

C1 15531

SEQUENCE NO. (MDE USE ONLY)

STATE OF MARYLAND WELL COMPLETION REPORT

FILL IN THIS FORM COMPLETELY PLEASE TYPE

THIS REPORT MUST BE SUBMITTED WITHIN 45-DAYS AFTER WELL IS COMPLETED.

COUNTY NUMBER

1 2 3 6 (THIS NUMBER IS TO BE PUNCHED IN COLS. 3-6 ON ALL CARDS)

ST/CO USE ONLY

DATE RECEIVED MM DD YY 02 19 13

DATE WELL COMPLETED MM DD YY 21 14 13

DEPTH OF WELL 22 220 26

(TO NEAREST FOOT)

PERMIT NO. FROM "PERMIT TO DRILL WELL" HO 93 2424

28 29 30 31 32 33 34 35 36 37

OWNER KORSLUND, JOHN WELL SITE ADDRESS BROWNS BRIDGE TOWN FULTON SUBDIVISION VANDY PROP SECTION LOT 3

WELL LOG

Not required for driven wells

STATE THE KIND OF FORMATIONS PENETRATED, THEIR COLOR, DEPTH, THICKNESS AND IF WATER BEARING

Table with columns: DESCRIPTION, FEET (FROM, TO), check if water bearing. Rows include Top Soil, Brown Shale, Brown Mica, Gray Mica opening, Gray Mica.

GROUTING RECORD

WELL HAS BEEN GROUTED (Circle Appropriate Box) Y N

TYPE OF GROUTING MATERIAL (Circle one) CM BENTONITE CLAY BC

CEMENT BENTONITE CLAY

NO. OF BAGS 19 NO. OF POUNDS 1900

GALLONS OF WATER 114

DEPTH OF GROUT SEAL (to nearest foot) from 0 ft. to 40 ft. BOTTOM

CASING RECORD

ST CO PL OT STEEL CONCRETE PLASTIC OTHER

MAIN CASING TYPE ST Nominal diameter top (main) casing (nearest inch)! 6 Total depth of main casing (nearest foot) 60

OTHER CASING (if used) ST diameter inch 10 depth (feet) from 0 to 39

SCREEN RECORD

ST BR HO PL OT STEEL BRASS BRONZE PLASTIC OPEN HOLE OTHER

DEPTH (nearest ft.) 1 2 8 9 11 15 17 21 23 24 26 30 32 36 38 39 41 45 47 51

SLOT SIZE 1 2 3 DIAMETER OF SCREEN (NEAREST INCH) 56 60 from to

GRAVEL PACK IF WELL DRILLED WAS FLOWING WELL INSERT F IN BOX 68

MDE USE ONLY (NOT TO BE FILLED IN BY DRILLER) T (E.R.O.S.) W Q 70 72 74 75 76

TELESCOPE CASING LOG INDICATOR OTHER DATA

C 3

PUMPING TEST

HOURS PUMPED (nearest hour) 3

PUMPING RATE (gal. per min.) 20

METHOD USED TO MEASURE PUMPING RATE Bucket

WATER LEVEL (distance from land surface)

BEFORE PUMPING 33 ft.

WHEN PUMPING 68 ft.

TYPE OF PUMP USED (for test)

A air P piston T turbine C centrifugal R rotary O other (describe below) J jet S submersible

PUMP INSTALLED

DRILLER INSTALLED PUMP (CIRCLE) (YES OR NO) YES NO

IF DRILLER INSTALLS PUMP, THIS SECTION MUST BE COMPLETED FOR ALL WELLS.

TYPE OF PUMP INSTALLED PLACE (A,C,J,P,R,S,T,O) IN BOX 29. 29

CAPACITY: GALLONS PER MINUTE (to nearest gallon) 31 35

PUMP HORSE POWER 37 41

PUMP COLUMN LENGTH (nearest ft.) 43 47

CASING HEIGHT (circle appropriate box and enter casing height) + above LAND SURFACE - below 2 (nearest foot)

LATITUDE 3 9.169387 LONGITUDE 7 6.939946 (DEFAULT COORD. WGS 84)

NOTES:

NUMBER OF UNSUCCESSFUL WELLS:

WELL HYDROFRACTURED yes Y no N

CIRCLE APPROPRIATE LETTER A A WELL WAS ABANDONED AND SEALED WHEN THIS WELL WAS COMPLETED E ELECTRIC LOG OBTAINED P TEST WELL CONVERTED TO PRODUCTION WELL

I HEREBY CERTIFY THAT THIS WELL HAS BEEN CONSTRUCTED IN ACCORDANCE WITH COMAR 26.04.04 "WELL CONSTRUCTION" AND IN CONFORMANCE WITH ALL CONDITIONS STATED IN THE ABOVE CAPTIONED PERMIT, AND THAT THE INFORMATION PRESENTED HEREIN IS ACCURATE AND COMPLETE TO THE BEST OF MY KNOWLEDGE.

DRILLERS LIC. NO. 1 M WD 040 DRILLERS SIGNATURE Henry F. Easterday

LIC. NO. 1 JSD 038

SITE SUPERVISOR (sign. of driller or journeyman responsible for sitework if different from permittee)

B 1 09368

SEQUENCE NO. (MDE USE ONLY)

STATE OF MARYLAND APPLICATION FOR PERMIT TO DRILL WELL please type

STATE PERMIT NUMBER

HO -95 -2426 fill in this form completely

Date Received (APA)

10-9-12

OWNER INFORMATION

Forstlund John 7319 Browns Bridge rd FULTON MD 20759

B 3

LOCATION OF WELL

Howard Van Noy PRO. FULTON

DRILLER INFORMATION

Allen Compton MS 0009 Eagles Well Drilling 10 Box 202 Woodbine MD 21797 Allen Compton 10-4-12

B 4

SOURCES OF DRILLING WATER

- 1. 2. 3.

Browns Bridge rd 1000 FT DISTANCE FROM ROAD

B 2

WELL INFORMATION

APPROX. PUMPING RATE 5 (GAL. PER MIN.) AVERAGE DAILY QUANTITY NEEDED 500 (GAL. PER DAY)

NOT TO BE FILLED IN BY DRILLER HEALTH DEPARTMENT APPROVAL

Howard A535193 13 COUNTY NAME COUNTY NO. STATE SIGNATURE DATE ISSUED 10/23/2012 R. RT 10/23/13

- DOMESTIC POTABLE SUPPLY & RESIDENTIAL IRRIGATION FARMING (LIVESTOCK WATERING & AGRICULTURAL IRRIGATION) INDUSTRIAL, COMMERCIAL, DEWATERING PUBLIC WATER SUPPLY WELL TEST, OBSERVATION, MONITORING OPEN LOOP GEOTHERMAL CLOSED LOOP GEOTHERMAL

APPROXIMATE DEPTH OF WELL 300 FEET

APPROXIMATE DIAMETER OF WELL NEAREST INCH

METHOD OF DRILLING (circle one)

BORED (or Augered) AIR-ROTary JETTED AIR-PERCussion ROTARY (Hydraulic Rotary) CABLE REVERSE-ROTary DRIVEN Drive-POINT other

REPLACEMENT OR DEEPEMED WELLS (CIRCLE APPROPRIATE BOX)

- THIS WELL WILL NOT REPLACE AN EXISTING WELL THIS WELL WILL REPLACE A WELL THAT WILL BE ABANDONED AND SEALED THIS WELL WILL REPLACE A WELL THAT WILL BE USED AS A STANDBY-CONTACT LOCAL APPROVING AUTHORITY FOR POLICY ON STANDBY WELLS THIS WELL WILL DEEPM AN EXISTING WELL

PERMIT NUMBER OF WELL TO BE REPLACED OR DEEPEMED (IF AVAILABLE)

Not to be filled in by driller (MDE OR COUNTY USE ONLY)

APPROX. PERMIT NUMBER PERMIT No. HO -95 -2426

PROPOSED LOCATION OF WELL ON LOT SHOW PERMANENT STRUCTURES SUCH AS BUILDINGS, SEPTIC SYSTEM, ROADS AND/OR LANDMARKS AND INDICATE NOT LESS THAN TWO DISTANCE MEASUREMENTS TO WELL

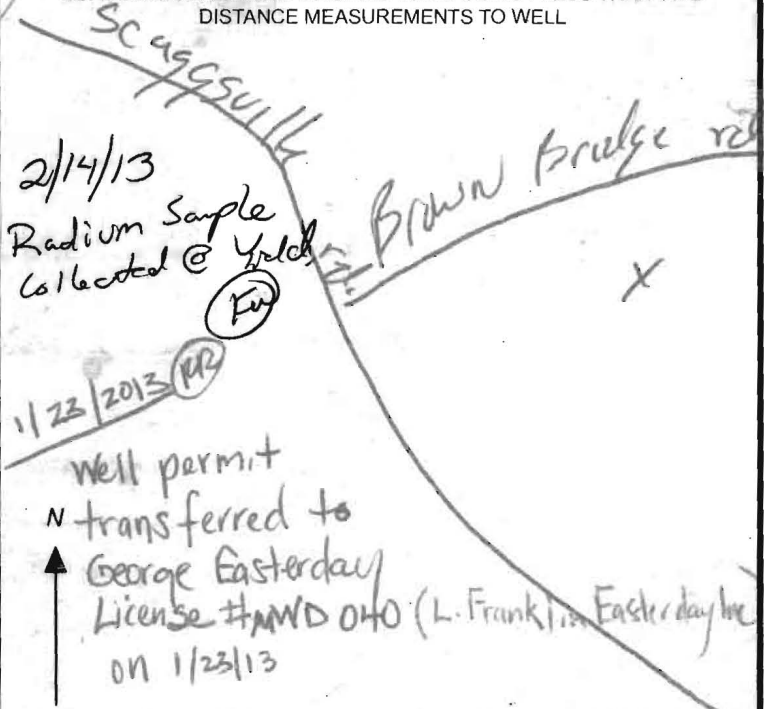

SPECIAL CONDITIONS

NOTE APPROVING AUTHORITIES SHOULD USE SEPARATE SHEET IF NEEDED

Radium Sample required @ yield test



HOWARD COUNTY HEALTH DEPARTMENT  
BUREAU OF ENVIRONMENTAL HEALTH  
WATER AND SEWERAGE PROGRAM  
TEL: (410)313-2640 FAX: (410)313-2648

Information Form for the Installation of the Well Pump, Pitless Adapter, and Supply Piping

NOTE: The installer is responsible for requesting an inspection prior to 9 am on the day of the desired inspection. No work is to be covered until approved by the Health Department. All installations must comply with the National Standard Plumbing Code (NSPC, as amended locally) and COMAR 26.04.04 (MD Well Construction Regulations). Submission of a complete form is required prior to Use and Occupancy approval.

Company Name: K.H. Plumbing, Inc. Telephone #: 410-259-5410  
Address: 470 DORTCH ST.  
WESTMINSTER, MD 21157

(Must circle one) Licensed Plumber Licensed Well Driller Licensed Well Pump Installer  
License # and name of individual responsible for the field installation:  
Name (Print): Keith Hundertmark License# 8300

\*A licensed individual must perform the actual installation. Apprentices must be under the direct supervision of a licensed journeyman or master plumber, pump installer or well driller. Licenses may be subjected to field verification.

Name of Property Owner: CHRIGAN Homes, Inc. Telephone #: 410-465-7755  
Subdivision: \_\_\_\_\_ Lot #: \_\_\_\_\_ Well Tag #: HO 45-2426J  
Site Address: 7311 Browns Bridge Rd.  
FULTON, MD 20759

Submersible Pump Data Pitless Adapter Well Cap and Electric Conduit  
Make: Goulds Make: American Clay by Two piece watertight cap: \_\_\_\_\_  
Model #: 5G507422C Model #: PT800NL Screened, vented well cap:   
Pump Capacity 5 GPM Depth: 42 1/2 (36" min) Cap secured to casing:   
Well Yield: 20 GPM NSF approved: Yes Conduit min 18" B.G.:   
Depth of well encountered at time of pump installation 220 (feet) Conduit secured to well cap:   
If pump capacity exceeds well yield, a low water cut off switch is required by NSPC 1990 Section 17.8.4  
Torque arrestors or Cable guards are required - Must circle one  
Safety rope, if used, attached to inside of well casing with eye bolt \_\_\_\_\_

Piping to House House Connection  
Type: polyethylene PVC sleeved to undisturbed soil at wall penetration:   
PSI: 160 (160 psi min) Approximate length of sleeve: 10'  
Depth of supply line 2' (36" min) Sleeve caulked and sealed properly:

The water supply line is required to be at least ten feet from the septic tank, pump chamber, sewage piping, distribution box, drainfields, and sewage reserve area. If this cannot be accomplished, contact this office for approval prior to installation.

Keith Hundertmark 7-8-16  
Signature of company representative responsible for installation date

For Health Department Use Only - Not to be completed by Installer

Date Insp. Requested: 7/12/16 Date Insp. Approved: 7/13/16 SC  
Inspection Data: Pitless adapter and water supply line at least 36" below grade   
Two piece cap installed and attached to casing securely   
Elec. conduit extends at least 18" below grade/attached to cap properly   
Safety rope installed inside of well casing   
Correct well tag attached properly and casing 8" above finished grade   
Water supply line sleeved adequately at house connection   
Adequate grout observed below pitless adapter

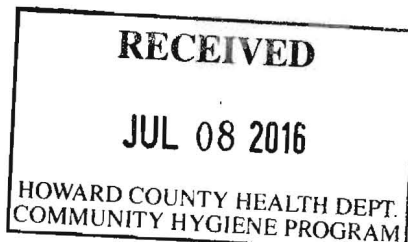

## Rappaport, Ryan

---

**From:** John Boris [jboris@mde.state.md.us]  
**Sent:** Thursday, January 10, 2013 9:13 AM  
**To:** Wolf, Kevin  
**Cc:** Rappaport, Ryan  
**Subject:** Re: Transfer of permit

Kevin,

I'm sure you've checked out the reg. If not see COMAR 26.04.04.06G for permit transfer instructions. In short you should get a new green form and some sort of written documentation from well driller A that states I'm transferring permit # to well driller B. I like the documentation because I want to completely release driller A from work being performed by driller B. After that you'll want driller B to send you something that stating that this permit is there responsibility. You can always issue another permit if the parties wish not to cooperate. You'll then have to get the tag and permit returned to you. Remember: We don't re-issue tags. It's a one and done unless transferred. Hope this helps. Let me know if you have any further issues regarding this matter.

John A. Boris, Jr., R.S., Geologist  
Maryland Dept.of the Environment  
Wastewater Permits Program  
Office: (410) 537-3678  
Fax: (410) 537-3163

Visit us on Facebook: [www.facebook.com/MDEnvironment](http://www.facebook.com/MDEnvironment)  
and Twitter:  
[www.twitter.com/MDEnvironment](http://www.twitter.com/MDEnvironment)

>>> "Wolf, Kevin" 01/09/13 4:32 PM >>>

John,

What do you want for a transfer of permit? Should we report anything on the original permit stating a ?transfer?? We might have a situation like this. Thoughts?

Thanks,

Kevin M. Wolf, R.S., R.E.H.S.  
Bureau of Environmental Health  
Well & Septic Program  
Groundwater Mgmt. Sec.  
7178 Columbia Gateway Dr.  
Columbia, MD 21046  
(o) 410-313-2645  
(f) 410-313-2648

---

### CONFIDENTIALITY NOTICE

This message and the accompanying documents are intended only for the use of the individual or entity to which they are addressed and may contain information that is privileged, confidential, or exempt from disclosure under applicable law. If the reader of this email is not the intended recipient, you are hereby notified that you are strictly prohibited from reading, disseminating, distributing, or copying this communication. If you have received this email in error, please notify the sender immediately and destroy the original transmission.



**AQUAFLOW**  
**PUMP & SUPPLY CO.**

1561 Pulaski Highway • P.O. Box 98 • Bear, DE 19701 . . . . . (302) 834-1311 • Fax (302) 834-0716  
16816 So. Dupont Highway • Harrington, DE 19952 . . . . . (302) 398-3704 • Fax (302) 398-3716  
15 Tomlinson Road • Huntingdon Valley, PA 19006 . . . . . (215) 947-7900 • Fax (215) 947-8907  
3001 Montrose Avenue • Reading, PA 19605 . . . . . (610) 929-0100 • Fax (610) 929-9230  
104 Railroad Street • Bedford, PA 15522 . . . . . (814) 623-2290 • Fax (814) 623-8892  
258 Donahoe Road • Greensburg, PA 15601 . . . . . (724) 552-0240 • Fax (724) 552-0249 • 1-800-581-5113  
9694 Rt. 322 • P.O. Box 157 • Shippenville, PA 16254 . . . . . (814) 226-5070 • Fax (814) 226-7961 • 1-800-360-4678  
16051 Business Parkway • Hagerstown, MD 21740 . . . . . (301) 790-0088 • Fax (301) 790-0098 • 1-877-558-0089  
2309 North Dupont Highway • New Castle, DE 19720 . . . . . (302) 656-5437 • Fax (302) 656-4309

Need not drill

at all on lot #3

Returning Permit + Jag

# ~~HD~~ 95-2426

Thanks

1/23/13

Note.

Transfer

Fogles Well



Bureau of Environmental Health  
7178 Columbia Gateway Drive, Columbia, MD 21046-2147  
Main: 410-313-2640 | Fax: 410-313-2648  
TDD 410-313-2323 | Toll Free 1-866-313-6300  
[www.hchealth.org](http://www.hchealth.org)  
Facebook: [www.facebook.com/hocohealth](http://www.facebook.com/hocohealth)  
Twitter: HowardCoHealthDep

**Maura J. Rossman, M.D., Health Officer**

---

**MEMORANDUM**

TO: George Easterday, MWD 040  
L. Franklin Easterday, Inc.

FROM: Jeff Williams, Program Supervisor  
Well & Septic Program

CC: Allen Compton  
Fogles Well Drilling

RE: Well Permit HO-95-2426, Van Noy Property, Lot 3, Browns Bridge Road

DATE: January 23, 2013

---

On January 22, 2012, I was notified by a representative of Fogles Well Drilling of their intent to transfer the above referenced well permit to you. On the same day, I received confirmation from a representative of L. Franklin Easterday, Inc. of your intent to accept the permit transfer.

Please accept this memo as the Approving Authority authorization of the permit transfer. Attached is the well tag, the driller copy of the permit, and the well exhibit showing the approved well location. If the well location is no longer staked at the site, you must notify our office and schedule a site visit with a Sanitarian to approve the well site prior to drilling. Please note that the permit expiration date is October 23, 2013.

1/9/13	- rec'd file from supervisor with new permit application from Easterday. I phoned the home owner, Mr. Korshend who stated that Fogles drilled Lot 1 & 2 but he wanted Easterday to drill Lot 3 and "frack" lots 1 & 2 to get a higher water yield. No completion report has been received for lots 1 & 2 yet. (RK)
1/14/13	- spoke to Allen Compton (Fogles) who stated that the well tag and permit had been put into the mail and sent back to us. A letter of transfer was requested from Fogles as per supervisor (JW) request. (JW)
1/14/13	- left a VM for home owner telling him that the Easterday permit would be release once the HD rec'd the Fogles permit/well tag back in our office. I also informed him that Easterday could frack lots 1 & 2 wells once the completion reports had been rec'd by the Hdept. (RK)
1/23/13	- permit transferred and mailed to Easterday (RK)
DATE	RESULTS OF REVIEW FOR FILE

FILE NOTES

**FISHER, COLLINS  
& CARTER, INC.**

**CIVIL ENGINEERING CONSULTANTS  
and LAND SURVEYORS**

Terrall A. Fisher, P.E., L.S.  
Earl D. Collins, P.E.  
Charles J. Crovo, Sr., P.E., L.S.

Paul W. Kriebel, P.E.  
Mark L. Robel, P.L.S.  
Aldo M. Vitucci, P.E.

July 8, 2011

Mr. Mike Davis  
Howard county Health Department  
Bureau of Environmental Health  
7178 Columbia Gateway Drive  
Columbia, Maryland 21046-4544

Re: Van Noy Property, Lot 3  
7319 Browns Bridge Road  
Percolation Certification Plat  
Waiver Request

Dear Mr. Davis:

On behalf of our client, Mr. John Korslund and Ms. Patricia Van Noy, and pursuant to my telephone conversation with Heidi Scott on July 7, 2011, we are requesting a variance for the proposed well box on Lot 3 that is located 200' downgradient from the septic easement for the above referenced project.

Should you have questions, or require additional information, please contact this office at 410-461-2855.

Very truly yours,  
Fisher, Collins & Carter, Inc



Tony Fertitta

Homeowner: \_\_\_\_\_

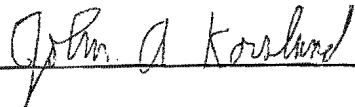

WO #08054-3001

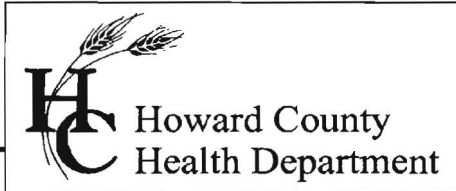

Bureau of Environmental Health  
7178 Gateway Drive Columbia, MD 21046  
(410) 313-2640 Fax (410) 313-2648  
TDD (410) 313-2323 Toll Free 1-866-313-6300  
Website: [www.hchealth.org](http://www.hchealth.org)

*Peter Beilenson, M.D., M.P.H., Health Officer*

July 13<sup>th</sup>, 2011

Patricia Van Noy & John Korslund  
7319 Browns Bridge Rd  
Fulton, MD 20759

**RE: Variance request  
Van Noy Property Lot 3  
7319 Browns Bridge Road**

Dear Ms. Van Noy & Mr. Korslund

The Health Department has received your variance request dated July 8<sup>th</sup>, 2011 for the above referenced property. Maryland Department of the Environment has accepted our recommendation to approve the following variance requests under the *Code of Maryland Regulations 26.04.02.05 (C)* to allow: the sewage disposal area serving the proposed house on Lot 2 to be located upgradient from the proposed private water supply on Lot 3. Due to the landscape position of the sewage area and well, the request was approved given that the proposed well is approximately 300' from the proposed sewage disposal area and the soils are acceptable.

If you have any questions regarding this matter, please contact me at the above address or by calling (410) 313-6287.

Sincerely,

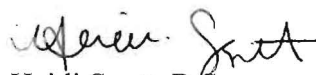
  
Heidi Scott, R.S.  
Well & Septic Program

  
Maryland Department of the Environment  
Steven Krieg, R.S.

Cc: File

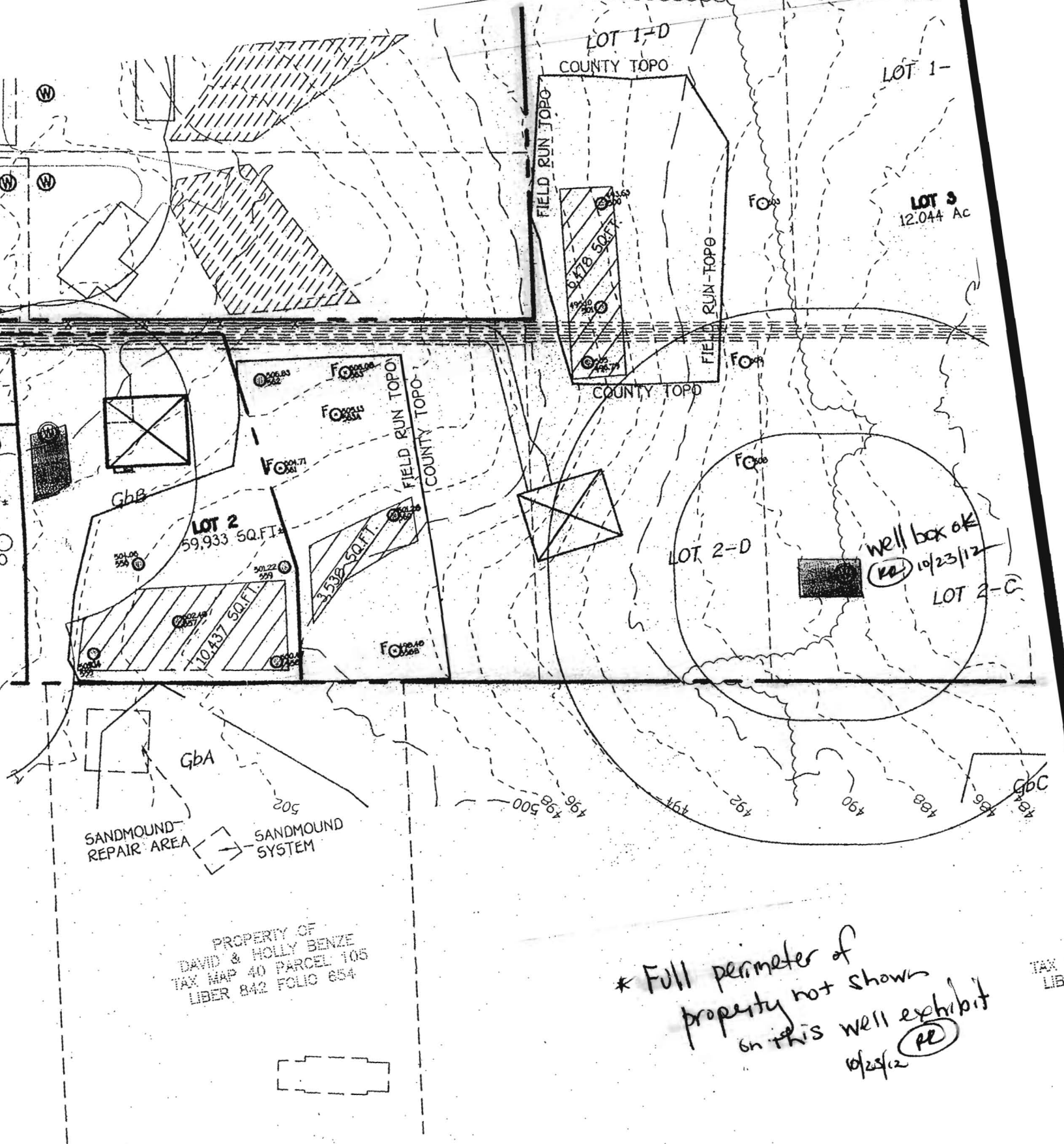

LOT 1-D  
COUNTY TOPO

LOT 1-

LOT 3  
12.044 Ac

FIELD RUN TOPO

FIELD RUN TOPO

COUNTY TOPO

FIELD RUN TOPO  
COUNTY TOPO

GbB

LOT 2  
59,933 SQ.FT.

10,437 SQ.FT.

3,538 SQ.FT.

LOT 2-D

well box OK  
(RE) 10/23/12  
LOT 2-C

GbA

SANDMOUND REPAIR AREA → SANDMOUND SYSTEM

PROPERTY OF  
DAVID & HOLLY BENZE  
TAX MAP 40 PARCEL 105  
LIBER 842 FOLIO 654

\* Full perimeter of  
property not shown  
on this well exhibit  
10/23/12 (RE)

TAX  
LIB

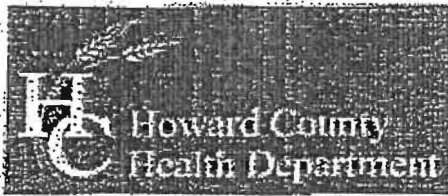

Bureau of Environmental Health  
7175 Columbia Gateway Drive, Columbia, MD 21046-2347  
(410) 313-2640 Fax (410) 313-2648  
TDD (410) 313-2322 Toll Free 1-866-313-6380  
website: www.hchealth.org

Peter L. Beilenson, M.D., M.P.H., Health Officer

Lot 3

TO ALL INTERESTED PARTIES

When submitting a well permit application for a proposed well for new construction, please indicate one of the following:

Well Site Location:  
Van Day Prop 1-3 Browns Bridge RD  
Subdivision/Property Name Lot# Road Name

- The well site has been staked by Fisher Collins & Carter  
(professional land surveyor or company employing professional land surveyors)  
on 9-12-12 (date) and does not require a site inspection.
- The well driller, builder or property owner will call the Health Department to schedule a time to meet in the field to verify the proposed well site location.

This sheet, along with two copies of an acceptable well site plan, must be attached to the green well permit application.

Revised 3/11/05

# FOUNTAIN VALLEY ANALYTICAL LABORATORY, INC.

1413 Old Taneytown Rd. Westminster, MD (410) 848-1014 (410) 876-4554 FAX (410) 848-0298

## REPORT OF ANALYSIS

Laboratory ID #: 109873	Account #: 24166
Reference: John Korslund	Company: CASH ACCOUNT
Location: 7311 Browns Bridge Road Fulton, MD 20759	Requested By: John Korslund
Date/ Time Collected: 9/12/2016 1045	Source: Well Water
Date/Time Rec'd: 9/12/2016 1315	Site: Pressure Tank
Chlorine ppm: Free: ND Total: ND	Treatment: Prior to Spin Down Separator
Collected By: J. Yeager 6176JY	pH: 7.0
	Well #: HO-95-2426

PARAMETERS	RESULTS	UNITS	REFERENCE	METHOD	DATE/TIME/ANALYST
Gross Alpha, Short Term	108	pCi/L	15	900.0	9/15/2016 / 0655 / MJN
Gross Beta, Short Term	74.1	pCi/L	50	900.0	9/15/2016 / 0655 / MJN
Gross Alpha, Long Term	30.6	pCi/L	15	900.0	9/23/2016 / 1103 / MJN
Gross Beta, Long Term	41.0	pCi/L	50	900.0	9/23/2016 / 1103 / MJN

*\* This was already done on 2/14/13 @ time of yield*

**NOTES**

- 1 Revised report: Building permit added 9/28/16
- 2 Long Term Gross Alpha Detection Limit: 1.5
- 3 pCi/L = picocuries per liter
- 4 Results less than or within the reference range sampling.
- 5 Short Term Gross Alpha Detection Limit: 1.
- 6 Sub-contracted to Reference Lab #278
- 7 ND:None Detected
- 8 Visual well check: Sealed, vented cap
- 9 pH & Chlorine level tested on site

Reason for Test : Use & Occupancy  
 Building Permit # : B-16000712

*message from John Korslund in voicemail*

*Robert*

/L  
 limits at the time of  
 Ci/L

Date Reported: 9/27/2016

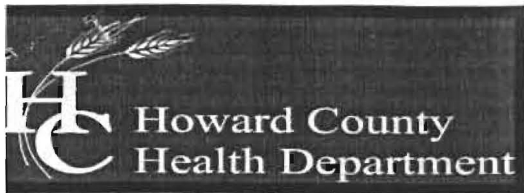

Bureau of Environmental Health

7178 Columbia Gateway Drive, Columbia, MD 21046-2147

Main: 410-313-2640 | Fax: 410-313-2648

TDD 410-313-2323 | Toll Free 1-866-313-6300

www.hchealth.org

Facebook: www.facebook.com/hocohealth

Maura J. Rossman, M.D., Health Officer

April 12, 2013

Mr. John Korslund  
7319 Brown Bridge Road  
Fulton, Maryland 20759

RE: Van Noy Property Lot 3  
Brown Bridge Road  
Well Tag: HO - 95 - 2426

Dear Mr. Korslund:

A sample was collected for the replacement well during a yield test on February 14, 2013 and submitted to the Department of Health & Mental Hygiene Laboratories to assess the possible presence of **Gross Alpha** and **Gross Beta** in the future well water supply. **Gross Alpha** and **Gross Beta** measure the total alpha and beta particle activity in a water supply. These naturally occurring radioactive nuclides have been demonstrated to be present in a certain type of geologic formation known as the Baltimore Gneiss which exists in your area of development within the County.

Results from this screening revealed a **Gross Alpha** of  $89.1 \pm 6.4$  picocuries/liter (pCi/L), while the **Gross Beta** level was  $51.9 \pm 3.8$  pCi/L. The **Gross Alpha** result was well above its **maximum contaminant level (MCL)** of 15 pCi/L, while the **Gross Beta** level was also above its targeted value of 50 pCi/L (roughly equivalent to the **annual dose rate** of 4 millirems/year).

At the time of testing and with respect to these parameters, the future well water supply **does not** meet EPA regulatory standards. Additional testing **for these parameters, plus Radium 226 and Radium 228** will be required to secure Use & Occupancy approval. Given the significantly elevated finding for **Gross Alpha** and elevated finding for **Gross Beta**, the installation of a water softener system and / or a reverse osmosis system will be necessary. **Pre and post short and long term Gross Alpha and Beta, plus a post Radium 226 / 228** will be needed to properly evaluate the effectiveness of the installed treatment(s). Given that it typically takes up to one month to perform and receive back the **Radium** analyses, plan accordingly. Please also note that other standard testing parameters (bacteria, nitrate, turbidity and sand) will still be required to help secure final approval for the replacement well.

A copy of the test results is enclosed for your information. Please call this office at 410-313-1773 if you have further questions or if you need to schedule additional testing.

Sincerely,

A handwritten signature in cursive script that reads 'Bert Nixon'.

Bert Nixon, Director

Bureau of Environmental Health

Enclosure

cc: Barry Glotfelty, MDE Water Mgmt.

✓ Well & Septic property file

Send Report To:

Bert Nixon

State of Maryland  
DHMH - Laboratories Administration  
Division of Environmental Chemistry  
**RADIATION LABORATORY**

E001746 2192

Howard County Health Department  
Bureau of Environmental Health  
7178 Columbia Gateway Drive  
Columbia, Maryland 21046

201 W. Preston Street, Baltimore, Maryland 21201  
John M. DeBoy, Dr. P. H., Director

**LABORATORY ANALYSIS REQUEST**

Sample Bottle No. A: 140KW2426 No. B: — Field Blank Bottle No. 1: FBKW21413 No B: —

Plant/Site Name: Van Noy Property - Lot (3) County: Howard

Sample Source: Browns Bridge Rd Location: Ho-95-2426  
(well no, lab sink, sample tap, etc.)

County:  1  3 Plant No.

CHECK (one per box)

Drinking Water	<input checked="" type="checkbox"/>
Landfill	<input type="checkbox"/>
Stream	<input type="checkbox"/>
Other	<input type="checkbox"/>

Community	<input type="checkbox"/>
Non-community	<input type="checkbox"/>
Private	<input checked="" type="checkbox"/>
Other	<input type="checkbox"/>

Source (raw water)	<input checked="" type="checkbox"/>
Distribution (treated)	<input type="checkbox"/>
MCL	<input type="checkbox"/>

Emergency	<input type="checkbox"/>
Routine	<input checked="" type="checkbox"/>
Recheck	<input type="checkbox"/>
Special	<input type="checkbox"/>

Collector: K. Wolf

Telephone No.: 410 313-2645

Date Collected: 2/14/13

Time Collected: 11:00 a.m. \_\_\_\_\_ p.m.

Nitric Acid Preserved: Yes  No

Iced: Yes  No

Submitters Code:

Federal Project:

Field Data: \_\_\_\_\_  
pH \_\_\_\_\_ Chlorine \_\_\_\_\_

Remarks: Sample pH < 2.0

✓	Test	EPA Code	Laboratory No.	Results (pCi/L)	Date Analyzed	Date Reported
✓	Gross Alpha	4000	1746	89.1 ± 6.4	02/21/13	02/25/13
✓	Gross Beta	4100	1746	51.9 ± 3.8	↓	↓
	Radon-222 Bottle A	4004				
	Radon-222 Bottle B	4004				
	Field Blank #A	4004				
	Field Blank #B	4004				
	Tritium					
	Ra - 226	4020				
	Ra - 228	4030				
	Total Uranium	4006				
	Gross Alpha - Conf.		1746	55.0 ± 5.3	02/26/13	02/28/13
	Gross Beta - Conf.		1746	44.2 ± 3.5	↓	↓

Date Received: 02/19/13

Supervisor: [Signature]

•Tel. No.: (410) 767 - 5537 •Fax No.: (410) 333- 5373



# Fredericktowne Labs Inc.

ENVIRONMENTAL TESTING

3020 Ventrie Court • P.O. BOX 244 • Myersville, MD 21773 • 800-332-3340 • FAX 501-293-2366  
www.fredericktownelabs.com • info@fredericktownelabs.com

## Certificate of Analysis

Acct. No. 10632 - 1-1

### Field Record

Site visit performed on: Monday, October 03, 2016 9:35 AM  
by: Alan DeValerio State ID No. 4018AD  
Affiliation: Fredericktowne Labs, Inc.  
Property Owner: Carrigan Homes, Inc  
Property Address: 7311 Browns Bridge Rd.  
Fulton, MD 20759  
Sample Source: Mudroom Sink  
Treatment Devices Noted: No Treatment Devices  
Well No.: HO-95-2426  
Field pH: 8.1  
Free Res. Cl.: <0.1 mg/l  
Temp: 20.1° C

### Laboratory Report

Sample Received at laboratory: 10/3/2016 12:38 PM

#### Bacteriological results:

Total Colif. (/100ml)	E.coli. (/100ml)	Start		End		Method	Analyst
		Date	Time	Date	Time		
8.7	<1	10/03/16	13:34	10/04/16	13:57	9223B	JD

Bacteriological analysis of this sample indicates the water is unsafe for human consumption.  
Analysis was performed according to the 20th edition of Standard Methods

#### Inorganic Chemical results:

Parameter	Result Units	MCL	Date of Analysis	Method	Analyst
Nitrate-Nitrogen	<0.2 mg/l	10	10/3/2016	300.0	PH
Sand	<2 mg/l	5	10/3/2016	0.065mm Filter	JD
Turbidity	1.9 NTU'	10	10/3/2016	180.1	KB

Reported by: Ellen Mellott 10/4/16  
Name Date

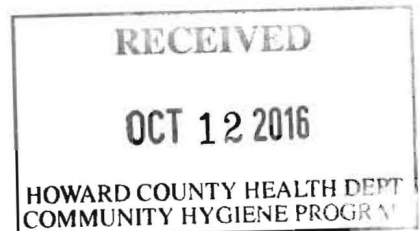

Fredericktowne Labs, Inc. is a State Certified Water Quality Laboratory  
Maryland Cert. No. 116 Virginia Cert. No. 00444  
MDOT WBE Cert. No.: 91-158



# Fredericktowne Labs Inc.

ENVIRONMENTAL TESTING

3020 Ventria Court • P.O. BOX 245 • Myersville, MD 21773 • 500-332-3340 • FAX 301-293-2366  
www.fredericktownelabs.com • Info@fredericktownelabs.com

## Certificate of Analysis

Acct. No. 10632 - 1-2

### Field Record

Site visit performed on: Monday, October 10, 2016 8:16 AM  
by: Kyle Neuman State ID No. 0036KN  
Affiliation: Fredericktowne Labs, Inc.  
Property Owner: Carrigan Homes, Inc  
Property Address: 7311 Browns Bridge Rd.  
Fulton, MD 20759  
Sample Source: Pressure Tank  
Treatment Devices Noted: Sediment Filter/Water Softener  
Well No.: HO-95-2426  
Free Res. Cl.: 0.9 mg/l

### Laboratory Report

Sample Received at laboratory: 10/10/2016 11:38 AM

### Bacteriological results:

<u>Total Colif. (/100ml)</u>	<u>E.coli.(/100ml)</u>	<u>Start</u>		<u>End</u>		<u>Method</u>	<u>Analyst</u>
		<u>Date</u>	<u>Time</u>	<u>Date</u>	<u>Time</u>		
						9223B	NPV

## Non-Productive Visit

### Chlorine over limit

Reported by: Curtis Phelps 10/10/16  
Name Date

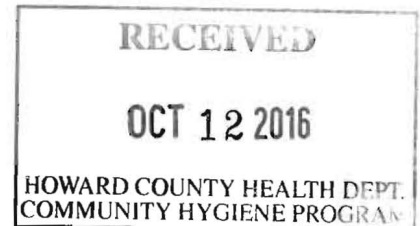

Fredericktowne Labs, Inc. is a State Certified Water Quality Laboratory  
Maryland Cert. No. 116 Virginia Cert. No. 00444  
MDOT WBE Cert. No.: 91-158



# Fredericktowne Labs Inc.

ENVIRONMENTAL TESTING

3020 Ventrie Court • P.O. BOX 245 • Myersville, MD 21773 • 800-332-3340 • FAX 301-283-2366  
www.fredericktownelabs.com • info@fredericktownelabs.com

## Certificate of Analysis

Acct. No. 10632 - 1-3

### Field Record

Site visit performed on: Monday, October 10, 2016 2:50 PM  
by: Wayne Dunkley State ID No. 4362WD  
Affiliation: Fredericktowne Labs, Inc.  
Property Owner: Carrigan Homes, Inc  
Property Address: 7311 Browns Bridge Rd.  
Fulton, MD 20759  
Sample Source: Mud Room Sink  
Well No.: HO-95-2426  
Field pH: 7.6  
Free Res. Cl.: <0.1 mg/l

### Laboratory Report

Sample Received at laboratory: 10/10/2016 4:05 PM

### Bacteriological results:

<u>Total Colif. (/100ml)</u>	<u>E.coli. (/100ml)</u>	<u>Start</u>		<u>End</u>		<u>Method</u>	<u>Analyst</u>
		<u>Date</u>	<u>Time</u>	<u>Date</u>	<u>Time</u>		
<1	<1	10/10/16	16:27	10/11/16	10:37	9223B	JD

**Bacteriological analysis of this sample indicates the water is safe for human consumption and meets federal, state and local requirements. Analysis was performed according to the 20th edition of Standard Methods**

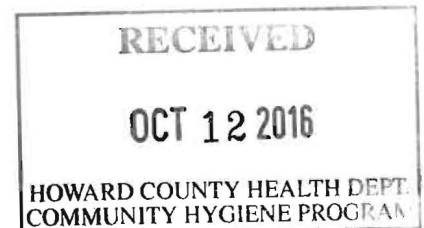

Reported by: Ellen Mellott 10/11/16  
Name Date

Fredericktowne Labs, Inc. is a State Certified Water Quality Laboratory  
Maryland Cert. No. 116 Virginia Cert. No. 00444  
MDOT WBE Cert. No.: 91-168

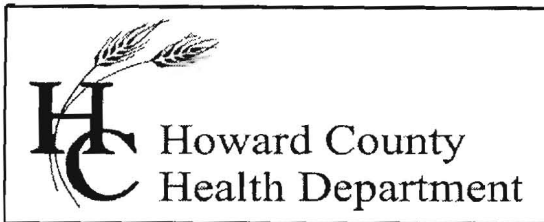

## Bureau of Environmental Health

8930 Stanford Blvd., Columbia, MD 21045  
Main: 410-313-1771 | Fax: 410-313-2648  
TDD 410-313-2323 | Toll Free 1-866-313-6300  
[www.hchealth.org](http://www.hchealth.org)  
Facebook: [www.facebook.com/hocohealth](https://www.facebook.com/hocohealth)  
Twitter: HowardCoHealthDep

Maura J. Rossman, M.D., Health Officer

---

TEMPORARY INTERIM CERTIFICATE OF POTABILITY  
**TEMPORARY DEVIATION FOR RADIUM**  
Expiration Date – November 19, 2016

October 20, 2016

John Korslund  
7311 Browns Bridge Road  
Fulton, MD 20759

**RE: Van Noy Property, Lot 3  
7311 Browns Bridge Road  
Building Permit: B16000712  
Well Permit: HO-95-2426**

Dear Homeowner:

This is to advise you that the septic system installation and water well construction for the above referenced property have been inspected and approved. Final approval of the septic system was granted on **10/7/2016**. Final approval of the well line connection to the dwelling was granted on **7/13/2016**. The well construction was completed on **2/14/2013**. Water samples were collected on **10/10/2016 & 10/10/2016**.

The water sample results indicate that the water samples submitted for testing were free of coliform and fecal coliform bacteria at the time of sampling and are bacteriologically safe for drinking.

Gross Alpha and Beta samples were also collected on **2/14/2013**. Results showed a Gross Alpha level of **89.1 ± 6.4 pCi/L** and **Gross Beta** level of **51.9 ± 3.8 pCi/L**. The Gross Alpha and Beta results were well above its maximum contaminant level (MCL) of 15 pCi/L.

**This is a temporary deviation to allow additional time for testing your well water system for Radium. Submission of water sample results must be obtained by the Health Department within the allowed 30 day period for the Interim Certificate of Potability.**

This Department will grant a **temporary deviation** to the Interim Certificate of Potability on condition that water sample results for long term gross alpha/beta are submitted to this Department **within 30 days**. Those results must indicate that the radionuclide levels meet a Gross Alpha level of less than **15 pCi/L**, and a Gross Beta level of less than **50 pCi/L**.

**This Temporary Interim Certificate of Potability will expire 30 days from the date of issuance. Failure to submit the required radium sample results and obtain an Interim Certificate of Potability before the expiration date will result in a Notice of Violation and is punishable as a misdemeanor under the *Annotated Code of Maryland, Environment Article, 9-1311*, subject to a fine of up to \$500 or imprisonment not to exceed three months.**

Please contact (410) 313-1773 to schedule a water sample appointment or contact a Maryland certified water quality laboratory to schedule a water sample. A list of laboratories certified by the state of Maryland may be found at the following website:  
<http://www.mde.state.md.us/assets/document/WSP-Labs-2010apr16.pdf>

Approving Authority,

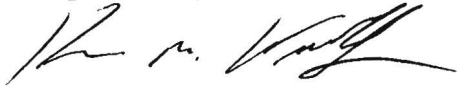

Kevin M. Wolf, L.E.H.S., REHS/RS, Supervisor  
Groundwater Management Section  
Well & Septic Program

cc: Howard County Dept. of Inspections, Licenses, and Permits  
Community Hygiene Program  
File

# FOUNTAIN VALLEY ANALYTICAL LABORATORY, INC.

1413 Old Taneytown Rd. Westminster, MD (410) 848-1014 (410) 876-4554 FAX (410) 848-0298

## REPORT OF ANALYSIS

Laboratory ID #: 110586 Account #: 24166  
Reference: John Korslund Company: CASH ACCOUNT  
Location: 7311 Browns Bridge Road Requested By: John Korslund  
Fulton, MD 20759 Source: Well Water  
Date/ Time Collected: 10/10/2016 1225 Site: Tap at Mud Room  
Date/Time Rec'd: 10/10/2016 1320 Treatment: Spin Down Separator/Softener/Carbon  
Chlorine ppm: Free: ND Total: ND pH: 7.2  
Collected By: J. Yeager 6176JY Well #: HO-95-2426

PARAMETERS	RESULTS	UNITS	REFERENCE	METHOD	DATE/TIME/ANALYST
Gross Alpha, Short Term	2.3	pCi/L	15	900.0	10/13/2016 / 0653 / MJN
Gross Beta, Short Term	<1.8	pCi/L	50	900.0	10/13/2016 / 0653 / MJN
Gross Alpha, Long Term	<1.3	pCi/L	15	900.0	10/20/2016 / 0647 / MJN
Gross Beta, Long Term	2.0	pCi/L	50	900.0	10/20/2016 / 0647 / MJN

### NOTES

- 1 Long Term Gross Alpha Detection Limit: 1.3 pCi/L; Long Term Gross Beta Detection Limit: 1.9 pCi/L
- 2 pCi/L = picocuries per liter
- 3 Results less than or within the reference range are considered satisfactory and within potable water limits at the time of sampling.
- 4 Short Term Gross Alpha Detection Limit: 1.0 pCi/L; Short Term Gross Beta Detection Limit: 1.8 pCi/L
- 5 Sub-contracted to Reference Lab #278
- 6 ND:None Detected
- 7 Visual well check: Sealed, vented cap
- 8 pH & Chlorine level tested on site

Reason for Test : Use & Occupancy

Date Reported: 10/21/2016

Send Report To:

Bert Nixon

Howard County Health Department  
Bureau of Environmental Health  
7178 Columbia Gateway Drive  
Columbia, Maryland 21046

State of Maryland  
DHMH - Laboratories Administration  
Division of Environmental Chemistry  
**RADIATION LABORATORY**  
201 W. Preston Street, Baltimore, Maryland 21201  
John M. DeBoy, Dr. P. H., Director

**LABORATORY ANALYSIS REQUEST**

Sample Bottle No. A: HOKW2426 No. B: — Field Blank Bottle No. 1: FBKW21413 No B: —

Plant/Site Name: Van Noy Property - Lot (3) County: Howard

Sample Source: Browns Bridge Rd Location: HO-95-2426  
(well no, lab sink, sample tap, etc.)

County:  1  3 Plant No.

CHECK (one per box)

Drinking Water	<input checked="" type="checkbox"/>
Landfill	<input type="checkbox"/>
Stream	<input type="checkbox"/>
Other	<input type="checkbox"/>

Community	<input type="checkbox"/>
Non-community	<input type="checkbox"/>
Private	<input checked="" type="checkbox"/>
Other	<input type="checkbox"/>

Source (raw water)	<input checked="" type="checkbox"/>
Distribution (treated)	<input type="checkbox"/>
MCL	<input type="checkbox"/>

Emergency	<input type="checkbox"/>
Routine	<input checked="" type="checkbox"/>
Recheck	<input type="checkbox"/>
Special	<input type="checkbox"/>

Collector: K. Wolf

Telephone No.: 410 313-2645

Date Collected: 2/14/13

Time Collected: 11:00 a.m. \_\_\_\_\_ p.m.

Nitric Acid Preserved: Yes  No

Iced: Yes  No

Submitters Code:

Federal Project:

Field Data: \_\_\_\_\_  
pH Chlorine

Remarks: Sample pH < 2.0

✓	Test	EPA Code	Laboratory No.	Results (pCi/L)	Date Analyzed	Date Reported
✓	Gross Alpha	4000				
✓	Gross Beta	4100				
	Radon-222 Bottle A	4004				
	Radon-222 Bottle B	4004				
	Field Blank #A	4004				
	Field Blank #B	4004				
	Tritium					
	Ra - 226	4020				
	Ra - 228	4030				
	Total Uranium	4006				

Date Received: \_\_\_/\_\_\_/\_\_\_

Supervisor: \_\_\_\_\_

•Tel. No.: (410) 767 - 5537 •Fax No.: (410) 333- 5373