



APPLICATION

FOR PERCOLATION TESTING AND SITE EVALUATION

\$ 506.00

TEST DATE(S) _____ TEST TIME _____

A/P 535175

AGENCY REVIEW: _____

DATE 5-3-11

DO NOT WRITE ABOVE THIS LINE

I HEREBY APPLY FOR THE NECESSARY TESTING/EVALUATION PRIOR TO ISSUANCE OF SEWAGE DISPOSAL SYSTEM PERMIT(S) TO:

CHECK AS NEEDED:

- CONSTRUCT NEW SEPTIC SYSTEM(S)
- REPAIR/ADD TO AN EXISTING SEPTIC SYSTEM
- REPLACE AN EXISTING SEPTIC SYSTEM

CHECK AS NEEDED:

- NEW STRUCTURE(S)
- ADDITION TO AN EXISTING STRUCTURE
- REPLACE AN EXISTING STRUCTURE

CHECK ONE:

- CREATE NEW LOT(S)
- BUILD ON AN EXISTING LOT IN A SUBDIVISION
- BUILD ON AN EXISTING PARCEL OF RECORD

IS THE PROPERTY WITHIN 2500' OF ANY RESERVOIR?

- YES
- NO

THE TYPE OF STRUCTURE IS:

- RESIDENTIAL WITH _____ PROPOSED BEDROOMS IN THE COMPLETED STRUCTURE (NOTE **UNKNOWN** IF APPROPRIATE)
- COMMERCIAL (PROVIDE DETAIL OF NUMBERS AND TYPES OF EMPLOYEES/ CUSTOMERS ON ACCOMPANYING PLAN)
- INSTITUTIONAL/GOVERNMENT (PROVIDE DETAIL OF NUMBERS AND TYPES OF EMPLOYEES/USERS ON ACCOMPANYING PLAN)

PROPERTY OWNER(S) Jingli Yang + Peter Li

DAYTIME PHONE _____ CELL 301-361-4109-4011 FAX _____

MAILING ADDRESS 6555 Paper Place Highland MD 20777
STREET CITY/TOWN STATE ZIP

APPLICANT Manland Potts Don Coulter

DAYTIME PHONE 410-995-6600 CELL 443-604-4029 FAX 410-381-4052

MAILING ADDRESS 9515 Gerwig Ln #121 Columbia MD 21046
STREET CITY/TOWN STATE ZIP

APPLICANT'S ROLE: DEVELOPER **BUILDER** BUYER RELATIVE/FRIEND REALTOR CONSULTANT

PROPERTY LOCATION
SUBDIVISION/PROPERTY NAME Van't Hoff Property LOT NO. 4

PROPERTY ADDRESS 6555 Paper Place Highland MD 20777
STREET TOWN/POST OFFICE

TAX MAP PAGE(S) 0034 GRID 0017 PARCEL(S) 0393 PROPOSED LOT SIZE 5,7135 ac

AS APPLICANT, I UNDERSTAND THE FOLLOWING: THE SYSTEM INSTALLED SUBSEQUENT TO THIS APPLICATION IS ACCEPTABLE ONLY UNTIL PUBLIC SEWERAGE IS AVAILABLE. THIS APPLICATION IS COMPLETE WHEN ALL APPLICABLE FEES AND A SUITABLE SITE PLAN HAVE BEEN RECEIVED. I ACCEPT THE RESPONSIBILITY FOR COMPLIANCE WITH ALL M.O.S.H.A. AND "MISS UTILITY" REQUIREMENTS. APPROVAL IS BASED UPON SATISFACTORY REVIEW OF A PERC CERTIFICATION PLAN.

TEST RESULTS WILL BE MAILED TO APPLICANT.

[Signature]
SIGNATURE OF APPLICANT

HOWARD COUNTY HEALTH DEPARTMENT, BUREAU OF ENVIRONMENTAL HEALTH, WELL AND SEPTIC PROGRAM
7178 COLUMBIA GATEWAY DRIVE COLUMBIA, MARYLAND 21046 (410) 313-2640 FAX (410) 313-2648
TDD (410) 313-2323 TOLL FREE 1-877-4MD-DHMH

#1
 Grey Brown
 2SBK SLt 0.8
 Red Brown
 Heavy Cl 3'
 Red Yellow
 Brown
 10-20%
 Sm Stones
 Many
 mica
 Med. SL
 ↓
 10'

#2
 Grey Brown
 Red 2sbk
 SLt 0.8
 Red Brown
 Cl 3'
 Fine S. Red
 Yellow
 10-20%
 small Rf
 much mica
 Black Mangrove
 Deposits
 around 8'
 ↓
 10'

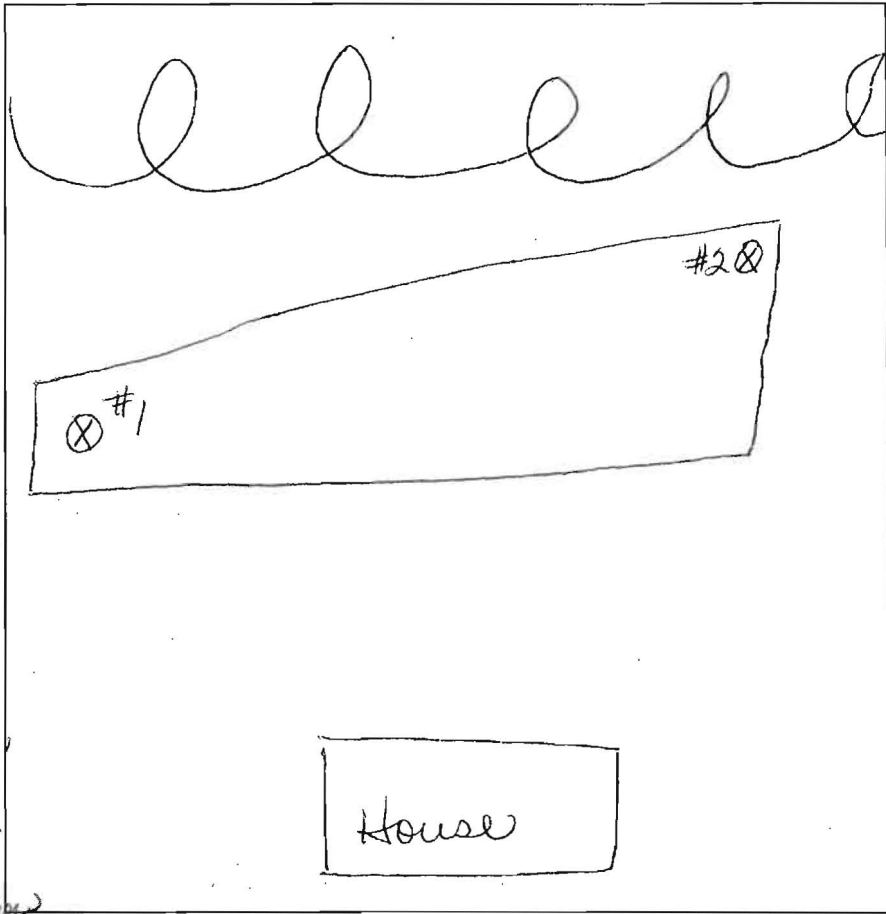

DATE	TEST #	DEPTH	START	BREAK 1" DROP	STOP 2" DROP	TIME OF 2ND INCH	P/F/H
5-25-11	#1	4' 10	10:44	10:47	10:52	5 min	P
5-25-11	#2	4' 10	10:23	10:25	10:27	2 min	P

REMARKS Upgrade for addition
 SANITARIAN Bernard BACKHOE Maryland OTHERS J. Conkley
 TEST HOLES USED IN SDA 2 AVG. PERC TIME 5m SQ. FT/BR _____
 TRENCH WIDTH _____ INLET DEPTH 4 MAX. BOT DEPTH 6 EFFECTIVE SW 2

Percolation Information- 6555 Paper Place

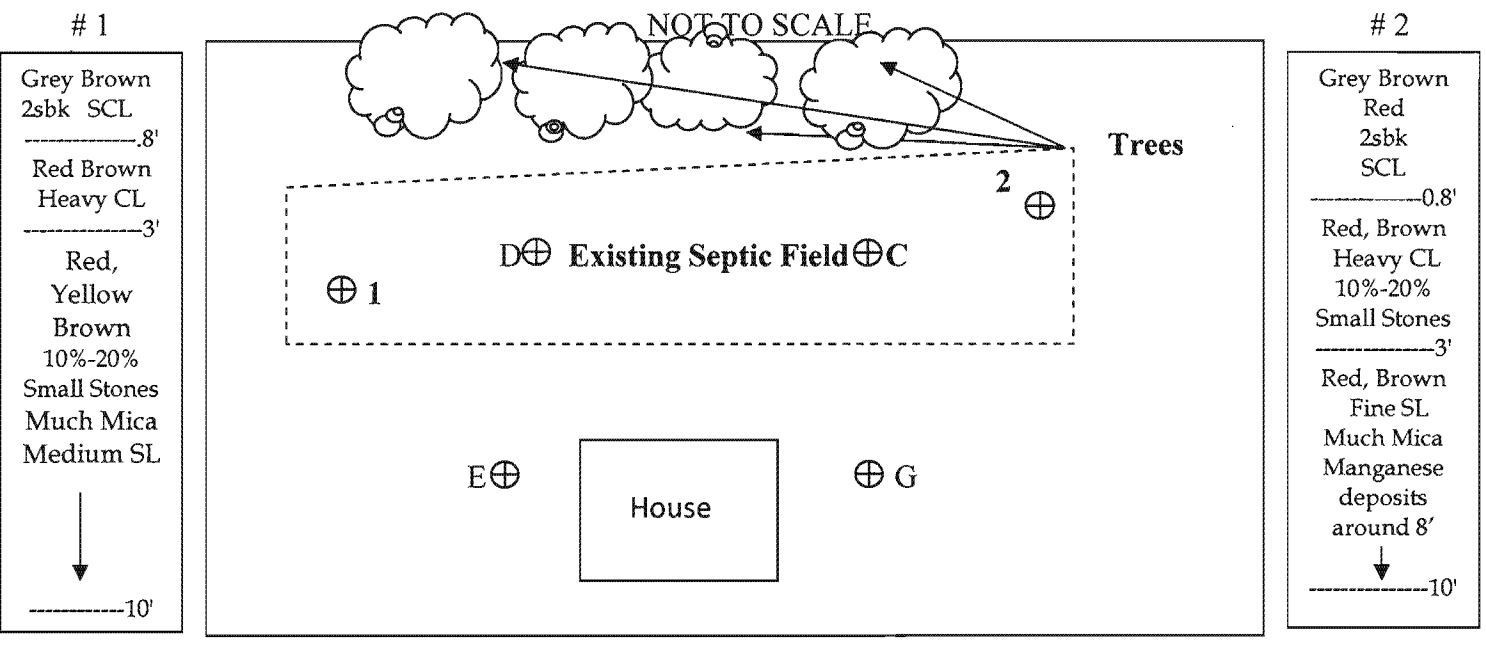

Date	Test #	Depth	Start	Break 1" Drop	Break 2" Drop	Time of 2 nd Inch	P/F/H
5-25-11	1	4'/10'	10:44	10:47	10:52	5 min.	Pass
5-25-11	2	4'/10'	10:23	10:25	10:27	2 min.	Pass

Remarks: Percolation occurred to Upgrade easement for addition. (pool) Sanitarian DB Backhoe: Maryland Pools Others J Coakley

Test Holes Used in SDA 2 Avg. Percolation Time 5min. SQ.FT/BR

Trench Width 3 Inlet Depth 4 Max Bot.Depth 6 Effective S/W 2

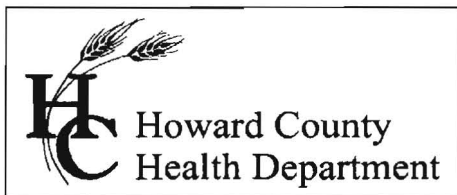

Bureau of Environmental Health
7178 Gateway Drive Columbia, MD 21046
(410) 313-2640 Fax (410) 313-2648
TDD (410) 313-2323 Toll Free 1-866-313-6300
Website: www.hchealth.org

Peter L. Beilenson, M.D., M.P.H., Health Officer

May 26, 2011

RE: **Percolation Test Results**

Purpose: To Redesign Septic Reserved Area for Proposed Building Permit

Property ID: 6555 Paper Place

Highland, Maryland 20777

Tax Map: 34 Parcel: 393 Lot #4

TO: Mr. J. Coakley

Maryland Pools

9515 Gerwig Lane, Suite # 121

Columbia, Maryland 21046

Dear Mr. Coakley:

Percolation testing was recently conducted on May 25, 2011 on the above referenced property, in an effort to redesign the septic reserve area to support an addition for the existing lot.

A total of 2 test holes were dug in the proposed area. Results for the lot indicated satisfactory soil conditions for onsite wastewater disposal. Acceptable ranges for recommended inlet and trench bottom depth, and usable sidewall are indicated, and may be confirmed at the time of installation. Field data collected is shown on the Percolation Test Worksheet enclosed with this letter.

The next step in this process is to have your engineer./consultant submit a Percolation Certification Plan to confirm the redesign of the septic reserve area. If you have any questions regarding this evaluation or requirements for the Percolation Certification Plan, please contact me at the above address or by telephone at (410) 313-2775.

Respectfully,

Dana Bernard

Dana Bernard, REHS/ RS

Bureau of Environmental Health

Well and Septic Program

Development and Coordination

Phone (410) 313-2775

E-mail: DBernard@howardcountymd.gov

DLB

Enclosures

cc: Well & Septic Program