



Bureau of Environmental Health
 8930 Stanford Boulevard, Columbia, MD 21045
 Main: 410-313-2640 | Fax: 410-313-2648
 TDD 410-313-2323 | Toll Free 1-866-313-6300
www.hchealth.org
 Facebook: www.facebook.com/hocohealth

Maura J. Rossman, M.D., Health Officer

RECEIPT DATE: 1/12/17 **ONSITE SEWAGE DISPOSAL SYSTEM** P ~~56506~~ 561410

APPROVAL DATE: 6/13/17 **PERMIT:** SEC **REPAIR** A _____

PROPERTY ADDRESS: 13270 Highland Road

SUBDIVISION: _____ LOT: _____ TAX ID: 05-341477

CONTRACTOR: Garland Brian EMAIL: _____

CONTRACTOR ADDRESS: _____ PHONE: 301-370-5432

PROPERTY OWNER: Zafar Gill EMAIL: _____

OWNER ADDRESS: 13270 Highland Road, Highland, MD 20777 PHONE: 410-707-7381

SEPTIC TANK SIZE (GALLONS): EX. PUMP CHAMBER CAPACITY (GALLONS): N/A PUMP SIZE: -

NUMBER OF BEDROOMS: 3 HOUSE SQ. FT. - APPLICATION RATE: 0.9

DISTRIBUTION SYSTEM: GRAVITY FED LOW PRESSURE DOSED

TRENCHES:	LINEAR FEET REQUIRED: <u>124 LF</u>	INLET DEPTH: <u>4'</u>
	TRENCH WIDTH: <u>2</u>	MAXIMUM BOTTOM DEPTH: <u>9'</u>
	MINIMUM SPACE BETWEEN TRENCHES: <u>N/A</u>	EFFECTIVE AREA BEGINNING DEPTH: <u>6'</u>
LOCATION:	TO BE STAKED BY SANITARIAN DURING PRE-CONSTRUCTION INSPECTION.	
NOTES:	<i>Install 2x62' trenches running in both directions. Trench running south must be installed w/ laser level. Approx 7" diff. Trenches pointed/staked in field. Ea. Drywell to be pumped/collected.</i>	

ISSUED BY: K. Wolf ISSUE DATE: 2/10/17 EXPIRATION DATE: 2/10/18

- NOTE: CONTRACTOR MUST SCHEDULE A PRE-CONSTRUCTION INSPECTION PRIOR TO BEGINNING ANY INSTALLATION
- NOTE: CONTRACTOR MUST SCHEDULE AN INSPECTION AND GAIN APPROVAL OF ALL COMPONENTS PRIOR TO COVERING
- NOTE: STONE MUST BE APPROVED BY HEALTH DEPARTMENT AND GRAVEL TICKET MUST BE AVAILABLE FOR REVIEW.
- NOTE: WATERTIGHT SEPTIC TANKS REQUIRED
- NOTE: ALL PARTS OF SEPTIC SYSTEM SHALL BE AT LEAST 100 FEET DOWNGRADE FROM ANY WATER WELL
- NOTE: MANHOLE RISERS REQUIRED ON ALL SEPTIC TANKS AND PUMP CHAMBERS
- NOTE: **AN ELECTRICAL PERMIT IS REQUIRED FOR INSTALLATION OF ANY ELECTRICAL COMPONENTS OF THE SYSTEM**
 ELECTRICAL PERMIT ISSUED E N/A
- NOTE: THE HCHD DOES NOT WARRANT ANY SYSTEM AND CANNOT GUARANTEE THE PERFORMANCE OF THIS SYSTEM AS DESIGNED. BY ACCEPTING THIS PERMIT, THE OWNER AND/OR APPLICANT ACKNOWLEDGE THAT THE SPECIFICATIONS DETAILED IN THIS DESIGN ARE ONE POSSIBLE OPTION AND THAT THE HCHD WILL REVIEW OTHER PROPOSALS. YOU HAVE THE OPTION TO SEEK THE ADVICE OF A QUALIFIED DESIGN CONSULTANT OR PROFESSIONAL ENGINEER FOR FURTHER GUIDANCE.
- NOTE: MDE RECOMMENDS SEPTIC TANKS, BAT, AND OTHER PRETREATMENT UNITS BE PUMPED AT A FREQUENCY ADEQUATE TO ENSURE THAT SOLIDS ARE NOT DISCHARGED TO THE DISPOSAL AREA

NEITHER THE HOWARD COUNTY COUNCIL NOR THE HEALTH DEPARTMENT IS RESPONSIBLE FOR THE SUCCESSFUL OPERATION OF ANY SYSTEM.

PERMITTEE RESPONSIBLE FOR OBTAINING FINAL APPROVAL ON THIS PERMIT.

CALL 410-313-1771 TO SCHEDULE INSPECTIONS.

NOT TO SCALE

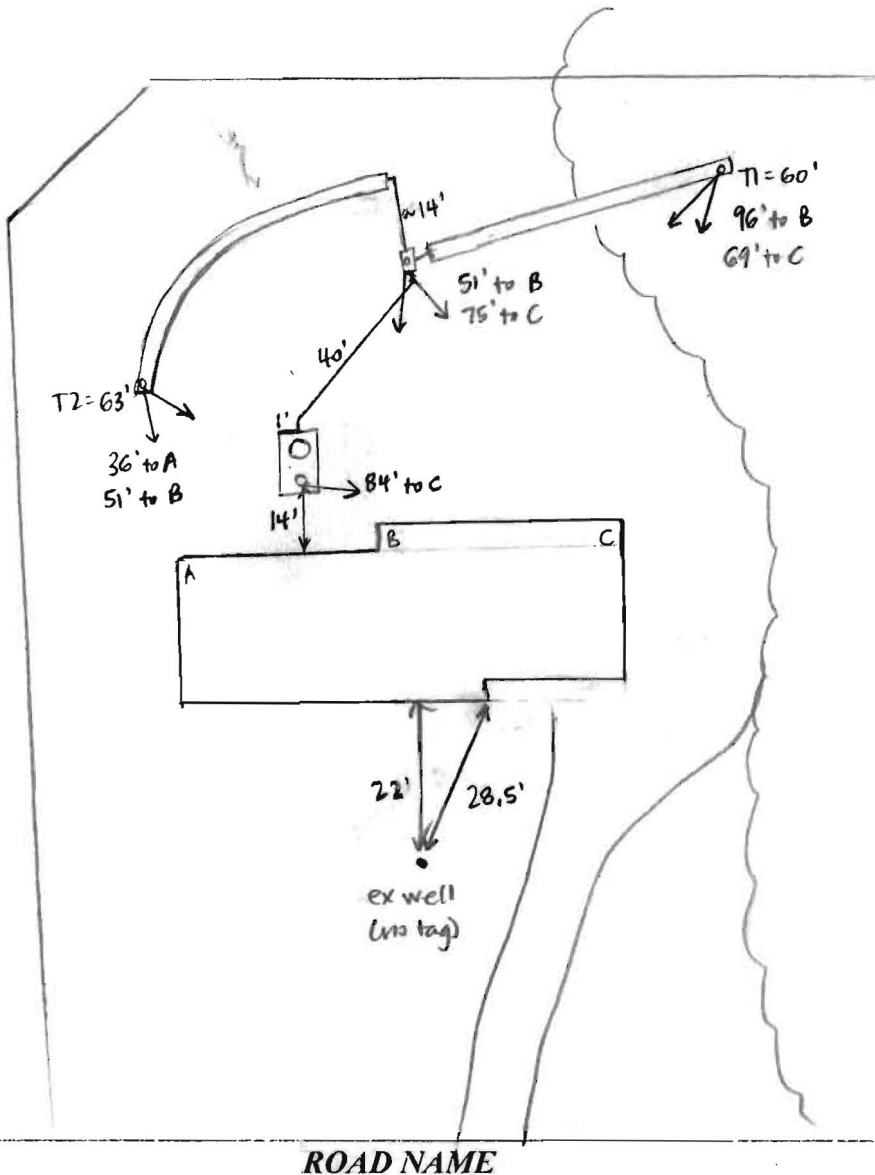

TRENCH/DRAINFIELD DATA		
WIDTH	INLET	BOTTOM
2'	4'	9'
NUMBER OF TRENCHES	2	
TOTAL LENGTH	123'	
ABSORPTION AREA	246' + SIDEWALL	
DISTRIBUTION BOX LEVEL	_____	
DISTRIBUTION BOX BAFFLE	_____	
DISTRIBUTION BOX PORT	_____	

SEPTIC TANK DATA	
SEPTIC TANK 1 LEVEL	existing
MANUFACTURER	?
CAPACITY	750 GAL
SEAM LOC	MID
TANK LID DEPTH	1.5-2'
BAFFLES	_____
BAFFLE FILTER	NO
MANHOLE LOC	REAR
6" PORT LOC	FRONT
WATERTIGHT TEST	NO
SLOTTED	NO
DATE ON LID	_____
PUMP/SEPTIC TANK LEVEL	
MANUFACTURER	
CAPACITY	
SEAM LOC	
TANK LID DEPTH	
BAFFLES	
BAFFLE FILTER	
MANHOLE LOC	
6" PORT LOC	
WATERTIGHT TEST	
SLOTTED	
DATE ON LID	

PRE-CONSTRUCTION:

2/10/17 Contour shot. Install D-box @ middle of trenches. Install 2 x 62' tanks running in both directions. Painted end staked in field. 62' trench running SE is to be installed closer to well ARC to concrete area. Roughly 7" difference start to end. Must use laser level. (KMD)

2/13/17 Contractor called explained owner is checking w/ other septic contractor and pipes. (KMD)

INSTALLATION: 5/15/17 met w/ Garland Brian. went over layout as indicated.

Must call in all work (KMD) 6/5/17 Trenches complete, left open for inspection.

T1 is 3.5' to stone at start and in middle, 4' to stone at end. Contractor not on site, not sure if he used laser while digging. Need Panella caps on observation pipes.

OK to cover trenches. (SC) 6/8/17 Distribution box installed + connected to trenches.

Need speed levelers. (SC) 6/9/17 Septic tank pumped, rear terracotta baffle is good.

Tank connected to D-box. Need baffle + speed levelers in D-box. (SC) 6/13/17 met

Garland Brian on site. Put brick in D-box as baffle, outlet pipes are level + no need

for speed levelers. Locking caps on observation pipes. (SC)

FINAL INSPECTOR Sarah Collins DATE OF APPROVAL 6/13/17

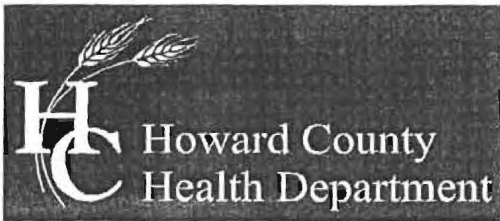

Bureau of Environmental Health
7178 Columbia Gateway Drive, Columbia, MD 21046-2147
Main: 410-313-2640 | Fax: 410-313-2648
TDD 410-313-2323 | Toll Free 1-866-313-6300
www.hchealth.org
Facebook: www.facebook.com/hocohealth
Twitter: HowardCoHealthDep

Maura J. Rossman, M.D., Health Officer

NOTICE OF VIOLATION

January 3, 2017

CERTIFIED MAIL: 70112970000303978500

Zafar & Akram Gill
13270 Highland Rd.
Highland, MD. 20777

RE: Sewage Overflow; Pollution of ground surface.
13270 Highland Rd., Tax Map 34 Grid 15 Parcel 229
REGULAR MAIL/CERTIFIED MAIL

Dear Mr. & Mrs. Gill,

A field review was conducted in relation to a citizen complaint regarding a sewage overflow on the subject property (Tax Map 34, Grid 15, Parcel 229), also known as 13270 Highland Road. Observation of the private sewage disposal system at the subject property on December 23, 2016, revealed that there is an ongoing surface discharge from the septic system that serves the existing residence.

The source of the discharge is a completely full drywell which is allowing overflow on the West side of the property in the backyard. The inspection revealed a very wet muddy area surrounding the cleanout for the drywell which indicates regular discharge.

Be advised that the observed sewage condition is in violation of the Code of Maryland Regulations (COMAR) 26.04.02.02(D): "A person may not dispose of sewage, body, or industrial wastes in any manner which may cause pollution of the ground surface, the waters of the State, or create a nuisance." This condition is also in violation of the Howard County Code 3.804(a)(1)&(3) and is a sewage overflow which is defined as a nuisance, Howard County Code 12.110(a).

You are hereby ordered to take the necessary actions to eliminate these on-going nuisance conditions on your property. You must immediately contact a licensed septic waste hauler to pump the drywell. You must apply for a septic system installation (repair) permit within 30 (thirty) days of the date on this notice. All soil surface areas that have been contaminated by sewage must also immediately be treated with anhydrous lime. Over the next month, the drywell must be serviced as often as needed so that further

surface discharge does not continue. The septic system must be properly repaired, and the installation (repair) permit approved by Health Department inspectors, within 45 (forty five) days of the date on this letter. The Howard County Health Department will conduct follow-up inspections to assure that actions are taken to correct and abate the nuisance condition and that the conditions do not recur. Failure to comply will result in the issuance of a civil citation(s). Under Howard County Code, paragraph 12.112, each day this violation is allowed to occur is considered a separate offense.

If you believe that the condition described above is not and could not be a hazard to health, or that the Health Department is not acting in compliance with pertinent laws and regulations, you may request a formal hearing before the Board of Health within 15 (fifteen) days of receipt of this letter. All requests are to be made in writing and directed to the Executive Secretary of the Board of Health at the above address.

For your convenience I've attached a list of licensed septic contractors that work in this area. If you have any questions regarding this letter, please contact me at 410-313-1773 or rrappaport@howardcountymd.gov.

Sincerely,



Ryan Rappaport, LEHS
Well & Septic Program
Groundwater Management Section

Copy: Executive Secretary, Board of Health

SENDER: COMPLETE THIS SECTION	COMPLETE THIS SECTION ON DELIVERY		RECEIPT (Postage Coverage Provided)
<ul style="list-style-type: none"> Complete items 1, 2, and 3. Also complete item 4 if Restricted Delivery is desired. Print your name and address on the reverse so that we can return the card to you. Attach this card to the back of the mailpiece, or on the front if space permits. 	A. Signature <input checked="" type="checkbox"/> Agent <input type="checkbox"/> Addressee	<input checked="" type="checkbox"/> Agent <input type="checkbox"/> Addressee	Visit us at www.usps.com
1. Article Addressed to: Zafar & Akram Gill 13270 Highland Rd. Highland, MD 20777	B. Received by (Printed Name) Humaira Gill	C. Date of Delivery 1/13	USE Postmark Here
2. Article Number (Transfer from service label)	D. Is delivery address different from item 1? <input type="checkbox"/> Yes If YES, enter delivery address below: <input type="checkbox"/> No		Gill Highland Rd. MD 20777
PS Form 3811, February 2004		3. Service Type <input type="checkbox"/> Certified Mail <input type="checkbox"/> Express Mail <input type="checkbox"/> Registered <input type="checkbox"/> Return Receipt for Merchandise <input type="checkbox"/> Insured Mail <input type="checkbox"/> C.O.D.	See Reverse for Instructions
Domestic Return Receipt		4. Restricted Delivery? (Extra Fee) <input type="checkbox"/> Yes	102595-02-M-1540
7011 2970 0003 0397 8500			

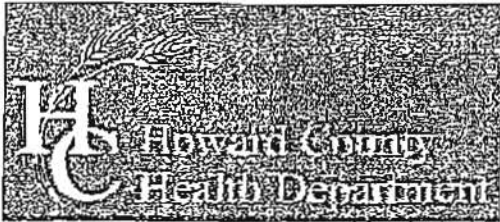

Bureau of Environmental Health

8930 Stanford Boulevard, Columbia, MD 21045
Main: 410-313-2640 | Fax: 410-313-2648
TDD 410-313-2323 | Toll Free 1-866-313-6300
www.hchealth.org

Facebook: www.facebook.com/hocohealth
Twitter: HowardCoHealthDep

Dr. Maura J. Rossman, M.D., Health Officer

INFORMATION FORM - SEPTIC SYSTEM REPAIR/UPGRADE

Reason for Request:

- Failing System
System relocation for proposed addition
System upgrade for proposed addition
Inadequate treatment zone
Collapsed septic tank
Collapsed drywell

Has the septic tank been pumped within the last month?

- Yes Date pumped: 12-29-16
No

Was a visual inspection of the septic tank and/or drain fields conducted?

- Yes Explain observations:
No

Was a visual inspection of the sewage line conducted?

- Yes
Blockage leading to the tank
Yes Explain:
No
Blockage leading to the field
Yes Explain:
No

Existing system design

- Drywell
Trench
Mound
Unknown
Other:

Is discharge surfacing on the ground?

- Yes No Longer surfacing as of 12-29-16
No

Additional Comments:

*For REPAIRS, are the owners proposing, or do they plan to add in the future, any additions or modifications to the property, i.e. pools, living space additions, garages, etc? This information must be disclosed at the time of this application. The Health Department will not be able to accommodate requests in the field for property modifications unrelated to the repair request. Such requests may require an additional fee, testing, and submittal of a Percolation Certification Plan, if the property does not meet current Code and Regulation.

Septic Contractor: Contractor's Phone:
Contractor's Address:

Property Address: 13270 Highland Rd, Highland MD 20777 County file:
Subdivision: Lot: Year Built:

Owner's Name: ZAFAR GILL Owner's Phone: 410-707-7381

Name of previous owners: Existing bedrooms: 3 Bedrooms
Proposed bedrooms: n/a

Has this request been previously discussed with a Sanitarian? (Name):
Public Sewer available/nearby:

*A Sanitarian will be in contact within three business days, depending upon the urgency of the situation, to coordinate the scheduling/review of the repair or upgrade.

Prior to scheduling inspections, scaled plans should be submitted to clarify the nature of the addition.

Print out a copy of Real Property Data via Dept. of Taxation website Indexed file found

If public sewer may be nearby, verify whether sewer is technically "available" through the Bureau of Engineering.

If sewer is available and the property is within the Metropolitan District, connection to sewer is required. If the owner believes reason for exemption exists, the owner should justify the request in writing.

If soil/site conditions are limited and sewer and/or Metro District status is not conducive to connection, the Sanitarian may recommend pursuit of Emergency Sewer Extension or Emergency Metro District Inclusion. The Owner should contact the Bureau of Utilities for details.

No permit is to be issued nor inspection to be scheduled without prior fee collection at the office unless an emergency situation exists. The contractor is to notify office of the emergency situation as soon as possible.

RECORD OF INVESTIGATION

Case #: Discharge 2016

LOCATION HIGHLAND ZIP 20777
 COMPLAINEE GILL ZAFAR ADDRESS 13270 HIGHLAND ROAD PHONE _____
 COMPLAINANT _____ ADDRESS _____ PHONE 3018543540
 REASON FOR INVESTIGATION Complainant stated that there is possibly 'wash water' coming from the home running into the street.

RECEIVED BY _____ DATE 12/22/16 ASSIGNED TO Rappaport, Ryan DATE _____

Date	Activity	Entered By	Comments
12/22/16	Assigned to San	rrappaport	
12/22/16	Responded-HStat	rrappaport	

4/24/16

A0551
P05089

12/22 - f/v met w/ homeowner/pics
Zafar Gill - 410-707-7381

12/23 - Spoke to Gill Zafar = will dye the system

12/23 - f/v dyed system - failing system in back - photos

12/25 - p/c from Complainant
 12/28 - Spoke about details -
 p/c to Zafar
 washer to tie to septic
 net swap.

Zafargill2016@qmail.com

750 gal.

$$V = \pi r^2 \times H = 954 \text{ cu. ft.}$$

$$\times 7.48$$

$$7,136 \text{ gal}$$

$$+ 750$$

$$\frac{7885 \text{ gal}}{16 \text{ oz} = 6000 \text{ gal}}$$

$$\frac{1}{4} = 1500 \text{ gal}$$

