

4/5/68 1-11-68

PERMIT

P 13495

A 11431

SEWAGE DISPOSAL SYSTEM

MARYLAND STATE DEPARTMENT OF HEALTH

HOWARD COUNTY

~~INDEXED~~

ELLCOTT CITY

DISTRICT 3

DATE 4/5/68

Emerson Feaga IS PERMITTED TO INSTALL ALTER
ADDRESS Triadelphia Rd., Ellicott City, Md. PHONE AT 6-2516
A SEWAGE DISPOSAL SYSTEM LOCATED AT _____

SUBDIVISION Green Henge ROAD 2891 Unnamed - Ordway LOT 12, Sec. 3
PROPERTY OWNER Carwell, Inc. Harris & Barbara Mager
ADDRESS _____

SPECIFICATIONS - 3 bedrooms

DRAIN FIELD _____ DEPTH _____ FEET, BOTTOM AREA _____ SQ. FT.

SEEPAGE PITS _____ ABSORBENT SIDE-WALL AREA _____ SQ. FT.

SEPTIC TANK CAPACITY 750 GALLONS

FOR GARBAGE GRINDER, INCREASE DISPOSAL AREA 22% & TANK CAPACITY 50%.

OTHER Two (2) dry wells - 150 sq. ft. each absorbent sidewall area below the inlet pipe at least 40 ft. apart measured edge to edge. First dry well to be located 45 ft. from front lot line and 70 ft. from left side lot line as seen when facing lot from Ordway Rd. Depth of dry wells to be no greater than 8 ft. below original grade. PERMIT VOID AFTER THREE YEARS.

PLANS APPROVED BY J. H. Kilmore DATE 3/28/67

FILL SEPTIC TANK AND DISTRIBUTION BOX WITH WATER BEFORE CALLING FOR AN INSPECTION. COVER NO WORK UNTIL INSPECTED AND APPROVED.

NEITHER THE HOWARD COUNTY COMMISSIONERS NOR THE HEALTH DEPARTMENT IS RESPONSIBLE FOR THE SUCCESSFUL OPERATION OF ANY SYSTEM.

ELDG. PERMIT SIGNED AND RETURNED 4/7/68
Dist # 13706 Doc

NOTIFY THE HEALTH DEPARTMENT 48 HOURS BEFORE EXCAVATIONS ARE TO BE BACK FILLED.

11431

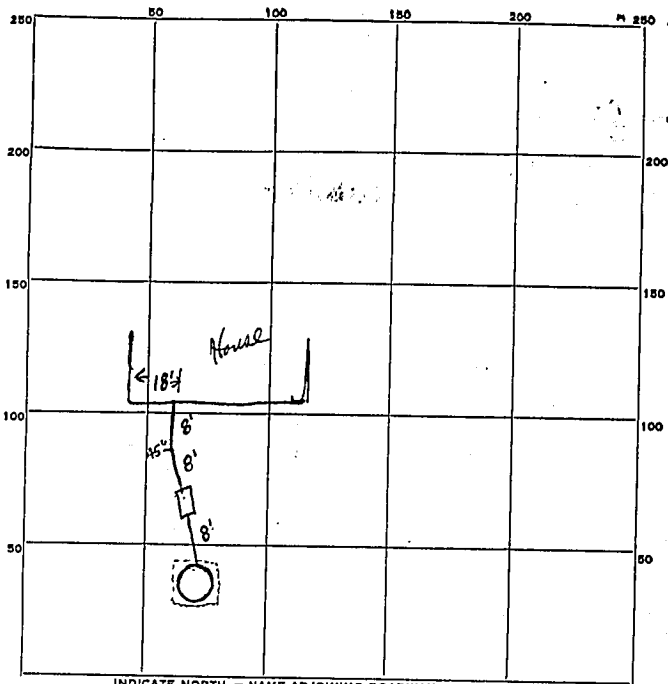

INDICATE NORTH. - NAME ADJOINING ROADWAY AS BASE LINE.

Unnamed Road

PERMIT CARD _____

SEPTIC TANK, LEVEL _____ _____ CLEANOUTS _____ _____

DISTRIBUTION BOX, LEVEL _____ _____

TILE FIELD, DEPTH _____ FT. TRENCH WIDTH _____ FT.

GRAVEL DEPTH _____ IN. TOTAL LENGTH _____ FT.

NUMBER OF TRENCHES _____ TOTAL BOTTOM AREA _____

SEEPAGE PITS, ~~INSIDE~~ DIAMETER 10 FT. DEPTH BELOW INLET 9 FT.

ABSORBENT AREA 350 + SQ. FT.

REMARKS lid 2' underground at low side toward road, 3 1/2 to 4' at high side.
how are we to know where water table is. H.

DATE SYSTEM APPROVED 4-11-68 INSPECTOR F. Trummel

APPLICATION

A 11431
P _____

SEWAGE DISPOSAL TESTING

MARYLAND STATE DEPARTMENT OF HEALTH

HOWARD COUNTY

ELLICOTT CITY

3 bedrooms - Septic Tank - 7500 gallons,
 2 dry wells, 150 sq. ft. each at least 40 ft apart
 measured edge to edge. First dry well to be located
 45 ft from front lot line and 70 ft. from left side lot line
 as seen when facing lot from Unnamed Rd. Depth of dry wells
 to be no greater than 8 ft below original grade

4 bedrooms - Septic Tank - 1000 gallons, absorbent sidewall area below the inlet pipe
 2 dry wells - 200 sq. ft each at least 40 ft. apart measured edge
 to edge and no deeper than 9 ft. below original grade located
 same as above.

TO: THE COUNTY HEALTH OFFICER
 ELLICOTT CITY, MARYLAND

DISTRICT 3
DATE 1/20/66

I, HEREBY, APPLY FOR THE NECESSARY TESTS IN ORDER TO CONSTRUCT (OR RECONSTRUCT) A SEWAGE DISPOSAL SYSTEM.

PROPERTY OWNER Carwell, Inc.

ADDRESS Chatham Road, Ellicott City, Md. PHONE HO 5-2677

PROPERTY LOCATION:

SUBDIVISION Green Henge LOT NO. 12, Sec. 3

ROAD AND DESCRIPTION Unnamed Road

OCCUPANT _____ PHONE _____

PERSON TO CONSTRUCT SYSTEM _____

ADDRESS _____ PHONE _____

SIZE OF LOT 167' x 275' x 235' x 137' TYPE BLDG. 3 or 4
NUMBER OF BEDROOMS

IF NOT SINGLE RESIDENCE DESCRIBE _____

SIGNATURE OF APPLICANT /s/ Carl G. Hall, President

APPROVED BY J. H. Kalbore FOR 1/20/66 DATE 1/20/66
KIND OF SYSTEM

REJECTED BY _____ FOR _____ DATE _____
KIND OF SYSTEM

HOLD PENDING FURTHER TESTS _____ DATE _____

REASONS FOR REJECTION OR HOLDING _____

THIS IS NOT A PERMIT

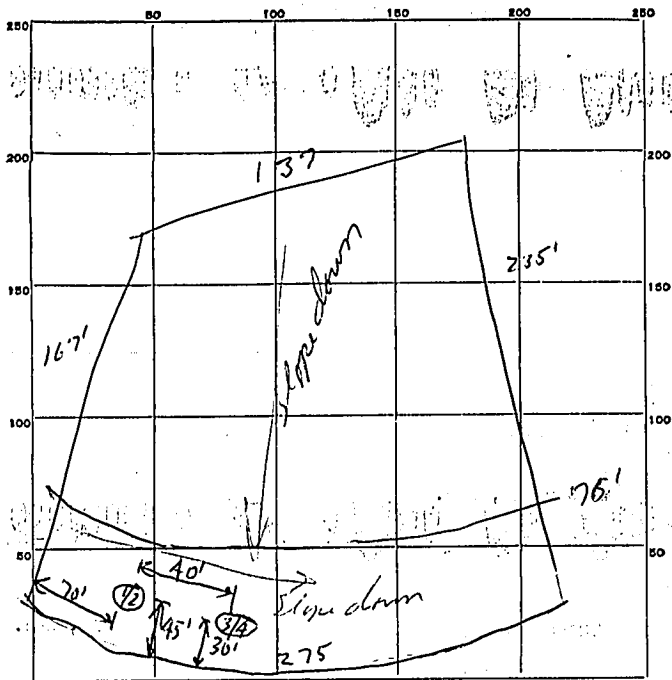

INDICATE NORTH. - NAME ADJOINING ROADWAY AS BASE LINE.

Unnamed Rd.

DATE	TEST NO.	DEPTH	PRE-WET		TEST - 1" DROP		TIME
			START	STOP	START	STOP	
1/21/66	1	5 ft.	10:26	10:27	10:27	10:29	2 min
	2	9 ft.	10:26	10:27	10:27	10:29	2 min.
	3	4 1/2 ft.	10:31	10:35	10:35	10:45	10 min.
	4	9 ft.	10:32	10:37	10:37	10:47	10 min

4124
L

SOIL AUGER FINDING 1/2 hole 1/2 (highest better piece)
 TESTED BY RIPF 1/21/66 Rig down to 13 ft in hole # 3/4
JHR

#12
Sec. 3

REMARKS ~~Station deep well~~ 3 shallow dry wells

THIS REPORT
MUST BE SUBMITTED
WITHIN 30 DAYS
AFTER COMPLETION
OF THE WELL

A11431

WELL COMPLETION REPORT

WELL DESCRIPTION

WELL LOG State the kind of formations penetrated, their color, their depth, their thickness, and if water-bearing	CASING AND SCREEN RECORD State the kind and size and position of casing, liner, shoe, screen, and other accessories (if no casing used, give diameter of well).		
FEET from ___ to ___	FEET from ___ to ___	DIAM. (inches)	FEET from ___ to ___
	37 ft. casing		
	Gray Rock		
	well 65 ft		

Permit Number No 28 W 127
 Owner J. Philip Ferris
 Address Greenway
 Subdivision Greenway
 Section _____ Lot 12

PUMPING TEST
 Hours Pumped 1
 Type of Pump Used Booster
 Pumping Rate _____
 Gallons per Minute 5

WATER LEVEL
 Distance from land surface to water:
 Before Pumping 40 Ft.
 When Pumping 50 Ft.

APPEARANCE OF WATER
 Clear Partly Cloudy
 Taste None
 Odor None

Height of Casing Above Land
 Surface 2 Ft.

PUMP INSTALLED
 Type _____
 Capacity _____
 Gallons per Minute _____
 Gallons per Hour _____
 Pump Column Length _____ Ft.

LOCATION OF WELL ON LOT
 Show permanent structures such as building(s), septic tank, and/or other landmarks and indicate not less than 2 distances (measurements) to well.

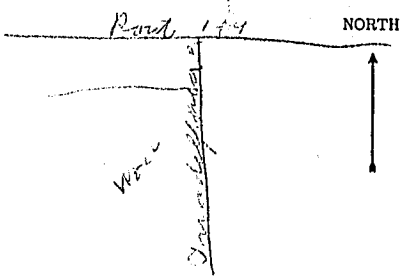

Date Well Was Completed March 3 1964
 Well Driller Signature Deany Brown

FENCE DATA:
 4' HIGH PICKET
 FENCE W/WIRE AS PER
 CODE (BY OWNER)

NO IMPACT ON
 WELL ON
 8/7/82

320 ±

202 ±

70 ±

5310.9 ± W.
 548.00

Ex. WELL

Ex. SEPTIC
 TANK

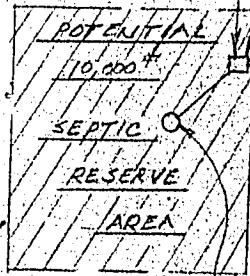

65 ±

105 ±

65 ±

(FLAGGED ACCESS)

NOTE:

SEPTIC AREA AS PER
 CONVERSATION AGREEMENT
 W/ CRAIG WILLIAMS, DIR. OF
 WATER & SEWER PROGRAM,
 HOWARD COUNTY

207.48'

N 58° 50' 52" W.

193.00'

N 57° 31' 00" W.

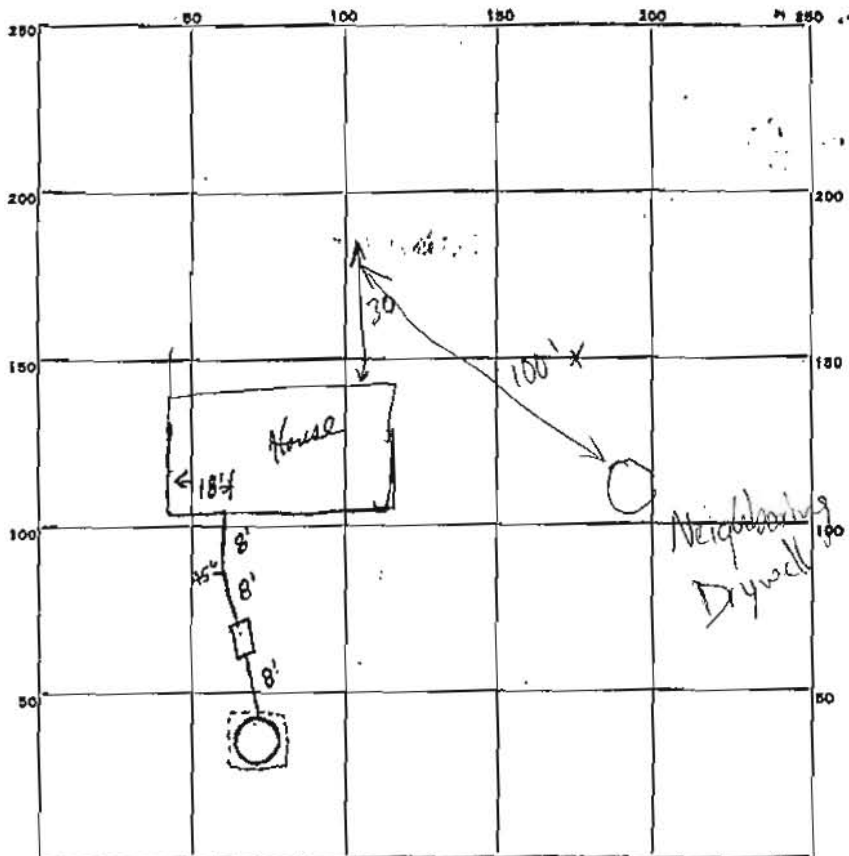

INDICATE NORTH - NAME ADJOINING ROADWAY AS BASE LINE.

named Road

PERMIT CARD _____

SEPTIC TANK, LEVEL _____ _____ CLEANOUTS _____ _____

DISTRIBUTION BOX, LEVEL _____

TILE FIELD, DEPTH _____ FT. TRENCH WIDTH _____ FT.

GRAVEL DEPTH _____ IN. TOTAL LENGTH _____ FT.

NUMBER OF TRENCHES _____ TOTAL BOTTOM AREA _____

SEEPAGE PITS, INLET DIAMETER 10 FT. DEPTH BELOW INLET 9 FT.

ABSORBENT AREA 350 + SQ. FT.

REMARKS Cell 2' underground at low side toward road, 1/2 to 4' at high side.
how are we to know where water table is. etc.

DATE SYSTEM APPROVED 4-11-68 INSPECTOR F. Frommelt

