

LAYOUT 6/23/08 INSP 4 _____
INSP 2 6/24/08 INSP 5 _____
INSP 3 _____ INSP 6 _____

ISSUE DATE: 6/23/2008

PERMIT

P 529455

APPROVAL DATE: 6/24/08

A 528985

ON-SITE SEWAGE DISPOSAL SYSTEM HOWARD COUNTY HEALTH DEPARTMENT BUREAU OF ENVIRONMENTAL HEALTH

J M Contracting LLC IS PERMITTED TO INSTALL ALTER

ADDRESS: 425 Obrecht Road, Sykesville PHONE NUMBER: 443-277-7526

SUBDIVISION: _____ LOT NUMBER: _____

ADDRESS: 2530 Pfefferkorn Road PROPERTY OWNER: Debra Burnt

SEPTIC TANK CAPACITY (GALLONS): 1500 OUTLET BAFFLE FILTER REQUIRED

PUMP CHAMBER CAPACITY (GALLONS): _____ COMPARTMENTED TANK REQUIRED

NUMBER OF BEDROOMS: 4

SQUARE FEET PER BEDROOM: _____

LINEAR FEET OF TRENCH REQUIRED: 165'

*Inlet 5'
Bottom 4'
2' wide.*

TRENCHES:	Trench to be 2.0 feet wide. Inlet 5.0 feet below original grade. Bottom maximum depth <u>9</u> feet below original grade. Effective area begins at 6.5 feet below original grade. <u>4.0</u> feet of stone below distribution pipe.
LOCATION:	Trench Layout to be given out in field.
NOTES:	Ex S.T. and D.W. to be pumped and collapsed.

PLANS APPROVED: KW DATE: 6/20/2008

- NOTE: PERMIT VOID AFTER 2 YEARS
- NOTE: CONTRACTOR RESPONSIBLE FOR SCHEDULING A PRE-CONSTRUCTION INSPECTION FOR ALL INSTALLATIONS
- NOTE: WATERTIGHT SEPTIC TANKS REQUIRED
- NOTE: ALL PARTS OF SEPTIC SYSTEM SHALL BE 100 FEET FROM ANY WATER WELL
- NOTE: MANHOLE RISERS REQUIRED ON ALL SEPTIC TANKS AND PUMP CHAMBERS UNLESS SPECIFICALLY AUTHORIZED

NEITHER THE HOWARD COUNTY COUNCIL NOR THE HEALTH DEPARTMENT IS RESPONSIBLE FOR THE SUCCESSFUL OPERATION OF ANY SYSTEM PERMITTEE RESPONSIBLE FOR OBTAINING FINAL APPROVAL ON THIS PERMIT CALL 410-313-2640 FOR INSPECTION OF SEPTIC SYSTEM

*90'
75'*

HO-73-2287

NOT TO SCALE

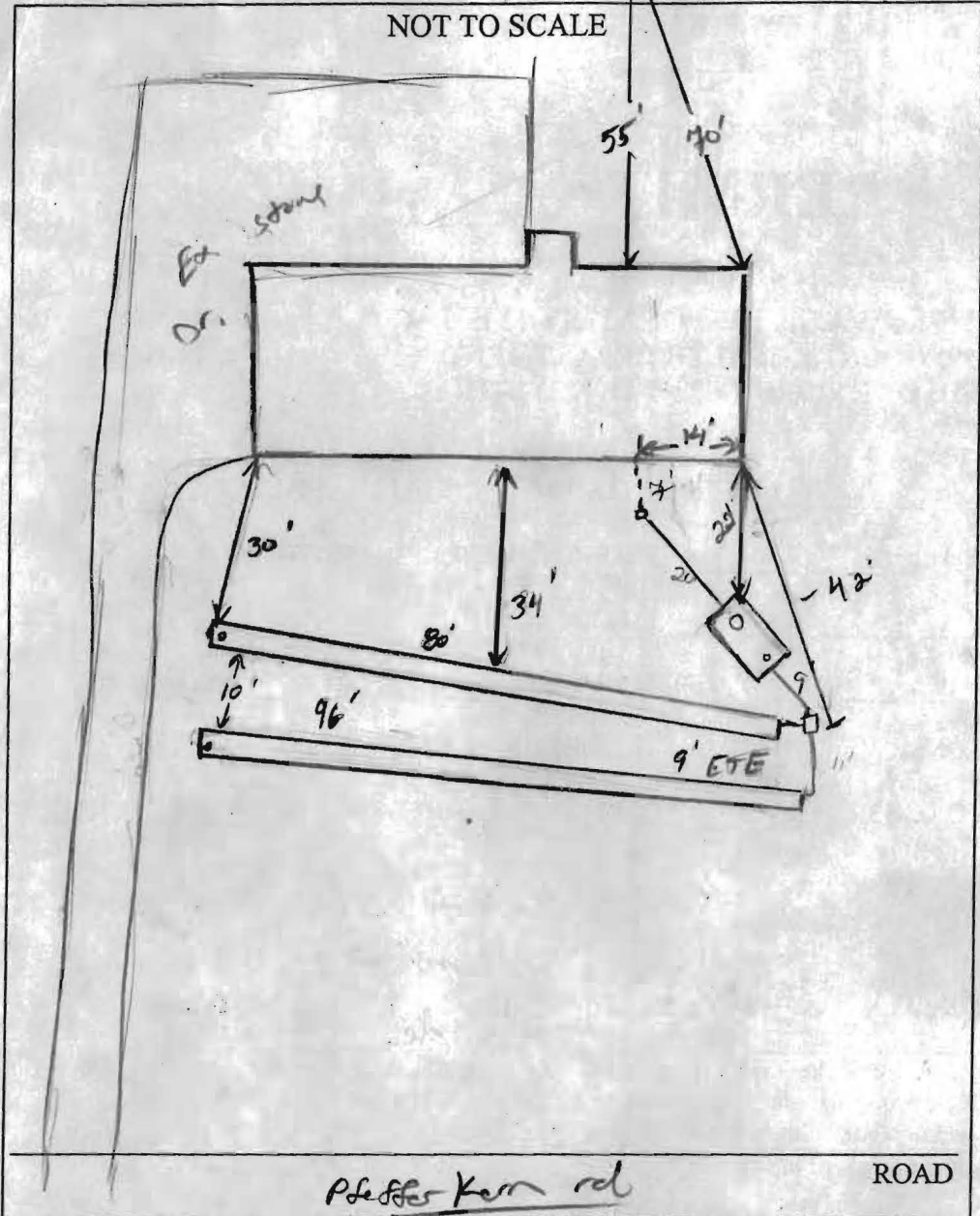

TRENCH/DRAINFIELD DATA		
WIDTH	INLET	BOTTOM
2'	5'	9'
NUMBER OF TRENCHES		2
TOTAL LENGTH		176'
ABSORPTION AREA		352 \pm SW
DISTRIBUTION BOX LEVEL		Leveler
DISTRIBUTION BOX BAFFLE		Yes
DISTRIBUTION BOX PORT		no

SEPTIC TANK DATA	
SEPTIC TANK 1 LEVEL	Yes
CAPACITY	1500 GAL
SEAM LOC	Top
TANK LID DEPTH	1.5'
BAFFLES	Yes
BAFFLE FILTER	-
MANHOLE LOC	Front
6" PORT LOC	Rear
WATERTIGHT TEST	-
SEPTIC TANK 2 LEVEL	
CAPACITY	_____ GAL
SEAM LOC	_____
TANK LID DEPTH	_____
BAFFLES	_____
BAFFLE FILTER	_____
MANHOLE LOC	_____
6" PORT LOC	_____
WATERTIGHT TEST	_____

Babylon
deep
slotted

PRE-CONSTRUCTION 6/23/08 Install a 45' and 90' diameter on center
1500g ST. acceptable. Met w/ homeowner and explained possible
INSTALLATION expectations of HD if additions to base are to be made
6/24/08 System complete. OK to backfill (TSW) (TSW)

FINAL INSPECTOR J. Hall DATE OF APPROVAL 6/24/08