

6/20/97  
10:00  
9/19/97 2/10/00

# PERMIT

## SEWAGE DISPOSAL SYSTEM

### DEPARTMENT OF HEALTH AND MENTAL HYGIENE

P 58535-B

A \_\_\_\_\_

DISTRICT \_\_\_\_\_

DATE 06/23/97

DATE SYSTEM APPROVED 9/16/97

INSPECTOR *SH*

HOWARD COUNTY HEALTH DEPARTMENT  
BUREAU OF ENVIRONMENTAL HEALTH  
410-313-2640

#03-297683  
INDEXED

Jack Fyock Septic Services IS PERMITTED TO INSTALL \_\_\_\_\_ ALTER

ADDRESS P. O. Box 89 Triadelphia, Glenelg, Md 21737 PHONE 410-988-9270

SUBDIVISION \_\_\_\_\_ LOT \_\_\_\_\_ ROAD 3150 Pfefferkorn Road

PROPERTY OWNER Trobridge Tax Map: 15 P. 153

ADDRESS 3150 Pfefferkorn Road  
West Friendship, Maryland 21794

SEPTIC TANK CAPACITY 1250 GALLONS \*NO property records found\*

NUMBER OF BEDROOMS 4

180 SQUARE FEET PER BEDROOM

LINEAR FEET OF TRENCH REQUIRED 240 (OR AS MUCH AS POSSIBLE)

REPAIR - PURPOSE - SEPTIC SYSTEM HAS FAILED.  
Call for inspection when ground is opened so sanitarian can recommend repair.  
06/23/97

Trenches to be 3' wide. inlet 2', bottom 3.5', stone 1.5'.  
Trenches w/dist box to run along side of house,  
just uphill from failing system. Trenches to run  
in both directions. Failing system to be abandoned.

PLANS APPROVED BY *Julie K. [Signature]* DATE 6/26/97

- COVER NO WORK UNTIL INSPECTED AND APPROVED
- NEITHER THE HOWARD COUNTY COUNCIL NOR THE HEALTH DEPARTMENT IS RESPONSIBLE FOR THE SUCCESSFUL OPERATION OF ANY SYSTEM
- NOTE: CLEANOUT REQUIRED EVERY 70 FEET OF SEWER LINE AND/OR AT 90° SWEEPS IN LINES FROM HOUSE TO DRAIN FIELDS, 90° ELBOWS NOT ACCEPTABLE.
- NOTE: ALL PARTS OF SEPTIC SYSTEMS (I.E. TANK, DISTRIBUTION BOX TRENCHES) TO BE 100 FEET FROM WELL (UNLESS OTHERWISE SPECIFICALLY AUTHORIZED)
- NOTE: IF DEEP TRENCH(ES) ARE USED CALL FOR INSPECTION BEFORE AND AFTER PLACING GRAVEL IN TRENCH(ES)
- NOTE: NO DRY WELL SHALL EXCEED 15 FOOT IN DIAMETER NO ABSORPTION TRENCH TO EXCEED 100 FEET IN LENGTH
- NOTE: ALL PIPE FROM HOUSE TO SEPTIC TANK MUST BE CAST IRON OR SCHEDULE 35/40 PVC OR ABS
- PERMIT VOID AFTER TWO YEARS
- NOTE: INSTALL STAND PIPE ON SEPTIC TANK AND DRY WELL STAND PIPES MUST BE 6 INCHES IN DIAMETER CAST IRON. CONCRETE OR TERRA COTTA OR PVA OR ABS ACCEPTED. IF TOP OF SEPTIC TANK IS DEEPER THAN 3 FEET. MANHOLE TO GRADE REQUIRED.
- NOTE: DISTRIBUTION BOXES MUST HAVE BAFFLES

**\*INSTALLER IS RESPONSIBLE FOR OBTAINING FINAL APPROVAL ON THIS PERMIT**  
\*CALL 461-9933 FOR INSPECTION OF SEPTIC SYSTEM.

P 58535-B

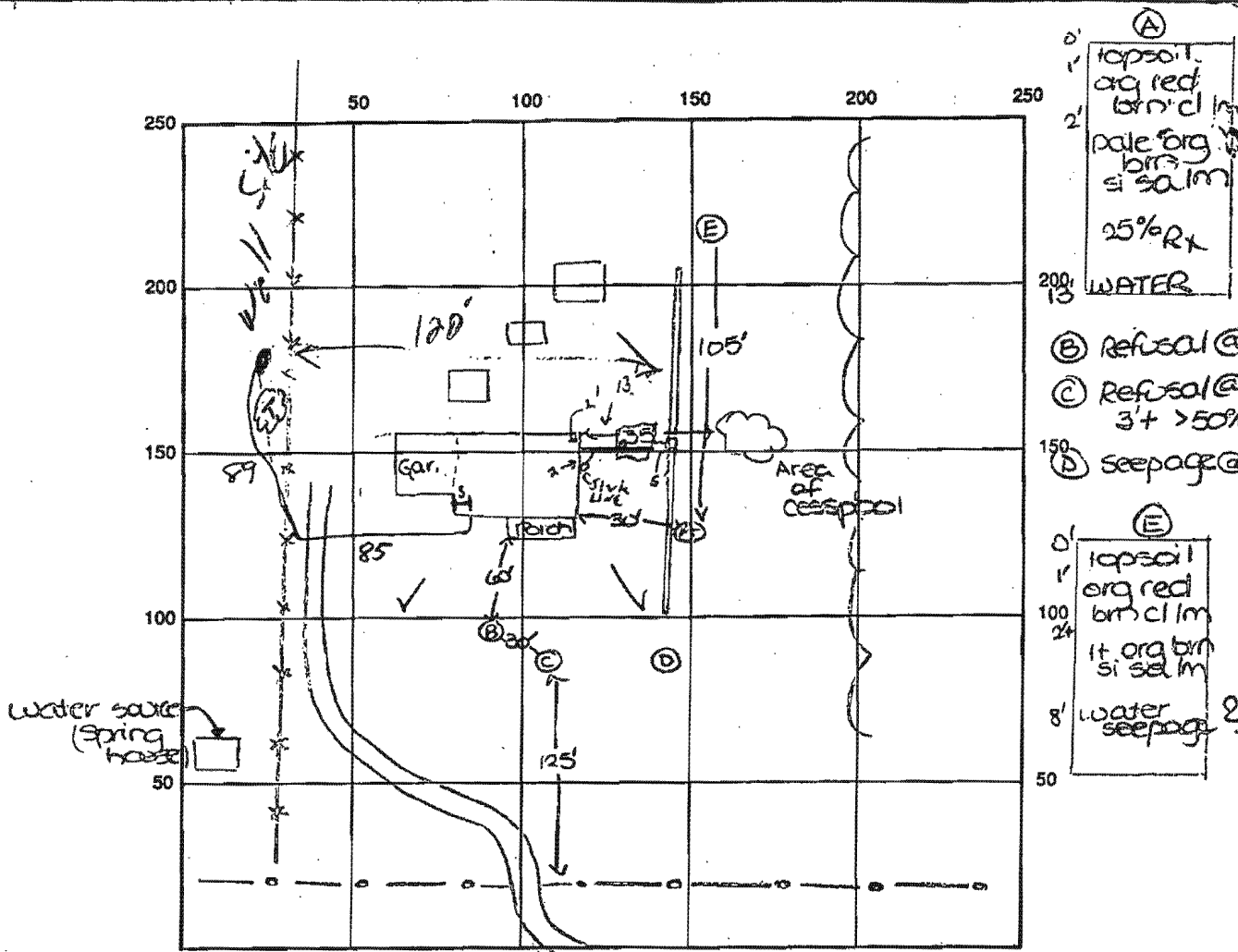

INDICATE NORTH - NAME ADJOINING ROADWAY AS BASE LINE  
Pfefferkorn Road

SEPTIC TANK LEVEL OK - 12.50 CLEANOUTS 1 ON TANK, 1 AT WALL ON SPK LINE

DISTRIBUTION BOX LEVEL OK

DRAIN FIELD/TITLE DEPTH 3.5-4.5 FT. TRENCH WIDTH 3 FT. INLET DEPTH 2 FT.

EFFECTIVE GRAVEL DEPTH 1.5-2.5 FT. TOTAL LENGTH 2 x 65 FT. = 130

NUMBER OF TRENCHES 2 ONE SIDEWALL/BOTTOM AREA 390 SQ. FT.

DRYWALL INSIDE DIAMETER — FT. EFFECTIVE DEPTH BELOW INLET — FT.

ABSORBENT AREA — SQ. FT.

REMARKS: 9/16/97 OK TO COVER WORK. JH

DATE SYSTEM APPROVED 9/16/97 INSPECTOR [Signature]

