

6/10/82
between 10 am & 12 noon
6/11/82

0/11/82 Appd J.W.

PERMIT

P 31968

SEWAGE DISPOSAL SYSTEM

A REPAIR

MARYLAND STATE DEPARTMENT OF HEALTH

HOWARD COUNTY

05-362393

ELLICOTT CITY

DISTRICT _____

INDEX

DATE 6/8/82

Zepp Plumbing & Heating

IS PERMITTED TO INSTALL _____ ALTER X

ADDRESS 6344 Ten Oaks Rd., Clarksville, Md. 21029 PHONE 531-6712

SUBDIVISION Pembrook Knolls ROAD 6924 Pendell Sch. Rd. LOT _____
(OWENS or Rooney original owner) 18 yr. old.

PROPERTY OWNER Mr. Kevin Rodden

ADDRESS 6924 Pendell Sch. Rd., Fulton, Md. 20759

SPECIFICATIONS

SEPTIC TANK CAPACITY _____ GALLONS
DRAIN FIELD _____ DEPTH _____ FEET, BOTTOM AREA _____ SQ. FT.
DEEP TRENCH _____ DEPTH _____ FEET, BOTTOM AREA _____ SQ. FT.
SEEPAGE PITS _____ ABSORBENT SIDE-WALL AREA _____ SQ. FT.
INLET PIPE _____ FT. BELOW ORIGINAL GRADE. MAXIMUM DEPTH _____ FT. BELOW ORIGINAL GRADE
EFFECTIVE DEPTH AT _____ FT. BELOW ORIGINAL GRADE.
LOCATE DISPOSAL AREA _____ FT. FROM _____ LOT LINE AND _____ FT. FROM _____ LOT LINE AS SEEN WHEN
FACING LOT FROM

REPAIR - CALL FOR INSPECTION WHEN GROUND IS OPENED UP SO SANITARIAN CAN RECOMMEND REPAIR.

PLANS APPROVED BY Palmer F. Wine DATE June 8, 1982

COVER NO WORK UNTIL INSPECTED AND APPROVED.
NEITHER THE HOWARD COUNTY COUNCIL NOR THE HEALTH DEPARTMENT IS RESPONSIBLE FOR THE SUCCESSFUL OPERATION OF ANY SYSTEM.
NOTE: IF TRENCH IS USED CALL FOR INSPECTION BEFORE PLACING GRAVEL IN TRENCH.
NOTE: NO DRY WELL SHALL EXCEED 15 FOOT IN DIAMETER.
NOTE: ALL PIPE FROM HOUSE TO DISPOSAL AREA MUST BE CAST IRON.
PERMIT VOID AFTER THREE YEARS.
NOTE: INSTALL STAND PIPE ON SEPTIC TANK AND DRY WELL. STAND PIPES MUST BE 6 INCHES IN DIAMETER. CAST IRON, CONCRETE OR TERRA COTTA ACCEPTED.

*INSTALLER IS RESPONSIBLE FOR OBTAINING FINAL APPROVAL ON THIS PERMIT.

BUDG. PERMIT SIGNED
AND RETURNED 6/15/82
Serial # 32723 - decl

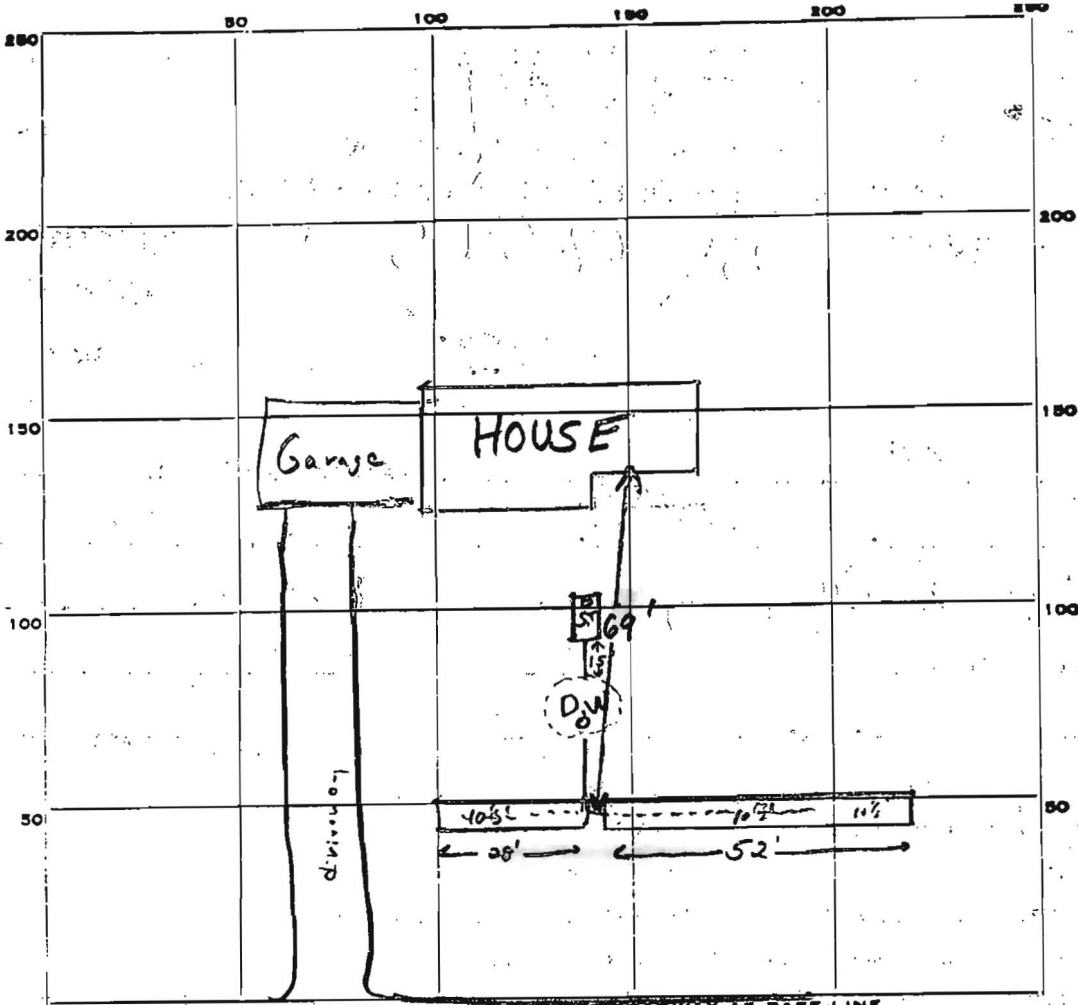

INDICATE NORTH. NAME ADJOINING ROADWAY AS BASE LINE.
Pindell School Rd.

PERMIT CARD

SEPTIC TANK, LEVEL existing

S.T.	D.W.
CLEANOUTS <u>existing</u>	<u>replaced</u> ✓

DISTRIBUTION BOX, LEVEL n.a.

TILE FIELD, DEPTH 10 1/2 FT. TRENCH WIDTH 2 FT.

GRAVEL DEPTH 8 FT. TOTAL LENGTH 80 FT.

NUMBER OF TRENCHES 2 ONE SIDEWALL TOTAL BOTTOM AREA 600 #

SEEPAGE PITS, INSIDE DIAMETER n.a. FT. DEPTH BELOW INLET 7 1/2 FT.

ABSORBENT AREA ± 600 SQ. FT.

REMARKS 6/10/82 28' trench dug an. to add pipe to ground in it 6/11/82 O.K. to put gravel in 2nd trench
6/11/82 OK to conceal work

DATE SYSTEM APPROVED 6/11/82

INSPECTOR F. Skinner