

PUBLIC SEWER STATUS VERIFIED BY RB

ISSUE DATE: 6/22/2011

# PERMIT

P 535272

APPROVAL DATE: 7/15/2011

A REPAIR

## Septic Repair

PROPERTY ID# 4318692

### ON-SITE SEWAGE DISPOSAL SYSTEM HOWARD COUNTY HEALTH DEPARTMENT BUREAU OF ENVIRONMENTAL HEALTH

FOGLE'S SEPTIC CLEAN, INC. IS PERMITTED TO INSTALL  ALTER

ADDRESS: 580 OBRECHT ROAD, SYKESVILLE 21784 PHONE NUMBER: 410-795-5670

SUBDIVISION: MT. AIRY LOT NUMBER: 9

ADDRESS: 16428 OLD FREDERICK ROAD PROPERTY OWNER: TOM THRASER

SEPTIC TANK CAPACITY (GALLONS): 1000 *Trenches 2' Wide*

PUMP CHAMBER CAPACITY (GALLONS): \_\_\_\_\_ *Inlet 5', Bottom 10.5'*

NUMBER OF BEDROOMS: 3 *Two 83' Trenches*

SQUARE FEET OF HOUSE: \_\_\_\_\_

LINEAR FEET OF TRENCH REQUIRED: 166'

TRENCHES:	
LOCATION:	
PURPOSE:	REPAIR/REPLACE FAILING SEPTIC SYSTEM.

PLANS APPROVED: B. Baker DATE: 7/13/2011

- NOTE: PERMIT VOID AFTER 2 YEARS
- NOTE: CONTRACTOR RESPONSIBLE FOR SCHEDULING A PRE-CONSTRUCTION INSPECTION FOR ALL INSTALLATIONS
- NOTE: WATERTIGHT SEPTIC TANKS REQUIRED
- NOTE: ALL PARTS OF SEPTIC SYSTEM SHALL BE 100 FEET FROM ANY WATER WELL
- NOTE: MANHOLE RISERS REQUIRED ON ALL SEPTIC TANKS AND PUMP CHAMBERS
- NOTE: AN ELECTRICAL PERMIT IS REQUIRED FOR INSTALLATION OF ANY ELECTRICAL COMPONENTS OF THE SYSTEM

**NEITHER THE HOWARD COUNTY COUNCIL OR THE HEALTH DEPARTMENT IS RESPONSIBLE FOR THE SUCCESSFUL OPERATION OF ANY SYSTEM PERMITTEE RESPONSIBLE FOR OBTAINING FINAL APPROVAL ON THIS PERMIT CALL 410-313-1771 FOR INSPECTION OF SEPTIC SYSTEM**

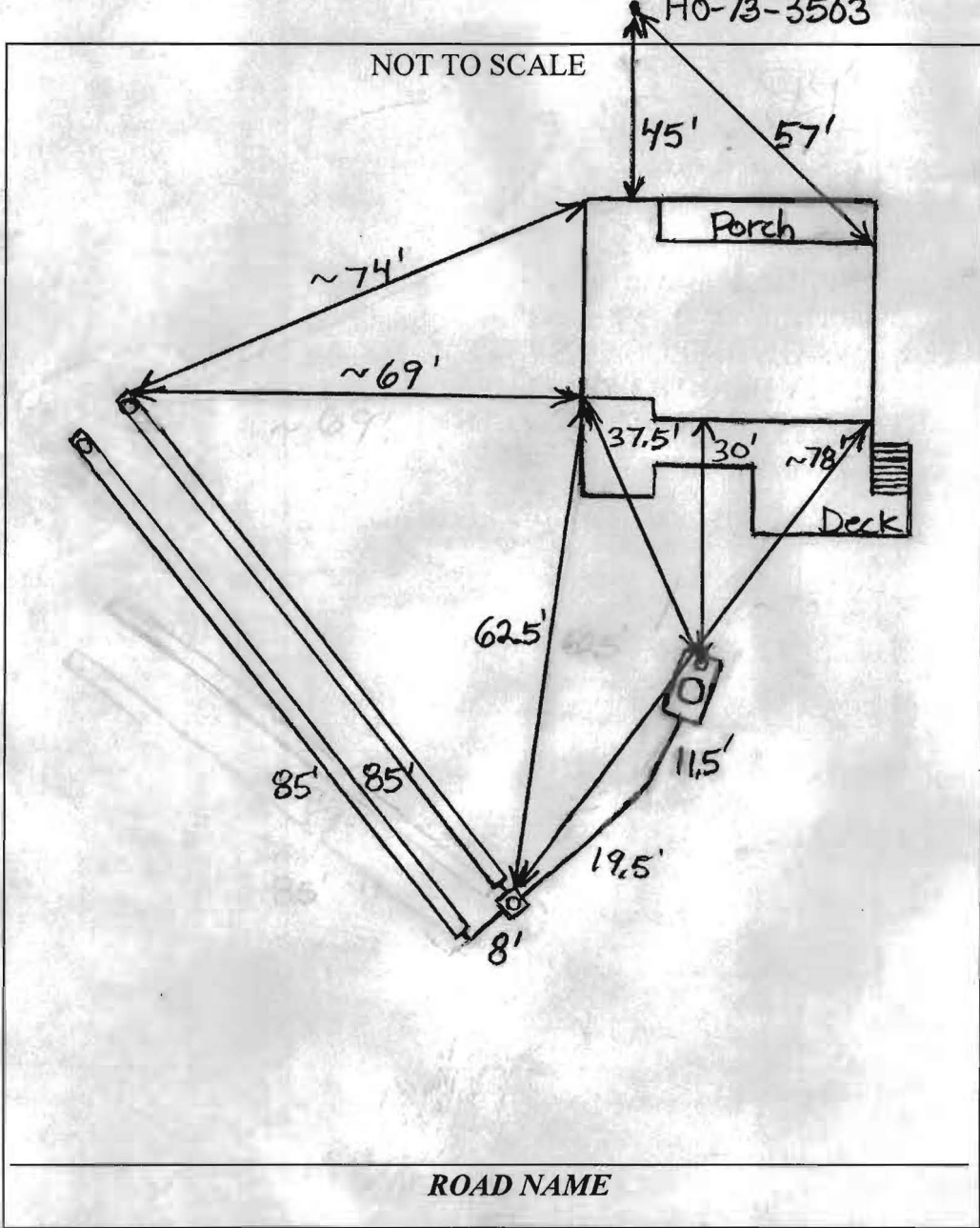

TRENCH/DRAINFIELD DATA		
WIDTH	INLET	BOTTOM
2'	5'	10.5'
NUMBER OF TRENCHES		2
TOTAL LENGTH		170'
ABSORPTION AREA		510
DISTRIBUTION BOX LEVEL		Levelers
DISTRIBUTION BOX BAFFLE		Yes
DISTRIBUTION BOX PORT		Yes

SEPTIC TANK DATA	
SEPTIC TANK I LEVEL	Yes
MANUFACTURER	N/A
CAPACITY	1000? GAL
SEAM LOC	Midseam
TANK LID DEPTH	25-3'
BAFFLES	Yes
BAFFLE FILTER	No
MANHOLE LOC	Middle
6" PORT LOC	Front
WATERTIGHT TEST	
SLOTTED	No
DATE ON LID	N/A
<del>PUMP/SEPTIC TANK LEVEL N/A</del>	
<del>MANUFACTURER</del>	
<del>CAPACITY</del> GAL	
<del>SEAM LOC</del>	
<del>TANK LID DEPTH</del>	
<del>BAFFLES</del>	
<del>BAFFLE FILTER</del>	
<del>MANHOLE LOC</del>	
<del>6" PORT LOC</del>	
<del>WATERTIGHT TEST</del>	
<del>SLOTTED</del>	
<del>DATE ON LID</del>	

PRE-CONSTRUCTION: 7/13/2011 Install two 83' trenches on contour above test hole (A) and outside of 100' well radius. Pump out and fill drywell with dirt. (BB)

INSTALLATION: 7/15/2011 System completed. O.K. to backfill. (BB)

FINAL INSPECTOR B. Baker DATE OF APPROVAL 7/15/2011