

NOON 3/2/80

Tap ID - 02-22683

# PERMIT

P 45097

A REPAIR

SEWAGE DISPOSAL SYSTEM

MARYLAND STATE DEPARTMENT OF HEALTH

DISTRICT \_\_\_\_\_

HOWARD COUNTY  
BUREAU OF ENVIRONMENTAL HEALTH  
461-9933

## INDEXED

DATE 3/28/91

DATE SYSTEM APPROVED 3/8/90

INSPECTOR Mark Rifkin

Olen Ketterman

IS PERMITTED TO INSTALL \_\_\_\_\_ ALTER

ADDRESS 14960 Route 144, Woodbine, Maryland 21797 PHONE 442-1336

SUBDIVISION Kefauver Property ROAD 8507 Old Frederick Rd LOT 4 - Existing House

PROPERTY OWNER Emerson Kefauver John Wellham

ADDRESS \_\_\_\_\_

IF GARBAGE GRINDER IS USED INCREASE SEPTIC TANK CAPACITY BY 50% AND ABSORPTION AREA BY 25%.

GARBAGE GRINDER  YES  NO

SEPTIC TANK CAPACITY 1500 GALLONS NUMBER OF BEDROOMS 5

TRENCHES - 180 sq. ft. per bedroom. Trench to be 3 feet wide. Inlet 4 feet below original grade. Bottom maximum depth 6 feet below original grade. Effective area begins at 4 feet below original grade. 2 feet of stone below distribution pipe.

LOCATION - Starting from front right lot corner, place distribution box 300 feet down right lot line and 100 feet off this same lot line. Run trenches on contour toward front of lot. MAINTAIN 20 FEET FROM HOUSE.

NOTE - No trench to exceed 100 feet in length. Provide 6" - 8" diameter cleanout and cap to grade or above on septic tank. 2-28-90 JEN

PLANS APPROVED BY Mark Rifkin DATE 1/18/90

COVER NO WORK UNTIL INSPECTED AND APPROVED

NEITHER THE HOWARD COUNTY COUNCIL NOR THE HEALTH DEPARTMENT IS RESPONSIBLE FOR THE SUCCESSFUL OPERATION OF ANY SYSTEM.

NOTE: CLEANOUT REQUIRED EVERY 70 FEET OF SEWER LINE AND/OR AT 90° SWEEPS IN LINES FROM HOUSE TO DRAIN FIELDS

NOTE: ALL PARTS OF SEPTIC SYSTEMS (I.E., TANK, DISTRIBUTION BOX, TRENCHES) TO BE 100 FEET FROM WELL (UNLESS OTHERWISE SPECIFICALLY AUTHORIZED)

NOTE: IF DEEP TRENCHES ARE USED CALL FOR INSPECTION BEFORE AND AFTER PLACING GRAVEL IN TRENCHES

NOTE: NO DRY WELL SHALL EXCEED 15 FOOT IN DIAMETER NO ABSORPTION TRENCH TO EXCEED 100 FEET IN LENGTH.

NOTE: ALL PIPE FROM HOUSE TO SEPTIC TANK MUST BE CAST IRON OR SCHEDULE 40 PVC OR ABS PERMIT VOID AFTER TWO YEARS

NOTE: INSTALL STAND PIPE ON SEPTIC TANK AND DRY WELL. STAND PIPES MUST BE 6 INCHES IN DIAMETER. CAST IRON, CONCRETE OR TERRA COTTA OR PVC OR ABS ACCEPTED. IF TOP OF SEPTIC TANK IS DEEPER THAN 3 FEET, MANHOLE TO GRADE REQUIRED

NOTE: DISTRIBUTION BOXES MUST HAVE BAFFLES

BLDG. PERMIT SIGNED AND RETURNED 10/21/93  
Serial # 50967  
Storage Shed

P  
45097

**\*INSTALLER IS RESPONSIBLE FOR OBTAINING FINAL APPROVAL ON THIS PERMIT**

\*CALL 461-9933 FOR INSPECTION OF SEPTIC SYSTEMS.

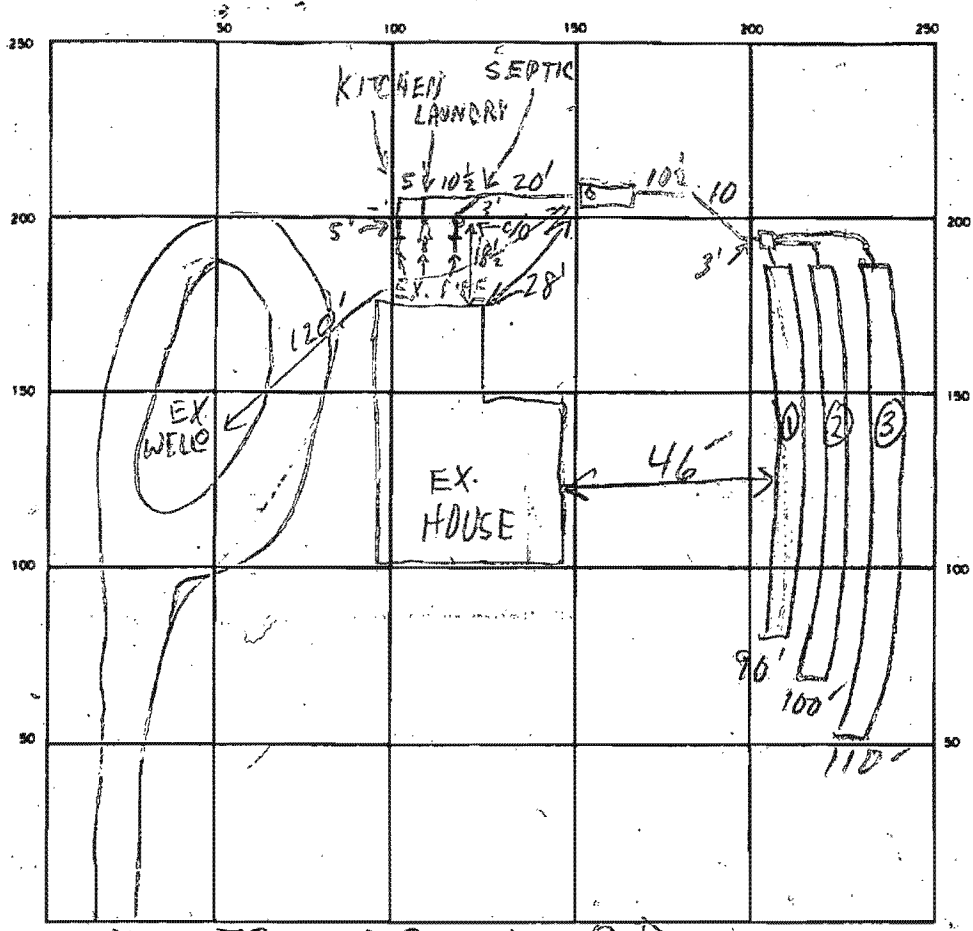

INDICATE NORTH LINE ADJOINING ROADWAY AS BASE LINE  
 OLD FREDERICK RD

SEPTIC TANK. LEVEL 1500 GAL-OK CLEANOUTS OK  
 DISTRIBUTION BOX. LEVEL OK BAFFLE IN  
 DRAIN FIELD/TILE FIELD. DEPTH 6 FT. TRENCH WIDTH 3 FT. INLET DEPTH 4 FT.  
 EFFECTIVE GRAVEL DEPTH 2 FT. TOTAL LENGTH 090 2180 3110 FT.  
 NUMBER OF TRENCHES 3 ONE SIDEWALL/BOTTOM AREA 0230 3330 SQ. FT.  
 DRYWELL INSIDE DIAMETER \_\_\_\_\_ FT. EFFECTIVE DEPTH BELOW INLET \_\_\_\_\_ FT.  
 ABSORBENT AREA 900 SQ. FT.

REMARKS 3/2/90 OK TO COVER TO DB EXCLUSIVE MR  
3/8/90 OK TO COVER ALL MR

DATE SYSTEM APPROVED 3/8/90 INSPECTOR M. Riskin