

ok out 9/19/63 - alter H.F. Wilson job
ok out 9/23/63

PERMIT

SEWAGE DISPOSAL SYSTEM

P 06175
A 06157

MARYLAND STATE DEPARTMENT OF HEALTH

HOWARD COUNTY

ELLICOTT CITY

DISTRICT 5

INDEXED

INDEXED

DATE 12/6/62

Daniel W. Lucas IS PERMITTED TO INSTALL ALTER

ADDRESS _____ PHONE _____

A SEWAGE DISPOSAL SYSTEM LOCATED AT Nichols Drive - first white house on right from Brighton Dam Road

SUBDIVISION _____ ROAD _____ LOT _____

PROPERTY OWNER LUCAS, Daniel W. BURNS?

ADDRESS _____

SPECIFICATIONS

DRAIN FIELD _____ DEPTH _____ FEET, BOTTOM AREA _____ SQ. FT.

SEEPAGE PITS ABSORBENT SIDE-WALL AREA 300 SQ. FT. below inlet *

SEPTIC TANK CAPACITY 750 GALLONS

FOR GARBAGE GRINDER, INCREASE DISPOSAL AREA 22% & TANK CAPACITY 50%.

OTHER * Example - 12 feet in diameter by 8 feet deep below the inlet.

Place the dry well 55 feet to 75 feet from the edge of Nichols Drive and 40 to 60 feet from the right side of lot as seen when facing lot from Nichols Drive. 9/4/63 O.K. to put top on septic tank P.W.

PLANS APPROVED BY Raymond Hodges DATE 12/4/62

FILL SEPTIC TANK AND DISTRIBUTION BOX WITH WATER BEFORE CALLING FOR AN INSPECTION. COVER NO WORK UNTIL INSPECTED AND APPROVED.

NEITHER THE HOWARD COUNTY COMMISSIONERS NOR THE HEALTH DEPARTMENT IS RESPONSIBLE FOR THE SUCCESSFUL OPERATION OF ANY SYSTEM.

A 06157

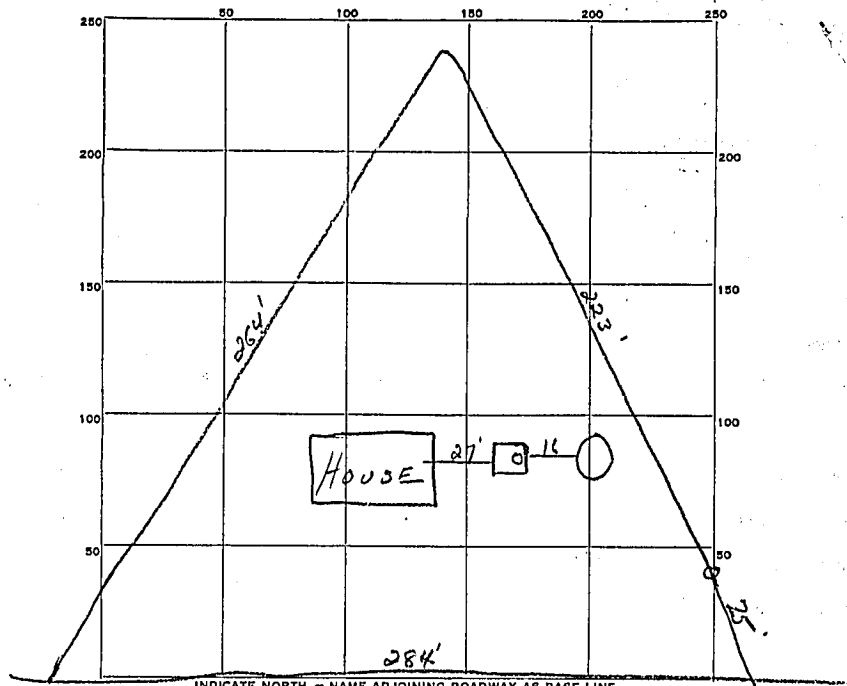

INDICATE NORTH - NAME ADJOINING ROADWAY AS BASE LINE.

Nicholas DRIVE

PERMIT CARD yes

SEPTIC TANK, LEVEL ✓ amolen block CLEANOUTS stand pipe

DISTRIBUTION BOX, LEVEL none

TILE FIELD, DEPTH _____ FT. TRENCH WIDTH _____ FT.

GRAVEL DEPTH _____ IN. TOTAL LENGTH _____ FT.

NUMBER OF TRENCHES _____ TOTAL BOTTOM AREA _____

SEEPAGE PITS, INSIDE DIAMETER 13 1/2 FT. DEPTH BELOW INLET 7 3/4 FT.

ABSORBENT AREA 61K SQ. FT.

REMARKS Top course of amolen block (2 places) slightly spaced. Need to
concrete openings - only way. JH.
Amolen block septic tank should be filled with water to
see if it is leak free. JH.
9-23-63. above BK. JH

DATE SYSTEM APPROVED 9-23-63 INSPECTOR J. Hennigson