

Refund- 4 out of 6 Lots 3/6/07



APPLICATION

FOR PERCOLATION TESTING AND SITE EVALUATION

TEST DATE(S) _____ TEST TIME _____

AP 522992

AGENCY REVIEW: _____

DATE 7/22/05

DO NOT WRITE ABOVE THIS LINE

I HEREBY APPLY FOR THE NECESSARY TESTING/EVALUATION PRIOR TO ISSUANCE OF SEWAGE DISPOSAL SYSTEM PERMIT(S) TO:

CHECK AS NEEDED:

- CONSTRUCT NEW SEPTIC SYSTEM(S)
- REPAIR/ADD TO AN EXISTING SEPTIC SYSTEM
- REPLACE AN EXISTING SEPTIC SYSTEM

CHECK AS NEEDED:

- NEW STRUCTURE(S)
- ADDITION TO AN EXISTING STRUCTURE
- REPLACE AN EXISTING STRUCTURE

CHECK ONE:

- CREATE NEW LOT(S)
- BUILD ON AN EXISTING LOT IN A SUBDIVISION
- BUILD ON AN EXISTING PARCEL OF RECORD

IS THE PROPERTY WITHIN 2500' OF ANY RESERVOIR?

- YES
- NO

THE TYPE OF STRUCTURE IS:

- RESIDENTIAL WITH 5 PROPOSED BEDROOMS IN THE COMPLETED STRUCTURE (NOTE UNKNOWN IF APPROPRIATE)
- COMMERCIAL (PROVIDE DETAIL OF NUMBERS AND TYPES OF EMPLOYEES/ CUSTOMERS ON ACCOMPANYING PLAN)
- INSTITUTIONAL/GOVERNMENT (PROVIDE DETAIL OF NUMBERS AND TYPES OF EMPLOYEES/USERS ON ACCOMPANYING PLAN)

PROPERTY OWNER(S) Samuel Daines, Bradley Daines, Maren Daines, Bernadette Pinella

DAYTIME PHONE 410 489 0383 CELL 202 321 9668 FAX _____

MAILING ADDRESS 14630 Old Frederick Rd. Woodbine Md. 21797
STREET CITY/TOWN STATE ZIP

APPLICANT Samuel Daines

DAYTIME PHONE 410 489 0383 CELL 202 321 9668 FAX _____

MAILING ADDRESS 14630 Old Frederick Rd. Woodbine Md. 21797
STREET CITY/TOWN STATE ZIP

APPLICANT'S ROLE: Developer BUILDER BUYER RELATIVE/FRIEND REALTOR CONSULTANT

PROPERTY LOCATION
SUBDIVISION/PROPERTY NAME 14630 Old Frederick Rd. HBL Subdivision LOT NO. 3, Parcels 9 & 8
Let 5

PROPERTY ADDRESS 14630 Old Frederick Rd. Woodbine Md. 21797
STREET TOWN/POST OFFICE

TAX MAP PAGE(S) 09 GRID _____ PARCEL(S) Lot 3 Roads A and B PROPOSED LOT SIZE Varies

AS APPLICANT, I UNDERSTAND THE FOLLOWING: THE SYSTEM INSTALLED SUBSEQUENT TO THIS APPLICATION IS ACCEPTABLE ONLY UNTIL PUBLIC SEWERAGE IS AVAILABLE. THIS APPLICATION IS COMPLETE WHEN ALL APPLICABLE FEES AND A SUITABLE SITE PLAN HAVE BEEN RECEIVED. I ACCEPT THE RESPONSIBILITY FOR COMPLIANCE WITH ALL M.O.S.H.A. AND "MISS UTILITY" REQUIREMENTS. APPROVAL IS BASED UPON SATISFACTORY REVIEW OF A PERC CERTIFICATION PLAN.

TEST RESULTS WILL BE MAILED TO APPLICANT.

Samuel Daines
SIGNATURE OF APPLICANT

HOWARD COUNTY HEALTH DEPARTMENT, BUREAU OF ENVIRONMENTAL HEALTH, WELL AND SEPTIC PROGRAM
3525-H ELLICOTT MILLS DRIVE, ELLICOTT CITY, MARYLAND 21043-4544 (410) 313-1771 FAX (410) 313-2648
TDD (410) 313-2323 TOLL FREE 1-877-4MD-DHMH

A/P _____

DATE	TEST #	DEPTH	START	BREAK 1" DROP	STOP 2" DROP	TIME OF 2nd INCH	P/F/H

REMARKS _____

SANITARIAN _____ BACKHOE _____ OTHERS _____

TEST HOLES USED IN SDA _____ AVG. PERC TIME _____ SQ. FT/BR _____

TRENCH WIDTH _____ INLET DEPTH _____ MAX. BOT DEPTH _____ EFFECTIVE S/W _____

Refund 4 out of 6 Lots



APPLICATION

FOR PERCOLATION TESTING AND SITE EVALUATION

TEST DATE(S) _____ TEST TIME _____

AP 522992

AGENCY REVIEW: _____

DATE 7/22/05

DO NOT WRITE ABOVE THIS LINE

I HEREBY APPLY FOR THE NECESSARY TESTING/EVALUATION PRIOR TO ISSUANCE OF SEWAGE DISPOSAL SYSTEM PERMIT(S) TO:

CHECK AS NEEDED:

- CONSTRUCT NEW SEPTIC SYSTEM(S)
- REPAIR/ADD TO AN EXISTING SEPTIC SYSTEM
- REPLACE AN EXISTING SEPTIC SYSTEM

CHECK AS NEEDED:

- NEW STRUCTURE(S)
- ADDITION TO AN EXISTING STRUCTURE
- REPLACE AN EXISTING STRUCTURE

CHECK ONE:

- CREATE NEW LOT(S)
- BUILD ON AN EXISTING LOT IN A SUBDIVISION
- BUILD ON AN EXISTING PARCEL OF RECORD

IS THE PROPERTY WITHIN 2500' OF ANY RESERVOIR?

- YES
- NO

THE TYPE OF STRUCTURE IS:

- RESIDENTIAL WITH 5 PROPOSED BEDROOMS IN THE COMPLETED STRUCTURE (NOTE **UNKNOWN** IF APPROPRIATE)
- COMMERCIAL (PROVIDE DETAIL OF NUMBERS AND TYPES OF EMPLOYEES/ CUSTOMERS ON ACCOMPANYING PLAN)
- INSTITUTIONAL/GOVERNMENT (PROVIDE DETAIL OF NUMBERS AND TYPES OF EMPLOYEES/USERS ON ACCOMPANYING PLAN)

PROPERTY OWNER(S) Samuel Daines, Bradley Daines, Maren Daines, Bernadette Pinella

DAYTIME PHONE 410 489 0383 CELL 202 321 9668 FAX _____

MAILING ADDRESS 14630 Old Frederick Rd. Woodbine Md. 21797
STREET CITY/TOWN STATE ZIP

APPLICANT Samuel Daines

DAYTIME PHONE 410 489 0383 CELL 202 321 9668 FAX _____

MAILING ADDRESS 14630 Old Frederick Rd. Woodbine Md. 21797
STREET CITY/TOWN STATE ZIP

APPLICANT'S ROLE: owner DEVELOPER BUILDER BUYER RELATIVE/FRIEND REALTOR CONSULTANT

PROPERTY LOCATION SUBDIVISION/PROPERTY NAME 14630 Old Frederick Rd. HBL Subdivision LOT NO. 3, Parcel 9 & Lot 4

PROPERTY ADDRESS 14630 Old Frederick Rd. Woodbine Md. 21797
STREET TOWN/POST OFFICE

TAX MAP PAGE(S) 09 GRID _____ PARCEL(S) Lot 3, Parcel 9 & Parcel B PROPOSED LOT SIZE Varies

AS APPLICANT, I UNDERSTAND THE FOLLOWING: THE SYSTEM INSTALLED SUBSEQUENT TO THIS APPLICATION IS ACCEPTABLE ONLY UNTIL PUBLIC SEWERAGE IS AVAILABLE. THIS APPLICATION IS COMPLETE WHEN ALL APPLICABLE FEES AND A SUITABLE SITE PLAN HAVE BEEN RECEIVED. I ACCEPT THE RESPONSIBILITY FOR COMPLIANCE WITH ALL M.O.S.H.A. AND "MISS UTILITY" REQUIREMENTS. APPROVAL IS BASED UPON SATISFACTORY REVIEW OF A PERC CERTIFICATION PLAN. TEST RESULTS WILL BE MAILED TO APPLICANT.

Samuel Daines
SIGNATURE OF APPLICANT

HOWARD COUNTY HEALTH DEPARTMENT, BUREAU OF ENVIRONMENTAL HEALTH, WELL AND SEPTIC PROGRAM
 3525-H ELLICOTT MILLS DRIVE, ELLICOTT CITY, MARYLAND 21043-4544 (410) 313-1771 FAX (410) 313-2648
 TDD (410) 313-2323 TOLL FREE 1-877-4MD-DHMH

A/P _____

DATE	TEST #	DEPTH	START	BREAK 1" DROP	STOP 2" DROP	TIME OF 2nd INCH	P/F/H

REMARKS _____

SANITARIAN _____ BACKHOE _____ OTHERS _____

TEST HOLES USED IN SDA _____ AVG. PERC TIME _____ SQ. FT/BR _____

TRENCH WIDTH _____ INLET DEPTH _____ MAX. BOT DEPTH _____ EFFECTIVE SW _____



Refund 4 out of 6 Lots 3/6/07

APPLICATION

FOR PERCOLATION TESTING AND SITE EVALUATION

TEST DATE(S) _____ TEST TIME _____

AP 522992

AGENCY REVIEW: _____

DATE 7/22/05

DO NOT WRITE ABOVE THIS LINE

I HEREBY APPLY FOR THE NECESSARY TESTING/EVALUATION PRIOR TO ISSUANCE OF SEWAGE DISPOSAL SYSTEM PERMIT(S) TO:

CHECK AS NEEDED:

- CONSTRUCT NEW SEPTIC SYSTEM(S)
- REPAIR/ADD TO AN EXISTING SEPTIC SYSTEM
- REPLACE AN EXISTING SEPTIC SYSTEM

CHECK AS NEEDED:

- NEW STRUCTURE(S)
- ADDITION TO AN EXISTING STRUCTURE
- REPLACE AN EXISTING STRUCTURE

CHECK ONE:

- CREATE NEW LOT(S)
- BUILD ON AN EXISTING LOT IN A SUBDIVISION
- BUILD ON AN EXISTING PARCEL OF RECORD

IS THE PROPERTY WITHIN 2500' OF ANY RESERVOIR?

- YES
- NO

THE TYPE OF STRUCTURE IS:

- RESIDENTIAL WITH 5 PROPOSED BEDROOMS IN THE COMPLETED STRUCTURE (NOTE **UNKNOWN** IF APPROPRIATE)
- COMMERCIAL (PROVIDE DETAIL OF NUMBERS AND TYPES OF EMPLOYEES/ CUSTOMERS ON ACCOMPANYING PLAN)
- INSTITUTIONAL/GOVERNMENT (PROVIDE DETAIL OF NUMBERS AND TYPES OF EMPLOYEES/USERS ON ACCOMPANYING PLAN)

PROPERTY OWNER(S) Samuel Daines, Bradley Daines, Maren Daines, Bernadette Pinella

DAYTIME PHONE 410 489 0383 CELL 202 321 9668 FAX _____

MAILING ADDRESS 14630 Old Frederick Rd. Woodbine Md. 21797
STREET CITY/TOWN STATE ZIP

APPLICANT Samuel Daines

DAYTIME PHONE 410 489 0383 CELL 202 321 9668 FAX _____

MAILING ADDRESS 14630 Old Frederick Rd. Woodbine Md. 21797
STREET CITY/TOWN STATE ZIP

APPLICANT'S ROLE: Developer DEVELOPER BUILDER BUYER RELATIVE/FRIEND REALTOR CONSULTANT

PROPERTY LOCATION
SUBDIVISION/PROPERTY NAME 14630 Old Frederick Rd. HBL Subdivision LOT NO. 3, Parcels 9 & 8

PROPERTY ADDRESS 14630 Old Frederick Rd. Woodbine Md. 21797
STREET TOWN/POST OFFICE

TAX MAP PAGE(S) 09 GRID _____ PARCEL(S) Lot 3 Parcels A and B PROPOSED LOT SIZE Varies

AS APPLICANT, I UNDERSTAND THE FOLLOWING: THE SYSTEM INSTALLED SUBSEQUENT TO THIS APPLICATION IS ACCEPTABLE ONLY UNTIL PUBLIC SEWERAGE IS AVAILABLE. THIS APPLICATION IS COMPLETE WHEN ALL APPLICABLE FEES AND A SUITABLE SITE PLAN HAVE BEEN RECEIVED. I ACCEPT THE RESPONSIBILITY FOR COMPLIANCE WITH ALL M.O.S.H.A. AND "MISS UTILITY" REQUIREMENTS. APPROVAL IS BASED UPON SATISFACTORY REVIEW OF A PERC CERTIFICATION PLAN.

TEST RESULTS WILL BE MAILED TO APPLICANT.

Samuel Daines
SIGNATURE OF APPLICANT

HOWARD COUNTY HEALTH DEPARTMENT, BUREAU OF ENVIRONMENTAL HEALTH, WELL AND SEPTIC PROGRAM
3525-H ELLICOTT MILLS DRIVE, ELLICOTT CITY, MARYLAND 21043-4544 (410) 313-1771 FAX (410) 313-2648
TDD (410) 313-2323 TOLL FREE 1-877-4MD-DHMH

A/P _____

DATE	TEST #	DEPTH	START	BREAK 1" DROP	STOP 2" DROP	TIME OF 2nd INCH	P/F/H

REMARKS _____

SANITARIAN _____ BACKHOE _____ OTHERS _____

TEST HOLES USED IN SDA _____ AVG. PERC TIME _____ SQ. FT/BR _____

TRENCH WIDTH _____ INLET DEPTH _____ MAX. BOT DEPTH _____ EFFECTIVE S/W _____

Refund 4 out of 6 lots - 3/6/07



Howard County Health Department

APPLICATION

FOR PERCOLATION TESTING AND SITE EVALUATION

TEST DATE(S) _____ TEST TIME _____

AP522992

AGENCY REVIEW: _____

DATE 7/22/05

DO NOT WRITE ABOVE THIS LINE

I HEREBY APPLY FOR THE NECESSARY TESTING/EVALUATION PRIOR TO ISSUANCE OF SEWAGE DISPOSAL SYSTEM PERMIT(S) TO:

CHECK AS NEEDED:

- CONSTRUCT NEW SEPTIC SYSTEM(S)
- REPAIR/ADD TO AN EXISTING SEPTIC SYSTEM
- REPLACE AN EXISTING SEPTIC SYSTEM

CHECK AS NEEDED:

- NEW STRUCTURE(S)
- ADDITION TO AN EXISTING STRUCTURE
- REPLACE AN EXISTING STRUCTURE

CHECK ONE:

- CREATE NEW LOT(S)
- BUILD ON AN EXISTING LOT IN A SUBDIVISION
- BUILD ON AN EXISTING PARCEL OF RECORD

IS THE PROPERTY WITHIN 2500' OF ANY RESERVOIR?

- YES
- NO

THE TYPE OF STRUCTURE IS:

- RESIDENTIAL WITH 5 PROPOSED BEDROOMS IN THE COMPLETED STRUCTURE (NOTE UNKNOWN IF APPROPRIATE)
- COMMERCIAL (PROVIDE DETAIL OF NUMBERS AND TYPES OF EMPLOYEES/ CUSTOMERS ON ACCOMPANYING PLAN)
- INSTITUTIONAL/GOVERNMENT (PROVIDE DETAIL OF NUMBERS AND TYPES OF EMPLOYEES/USERS ON ACCOMPANYING PLAN)

PROPERTY OWNER(S) Samuel Daines, Bradley Daines, Maren Daines, Bernadette Pinella

DAYTIME PHONE 410 489 0383 CELL 202 321 9668 FAX _____

MAILING ADDRESS 14630 Old Frederick Rd. Woodbine Md. 21797
STREET CITY/TOWN STATE ZIP

APPLICANT Samuel Daines

DAYTIME PHONE 410 489 0383 CELL 202 321 9668 FAX _____

MAILING ADDRESS 14630 Old Frederick Rd. Woodbine Md. 21797
STREET CITY/TOWN STATE ZIP

APPLICANT'S ROLE: Developer DEVELOPER BUILDER BUYER RELATIVE/FRIEND REALTOR CONSULTANT

PROPERTY LOCATION SUBDIVISION/PROPERTY NAME 14630 Old Frederick Rd. HBL Subdivision LOT NO. 3, Parcels 9 & 10

PROPERTY ADDRESS 14630 Old Frederick Rd. Woodbine Md. 21797
STREET TOWN/POST OFFICE

TAX MAP PAGE(S) 09 GRID _____ PARCEL(S) Lot 3, Parcels A and B PROPOSED LOT SIZE Varies

AS APPLICANT, I UNDERSTAND THE FOLLOWING: THE SYSTEM INSTALLED SUBSEQUENT TO THIS APPLICATION IS ACCEPTABLE ONLY UNTIL PUBLIC SEWERAGE IS AVAILABLE. THIS APPLICATION IS COMPLETE WHEN ALL APPLICABLE FEES AND A SUITABLE SITE PLAN HAVE BEEN RECEIVED. I ACCEPT THE RESPONSIBILITY FOR COMPLIANCE WITH ALL M.O.S.H.A. AND "MISS UTILITY" REQUIREMENTS. APPROVAL IS BASED UPON SATISFACTORY REVIEW OF A PERC CERTIFICATION PLAN. TEST RESULTS WILL BE MAILED TO APPLICANT.

Samuel Daines
SIGNATURE OF APPLICANT

HOWARD COUNTY HEALTH DEPARTMENT, BUREAU OF ENVIRONMENTAL HEALTH, WELL AND SEPTIC PROGRAM
3525-H ELLICOTT MILLS DRIVE, ELLICOTT CITY, MARYLAND 21043-4544 (410) 313-1771 FAX (410) 313-2648
TDD (410) 313-2323 TOLL FREE 1-877-4MD-DHMH

A/P _____

DATE	TEST #	DEPTH	START	BREAK 1" DROP	STOP 2" DROP	TIME OF 2nd INCH	P/F/H

REMARKS _____

SANITARIAN _____ BACKHOE _____ OTHERS _____

TEST HOLES USED IN SDA _____ AVG. PERC TIME _____ SQ. FT/BR _____

TRENCH WIDTH _____ INLET DEPTH _____ MAX. BOT DEPTH _____ EFFECTIVE SW _____

refund 4 out of 6 lots



APPLICATION

FOR PERCOLATION TESTING AND SITE EVALUATION

TEST DATE(S) _____ TEST TIME _____

AP522992

AGENCY REVIEW: _____

DATE 7/22/05

DO NOT WRITE ABOVE THIS LINE

I HEREBY APPLY FOR THE NECESSARY TESTING/EVALUATION PRIOR TO ISSUANCE OF SEWAGE DISPOSAL SYSTEM PERMIT(S) TO:

CHECK AS NEEDED:

- CONSTRUCT NEW SEPTIC SYSTEM(S)
- REPAIR/ADD TO AN EXISTING SEPTIC SYSTEM
- REPLACE AN EXISTING SEPTIC SYSTEM

CHECK AS NEEDED:

- NEW STRUCTURE(S)
- ADDITION TO AN EXISTING STRUCTURE
- REPLACE AN EXISTING STRUCTURE

CHECK ONE:

- CREATE NEW LOT(S)
- BUILD ON AN EXISTING LOT IN A SUBDIVISION
- BUILD ON AN EXISTING PARCEL OF RECORD

IS THE PROPERTY WITHIN 2500' OF ANY RESERVOIR?

- YES
- NO

THE TYPE OF STRUCTURE IS:

- RESIDENTIAL WITH 5 PROPOSED BEDROOMS IN THE COMPLETED STRUCTURE (NOTE UNKNOWN IF APPROPRIATE)
- COMMERCIAL (PROVIDE DETAIL OF NUMBERS AND TYPES OF EMPLOYEES/ CUSTOMERS ON ACCOMPANYING PLAN)
- INSTITUTIONAL/GOVERNMENT (PROVIDE DETAIL OF NUMBERS AND TYPES OF EMPLOYEES/USERS ON ACCOMPANYING PLAN)

PROPERTY OWNER(S) Samuel Daines, Bradley Daines, Maren Daines, Bernadette Pinella

DAYTIME PHONE 410 489 0383 CELL 202 321 9668 FAX _____

MAILING ADDRESS 14630 Old Frederick Rd. Woodbine Md. 21797
STREET CITY/TOWN STATE ZIP

APPLICANT Samuel Daines

DAYTIME PHONE 410 489 0383 CELL 202 321 9668 FAX _____

MAILING ADDRESS 14630 Old Frederick Rd. Woodbine Md. 21797
STREET CITY/TOWN STATE ZIP

APPLICANT'S ROLE: DEVELOPER BUILDER BUYER RELATIVE/FRIEND REALTOR CONSULTANT

PROPERTY LOCATION
SUBDIVISION/PROPERTY NAME 14630 Old Frederick Rd. HBL Subdivision LOT NO. 3, Parcel 9 & Lot 8

PROPERTY ADDRESS 14630 Old Frederick Rd. Woodbine Md. 21797
STREET TOWN/POST OFFICE

TAX MAP PAGE(S) 09 GRID _____ PARCEL(S) Lot 3, Parcels A and B PROPOSED LOT SIZE Varies

AS APPLICANT, I UNDERSTAND THE FOLLOWING: THE SYSTEM INSTALLED SUBSEQUENT TO THIS APPLICATION IS ACCEPTABLE ONLY UNTIL PUBLIC SEWERAGE IS AVAILABLE. THIS APPLICATION IS COMPLETE WHEN ALL APPLICABLE FEES AND A SUITABLE SITE PLAN HAVE BEEN RECEIVED. I ACCEPT THE RESPONSIBILITY FOR COMPLIANCE WITH ALL M.O.S.H.A. AND "MISS UTILITY" REQUIREMENTS. APPROVAL IS BASED UPON SATISFACTORY REVIEW OF A PERC CERTIFICATION PLAN.

TEST RESULTS WILL BE MAILED TO APPLICANT.

Samuel Daines
SIGNATURE OF APPLICANT

HOWARD COUNTY HEALTH DEPARTMENT, BUREAU OF ENVIRONMENTAL HEALTH, WELL AND SEPTIC PROGRAM
3525-H ELLICOTT MILLS DRIVE, ELLICOTT CITY, MARYLAND 21043-4544 (410) 313-1771 FAX (410) 313-2648
TDD (410) 313-2323 TOLL FREE 1-877-4MD-DHMH

AP _____

DATE	TEST #	DEPTH	START	BREAK 1" DROP	STOP 2" DROP	TIME OF 2nd INCH	P/F/H

REMARKS _____

SANITARIAN _____ BACKHOE _____ OTHERS _____

TEST HOLES USED IN SDA _____ AVG. PERC TIME _____ SQ. FT/BR _____

TRENCH WIDTH _____ INLET DEPTH _____ MAX. BOT DEPTH _____ EFFECTIVE SW _____

refund 4 out of 6 lots



APPLICATION

FOR PERCOLATION TESTING AND SITE EVALUATION

TEST DATE(S) _____ TEST TIME _____

AP 522992

AGENCY REVIEW: _____

DATE 7/22/05

DO NOT WRITE ABOVE THIS LINE

I HEREBY APPLY FOR THE NECESSARY TESTING/EVALUATION PRIOR TO ISSUANCE OF SEWAGE DISPOSAL SYSTEM PERMIT(S) TO:

- CHECK AS NEEDED:
- CONSTRUCT NEW SEPTIC SYSTEM(S)
 - REPAIR/ADD TO AN EXISTING SEPTIC SYSTEM
 - REPLACE AN EXISTING SEPTIC SYSTEM

- CHECK AS NEEDED:
- NEW STRUCTURE(S)
 - ADDITION TO AN EXISTING STRUCTURE
 - REPLACE AN EXISTING STRUCTURE

- CHECK ONE:
- CREATE NEW LOT(S)
 - BUILD ON AN EXISTING LOT IN A SUBDIVISION
 - BUILD ON AN EXISTING PARCEL OF RECORD

- IS THE PROPERTY WITHIN 2500' OF ANY RESERVOIR?
- YES
 - NO

- THE TYPE OF STRUCTURE IS:
- RESIDENTIAL WITH 5 PROPOSED BEDROOMS IN THE COMPLETED STRUCTURE (NOTE UNKNOWN IF APPROPRIATE)
 - COMMERCIAL (PROVIDE DETAIL OF NUMBERS AND TYPES OF EMPLOYEES/ CUSTOMERS ON ACCOMPANYING PLAN)
 - INSTITUTIONAL/GOVERNMENT (PROVIDE DETAIL OF NUMBERS AND TYPES OF EMPLOYEES/USERS ON ACCOMPANYING PLAN)

PROPERTY OWNER(S) Samuel Daines, Bradley Daines, Maren Daines, Bernadette Pinella

DAYTIME PHONE 410 489 0383 CELL 202 321 9668 FAX _____

MAILING ADDRESS 14630 Old Frederick Rd. Woodbine Md. 21797
STREET CITY/TOWN STATE ZIP

APPLICANT Samuel Daines

DAYTIME PHONE 410 489 0383 CELL 202 321 9668 FAX _____

MAILING ADDRESS 14630 Old Frederick Rd. Woodbine Md. 21797
STREET CITY/TOWN STATE ZIP

APPLICANT'S ROLE: Developer DEVELOPER BUILDER BUYER RELATIVE/FRIEND REALTOR CONSULTANT

PROPERTY LOCATION
SUBDIVISION/PROPERTY NAME 14630 Old Frederick Rd. HBL Subdivision LOT NO. 3, Parcel 9 & 8

PROPERTY ADDRESS 14630 Old Frederick Rd. Woodbine Md. 21797
STREET TOWN/POST OFFICE

TAX MAP PAGE(S) 09 GRID _____ PARCEL(S) Lot 3, Roads A and B PROPOSED LOT SIZE Varies

AS APPLICANT, I UNDERSTAND THE FOLLOWING: THE SYSTEM INSTALLED SUBSEQUENT TO THIS APPLICATION IS ACCEPTABLE ONLY UNTIL PUBLIC SEWERAGE IS AVAILABLE. THIS APPLICATION IS COMPLETE WHEN ALL APPLICABLE FEES AND A SUITABLE SITE PLAN HAVE BEEN RECEIVED. I ACCEPT THE RESPONSIBILITY FOR COMPLIANCE WITH ALL M.O.S.H.A. AND "MISS UTILITY" REQUIREMENTS. APPROVAL IS BASED UPON SATISFACTORY REVIEW OF A PERC CERTIFICATION PLAN.

TEST RESULTS WILL BE MAILED TO APPLICANT. Samuel Daines
SIGNATURE OF APPLICANT

HOWARD COUNTY HEALTH DEPARTMENT, BUREAU OF ENVIRONMENTAL HEALTH, WELL AND SEPTIC PROGRAM
3525-H ELLICOTT MILLS DRIVE, ELLICOTT CITY, MARYLAND 21043-4544 (410) 313-1771 FAX (410) 313-2648
TDD (410) 313-2323 TOLL FREE 1-877-4MD-DHMH

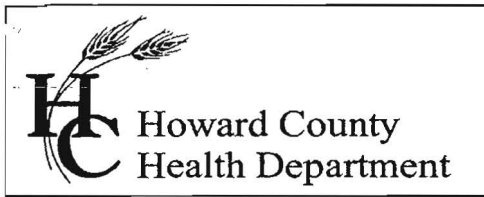

Bureau of Environmental Health
7178 Columbia Gateway Drive, Columbia MD 21046
(410) 313-2640 Fax (410) 313-2648
TDD (410) 313-2323 Toll Free 1-866-313-6300
website: www.hchealth.org

Penny E. Borenstein, M.D., M.P.H., Health Officer

February 26, 2007

MEMORANDUM

To: Carletta McKnight

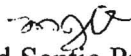
From: Michael J. Davis 
Director Well and Septic Program

Re: 14630 Old Frederick Road
Refund – receipt # 22992

The Department of Health received a check to cover six applications and six plan review fees. See attached receipt for \$3,036.00. The owner has changed the proposal to only reconfigure two lots and is requesting a refund for four of the six applications and plan review fees for a refund of \$2,024.00. I recommend refund of \$2,024.00 as we have not acted on the four applications.

Please address check to Samuel R. Daines and mail to:
Samuel R. Daines
16942 Frederick Road
Mt. Airy, MD 21771



HOWARD COUNTY HEALTH DEPARTMENT

22992

DATE 7/22/05

Received From

Samuel E. Jones

PHONE # 410 489-0383

14630 Old Frederick Rd Woodbine MD 21797

For one of 1 year fee

1430 Old Frederick Rd

2073 Par-A-B 6 lots

Three Howard County

Dollars

CASH
 CHECK

NO.

1155

\$ 3036 00

Received By

[Signature] M.D.

306-885-4799

Samuel R. Daines
3133 Daisy Road
Woodbine, MD 21797
410-489-0383

February 23, 2007

Mike Davis
Howard County Health Department
Columbia Maryland

Dear Sir,

On July 22nd 2005 I paid \$3,036.00 for six perc and plan review fees (see attached receipt # 22992) for our planned re-subdivision of three existing lots , Lot 3, Parcel 400 and parcel 367 at 14630 Old Frederick Road with the addition of new lots through the acquisition of DEO's.

Based on further engineering of the site and search for reasonably priced DEO's we have decided to give up adding lots so our revised plan, ~~attached~~, calls only for reconfiguring the existing lots.

At this time, therefore, we would like to request the refund of four of the perc and plan review fees \$2,024.00. These funds are needed urgently to pay for additional engineering for a revised plan for reconfiguration of the existing three lots.

You will notice from this letterhead that we are no longer receiving mail at the 14630 Old Frederick Road address, so the refund check should be sent to our new mailing address, 3133 Daisy Road, Woodbine MD 21797.

We appreciate your earliest attention.

Sincerely,

Samuel R. Daines

SITE INSPECTION SHEET

OWNER: Catherine Carter PHONE #: 410-489-9901

ADDRESS: 14630 Rt. 99 CONTRACTOR: _____

WELL TAG #: _____

SUBDIVISION: _____ LOT: _____ COUNTY #: _____

PROPOSAL: _____

LOCATION DIAGRAM

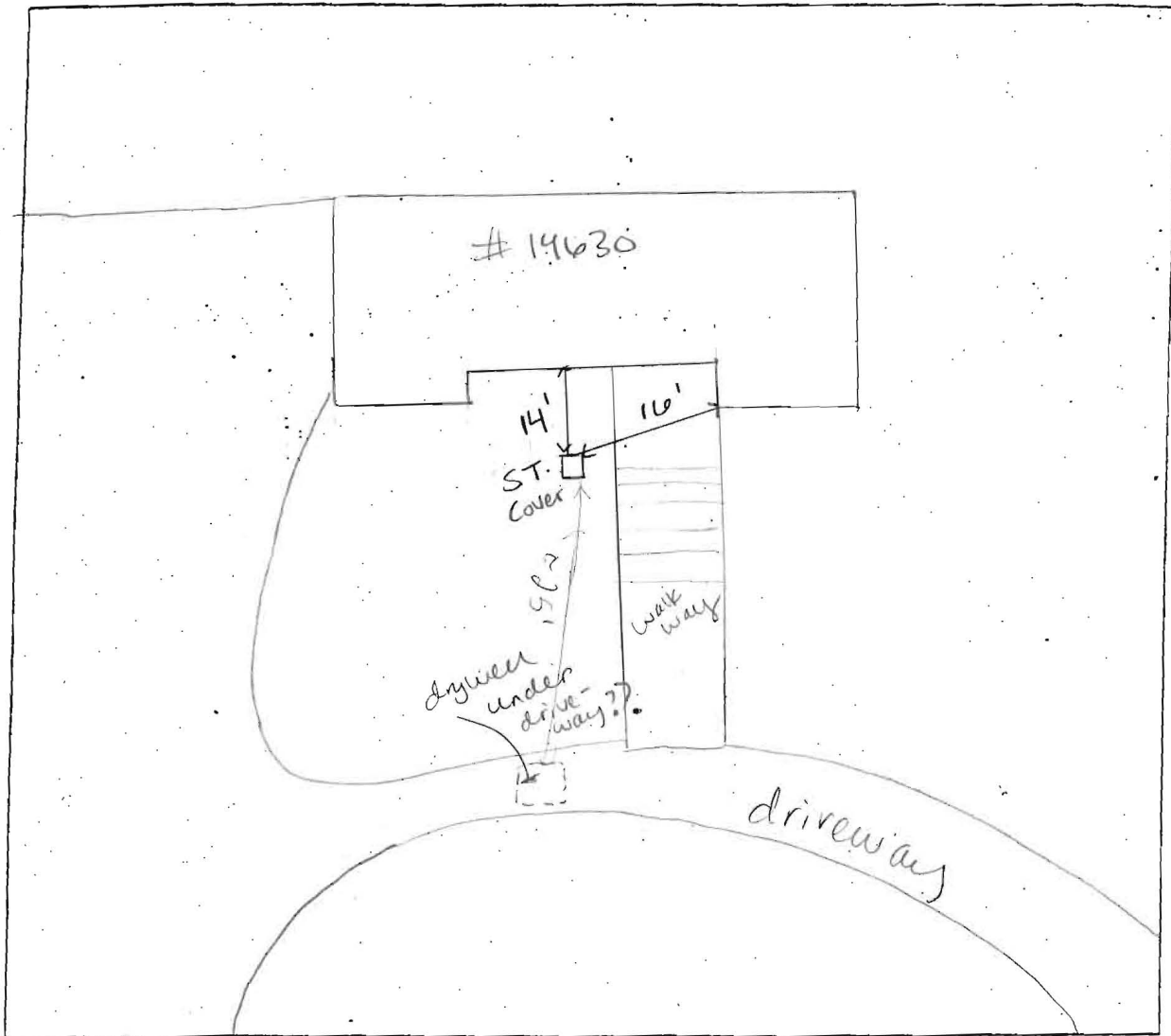

COMMENTS: _____
