



Building Permit Application

Howard County Maryland
Department of Inspections, Licenses and Permits
3430 Court House Drive
Permits: 410-313-2455
www.howardcountymd.gov

Date Received: _____

Permit No.: _____

Building Address: 17197 Hardy Road
 City: Mt. Airy State: MD Zip Code: 21771
 Suite/Apt. # _____ SDP/WP/BA #: _____
 Census Tract: _____ Subdivision: _____
 Section: _____ Area: _____ Lot: _____
 Tax Map: 0007 Parcel: 0037 Grid: 0008
 Zoning: _____ Map Coordinates: _____ Lot Size: 62AC

Existing Use: Single family
 Proposed Use: _____
 Estimated Construction Cost: \$ 47,000
 Description of Work: 18' x 18' screened porch with 11' x 9' deck and steps
 Occupant or Tenant: _____
 Was tenant space previously occupied? Yes No
 Contact Name: _____
 Address: _____
 City: _____ State: _____ Zip Code: _____
 Phone: _____ Fax: _____
 Email: _____

Property Owner's Name: Julian Baca
 Address: 17197 Hardy Rd
 City: Mt Airy State: MD Zip Code: 21771
 Phone: 808-754-2485 Fax: _____
 Email: _____

Applicant's Name & Mailing Address, (If other than stated herein)
 Applicant's Name: Greg Simon
 Address: 12885 Old Frederick road
 City: Sykesville State: MD Zip Code: 21784
 Phone: 410-442-2445 Fax: _____
 Email: greg@rhinelandscaping.com

Contractor Company: Rhine Landscaping
 Contact Person: Greg Simon
 Address: 12885 Old Frederick road
 City: Sykesville State: MD Zip Code: 21784
 License No.: MHIC# 121739
 Phone: 410-442-2445 Fax: _____
 Email: greg@rhinelandscaping.com

Engineer/Architect Company: _____
 Responsible Design Prof.: _____
 Address: _____
 City: _____ State: _____ Zip Code: _____
 Phone: _____ Fax: _____
 Email: _____

Commercial Building Characteristics	Residential Building Characteristics
Height:	<input checked="" type="checkbox"/> SF Dwelling <input type="checkbox"/> SF Townhouse
No. of stories:	Depth Width
Gross area, sq. ft./floor:	1 st floor:
	2 nd floor:
Area of construction (sq. ft.):	Basement:
	<input type="checkbox"/> Finished Basement
Use group:	<input type="checkbox"/> Unfinished Basement
	<input type="checkbox"/> Crawl Space
Construction type:	<input type="checkbox"/> Slab on Grade
<input type="checkbox"/> Reinforced Concrete	No. of Bedrooms:
<input type="checkbox"/> Structural Steel	Multi-family Dwelling
<input type="checkbox"/> Masonry	No. of efficiency units:
<input type="checkbox"/> Wood Frame	No. of 1 BR units:
<input type="checkbox"/> State Certified Modular	No. of 2 BR units:
	No. of 3 BR units:
	Other Structure:
	Dimensions:
<input checked="" type="checkbox"/> Roadside Tree Project Permit	Footings:
<input type="checkbox"/> Yes <input type="checkbox"/> No	Roof:
Roadside Tree Project Permit #	<input type="checkbox"/> State Certified Modular
	<input type="checkbox"/> Manufactured Home

Utilities	
Water Supply	
<input type="checkbox"/> Public	
<input checked="" type="checkbox"/> Private	
Sewage Disposal	
<input type="checkbox"/> Public	
<input checked="" type="checkbox"/> Private	
Electric: <input type="checkbox"/> Yes <input type="checkbox"/> No	
Gas: <input type="checkbox"/> Yes <input type="checkbox"/> No	
Heating System	
<input type="checkbox"/> Electric <input type="checkbox"/> Oil	
<input type="checkbox"/> Natural Gas <input type="checkbox"/> Propane Gas	
<input type="checkbox"/> Other:	
Sprinkler System:	
<input type="checkbox"/> Yes <input type="checkbox"/> No	
Grading Permit Number:	
Building Shell Permit Number:	

THE UNDERSIGNED HEREBY CERTIFIES AND AGREES AS FOLLOWS: (1) THAT HE/SHE IS AUTHORIZED TO MAKE THIS APPLICATION; (2) THAT THE INFORMATION IS CORRECT; (3) THAT HE/SHE WILL COMPLY WITH ALL REGULATIONS OF HOWARD COUNTY WHICH ARE APPLICABLE THERETO; (4) THAT HE/SHE WILL PERFORM NO WORK ON THE ABOVE REFERENCED PROPERTY NOT SPECIFICALLY DESCRIBED IN THIS APPLICATION; (5) THAT HE/SHE GRANTS COUNTY OFFICIALS THE RIGHT TO ENTER ONTO THIS PROPERTY FOR THE PURPOSE OF INSPECTING THE WORK PERMITTED AND POSTING NOTICES.

Gregory T Simon
Applicant's Signature
greg@rhinelandscaping.com
Email Address
Landscaper Designer
Title/Company

Gregory T Simon
Print Name
3/22/2017
Date

Checks Payable to: DIRECTOR OF FINANCE OF HOWARD COUNTY

PLEASE WRITE NEATLY & LEGIBLY

-FOR OFFICE USE ONLY-

AGENCY	DATE	SIGNATURE OF APPROVAL
State Highways		
Building Officials		
PSZA (Zoning)		
PSZA (Engineering)		
Health	<u>3/22/17</u>	<u>H. Oswald</u>

Is Sediment Control approval required for issuance? Yes No
 CONTINGENCY CONSTRUCTION START

DPZ SETBACK INFORMATION
Front:
Rear:
Side:
Side St.:
All minimum setbacks met? <input type="checkbox"/> Yes <input type="checkbox"/> No
Is Entrance Permit Required? <input type="checkbox"/> Yes <input type="checkbox"/> No
Historic District? <input type="checkbox"/> Yes <input type="checkbox"/> No
Lot Coverage for New Town Zone:
SDP/Red-line approval date:

Filing Fee	\$
Permit Fee	\$
Tech Fee	\$
Excise Tax	\$
PSFS	\$
Guaranty Fund	\$
Add'l per Fee	\$
Total Fees	\$
Sub- Total Paid	\$
Balance Due	\$
Check	#

Distribution of Copies: White: Building Officials Green: PSZA,Zoning Yellow: PSZA,Engineering Pink: Health Gold: SHA

Scale 1"=30'
March 22, 2017

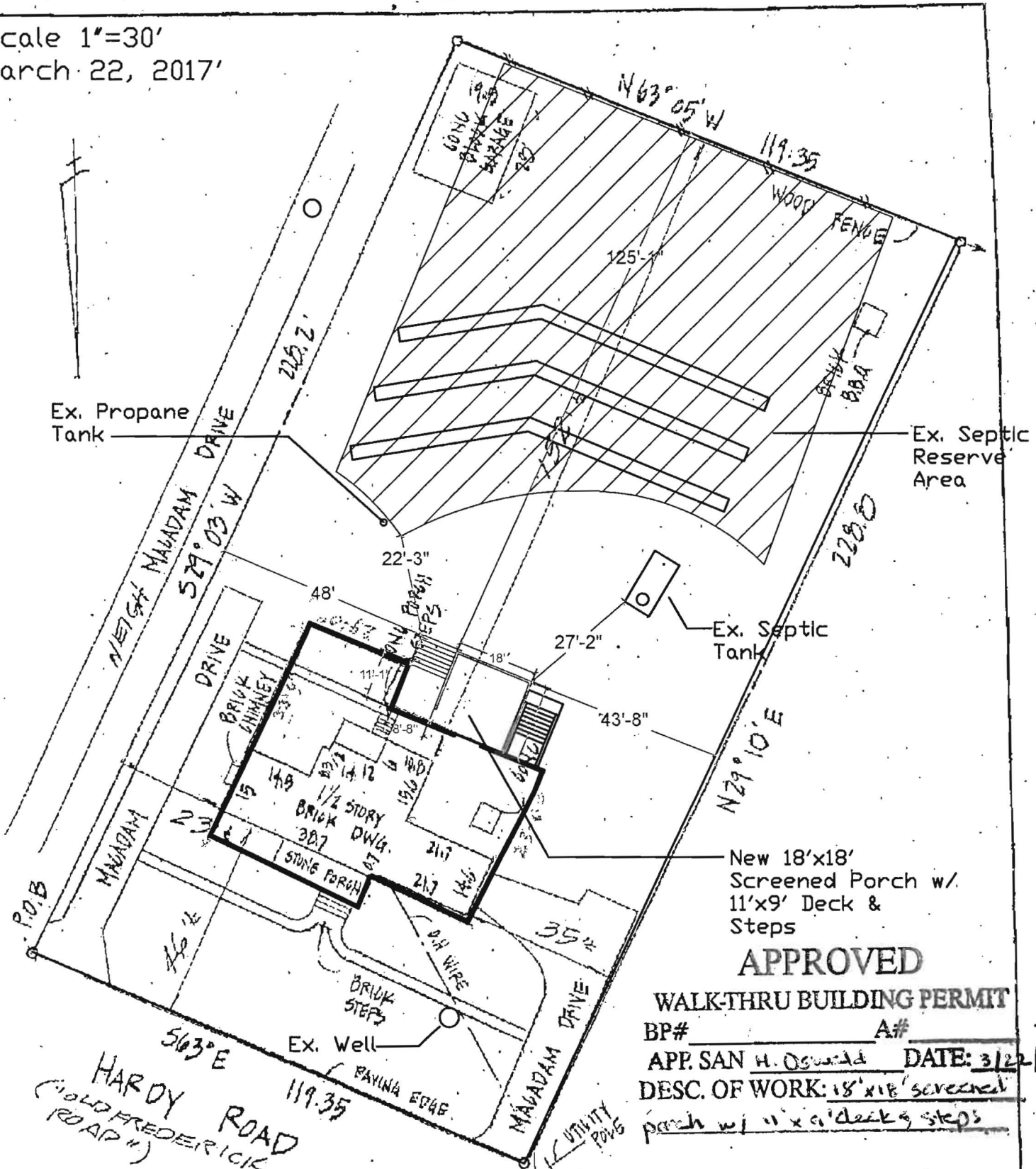

APPROVED
WALK-THRU BUILDING PERMIT

BP# _____ A# _____
 APP. SAN H. OSWALD DATE: 3/22/17
 DESC. OF WORK: 18'x18' screened porch w/ 11'x9' deck & steps

LOT DESCRIPTION SHOWN
 HEREON PER HICKORY RIDGE
 TITLE COOP.
 4TH ELECTION DIST
 HOWARD COUNTY MD

1. THE PLAT IS OF BENEFIT TO A CONSUMER ONLY INsofar AS IT IS REQUIRED BY A LENDER OR A TITLE COMPANY OR IT'S AGENT IN CONNECTION WITH CONTEMPLATED TRANSFER FINANCING OR RE-FINANCING.
2. THE PLAT IS NOT TO BE RELIED UPON FOR THE ESTABLISHMENT OR LOCATION OF FENCES, GARAGES, BUILDING, OR OTHER EXISTING OR FUTURE IMPROVEMENTS.
3. THE PLAT DOES NOT PROVIDE FOR THE ACCURATE IDENTIFICATION OF PROPERTY BOUNDARY LINES, BUT SUCH IDENTIFICATION MAY NOT BE REQUIRED FOR THE TRANSFER OF TITLE OR SECURING FINANCING OR RE-FINANCING.
4. I HAVE EXAMINED FLOOD INSURANCE RATE MAP PANEL NUMBER 2400440007B