



APPLICATION

FOR PERCOLATION TESTING AND SITE EVALUATION

TEST DATE(S) _____ TEST TIME _____

AP 523022

AGENCY REVIEW: _____

DATE 7/27/05

04-317807

DO NOT WRITE ABOVE THIS LINE

I HEREBY APPLY FOR THE NECESSARY TESTING/EVALUATION PRIOR TO ISSUANCE OF SEWAGE DISPOSAL SYSTEM PERMIT(S) TO:

CHECK AS NEEDED:

- CONSTRUCT NEW SEPTIC SYSTEM(S)
- REPAIR/ADD TO AN EXISTING SEPTIC SYSTEM
- REPLACE AN EXISTING SEPTIC SYSTEM

CHECK AS NEEDED:

- NEW STRUCTURE(S)
- ADDITION TO AN EXISTING STRUCTURE
- REPLACE AN EXISTING STRUCTURE

CHECK ONE:

- CREATE NEW LOT(S)
- BUILD ON AN EXISTING LOT IN A SUBDIVISION
- BUILD ON AN EXISTING PARCEL OF RECORD

IS THE PROPERTY WITHIN 2500' OF ANY RESERVOIR?

- YES
- NO

THE TYPE OF STRUCTURE IS:

- RESIDENTIAL WITH _____ PROPOSED BEDROOMS IN THE COMPLETED STRUCTURE (NOTE UNKNOWN IF APPROPRIATE)
- COMMERCIAL (PROVIDE DETAIL OF NUMBERS AND TYPES OF EMPLOYEES/ CUSTOMERS ON ACCOMPANYING PLAN)
- INSTITUTIONAL/GOVERNMENT (PROVIDE DETAIL OF NUMBERS AND TYPES OF EMPLOYEES/USERS ON ACCOMPANYING PLAN)

PROPERTY OWNER(S) BILL BLACKERT

DAYTIME PHONE 410-984-4979 CELL _____ FAX _____

MAILING ADDRESS 2555 MCKENDREE RD GLENWOOD MD 21738
STREET CITY/TOWN STATE ZIP

APPLICANT FISHER, COLLINS, & CARTER

DAYTIME PHONE 410-461-2855 CELL _____ FAX 410-750-3784

MAILING ADDRESS 10272 BALTIMORE NATIONAL PIKE ELLCOTT CITY MD 21042
STREET CITY/TOWN STATE ZIP

APPLICANT'S ROLE: DEVELOPER BUILDER BUYER RELATIVE/FRIEND REALTOR **CONSULTANT**

PROPERTY LOCATION
SUBDIVISION/PROPERTY NAME HOBBS PROPERTY LOT NO. _____

PROPERTY ADDRESS 2765 MCKENDREE RD GLENWOOD
STREET TOWN/POST OFFICE

TAX MAP PAGE(S) 14 GRID 18 PARCEL(S) 89 PROPOSED LOT SIZE _____

AS APPLICANT, I UNDERSTAND THE FOLLOWING: THE SYSTEM INSTALLED SUBSEQUENT TO THIS APPLICATION IS ACCEPTABLE ONLY UNTIL PUBLIC SEWERAGE IS AVAILABLE. THIS APPLICATION IS COMPLETE WHEN ALL APPLICABLE FEES AND A SUITABLE SITE PLAN HAVE BEEN RECEIVED. I ACCEPT THE RESPONSIBILITY FOR COMPLIANCE WITH ALL M.O.S.H.A. AND "MISS UTILITY" REQUIREMENTS. APPROVAL IS BASED UPON SATISFACTORY REVIEW OF A PERC CERTIFICATION PLAN.

TEST RESULTS WILL BE MAILED TO APPLICANT. _____
SIGNATURE OF APPLICANT

HOWARD COUNTY HEALTH DEPARTMENT, BUREAU OF ENVIRONMENTAL HEALTH, WELL AND SEPTIC PROGRAM
3525-H ELLCOTT MILLS DRIVE, ELLCOTT CITY, MARYLAND 21043-4544 (410) 313-1771 FAX (410) 313-2648
TDD (410) 313-2323 TOLL FREE 1-877-4MD-DHMH

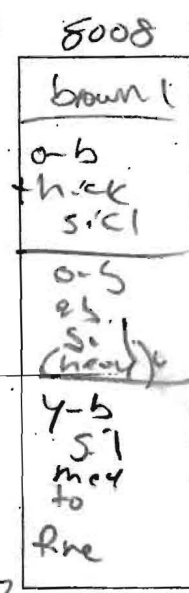
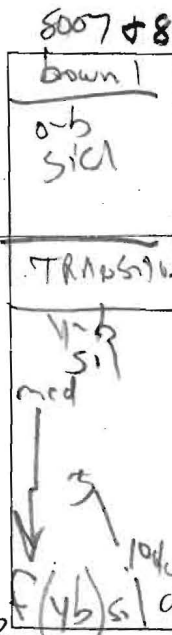
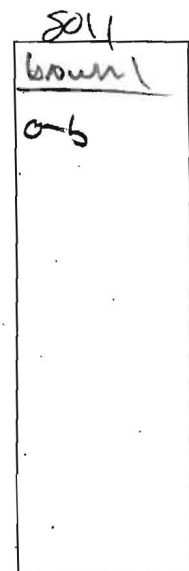
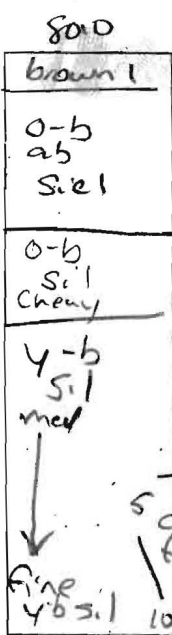
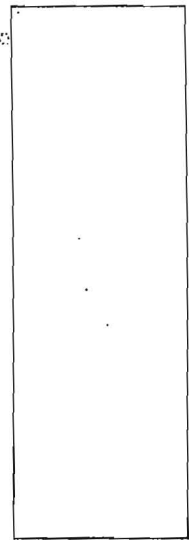
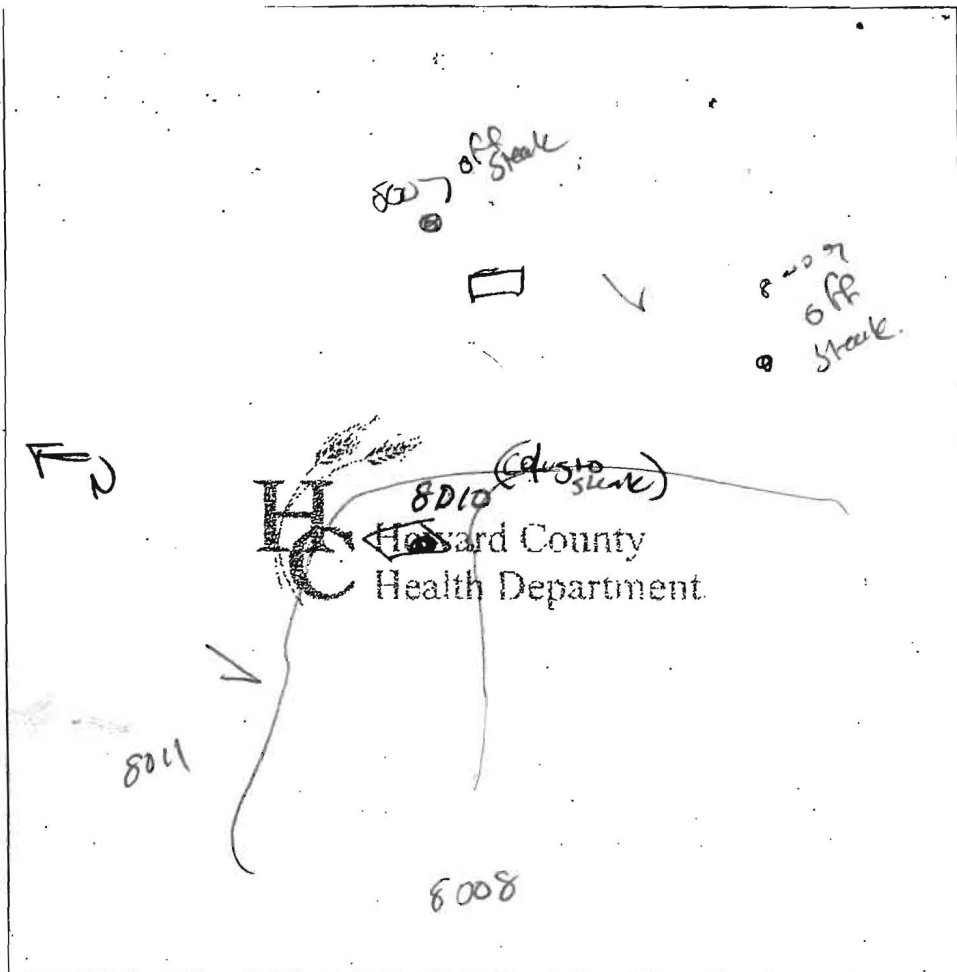
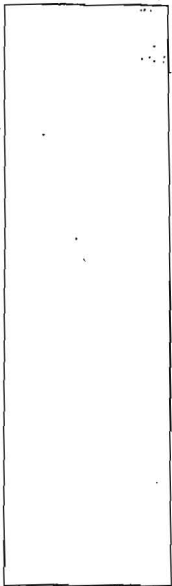

DATE	TEST #	DEPTH	START	BREAK 1" DROP	STOP 2" DROP	TIME OF 2nd INCH	P/F/H
8/5/05	8010	5 / 13	2:12	2:25	2:42	17	P
	8007	5 / 12	2:21	2:23	2:27	3	P
	8009	13	Visual			2+7	P
	8011	5 / 13	2:53	3:13	3:30	22	P
	8008	4 / 13	2:59	3:02	3:06	4	P

REMARKS ~~Adjusting equipment finding well abandonment~~
 SANITARIAN PMY BACKHOE Burdell (L) OTHERS B. Becker
 TEST HOLES USED IN SDA 5 AVG. PERC TIME _____ SQ.-FT/BR _____
 TRENCH WIDTH _____ INLET DEPTH _____ MAX. BOT DEPTH _____ EFFECTIVE SW _____

8
5
108
13
13
10%

13
2 1/2
4
13

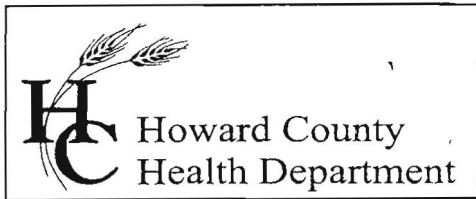

Bureau of Environmental Health
7178 Columbia Gateway Drive, Columbia, MD 21046
(410) 313-2640 Fax (410) 313-2648
TDD (410) 313-2323 Toll Free 1-866-313-6300
website: www.hchealth.org

Penny E. Borenstein, M.D., M.P.H., Health Officer

August 8, 2005

Mr. & Mrs. Bill Blackert
2555 McKendree Rd.
Glenwood MD 21738

RE: PERCOLATION TEST RESULTS-^{A523022}~~A522094~~
Tax Map 14, Parcel 89
Lot 1, Hobbs Rd. Hobbs Property

Dear Mr. Blackert:

Percolation testing conducted August 5, 2005 on the referenced property satisfactory soil conditions. Copies of the test results are enclosed.

Further review is contingent upon submission by a registered engineer/surveyor of a percolation certification plan showing the following:

- 1) Actual locations and elevations of all excavated test holes
- 2) A suitable house and well site for each lot
- 3) Two replacement well sites or approximately 1500 square feet of approvable well area for each lot
- 4) All existing wells and septic reserve areas on the property
- 5) Locations of any other relevant features such as streams, swales, or existing structures
- 6) A note must be included certifying that all existing wells and septic systems within 100 feet of property boundaries have been shown
- 7) A note indicating that depicted topography reflects field-matched information
- 8) A health officer signature block stating "approved for private water and private sewerage systems"
- 9) A MDE sewage disposal area statement is required

The percolation certification plat should be submitted within 60 days to allow field verification if necessary. If you have any questions regarding this matter, please contact me at the above address or by calling (410) 313-1771.

Respectfully,

Peter A. Yencsik
Development Coordination Section
Well and Septic Program

PY
Enclosures
cc: FCC
File

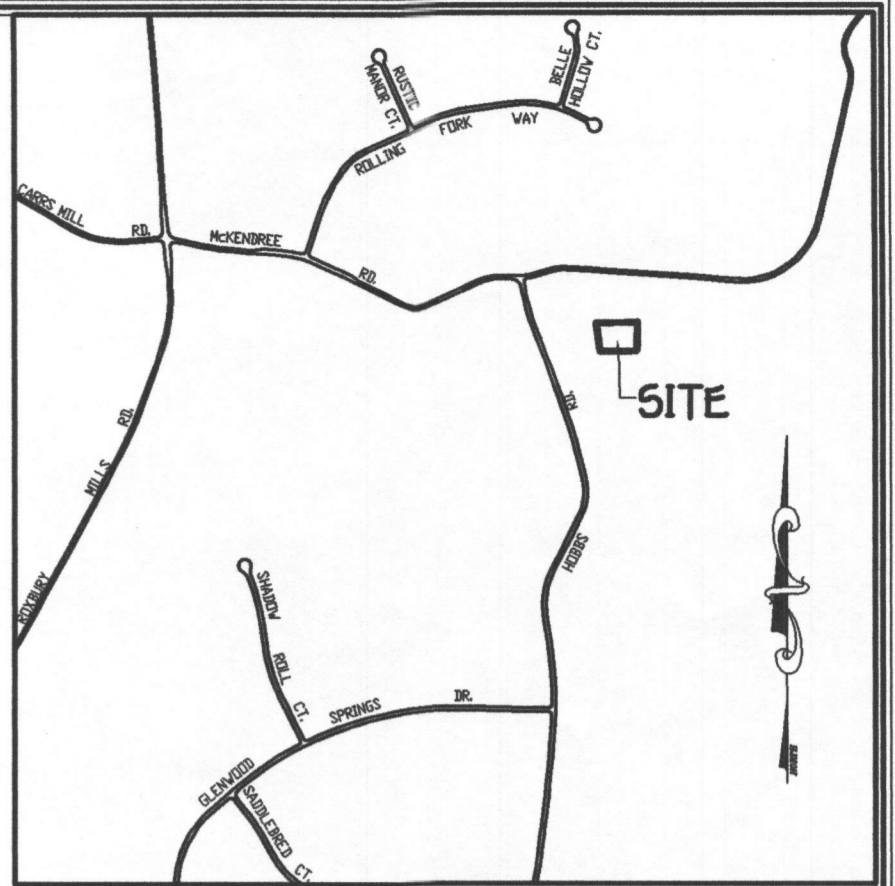
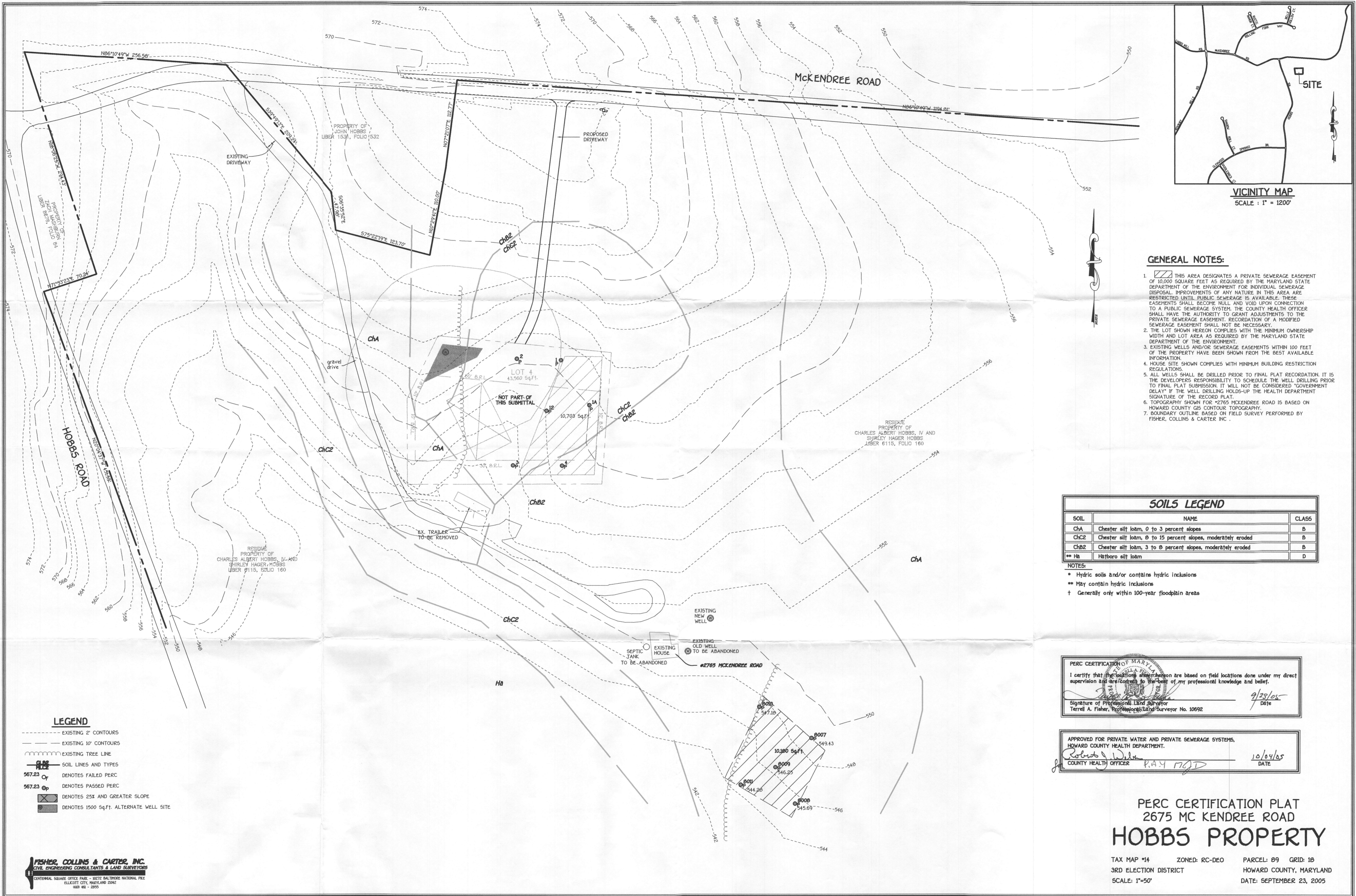

VICINITY MAP
SCALE: 1" = 1200'

GENERAL NOTES:

- THIS AREA DESIGNATES A PRIVATE SEWERAGE EASEMENT OF 10,000 SQUARE FEET AS REQUIRED BY THE MARYLAND STATE DEPARTMENT OF THE ENVIRONMENT FOR INDIVIDUAL SEWERAGE DISPOSAL IMPROVEMENTS OF ANY NATURE IN THIS AREA ARE RESTRICTED UNTIL PUBLIC SEWERAGE IS AVAILABLE. THESE EASEMENTS SHALL BECOME NULL AND VOID UPON CONNECTION TO A PUBLIC SEWERAGE SYSTEM. THE COUNTY HEALTH OFFICER SHALL HAVE THE AUTHORITY TO GRANT ADJUSTMENTS TO THE PRIVATE SEWERAGE EASEMENT. RECORDATION OF A MODIFIED SEWERAGE EASEMENT SHALL NOT BE NECESSARY.
- THE LOT SHOWN HEREON COMPLIES WITH THE MINIMUM OWNERSHIP WIDTH AND LOT AREA AS REQUIRED BY THE MARYLAND STATE DEPARTMENT OF THE ENVIRONMENT.
- EXISTING WELLS AND/OR SEWERAGE EASEMENTS WITHIN 100 FEET OF THE PROPERTY HAVE BEEN SHOWN FROM THE BEST AVAILABLE INFORMATION.
- HOUSE SITE SHOWN COMPLIES WITH MINIMUM BUILDING RESTRICTION REGULATIONS.
- ALL WELLS SHALL BE DRILLED PRIOR TO FINAL PLAT RECORDATION. IT IS THE DEVELOPER'S RESPONSIBILITY TO SCHEDULE THE WELL DRILLING PRIOR TO FINAL PLAT SUBMISSION. IT WILL NOT BE CONSIDERED "GOVERNMENT DELAY" IF THE WELL DRILLING HOLDS-UP THE HEALTH DEPARTMENT SIGNATURE OF THE RECORD PLAT.
- TOPOGRAPHY SHOWN FOR #2765 MCKENDREE ROAD IS BASED ON HOWARD COUNTY GIS CONTOUR TOPOGRAPHY.
- BOUNDARY OUTLINE BASED ON FIELD SURVEY PERFORMED BY FISHER, COLLINS & CARTER, INC.

SOILS LEGEND

SOIL	NAME	CLASS
ChA	Chester silt loam, 0 to 3 percent slopes	B
ChC2	Chester silt loam, 8 to 15 percent slopes, moderately eroded	B
ChB2	Chester silt loam, 3 to 8 percent slopes, moderately eroded	B
Hb	Hatboro silt loam	D

- NOTES:**
- * Hydric soils and/or contains hydric inclusions
 - ** May contain hydric inclusions
 - † Generally only within 100-year floodplain areas

LEGEND

- EXISTING 2' CONTOURS
- - - EXISTING 10' CONTOURS
- EXISTING TREE LINE
- SOIL LINES AND TYPES
- 567.23 O_f DENOTES FAILED PERC
- 567.23 O_p DENOTES PASSED PERC
- DENOTES 25% AND GREATER SLOPE
- DENOTES 1500 Sq.Ft. ALTERNATE WELL SITE

PERC CERTIFICATION OF MARYLAND
 I certify that the locations shown hereon are based on field locations done under my direct supervision and are correct to the best of my professional knowledge and belief.
 Signature of Professional Land Surveyor: Terrell A. Fisher, Professional Land Surveyor No. 10692
 Date: 9/23/05

APPROVED FOR PRIVATE WATER AND PRIVATE SEWERAGE SYSTEMS,
 HOWARD COUNTY HEALTH DEPARTMENT.
 Signature of Professional Land Surveyor: Robert A. Wile
 COUNTY HEALTH OFFICER: KAY MGD
 Date: 10/04/05

PERC CERTIFICATION PLAT
 2675 MC KENDREE ROAD
HOBBS PROPERTY

TAX MAP #14 ZONED: RC-DEO PARCEL: 89 GRID: 18
 3RD ELECTION DISTRICT HOWARD COUNTY, MARYLAND
 SCALE: 1"=50' DATE: SEPTEMBER 23, 2005

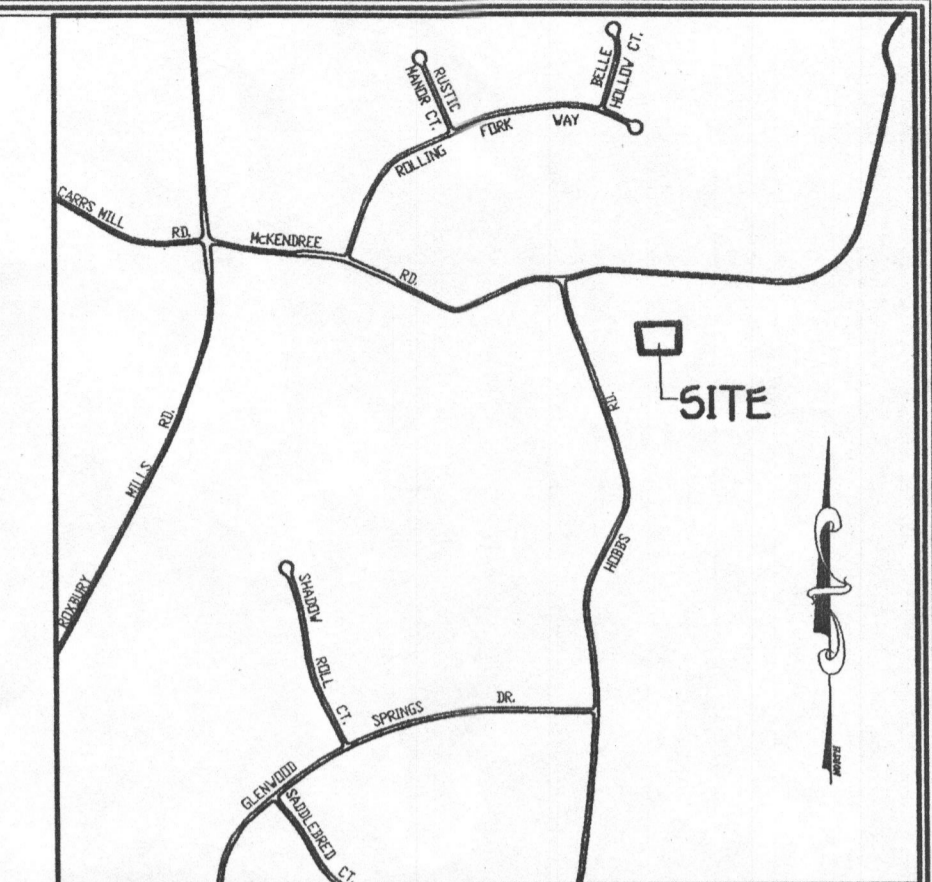
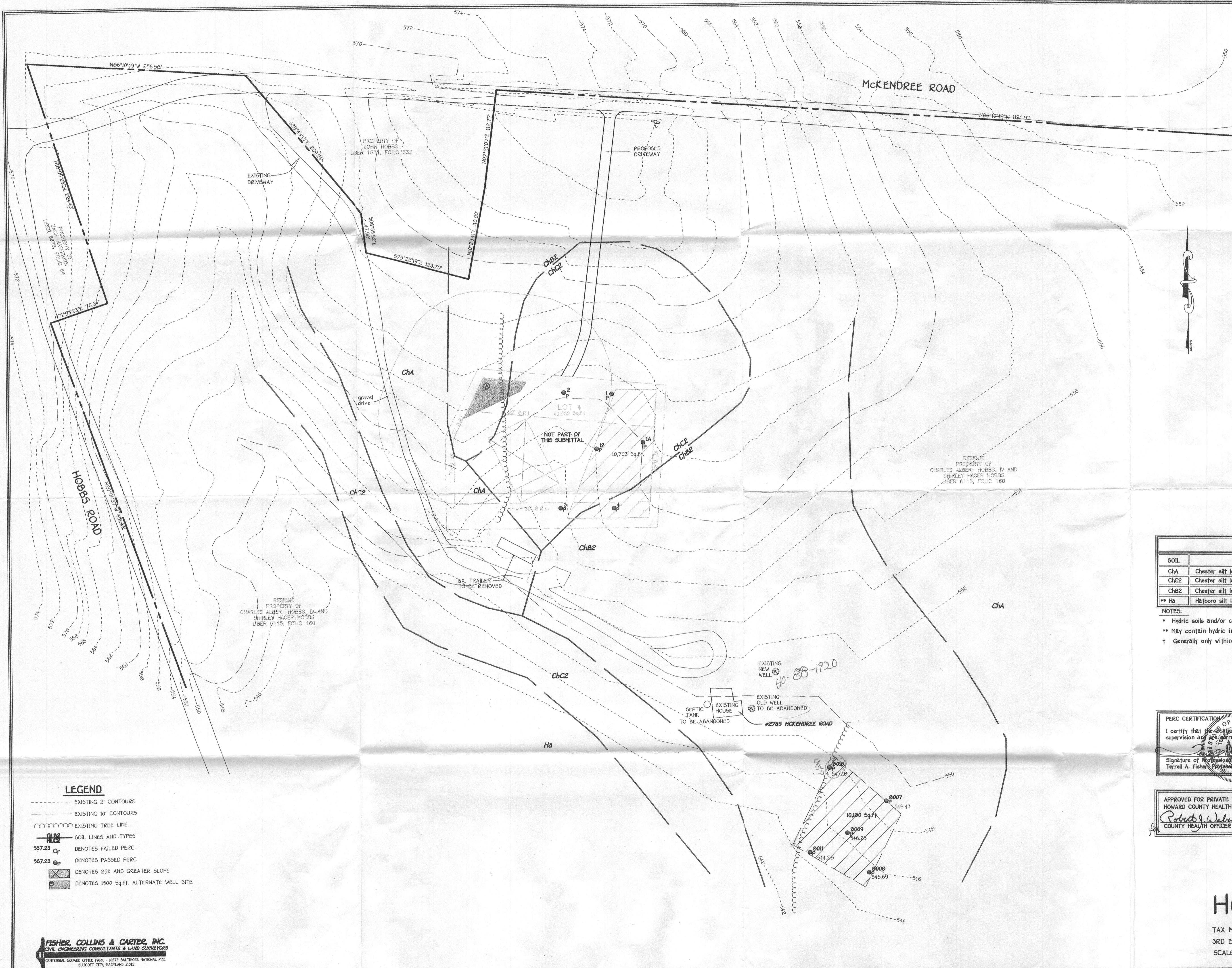

VICINITY MAP
SCALE: 1" = 1200'

GENERAL NOTES:

- THIS AREA DESIGNATES A PRIVATE SEWERAGE EASEMENT OF 10,000 SQUARE FEET AS REQUIRED BY THE MARYLAND STATE DEPARTMENT OF THE ENVIRONMENT FOR INDIVIDUAL SEWERAGE DISPOSAL IMPROVEMENTS OF ANY NATURE IN THIS AREA ARE RESTRICTED UNTIL PUBLIC SEWERAGE IS AVAILABLE. THESE EASEMENTS SHALL BECOME NULL AND VOID UPON CONNECTION TO A PUBLIC SEWERAGE SYSTEM. THE COUNTY HEALTH OFFICER SHALL HAVE THE AUTHORITY TO GRANT ADJUSTMENTS TO THE PRIVATE SEWERAGE EASEMENT. RECORDATION OF A MODIFIED SEWERAGE EASEMENT SHALL NOT BE NECESSARY.
- THE LOT SHOWN HEREON COMPLIES WITH THE MINIMUM OWNERSHIP WIDTH AND LOT AREA AS REQUIRED BY THE MARYLAND STATE DEPARTMENT OF THE ENVIRONMENT.
- EXISTING WELLS AND/OR SEWERAGE EASEMENTS WITHIN 100 FEET OF THE PROPERTY HAVE BEEN SHOWN FROM THE BEST AVAILABLE INFORMATION.
- HOUSE SITE SHOWN COMPLIES WITH MINIMUM BUILDING RESTRICTION REGULATIONS.
- ALL WELLS SHALL BE DRILLED PRIOR TO FINAL PLAT RECORDATION. IT IS THE DEVELOPER'S RESPONSIBILITY TO SCHEDULE THE WELL DRILLING PRIOR TO FINAL PLAT SUBMISSION. IT WILL NOT BE CONSIDERED "GOVERNMENT DELAY" IF THE WELL DRILLING HOLDS-UP THE HEALTH DEPARTMENT SIGNATURE OF THE RECORD PLAT.
- TOPOGRAPHY SHOWN FOR #2765 MCKENDREE ROAD IS BASED ON HOWARD COUNTY GIS CONTOUR TOPOGRAPHY.
- BOUNDARY OUTLINE BASED ON FIELD SURVEY PERFORMED BY FISHER, COLLINS & CARTER INC.

SOILS LEGEND

SOIL	NAME	CLASS
ChA	Chester silt loam, 0 to 3 percent slopes	B
ChC2	Chester silt loam, 0 to 15 percent slopes, moderately eroded	B
ChB2	Chester silt loam, 3 to 8 percent slopes, moderately eroded	D
Ha	Harboro silt loam	D

- NOTES:
- * Hydric soils and/or contains hydric inclusions
 - ** May contain hydric inclusions
 - † Generally only within 100-year floodplain areas

PERC CERTIFICATION OF MARYLAND
 I certify that the data shown hereon are based on field locations done under my direct supervision and are correct to the best of my professional knowledge and belief.
 Signature of Professional Land Surveyor: *Terrell A. Fisher* Date: *9/23/05*
 Terrell A. Fisher, Professional Land Surveyor No. 10692

APPROVED FOR PRIVATE WATER AND PRIVATE SEWERAGE SYSTEMS,
 HOWARD COUNTY HEALTH DEPARTMENT.
 Signature of County Health Officer: *Robert A. Walker* Date: *10/17/05*
 COUNTY HEALTH OFFICER P.A.Y. MJD

PERC CERTIFICATION PLAT
 2675 MC KENDREE ROAD
HOBBS PROPERTY

TAX MAP #14 ZONED: RC-DEO PARCEL: 89 GRID: 18
 3RD ELECTION DISTRICT HOWARD COUNTY, MARYLAND
 SCALE: 1"=50' DATE: SEPTEMBER 23, 2005

- LEGEND**
- EXISTING 2' CONTOURS
 - EXISTING 10' CONTOURS
 - EXISTING TREE LINE
 - SOIL LINES AND TYPES
 - 567.23 \odot DENOTES FAILED PERC
 - 567.23 \odot DENOTES PASSED PERC
 - \otimes DENOTES 25% AND GREATER SLOPE
 - \oplus DENOTES 1500 Sq.Ft. ALTERNATE WELL SITE

I:\05001\dwg\05001-3001 TPOD 2564 Mc. kendree Road.dwg, 9/23/2005 3:07:30 PM