

APPLICATION

19188

SEWAGE DISPOSAL TESTING

STATE OF MARYLAND - DEPARTMENT OF HEALTH AND MENTAL HYGIENE

HOWARD COUNTY HEALTH DEPARTMENT
ENVIRONMENTAL HEALTH SERVICES
P. O. BOX 476, ELLICOTT CITY, MARYLAND 21043
TELEPHONE: 469-8000, EXT. 396

DISTRICT 4th

DATE 10/30/73

TO: THE COUNTY HEALTH OFFICER
ELLICOTT CITY, MARYLAND

I, HEREBY, APPLY FOR THE NECESSARY TEST IN ORDER TO CONSTRUCT (OR RECONSTRUCT) A SEWAGE DISPOSAL SYSTEM.

PROPERTY OWNER JUSTICE TRACT, JOINT VENTURE

ADDRESS 1131 University Blvd. W. #215, Silver Spring, Md. 20902 PHONE 301-649-1500

PROPERTY LOCATION:

SUBDIVISION Glenwood Estates

LOT NO. 13

13 Sec I

ROAD AND DESCRIPTION S.E. Quadrant of intersection of Shady Lane & Burntwoods Rd.

SIZE OF LOT 2.7 ACRES 49,000 s.f. TYPE BLDG. 3-4 Bedrooms

NUMBER OF BEDROOMS

IF NOT SINGLE RESIDENCE DESCRIBE _____

THE SYSTEM INSTALLED UNDER THIS APPLICATION IS ACCEPTABLE ONLY UNTIL PUBLIC FACILITIES BECOME AVAILABLE.

SIGNATURE OF APPLICANT Justice Tract, Joint Venture: By Martin Royal Partner

APPROVED BY _____ FOR _____ DATE _____
(KIND OF SYSTEM)

REJECTED BY _____ FOR _____ DATE _____
(KIND OF SYSTEM)

HOLD PENDING FURTHER TESTS _____ DATE _____

REASONS FOR REJECTION OR HOLDING _____

THIS IS NOT A PERMIT

Combine 1/4 lot 14, use trenches

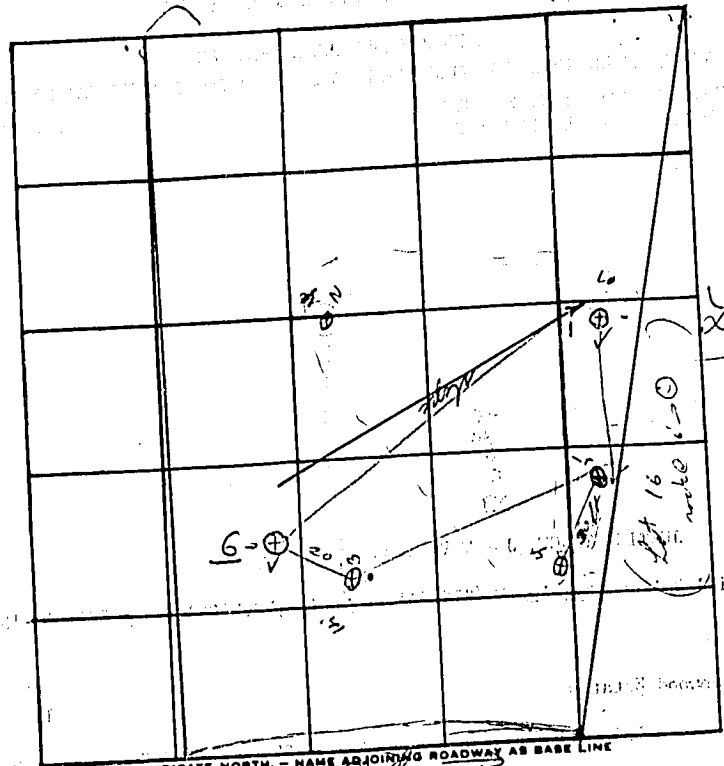

INDICATE NORTH - NAME ADJOINING ROADWAY AS BASE LINE

DATE	TEST NO.	DEPTH	PRE-WET		TEST - 1" DROP		TIME
			START	STOP	START	STOP	
8/16	1	12	10 ⁴⁴	10 ⁴⁶	10 ⁴⁶	10 ⁴⁸	2
	1A	4	10 ⁴⁴	10 ⁵⁴	10 ⁵⁴	11 ⁰¹	10
	(2)	11	vis		Rock (top to bottom)		
	3	5	11 ¹³	11 ²⁵	11 ²⁵	11 ⁴⁸	23
8/30	3A	12	11 ⁴	11 ¹³	11 ¹³	11 ¹⁷	4
	(4)	2	rock				
	5	12	11 ²⁵	11 ⁴⁶	11 ⁴⁶	12 ⁰⁰	14
8/30	6	6	10 ²⁵	10 ³⁰	10 ³⁰	10 ³⁴	8
	6A	12	10 ²⁵	10 ²⁷	10 ²⁷	10 ³⁷	10
	5A	5	10 ²³	10 ²⁷	10 ²⁷	10 ³¹	4

0.5' radius
lean clay
lean clay
lean clay
lean clay

use first {

REMARKS _____
TYPE OF SOIL lean / rock RJM