

PUB. SEWER STATUS VERIFIED BY _____

ISSUE DATE: 05/06/05

PERMIT

P 522449

APPROVAL DATE: 5/17/05

A 59255-A

ON-SITE SEWAGE DISPOSAL SYSTEM HOWARD COUNTY HEALTH DEPARTMENT BUREAU OF ENVIRONMENTAL HEALTH

Jenkins Brothers IS PERMITTED TO INSTALL ALTER

ADDRESS: 7670 Smiths Private Road, Sykesville PHONE NUMBER: 410-461-9282

SUBDIVISION: _____ LOT NUMBER: 5

ADDRESS: 11285 Old Frederick Road PROPERTY OWNER: Edna Mae Cook

SEPTIC TANK CAPACITY (GALLONS): _____

PUMP CHAMBER CAPACITY (GALLONS): _____

NUMBER OF BEDROOMS: _____

SQUARE FEET PER BEDROOM: _____

LINEAR FEET OF TRENCH REQUIRED: _____

TRENCHES:	Trench to be _____ feet wide. Inlet _____ feet below original grade. Bottom maximum depth _____ feet below original grade. Effective area begins at _____ feet below original grade. _____ feet of stone below distribution pipe.
LOCATION:	_____
PURPOSE:	Existing septic system has failed. Call for inspection when ground is opened so sanitarian can recommend repair.

PLANS APPROVED: _____ DATE: _____

- NOTE: PERMIT VOID AFTER 2 YEARS
- NOTE: CONTRACTOR RESPONSIBLE FOR SCHEDULING A PRE-CONSTRUCTION INSPECTION FOR ALL INSTALLATIONS
- NOTE: WATERTIGHT SEPTIC TANKS REQUIRED
- NOTE: ALL PARTS OF SEPTIC SYSTEM SHALL BE 100 FEET FROM ANY WATER WELL
- NOTE: MANHOLE RISERS REQUIRED ON ALL SEPTIC TANKS AND PUMP CHAMBERS

NEITHER THE HOWARD COUNTY COUNCIL OR THE HEALTH DEPARTMENT IS RESPONSIBLE FOR THE SUCCESSFUL OPERATION OF ANY SYSTEM PERMITTEE RESPONSIBLE FOR OBTAINING FINAL APPROVAL ON THIS PERMIT CALL 410-313-2640 FOR INSPECTION OF SEPTIC SYSTEM

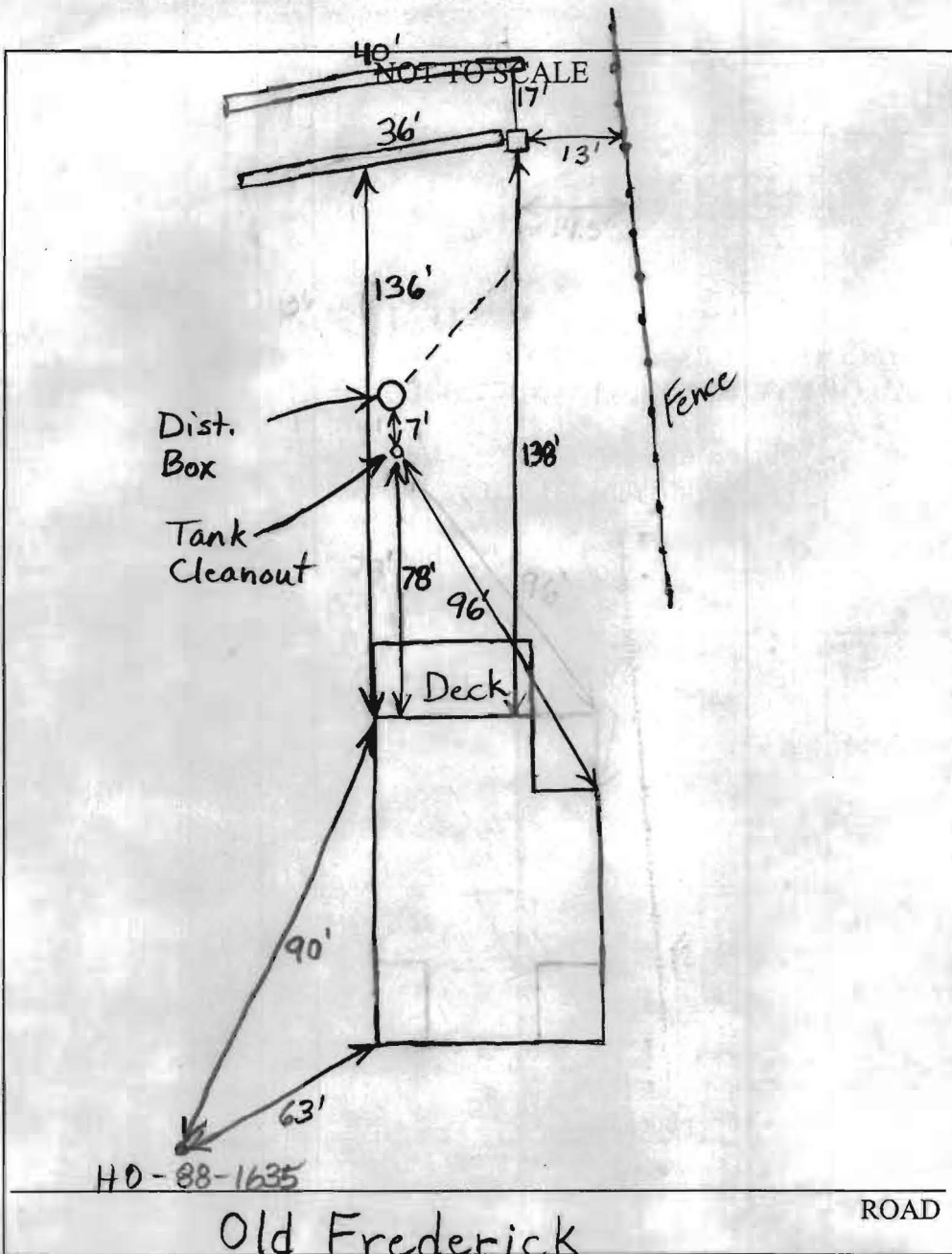

TRENCH/DRAINFIELD DATA		
WIDTH	INLET	BOTTOM
3'	2.5'-3.5'	8'
NUMBER OF TRENCHES		2
TOTAL LENGTH		76'
ABSORPTION AREA		228' + Sidewalk
DISTRIBUTION BOX LEVEL		Leveler
DISTRIBUTION BOX BAFFLE		Yes
DISTRIBUTION BOX PORT		No

SEPTIC TANK DATA	
SEPTIC TANK 1 LEVEL	Existing
CAPACITY	_____ GAL
SEAM LOC	_____
TANK LID DEPTH	_____
BAFFLES	_____
BAFFLE FILTER	_____
MANHOLE LOC	_____
6" PORT LOC	_____
WATERTIGHT TEST	_____
SEPTIC TANK 2 LEVEL	N/A
CAPACITY	_____ GAL
SEAM LOC	_____
TANK LID DEPTH	_____
BAFFLES	_____
BAFFLE FILTER	_____
MANHOLE LOC	_____
6" PORT LOC	_____
WATERTIGHT TEST	_____

PRE-CONSTRUCTION 5/17/05 To install 2 trenches on contour below existing trenches. (BB)

INSTALLATION 5/17/05 Lowest trench disconnected and 2 new trenches installed. Upper 2 trenches still connected to dist. box but no flow going to them. (BB)

FINAL INSPECTOR B. Baber

DATE OF APPROVAL 5/17/05