

8/1/86  
10 AM

8-1-86  
Approved  
S. Abel

# PERMIT

P. 37428

A. 19180

SEWAGE DISPOSAL SYSTEM

MARYLAND STATE DEPARTMENT OF HEALTH

HOWARD COUNTY  
BUREAU OF ENVIRONMENTAL HEALTH  
XXXXXX  
461-9933

ELLCOTT CITY  
DISTRICT 4th

DATE 7/31/86

INDEXED

Dave Hopkins IS PERMITTED TO INSTALL  ALTER   
ADDRESS 17550 Old Frederick Road, Mt. Airy, Maryland PHONE 831-7257  
SUBDIVISION Glenwood Estates ROAD 14620 Mustang Path LOT 6, Section 1  
PROPERTY OWNER Roger Howell  
ADDRESS \_\_\_\_\_

IF GARBAGE GRINDER IS USED INCREASE SEPTIC TANK CAPACITY BY 50% AND ABSORPTION AREA BY 22%.

GARBAGE GRINDER? YES \_\_\_\_\_ NO

SEPTIC TANK CAPACITY 1250 GALLONS NUMBER OF BEDROOMS 4

TRENCHES - 180 sq. ft. per bedroom. Trench to be 2 feet wide. Inlet 4.5 feet below original grade. Bottom maximum depth 9 feet below original grade. Effective area begins at 4.5 feet below original grade. 4.5 feet of stone below distribution pipe.

LOCATION - Place the distribution box 185 feet from the front (160') lot line and 110 feet from the right (285') lot line as seen when facing the property from Mustang path. Run trenches on contour toward left and right lot lines.

NOTE - No trench to exceed 100 feet in length. If more than one trench used, a distribution box is required. Call for inspection of trench(s) before and after gravel is installed. Provide 6" - 8" diameter cleanout and cap to grade or above on septic tank.

PLANS APPROVED BY S. Abel DATE 7/29/86

COVER NO WORK UNTIL INSPECTED AND APPROVED.

NEITHER THE HOWARD COUNTY COUNCIL NOR THE HEALTH DEPARTMENT IS RESPONSIBLE FOR THE SUCCESSFUL OPERATION OF ANY SYSTEM.

NOTE: IF TRENCH IS USED CALL FOR INSPECTION BEFORE AND AFTER PLACING GRAVEL IN TRENCH.

NOTE: NO DRY WELL SHALL EXCEED 15 FOOT IN DIAMETER. NO ABSORPTION TRENCH TO EXCEED 100 FEET IN LENGTH.

NOTE: ALL PIPE FROM HOUSE TO SEPTIC TANK MUST BE CAST IRON OR SCHEDULE 40 PVC OR ABS.

PERMIT VOID AFTER THREE YEARS.

NOTE: INSTALL STAND PIPE ON SEPTIC TANK AND DRY WELL. STAND PIPES MUST BE 6 INCHES IN DIAMETER CAST IRON, CONCRETE OR TERRA COTTA, OR PVC OR ABS ACCEPTED. IF TOP OF SEPTIC TANK IS DEEPER THAN 3 FEET MANHOLE TO GRADE REQUIRED

**\*INSTALLER IS RESPONSIBLE FOR OBTAINING FINAL APROVAL ON THIS PERMIT**

CALL 992-2330 FOR INSPECTION OF SEPTIC SYSTEMS.

EH - 2-1082

A  
10/1/86

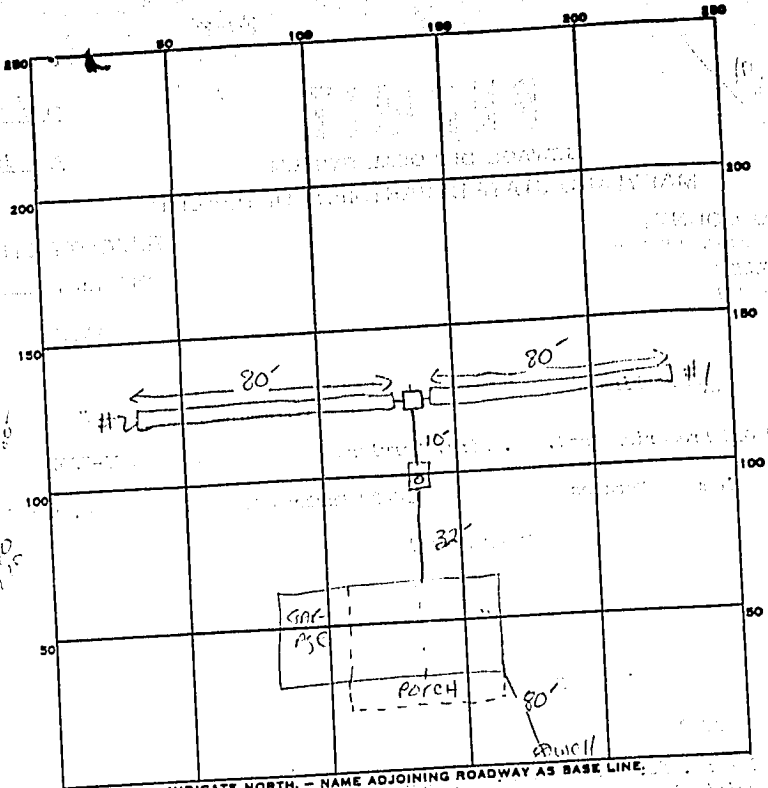

PERMIT CARD

SEPTIC TANK, LEVEL 1500 Y.P.1

CLEANOUTS

DISTRIBUTION BOX, LEVEL

TILE FIELD, DEPTH 9' FT. TRENCH WIDTH 2' FT. Inlet 4.5'

GRAVEL DEPTH 4.5' IN. TOTAL LENGTH 80' FT. TOTAL 160'

NUMBER OF TRENCHES 2 ONE SIDE WALL TOTAL-BOTTOM AREA 720  $\phi$

SEEPAGE PITS, INSIDE DIAMETER \_\_\_\_\_ FT. DEPTH BELOW INLET \_\_\_\_\_ FT.

ABSORBENT AREA 720 SQ. FT.

REMARKS 8-1-86. OK TO START BOTH TRENCHES. S. Abel

DATE SYSTEM APPROVED 8-1-86 INSPECTOR S. Abel