

JULY 24-
✓SAR
7/26/89 NOON P.M.
7/28/89 1:20 PM P.M.

7/26 (2) P.C.O. C.B.D.
7/27 (2) P.C.O. C.B.D.
P 44897

PERMIT

SEWAGE DISPOSAL SYSTEM
MARYLAND STATE DEPARTMENT OF HEALTH

HOWARD COUNTY
BUREAU OF ENVIRONMENTAL HEALTH
461-9933

A Repair
DISTRICT 2nd
DATE 8/24/89
DATE SYSTEM APPROVED 7/28/89
INSPECTOR R.H.

INDEXED

John Chamney IS PERMITTED TO INSTALL _____ ALTER X

ADDRESS 3801 Offutt Road, Randallstown, MD 21133 PHONE 655-0930

SUBDIVISION _____ ROAD 8665 Old Frederick Rd. LOT _____
(3rd house on right heading towards Daniels)

PROPERTY OWNER James E. Streaker

ADDRESS 8665 Old Frederick Road, Ellicott City, MD 21043 Phone: 461-1385

IF GARBAGE GRINDER IS USED INCREASE SEPTIC TANK CAPACITY BY 50% AND ABSORPTION AREA BY 22%.

GARBAGE GRINDER? YES _____ NO

SEPTIC TANK CAPACITY 1000 GALLONS NUMBER OF BEDROOMS _____

*S.S. Abandoned
per Charles Stancer*

REPAIR - Call for an appointment when ground is opened up and Sanitarian will MR.
recommend repair system. 7/28/89

10 DEEP TRENCH 10 FT DEEP 7 FT STONE 2 FT
FT WIDE 540 SQ FT SIDEWALL AREA
ABOUT 77 FT LONG FALL IN OLD TANK & DRYWELL
KEEP NEW TANK & TRENCHES 75 FT OR MORE FROM
THE WELL 3 KP

PLANS APPROVED BY Craig Williams DATE 7/21/89

COVER NO WORK UNTIL INSPECTED AND APPROVED SEE OTHER SIDE

- NEITHER THE HOWARD COUNTY COUNCIL NOR THE HEALTH DEPARTMENT IS RESPONSIBLE FOR THE SUCCESSFUL OPERATION OF ANY SYSTEM
- NOTE: CLEANOUT REQUIRED EVERY 70 FEET OF SEWER LINE AND/OR AT 90° SWEEPS IN LINES FROM HOUSE TO DRAIN FIELDS
 - NOTE: ALL PARTS OF SEPTIC SYSTEMS (I.E. TANK, DISTRIBUTION BOX, TRENCHES) TO BE 100 FEET FROM WELL (UNLESS OTHERWISE SPECIFICALLY AUTHORIZED)
 - NOTE: IF DEEP TRENCH(IES) ARE USED CALL FOR INSPECTION BEFORE AND AFTER PLACING GRAVEL IN TRENCH(IES)
 - NOTE: NO DRY WELL SHALL EXCEED 15 FOOT IN DIAMETER NO ABSORPTION TRENCH TO EXCEED 100 FEET IN LENGTH.
 - NOTE: ALL PIPE FROM HOUSE TO SEPTIC TANK MUST BE CAST IRON OR SCHEDULE 40 PVC OR ABS
- PERMIT VOID AFTER TWO YEARS
- NOTE: INSTALL STAND PIPE ON SEPTIC TANK AND DRY WELL. STAND PIPES MUST BE 6 INCHES IN DIAMETER. CAST IRON, CONCRETE OR TERRA COTTA OR PVC OR ABS ACCEPTED. IF TOP OF SEPTIC TANK IS DEEPER THAN 3 FEET, MANHOLE TO GRADE REQUIRED
 - NOTE: DISTRIBUTION BOXES MUST HAVE BAFFLES

*INSTALLER IS RESPONSIBLE FOR OBTAINING FINAL APROVAL ON THIS PERMIT

*CALL 461-9933 FOR INSPECTION OF SEPTIC SYSTEMS.

244897

①
CLAY
SANDY

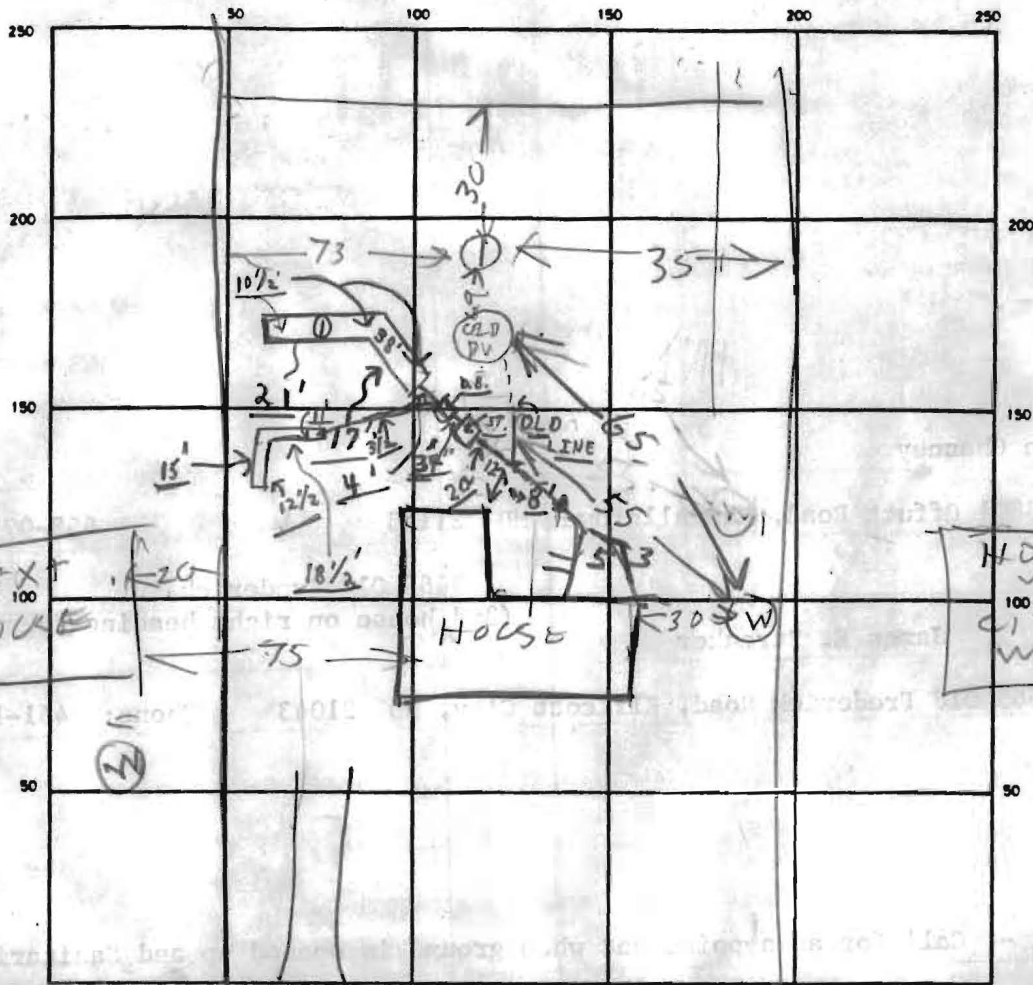

INDICATE NORTH - NAME ADJOINING ROADWAY AS BASE LINE

OLD FREDERICK RD

SEPTIC TANK LEVEL OK CLEANOUTS (Manhole TYPE 7/26 NOT CEMENTED) (7/29 " ")
 DISTRIBUTION BOX LEVEL OK (7/26 Needs baffle)
 DRAIN FIELD/TILE FIELD DEPTH ① 10 1/2 FT. TRENCH WIDTH ② 2 FT. INLET DEPTH 3 FT.
 EFFECTIVE GRAVEL DEPTH ① 7 1/2 any FT. TOTAL LENGTH ① 38' ② 322' FT.
 NUMBER OF TRENCHES ② 8 1/2 any 2 ONE SIDEWALL/COVER AREA ① 7x1' ② 285' } 560' SQ FT.
 DRYWELL INSIDE DIAMETER FT. EFFECTIVE DEPTH BELOW INLET ② 2 FT.
 ABSORBENT AREA 560' + SQ. FT.

REMARKS P.C.O. 7/26/89 ① TRENCH #① OK FOR STONE; NO NEW PIPE ANYWHERE;
② Partial - ok to cover #① trench to DIST. BOX - ONLY. c.o.d.
7/27/89 @ P.M. → TRENCH #② IS OK FOR STONE; 12 1/2' tall' deep - signal
sticks; c.o.d. NOTE #① + #② trench only have pipes; no pipe
7/27/89 ② inspection ok to cover final trench to 2' of turn
and leave end open. Need to see house + tank to D.B. connections
also!!
 DATE SYSTEM APPROVED 7/28/89 INSPECTOR 7/28/89 HOOK UP OK Raymond J. Hodges

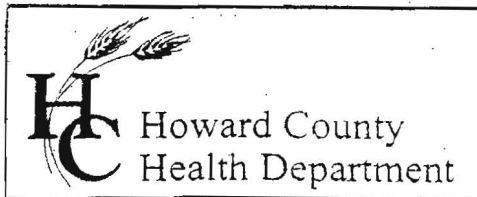

3525 H Ellicott Mills Drive, Ellicott City, MD 21043
(410) 313-2640 Fax (410) 313-2648
TDD (410) 313-2323 Toll Free 1-866-313-6300
website: www.hchealth.org

Penny E. Borenstein, M.D., M.P.H., Health Officer

8/18/03

MEMORANDUM

TO: Charles Stancer
Sandra Land Development, Inc.
16900 Hardy Rd
Mt. Airy, MD 21771

FROM: Steven R. Krieg, R.S. (SRK)
Groundwater Management Section Supervisor
Howard County Health Department
Bureau of Environmental Health
Well and Septic Program

RE: 8665 Old Frederick Road

This is to advise that the Howard County Health Department recommends issuance of the demolition permit for the above referenced property.

The well and septic system which previously served the existing dwelling have been properly disconnected and abandoned. If any other wells or septic systems are found during site work, please notify this office.

cc: DILP ✓

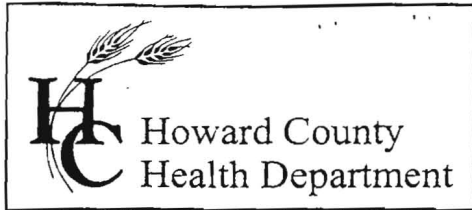

3525 H Ellicott Mills Drive, Ellicott City, MD 21043
(410) 313-2640 Fax (410) 313-2648
TDD (410) 313-2323 Toll Free 1-866-313-6300
website: www.hchealth.org

Penny E. Borenstein, M.D., M.P.H., Health Officer

July 6, 2004

TO: Cindy Hamilton, Chief
Division of Land Development

FROM: Mark Rifkin *MR*
Well and Septic Program

RE: File Number: SDP-04-155
Title: 8665 Old Frederick Road

The Health Department requests that approval of the SDP be delayed until documentation of proper abandonment/sealing of the existing well and septic system has been submitted.

According to Health Dept. records, the well is on the right side of the original house and the septic system is in the rear.

MR
cc: File

Property Type: Residential

Agent Synopsis Report

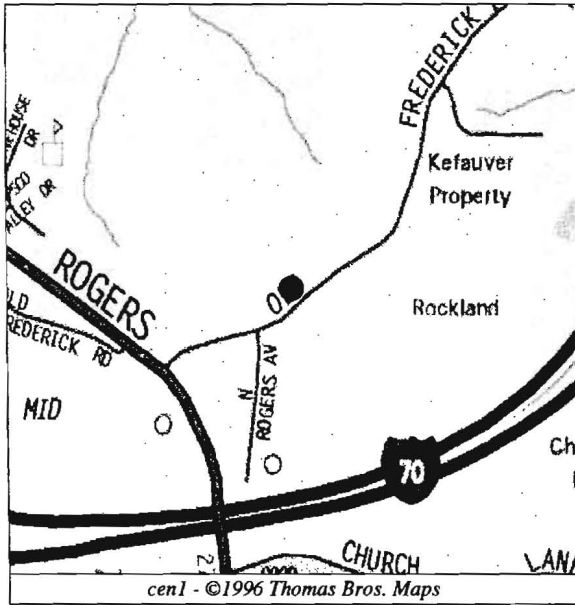
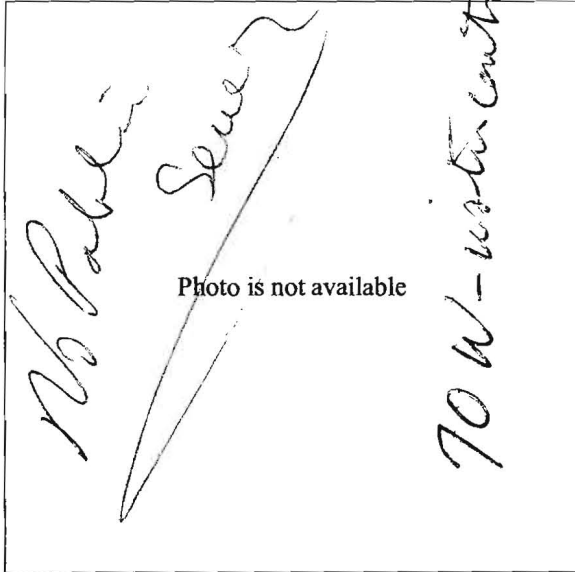

8665 OLD FREDERICK RD, ELLICOTT CITY, MD 21043-1919
MLS#: HW4510258 Status: ACTIVE Ownership: Fee Simple, Sale
Leg Sub: Adv Sub: N/A Map Old/TBM: NA/769A5
Lease Term/Min/Max: //
Total Taxes: \$1,534 Tax Year: 2002 HOA Fee: \$0.00 /mo pd N Area: N/A
Style: Bungalow Type: Detached Model: Yr. Built: 1945

TOTAL	MAIN	UPR1	UPR2	LWR1	LWR2	SCHOOLS	
BR: 5	BR: 3	BR: 2	BR: 0	BR: 0	BR: 0	ES:	#Lvis/#Fpls: 3 /0
FB: 1	FB: 1	FB: 0	FB: 0	FB: 0	FB: 0	MS:	Tot Fin SF: 0
HB:	HB:	HB:	HB:	HB:	HB:	HS:	Lot-SF/AC: 14679/0.34

Main: Living Room, 10X15
Main: Bedroom-Master, 11X11
Main: Bedroom-Second, 10X12
Main: Bedroom-Third, 10X11
Upper 1: Bedroom-Fourth, 13X15

Main: Kitchen, 9X15
Exterior: Fenced - Rear
Exterior Const: Vinyl Siding
Basement: YES, Full, Unfinished
Parking: Drvwy/Off Str
Heat System: Forced Air
Water: Well
Cool System: None
Sewer/Septic: Septic
Appliances: Dryer, Oven/Range-Electric, Washer
WATER Access: N Front: N View: N Dock: N
Roofing: Shingle-Asphalt
Heat Fuel: Oil
Hot Water: Electric
Cool Fuel: None
Listing Co: LONG & FOSTER REAL ESTATE, INC.

Remarks: Unusual offering for Howard County! 3 BR's on 1st flr; 2 on 2nd flr. have tapered roof-line. Kitchen and dining area off Living Room. Nice lot, surrounded by large new homes. Offers opportunity to expand the home and still be close to the shopping and schools. Lited ceiling fan, refrigerator, washer and dryer convey. Storage shed, too.
Listing: 13-MAY-2003 Update: 13-MAY-2003 DOM-MLS: 1 DOM-Prop: 1
Show Instructions: Call Office
Vacation Prop: NO
Directions: RT. 40 TO NORTH ON ROGERS AVENUE TO RIGHT ON OLD FREDERICK (3RD HOUSE ON RIGHT).

Charles Stancer c-443-622-7767

Listing Agent: JACK MARTIN
Agt Off: Home: (410)747-3419
Alt. Agent:
Owner(s): FOSTER LONG
Show Contact(s): SAME LONG & FOSTER
Sub Comp: 3.0 Buy Comp: 3.0
Brkr Code: LNG109
Pager:
Brkr Off: (410)540-9200
Cell:
Home: (410)540-9200
On-Site: (410)540-9200
Dual: Y DesR: VarC: N

**FISHER, COLLINS
& CARTER, INC.**

**CIVIL ENGINEERING CONSULTANTS
and LAND SURVEYORS**

Terrell A. Fisher, P.E., L.S.
Earl D. Collins, P.E.
Ronald B. Carter, L.S.
Charles J. Crovo, Sr., P.E., L.S.

August 16, 2004

Mr. John Boris, Program Director
Well & Septic
Howard County Health Department
3525H Ellicott Mills Drive
Ellicott City, MD 21043

RE: SDP 04-155
Streaker Property, Parcel 89
8665 Old Frederick Road

REVISED
8/16/04

Dear Mr. Boris:

On behalf of our client, Mr. Charles Streaker, and in response to Mr. Rifkin's July 6, 2004, comment regarding the proper abandonment/sealing of the existing well and septic systems on the above referenced property, please be advised that they were demolished under Demolition Permit No. B00143637.

Should you have questions or require further information, please contact this office at 410-461-2855.

Very truly yours,
Fisher, Collins & Carter, Inc.

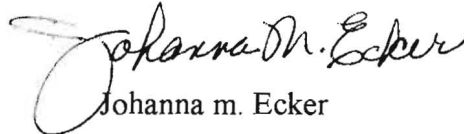
Johanna m. Ecker

WO #61872

HOWARD COUNTY DEPARTMENT OF PLANNING AND ZONING
Division of Land Development

DATE: 8/16/04

DPZ File No. SDP-04-155

Department of Planning and Zoning

- Transportation Planning
- Historic Preservation 4
- Public Service and Zoning Administration
- Research RETURN 2
- Address Coordinator

- Environmental and Community Planning (Ag Pres/Route 1)
- Development Engineering Division
- Other
- File

Agencies

- Soil Conservation District
- Department of Inspections, Licenses & Permits
- Department of Fire and Rescue Services
- State Highway Administration
- Health Department
- Public School System
- Recreation and Parks
- WSSC
- MD Aviation Administration

- Tax Assessment
- Verizon
- BGE
- Cable TV
- Police
- MTA
- Finance
- DPW, Real Estate Services
- DPW, Construction and Inspection
- DPW, Bureau of Utilities

REVISED
8/16/04

RE: 865 OLD FREDERICK ROAD PROP.

ENCLOSED FOR YOUR → Signature Approval Review & Comments Files
 THE ENCLOSED → Original Pre-Packaged Plan Set

Plans	# of Sheets	Supplemental Documents
<input type="checkbox"/> Sketch Plan	_____	<input type="checkbox"/> Wetlands Report
<input type="checkbox"/> Prel Equiv Sketch Plan	_____	<input type="checkbox"/> Soils/Topo Map/Drain Area Map
<input type="checkbox"/> Preliminary Plan	_____	<input type="checkbox"/> FSD/FCP/Worksheet and Application
<input type="checkbox"/> Final Plat/Plat of Easement/RE Plat	_____	<input type="checkbox"/> Declaration of Intent (Forest Cons)
<input type="checkbox"/> Final Constr Plans (RDS)	_____	<input type="checkbox"/> Drainage and/or Computation/Pond Safety Comps
<input type="checkbox"/> Final Development Plan	_____	<input type="checkbox"/> Preliminary Road Profiles
<input checked="" type="checkbox"/> Site Development Plan	<u>1</u>	<input type="checkbox"/> APFO Roads Test/Mitigation Plan/Traffic Study
<input type="checkbox"/> Landscape Plan/Supplemental Plan	_____	<input type="checkbox"/> Noise Study
<input type="checkbox"/> Grading Plan	_____	<input type="checkbox"/> Sight Distance Analysis/Speed Flow Study
<input type="checkbox"/> House Type Revision/Walk-Thru Red-Line	_____	<input type="checkbox"/> Floodplain Study
<input type="checkbox"/> Water and Sewer Plan	_____	<input type="checkbox"/> Stormwater Management Comps/Geo-Tech Report
Applications		<input type="checkbox"/> Industrial Waste Survey (DPW)
<input type="checkbox"/> Waiver Petition Applic/Exhibit	_____	<input type="checkbox"/> Road Poster Form Letter
<input type="checkbox"/> Planning Board Application	_____	<input type="checkbox"/> Response Letter
<input type="checkbox"/> ASDP/CSDP Application	_____	<input type="checkbox"/> Perc Plat
<input type="checkbox"/> DED Application/Checklist	_____	<input type="checkbox"/> Scenic Road Exhibits
<input type="checkbox"/> DED Fee Receipt/Deeds/Cost Estimate	_____	<input type="checkbox"/> Deeds
		<input type="checkbox"/> Photographs
		<input type="checkbox"/> Retaining Wall Comps/Details
		<input type="checkbox"/> Poster/Community or HDC Meeting Information
		<input type="checkbox"/> Route 1 Details/Summary

WAS: Received Tentatively Approved Recorded
 Received and Revised Approved On 8/16/04

COMMENTS: _____ SRC/Comments Due By: 9/1/04

Check, initial and return to the Department of Planning and Zoning if plan is approved with no comments.

[Signature] 8/31/04

DPZ STAFF INITIALS DJ



↑
 G1B2
 3-8-90
 51904
 51905
 ↓

537

18 534

531

528

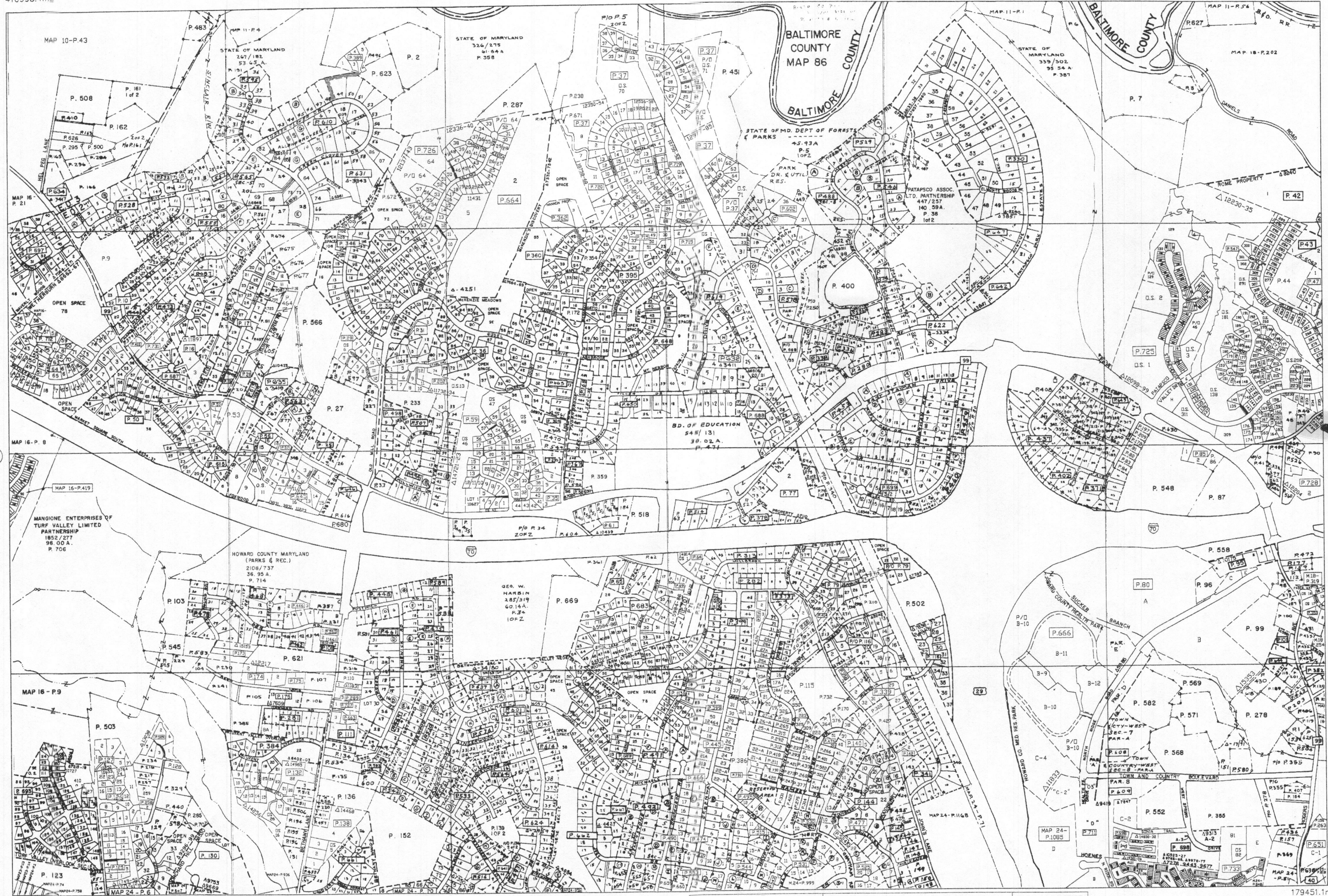

537

534

531

528

18
 3-8-70
 Slopes
 G.L. B2
 G.L. B1
 G.L. B3

Metropolitan Regional Information Systems, Inc.

Date: 05

** PUBLIC RECORD **

Tax ID#: 1402246716

Tax ID#: 1402246716

County: HW

PROPERTY ADDRESS: 8665 OLD FREDERICK RD, , ELLICOTT CITY, MD 21043-1919

OWNER: JAMES E STREAKER, JR Phone #: (410) 461-1385 Abs Owner: N

Addtl: WF

MAIL ADDRESS: 8665 OLD FREDERICK RD, , ELLICOTT CITY, MD 21043-1919

LEGAL DESCRIPTION: IMPS1 LOT 8665 OLD FREDERICK RD ELLICOTT CITY

Mag/Dist #: 2

Lot: 8665

Block/Square: Tax Map:

Elec Dist: 2

Legal Unit #:

Grid: 12

Map: 17

Section:

Blk Suffix:

Subdiv Ph:

Add-Parcel Flag/#: /

Map Suffix:

Suffix:

Parcel: 89

Sub-Parcel:

TOTAL TAX BILL: \$1,534

State/County Tax: \$1,192

City Tax:

Tax Levy Yr: 2002

Front Foot Fee: \$0

Spec Tax Assmt: \$217

Refuse: \$125

Tax Rate: 1.13

Tax Class:

Homestd/Exempt Status:

Exempt Class: 000

Mult. Class:

ASSESSMENT

Year Assessed	Total Tax Value	Land	Improvement	Land Use	Taxable Assessment
2000	\$109,850	\$80,000	\$29,850	\$	State: \$
Previous	\$105,692	\$65,630	\$31,750	\$	Municipal: \$
Early	\$101,536	\$59,670	\$32,580	\$	City: \$

DEED Deed Liber: 0 Deed Folio: 0 Deed Type:

Transfer Date Price Grantor Grantee

\$0 STREAKER JAMES E JR & WF

PROPERTY DESCRIPTION

Year Built: 1945 Zoning: R20 Census Trct/Blck: 602100/3 Irregular Lot: N
 Square Feet: 14,679 Acreage: 0.34 Land Use: Residential
 Property Class: R Plat Liber/Folio: / Property Card: Quality/Grade: FAIR
 Prop Use: RESIDENTIAL

STRUCTURE DESCRIPTION

	Section 1	Section 2	Section 3	Section 4	Section 5
Construction	Frame				
Story	1B				
Area	784				
Ext Wall:		Roofing: Shingle - Composite		Foundation:	
Stories: 1B	Units: 1		Style:		Year Remodeled: 1945
Total Building Area:		Living Area: 784		Base Sq Ft: 784	Model/Unit Type: SINGLE

FAMILY UNIT

Rooms:	Bsmt Type: Not Specified	Fireplaces:	Garage Type:
Bedrooms:	Bsmt Tot Sq Ft: 784	Fireplace Type:	Garage Sq Ft:
Full Baths: 1	Bsmt Fin Sq Ft:	Attic Type:	Gar Constr:
Half Baths: 0	Bsmt Unfin Sq Ft:	Attic Sq Ft:	Garage Spaces:
Baths: 1	Air Cond:		
Gas:	Heat: Forced Air	Sewer:	Fuel:
Electric:	Water:	Underground:	Walls:

8665 OLD FREDERICK RD, ELLICOTT CITY, MD 21043-1919

STATUS: ACTIVE

Ownership: Fee Simple, Sale

Legal Sub:

Adv Sub: N/A

Lot-SF: 14679

Lot-Acres: 0.34

#Lvs: 3 #Fpls: 0

Main Entrance:

Tax Map:

Oth Fee: /mo pd

Lot/Block/Square: 8665

Style: Bungalow

Type: Detached

THType:

Parcel: 89

HOA FEE: \$0.00 /mo pd None

GROUND RENT:

TAXES: \$1,534

Tax Year: 2002

Tax ID#: 1402246716

Model:

Liber:

LIST PRICE: \$149,000

Classification: Residential

List Type: Excl. Right

Old Map: NA

TBM Map: 769A5

Area: N/A

Age: 58

Year Built: 1945

Finished SF: 0

Folio:

TOTAL	MAIN	UPR1	UPR2	LWR1	LWR2	SCHOOLS
BR: 5	BR: 3	BR: 2	BR: 0	BR: 0	BR: 0	ES:
FB: 1	FB: 1	FB: 0	FB: 0	FB: 0	FB: 0	MS:
HB:	HB:	HB:	HB:	HB:	HB:	HS:
Main: Living Room, 10 X 15			Main: Bedroom-Master, 11 X 11			

Main: Kitchen, 9 X 15

Main: Bedroom-Second, 10 X 12

Main: Bedroom-Third, 10 X 11

Upper 1: Bedroom-Fourth, 13 X 15

Upper 1: Bedroom-Fifth, 13 X 15

Basement: YES, Full, Unfinished

Parking: Drvwy/Off Str

Heat: Forced Air, Oil

Cool: None, None

TV/Cable/Comm:

#Garage/Carport Spaces: /

#Assigned Spaces:

Hot Water: Electric

Water: Well

Sewer/Septic: Septic

INTERIOR: Dryer, Oven/Range-Electric, Washer, Kit-Dining Combo, Screens, Storm Door(s), Storm Windows

EXTERIOR: Vinyl Siding, Shingle-Asphalt, Fenced - Rear, Shed, Level,

REMARKS: Unusual offering for Howard County! 3 BR's on 1st Flr; 2 on 2nd flr. have tapered roof-line. Kitchen and dining area off Living Room. Nice lot, surrounded by large new homes. Offers opportunity to expand the home and still be close to the shopping and schools. Lited ceiling fan, refrigerator, washer and dryer convey. Storage shed, too.

DIRECTIONS: RT. 40 TO NORTH ON ROGERS AVENUE TO RIGHT ON OLD FREDERICK (3RD HOUSE ON RIGHT).

Broker: LONG & FOSTER REAL ESTATE, INC.

Brkr Code: LNG109

Brkr Office: (410)540-9200

Brkr Fax: (410)540-9722

Home: (410)747-3419

Cell:

Listing Agent: JACK MARTIN

Agt Office:

Pager:

Agent Email:

Show Instructions: Call Office

Owner: FOSTER LONG

Showing Contact: SAME LONG & FOSTER

List Date: 13-MAY-2003

Update Date: 13-MAY-2003

Update Type: New

Disclosures: Prop Disclaimer

Documents:

Cur Finance Type: Clear

New Finance Types:

WATER

Water Oriented: N

Phys Dock Conveys: N

Vacation Prop: NO

Water Access: N

Nav Water:

Water View: N

Waterfront: N

H: (410)540-9200

H: (410)540-9200

DOM-MLS: 1

DOM-PROP: 1

Property Condition:

Possession: 31-60 Days CD

SubComp: 3.0

BuyComp: 3.0

Add'l:

Dual: Y

DesR:

VarC: N