

C1 6622

SEQUENCE NO. (MDE USE ONLY)

STATE OF MARYLAND WELL COMPLETION REPORT

THIS REPORT MUST BE SUBMITTED WITHIN 45 DAYS AFTER WELL IS COMPLETED.

COUNTY NUMBER 13

(THIS NUMBER IS TO BE PUNCHED IN COLS. 3-6 ON ALL CARDS)

ST/CO USE ONLY DATE Received DATE WELL COMPLETED Depth of Well PERMIT NO. FROM "PERMIT TO DRILL WELL"

OWNER ITS Corp STREET OR RFD Musgrave Farms Ct TOWN Catonsville SUBDIVISION SECTION 21/12/12 LOT 24

WELL LOG

Not required for driven wells

STATE THE KIND OF FORMATIONS PENETRATED, THEIR COLOR, DEPTH, THICKNESS AND IF WATER BEARING

Table with columns: DESCRIPTION, FEET (FROM, TO), check if water bearing. Rows include Top Soil, Sandy, Sand Stone, MICKA, Sand Stone, MICKA.

GROUTING RECORD

WELL HAS BEEN GROUTED (Y/N), TYPE OF GROUTING MATERIAL (Cement, Bentonite Clay), NO. OF BAGS, NO. OF POUNDS, GALLONS OF WATER, DEPTH OF GROUT SEAL.

CASING RECORD

MAIN CASING TYPE (PL), Nominal diameter (6), Total depth of main casing (60). Includes casing type codes (ST, CO, PL, OT).

OTHER CASING (if used)

Table for other casing with columns for diameter and depth.

SCREEN RECORD

screen type or open hole (HO), insert appropriate code below. Includes screen type codes (ST, BR, PL, HO, OT).

DEPTH (nearest ft.)

DEPTH (nearest ft.) table with rows for casing and screen diameters.

NUMBER OF UNSUCCESSFUL WELLS: 0

WELL HYDROFRACTURED (Y/N)

CIRCLE APPROPRIATE LETTER: A (Well abandoned), E (Electric log), P (Test well converted).

I HEREBY CERTIFY THAT THIS WELL HAS BEEN CONSTRUCTED IN ACCORDANCE WITH COMAR 26.04.04 "WELL CONSTRUCTION"...

DRILLERS LIC. NO. M SD 117, DRILLERS SIGNATURE, LIC. NO. D

SITE SUPERVISOR (sign. of driller or journeyman responsible for sitework if different from permittee)

GRAVEL PACK IF WELL DRILLED WAS FLOWING WELL INSERT F IN BOX 68

MDE USE ONLY (NOT TO BE FILLED IN BY DRILLER) T (E.R.O.S.) W Q

TELESCOPE CASING LOG INDICATOR OTHER DATA

C 3

PUMPING TEST

HOURS PUMPED (3), PUMPING RATE (15), METHOD USED TO MEASURE PUMPING RATE (Bucket), WATER LEVEL (6 ft before, 49 ft when pumping), TYPE OF PUMP USED (S - submersible).

PUMP INSTALLED

DRILLER INSTALLED PUMP (YES/NO), TYPE OF PUMP INSTALLED (S), CAPACITY: GALLONS PER MINUTE (31/35), PUMP HORSE POWER (37/41), PUMP COLUMN LENGTH (43/47), CASING HEIGHT (+ above, - below), LAND SURFACE (2 ft nearest).

LOCATION OF WELL ON LOT

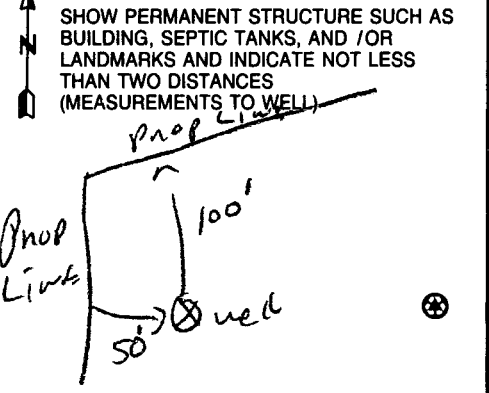

B 1 8926

SEQUENCE NO. (MDE USE ONLY)

STATE OF MARYLAND APPLICATION FOR PERMIT TO DRILL WELL please type 522472

STATE PERMIT NUMBER HD-95-6058 fill in this form completely

Date Received (APA)

OWNER INFORMATION

8 MM DD YY 13

J. T. S. Corp Owner First Name 34 8800 Centre Park Dr. Suite 205 Street or RFD 55 Columbia MD. 21045 Town 70 State 72 Zip 76

B 3 LOCATION OF WELL

Howard COUNTY 21 Musgrove Farm SUBDIVISION 42 SECTION 44 46 LOT 24 48 50 GLENELG NEAREST TOWN 71 MILES FROM TOWN (enter 0 if in town) 2 MI 73 76 77 78

DRILLER INFORMATION

Ralph E. Mayne MS D 112 Driller's Name 76 License No. 81 Ralph E. Mayne Inc Firm Name 17024 Handy Rd Mt Airy MD 21054 Address 7/6/05 Signature 5-14-05 Date

B 4

1 2 DIRECTION OF WELL FROM TOWN (CIRCLE BOX)

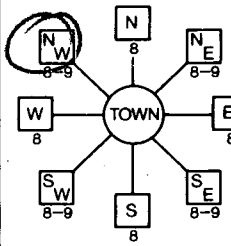

Musgrove Farm Ct NEAR WHAT ROAD 30 ON WHICH SIDE OF ROAD (CIRCLE APPROPRIATE BOX) NORTH SOUTH WEST EAST DISTANCE FROM ROAD 200 FT 34 37 ENTER FT OR MI 38 39 TAX MAP: 21 BLK: 12 PARCEL 12

B 2 WELL INFORMATION APPROX. PUMPING RATE 5 GAL. PER MIN. 8 12 AVERAGE DAILY QUANTITY NEEDED 500 GAL. PER DAY 14 20

USE FOR WATER (CIRCLE APPROPRIATE BOX)

- D DOMESTIC POTABLE SUPPLY & RESIDENTIAL IRRIGATION F FARMING (LIVESTOCK WATERING & AGRICULTURAL IRRIGATION) I INDUSTRIAL, COMMERCIAL, DEWATERING P PUBLIC WATER SUPPLY WELL T TEST, OBSERVATION, MONITORING G GEO-THERMAL

NOT TO BE FILLED IN BY DRILLER HEALTH DEPARTMENT APPROVAL

Howard COUNTY NAME 13 COUNTY NO. STATE SIGNATURE DATE ISSUED 6/20/05 CO SIGNATURE EXP. DATE 6/20/08 NORTH GRID 524 000 EAST GRID 798 000 50 55 57 63

APPROXIMATE DEPTH OF WELL 150 FEET 24 28

APPROXIMATE DIAMETER OF WELL 6" NEAREST INCH

METHOD OF DRILLING (circle one)

BORED (or Augered) JETTED Jetted & DRIVEN AIR-ROTary AIR-PERCussion ROTARY (Hydraulic Rotary) CABLE REVerse-ROTary Drive-POINT other

REPLACEMENT OR DEEPEMED WELLS (CIRCLE APPROPRIATE BOX)

N THIS WELL WILL NOT REPLACE AN EXISTING WELL Y THIS WELL WILL REPLACE A WELL THAT WILL BE ABANDONED AND SEALED S THIS WELL WILL REPLACE A WELL THAT WILL BE USED AS A STANDBY-CONTACT LOCAL APPROVING AUTHORITY FOR POLICY ON STANDBY WELLS D THIS WELL WILL DEEPEMED AN EXISTING WELL PERMIT NUMBER OF WELL TO BE REPLACED OR DEEPEMED (IF AVAILABLE) 41 52

SHOW MAJOR FEATURES OF BOX & LOCATE WELL WITH AN X

SOURCES OF DRILLING WATER 1. well 2. 3.

WRITE THE BOX NUMBER FROM THE MAP HERE

E 525 798 N 890 524

DRAW A SKETCH BELOW SHOWING LOCATION OF WELL IN RELATION TO NEARBY TOWNS AND ROADS AND GIVE DISTANCE FROM WELL TO NEAREST ROAD JUNCTION

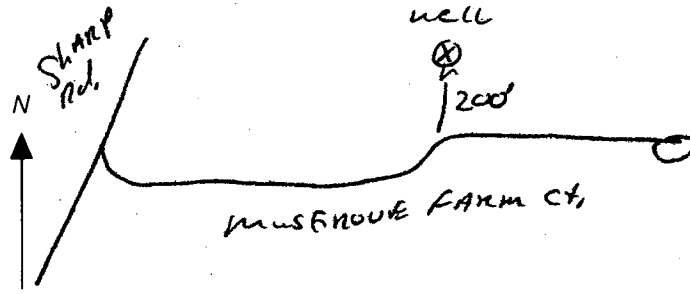

Not to be filled in by driller (MDE OR COUNTY USE ONLY)

APPROX. PERMIT NUMBER HD 2005 G 002 PERMIT No. HD-95-0058 70 71 72 73 74 75 76 77 78 79

SPECIAL CONDITIONS

NOTE - APPROVING AUTHORITIES SHOULD USE SEPARATE SHEET IF NEEDED



**HOWARD COUNTY HEALTH DEPARTMENT  
BUREAU OF ENVIRONMENTAL HEALTH  
WATER AND SEWERAGE PROGRAM  
TEL: (410)313-2640 FAX: (410)313-2643**

Information Form for the Installation of the Well Pump, Pitless Adapter, and Supply Piping

**NOTE:** The installer is responsible for requesting an inspection prior to 9 am on the day of the desired inspection. No work is to be covered until approved by the Health Department. All installations must comply with the National Standard Plumbing Code (NSPC, as amended locally) and COMAR 26.04.04 (MD Well Construction Regulations). Submission of a complete form is required prior to Use and Occupancy approval.

Company Name: Eagles Well Drilling, LLC Telephone #: 443-609-4195  
Address: 1615 Woodbine Rd  
Woodbine, Md 21797

(Must circle one) Licensed Plumber Licensed Well Driller Licensed Well Pump Installer  
License # and name of individual responsible for the field installation:

Name (Print): Allen Compton License# MSD 009

\*A licensed individual must perform the actual installation. Apprentices must be under the direct supervision of a licensed journeyman or master plumber, pump installer or well driller. Licenses may be subjected to field verification.

Name of Property Owner: Ryan Homes Telephone #: \_\_\_\_\_  
Subdivision: Musgrove Farms Lot #: 34 Well Tag #: HO-95-0058  
Site Address: 14347 Musgrove Farm Ct

Submersible Pump Data

Make: Grundfos  
Model #: ISS010-250  
Pump Capacity 15 GPM  
Well Yield: 20+ GPM

Pitless Adapter

Make: Campbell  
Model #: N/A  
Depth: 3/2 (36" min)  
NSF approved: yes

Well Cap and Electric Conduit

Two piece watertight cap: yes  
Screened, vented well cap: yes  
Cap secured to casing: yes  
Conduit min 18" B.G.: yes  
Conduit secured to well cap: yes

Depth of well encountered at time of pump installation: 140 (feet)  
If pump capacity exceeds well yield, a low water cut off switch is required by NSPC 1990 Section 17.8.4

Torque arrestors or Cable guards are required - Must circle one

Safety rope, if used, attached to inside of well casing with eye bolt N/A

Piping to house

Type: 1" Black Plastic  
PSI: 160 (160 psi min)

House Connection

PVC sleeved to undisturbed soil at wall penetration: yes  
Approximate length of sleeve (5 foot minimum): 5

Depth of supply line: 42 (36" min).

Sleeve caulked and sealed properly: yes

The water supply line is required to be at least ten feet from the septic tank, pump chamber, sewage piping, distribution box, drainfields, and sewage reserve area. If this cannot be accomplished, contact this office for approval prior to installation:

Signature of company representative responsible for installation: Allen Compton date: 1-19-10

For Health Department Use Only - Not to be completed by Installer

Date Insp. Requested: \_\_\_\_\_ Date Insp. Approved: 1/15/10 (KW)  
Inspection Data: Pitless adapter and water supply line at least 36" below grade ✓  
Two piece cap installed and attached to casing securely ✓  
Elec. conduit extends at least 18" below grade/attached to cap properly ✓  
Safety rope installed inside of well casing ✓  
Correct well tag attached properly and casing 8" above finished grade ✓  
Water supply line sleeved adequately at house connection ✓  
Adequate grout observed below pitless adapter ✓

APR-25-2005 17:04

J. THOMAS SCRIVENER



Howard County  
Health Department

3525 H Ellicott Mills Drive • Ellicott City, MD 21043  
(410) 313-2640 Fax (410) 313-2648  
TDD (410) 313-2923 Toll Free 1-866-313-6300  
website: www.hchealth.org

Penny E. Borenstein, M.D., M.P.H., Health Officer

**ATTENTION WELL DRILLERS!!!**

*Muscrow Farm*

When submitting a well application for a new or replacement well, please indicate one of the following:

- The well site has been staked by Gutschick Little & Weber PA on 05/05/05 and is ready for site inspection.
- \_\_\_\_\_ will call the Health Department for a time to meet in the field to verify a well location.
- Site plan for new well is attached to well permit application.

Please attach this sheet when submitting your green application. This should help improve communication allowing a more timely service for our citizens.

KN



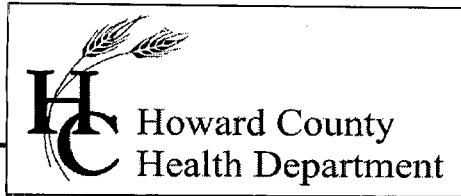

Bureau of Environmental Health  
7178 Gateway Drive Columbia, MD 21046  
(410) 313-2640 Fax (410) 313-2648  
TDD (410) 313-2323 Toll Free 1-866-313-6300  
website: [www.hchealth.org](http://www.hchealth.org)

*Peter Beilenson, M.D., M.P.H., Health Officer*

February 9, 2010

Homeowner  
14347 Musgrove Farm Court  
Glenwood, MD 21738

RE: Musgrove Farm, Lot 24  
14347 Musgrove Farm Court  
BP #: B09002885  
Well Tag: HO-95-0058

Dear Sir:

This is to advise you that the septic system for the above referenced property has been installed and inspected. **Final approval of the septic system was granted on 02/03/2010. Final approval of the well line connection to the dwelling was approved on 01/15/2010.**

The water sample results indicate that the water samples submitted for testing were free of coliform and fecal coliform bacteria at the time of sampling and are bacteriologically safe for drinking. The water sample results were found to be in compliance with COMAR water quality standards. The nitrate sample taken on 02/01/2010 was documented at 9.4 mg/L. EPA's Federal Drinking Water Standard sets the maximum containment level at 10.0 mg/L.

Enclosed with this certificate, is a copy of the septic permit and the as-built along with important information regarding the use and maintenance of your septic system. Please read through carefully and thoroughly. Any questions regarding your well and/or septic, please call this office for guidance 410-313-1771.

#### **INTERIM CERTIFICATE OF POTABILITY**

This certifies that the initial sampling requirements of COMAR 26.04.04 "Well Regulations" have been met for the water supply system installed under well permit #HO-95-0058. Although the submitted sample results are in compliance with COMAR standards, the Health Department does not guarantee water supplies. Based upon satisfactory investigation and evaluation, the Howard County Health Department as authorized by the Maryland Department of the Environment accepts this well system as required by COMAR 26.04.04.

This certificate may become final upon completion of the second bacteriological test, which is to be taken by the county health department within six months of receipt of this letter. In addition to this, a second nitrate sample should be tested at the time of second bacteriological test. **Please contact (410) 313-1773 to schedule a final water sample appointment. Currently, there is no charge for this final sampling.**

Date of Water Samples: 02/01/2010  
Date of Well Completion: 06/14/2006

Approving Authority,

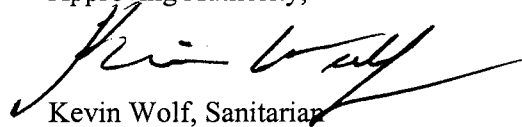
A handwritten signature in black ink, appearing to read "Kevin Wolf", written over a horizontal line.

Kevin Wolf, Sanitarian  
Well & Septic Program

cc: Building Inspector's Office  
Community Health Services  
File

# FOUNTAIN VALLEY ANALYTICAL LABORATORY, INC.

1413 Old Tanktown Rd. Westminster, MD (410) 848-1014 (410) 876-4354 FAX: (410) 848-0298

## REPORT OF ANALYSIS

Laboratory ID #: 74232  
Reference: Ryan Homes Lot 24  
Location: 14347 Musgrove Farm Court  
Glenelg, MD 21737  
Date/ Time Collected: 2/1/2010 1530  
Date/Time Rec'd: 2/1/2010 1630  
Chlorine ppm: Free: ND Total: ND  
Collected By: J. Fogle 1974JF  
Account #: 1930  
Company: Fogle's Well Drilling  
Requested By: Dave Fogle  
Source: Well Water  
Site: Kitchen Sink Tap  
Treatment: None  
pH: 6.2  
Well #: HO-95-0058

PARAMETERS	RESULTS	UNITS	REFERENCE	METHOD	DATE/TIME/ANALYST
Bacteria, Coliform, Total, MPN	<1.0	MPN/ 100 ml	<1.0	SM18 9223	2/2/2010 / 1045 / CCH
Bacteria, E. coli, MPN	<1.0	MPN/ 100 ml	<1.0	SM18 9223	2/2/2010 / 1045 / CCH
Nitrate	9.40	mg/L	10	601	2/2/2010 / 1615 / CCH
Turbidity	0.72	NTU	<10	SM18 2130B	2/2/2010 / 1000 / CCH
Sand	NS	mg/L	5	Visual/Gravimetr	2/2/2010 / 1000 / CCH

### NOTES:

- 1 mg/L = milligrams per liter (also, parts per million)
- 2 MPN/ 100 ml = Most Probable Number [of viable bacteria] per 100 ml of sample.
- 3 NS = None Seen (NS indicates less than 5 mg/L)
- 4 NTU = Nephelometric Turbidity Units
- 5 Results less than or within the reference range are considered satisfactory and within potable water limits at the time of sampling.
- 6 ND:None Detected
- 7 Sample collected by client, analyzed as received
- 8 pH tested on-site

Reason for Test : Use & Occupancy  
Building Permit # : B09002885

Date Reported: 2/2/2010