

SHAPIRO RESIDENCE
SCALE: 1" = 30'

SOILS DESCRIPTION

SYMBOL	HYDROLOGICAL GROUP	DESCRIPTION
BTD	B	BRINKLOW CHANNERY LOAM, 15 TO 25% SLOPES
BTE	B	BRINKLOW-BLOCKTOWN CHANNERY LOAMS, 25 TO 65% SLOPES
Cc	C/D	BOGORUS AND HARBOR SILT LOAMS, 0 TO 3% SLOPES
GgB	B	GLENING LOAM, 8 TO 28% SLOPES
GgC	B	GLENING LOAM, 8 TO 15% SLOPES
MdD	B	MANOR LOAM, 15 TO 20% SLOPES
MkF	B	MANOR-BRINKLOW COMPLEX, 25 TO 65% SLOPES

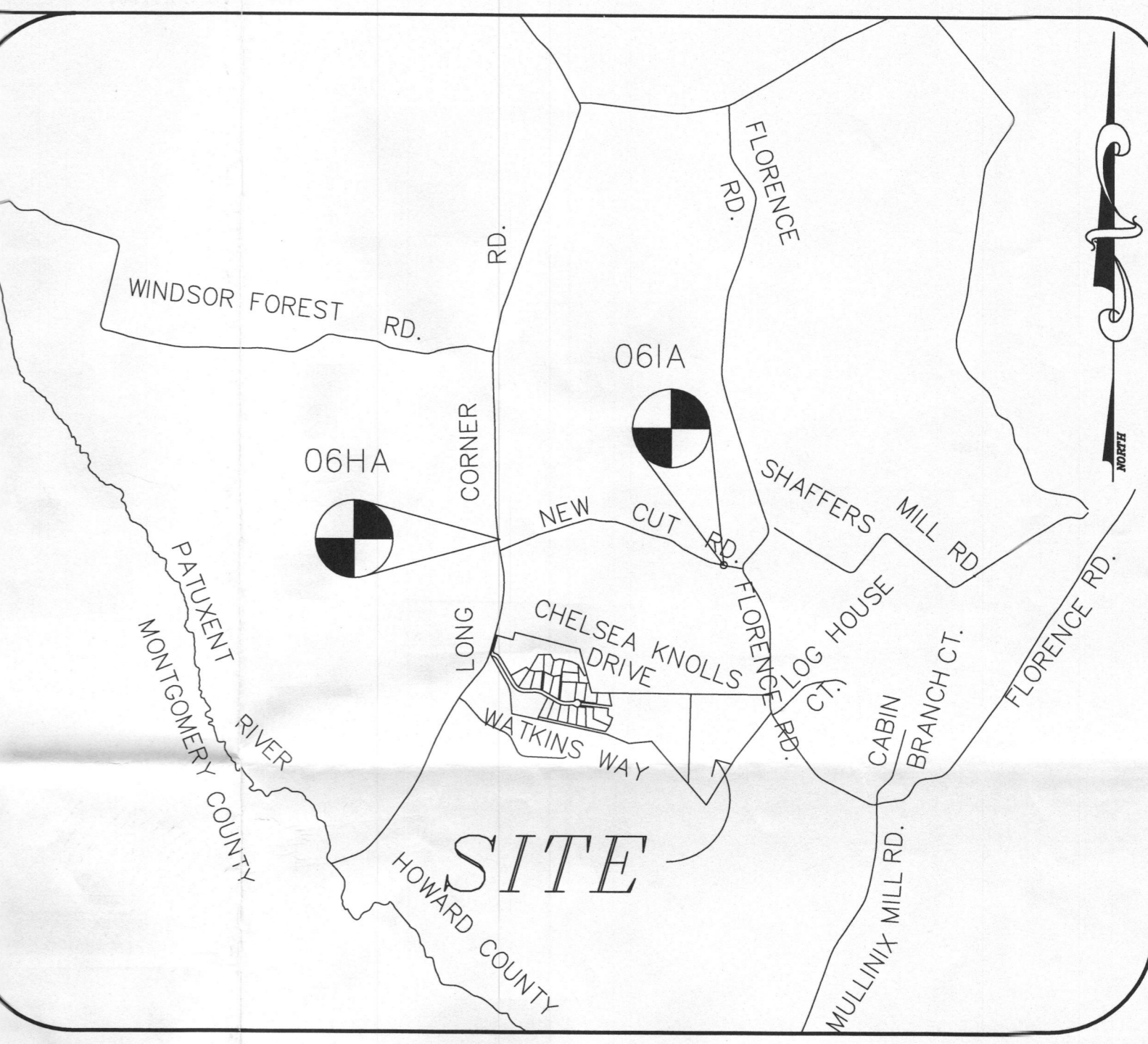

VICINITY MAP
SCALE: 1"=2000'
ADC 14 E-1

GENERAL NOTES:

- THE SUBJECT PROPERTY IS ZONED RC-DEO PER THE 7/28/2006 COMPREHENSIVE ZONING PLAN.
- PARCEL BACKGROUND:**
TAX MAP : 12
PARCEL : 78, BULK PARCEL C, PLAT 22019
DEED REFERENCE: LIBER 14774 FOLIO 467
ELECTION DISTRICT : 4th
ZONING : RC-DEO
AREA : 29.37 ACRES ±
- 2' TOPOGRAPHY FOR THE DEVELOPED AREAS IS BASED ON A FIELD RUN SURVEY BY MILDENBERG BOENDER AND ASSOC. ON OR ABOUT SEP. 2001. 2' TOPOGRAPHY FOR THE NON-DEVELOPED AREAS IS BASED ON HOWARD COUNTY 200 SCALE MAPS.
- PRIVATE WELL AND SEPTIC WILL BE UTILIZED.
- SOILS DATA BASED ON THE USDA SOIL SURVEY OF HOWARD COUNTY, MD, DATED MAY, 2008.
- THIS AREA DESIGNATES A PRIVATE SEWERAGE EASEMENT OF AT LEAST 10,000 SQ. FT. AS REQUIRED BY THE MARYLAND STATE DEPARTMENT OF ENVIRONMENT FOR INDIVIDUAL SEWERAGE DISPOSAL. IMPROVEMENTS OF ANY NATURE IN THIS AREA ARE RESTRICTED UNTIL PUBLIC SEWERAGE IS AVAILABLE. THIS EASEMENT SHALL BECOME NULL AND VOID UPON CONNECTION TO A PUBLIC SEWERAGE SYSTEM. THE COUNTY HEALTH OFFICER SHALL HAVE THE AUTHORITY TO GRANT ADJUSTMENTS TO THE PRIVATE SEWERAGE EASEMENT, & RECORDATION OF A MODIFIED EASEMENT SHALL NOT BE NECESSARY.
- THIS AREA DESIGNATES AN EXISTING SEWERAGE EASEMENT.
- THIS SYMBOL DESIGNATES A PROPOSED WELL LOCATION.
- THIS SYMBOL DESIGNATES A PASSING SEPTIC TEST HOLE.
- THIS SYMBOL DESIGNATES A FAILED SEPTIC TEST HOLE.
- TO THE BEST OF OUR KNOWLEDGE ALL ADJACENT RELEVANT WELL AND SEPTIC SYSTEMS WITHIN 100 FEET OF THE PROPERTY HAVE BEEN SHOWN.
- ANY CHANGES TO A PRIVATE SEWERAGE EASEMENT SHALL REQUIRE A REVISED PERC CERTIFICATION PLAN.
- EXISTING WELLS, SEPTIC SYSTEMS, AND SEWER DISPOSAL AREAS WITHIN 100' OF THE PROPERTY AND THOSE WELLS WITHIN 200' DOWN GRADIENT OF EXISTING OR PROPOSED SEPTIC SYSTEMS OR SEWER DISPOSAL AREAS HAVE BEEN SHOWN.
- THE WELL SHALL BE DRILLED PRIOR TO HEALTH DEPARTMENT APPROVAL OF THE BUILDING PERMIT. IT IS THE DEVELOPER'S RESPONSIBILITY TO SCHEDULE THE WELL DRILLING PRIOR TO APPLYING FOR A BUILDING PERMIT. IT WILL NOT BE CONSIDERED "GOVERNMENT DELAY" IF THE WELL DRILLING HOLDS UP HEALTH DEPARTMENT APPROVAL OF THE BUILDING PERMIT.
- THIS SYMBOL DESIGNATES FAILED WELL ZONE 'A' (FAILED ON OR ABOUT FEBRUARY, 2015).
- THIS SYMBOL DESIGNATES PROPOSED WELL ZONE 'B' & 'C' (IN THE EVENT THAT ADEQUATE WATER IS FOUND IN ONE OF THESE ZONES THE OTHER ZONE WILL BE VOID).

APPROVED FOR PRIVATE WATER AND PRIVATE SEWERAGE SYSTEMS

Michael J. Davis
HOWARD COUNTY HEALTH OFFICER
DATE: 4/6/15

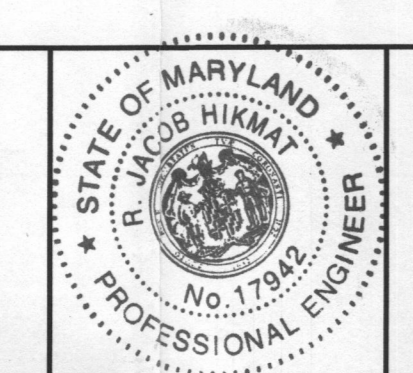

I HEREBY CERTIFY THAT THESE DOCUMENTS WERE PREPARED OR APPROVED BY ME AND THAT I AM A DULY LICENSED PROFESSIONAL ENGINEER UNDER THE LAWS OF THE STATE OF MARYLAND, LICENSE NO. 17942, EXP. DATE 09/03/2016.

R. Jacob Hikmat
R. JACOB HIKMAT
DATE: 4/11/15

OWNER/DEVELOPER

DONNA LYNN SHAPIRO
2082 FLORENCE ROAD
MT. AIRY, MD 21711

Project	13-020	date	APR. 2015
Illustration	MES	engineering	MES
scale	1"=100'	approval	RJH

1. REVISE WELL ZONE LOCATION.	4/07/2015
revisions	date

CHELSEA KNOLLS PARCEL C
TAX MAP 12, GRID 5, PARCEL 78, PLAT 22019
FOURTH ELECTION DISTRICT
HOWARD COUNTY, MARYLAND
PERCOLATION CERTIFICATION PLAN

MILDENBERG, BOENDER & ASSOC., INC.
Engineers Planners Surveyors
6800 Deerpath Road, Suite 150, Elkridge, MD 21075
(410) 997-0296 Fax (410) 997-0298 Fax