

SITE INSPECTION SHEET

OWNER: Cahill PHONE #: \_\_\_\_\_

ADDRESS: 16025 Carrs Mills Rd CONTRACTOR: \_\_\_\_\_

WELL TAG #: N/A

SUBDIVISION: \_\_\_\_\_ LOT: \_\_\_\_\_ COUNTY #: Howard

PROPOSAL: Follow-up for complaint - unpleasant odor  
(see PacTrac for details) 3/14/11

LOCATION DIAGRAM

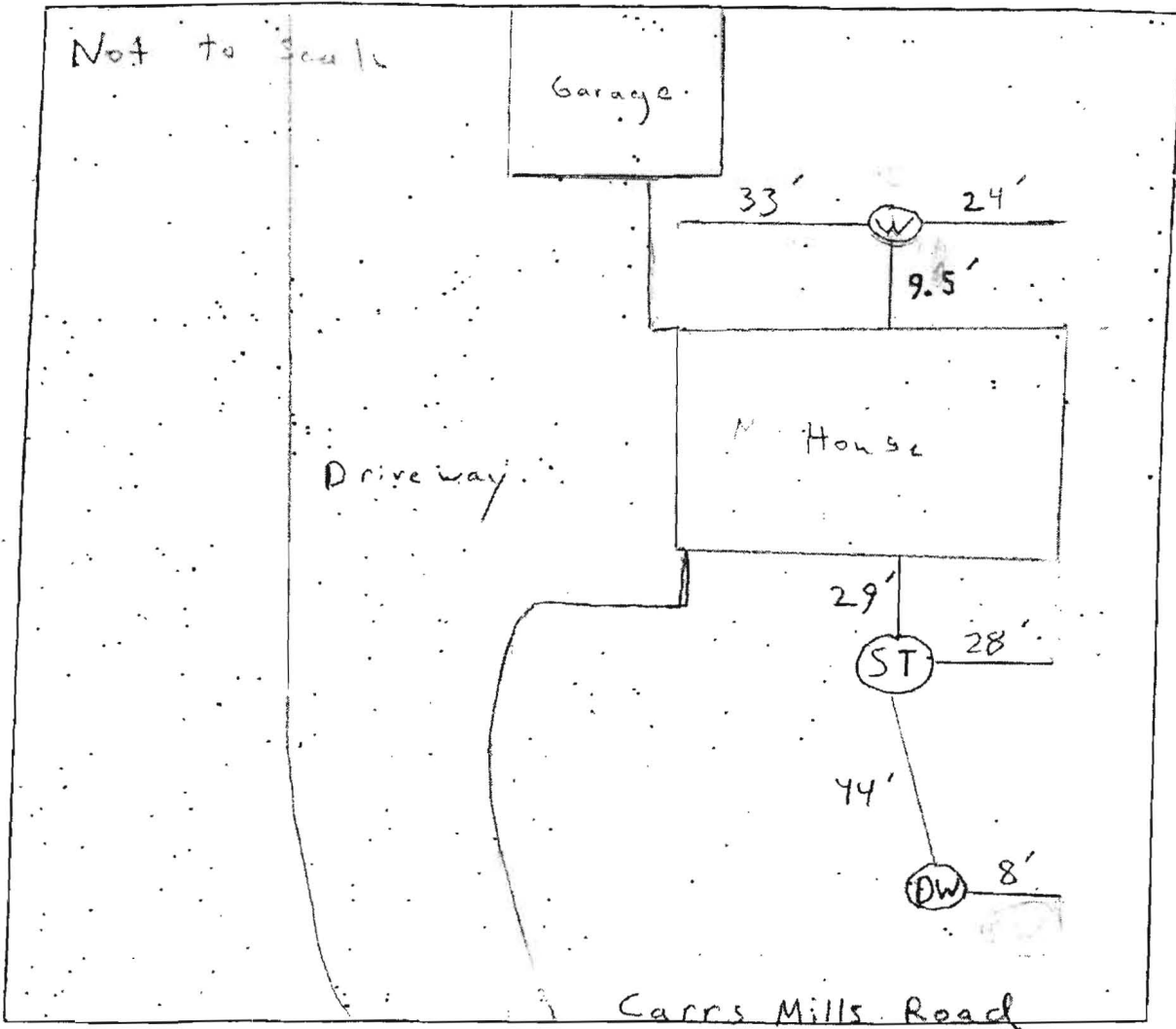

3/14/11  
COMMENTS: ① 7' to 8' to solution in dry well ② Well was  
1-piece cap, 6" diameter casing, conduit was secured and  
rope for the pump needs to be secured inside the well (MT)