

Plat of Survey

4th. Election District - Howard County, Maryland

Scale: 1" = 100'

February, 1975

JUSTICE, JONES & ASSOCIATES, INC.
 ENGINEERS, SURVEYORS & LAND PLANNERS
 2419 REEDS DRIVE
 WHEATON, MARYLAND 20832
 Tel. 949-2011

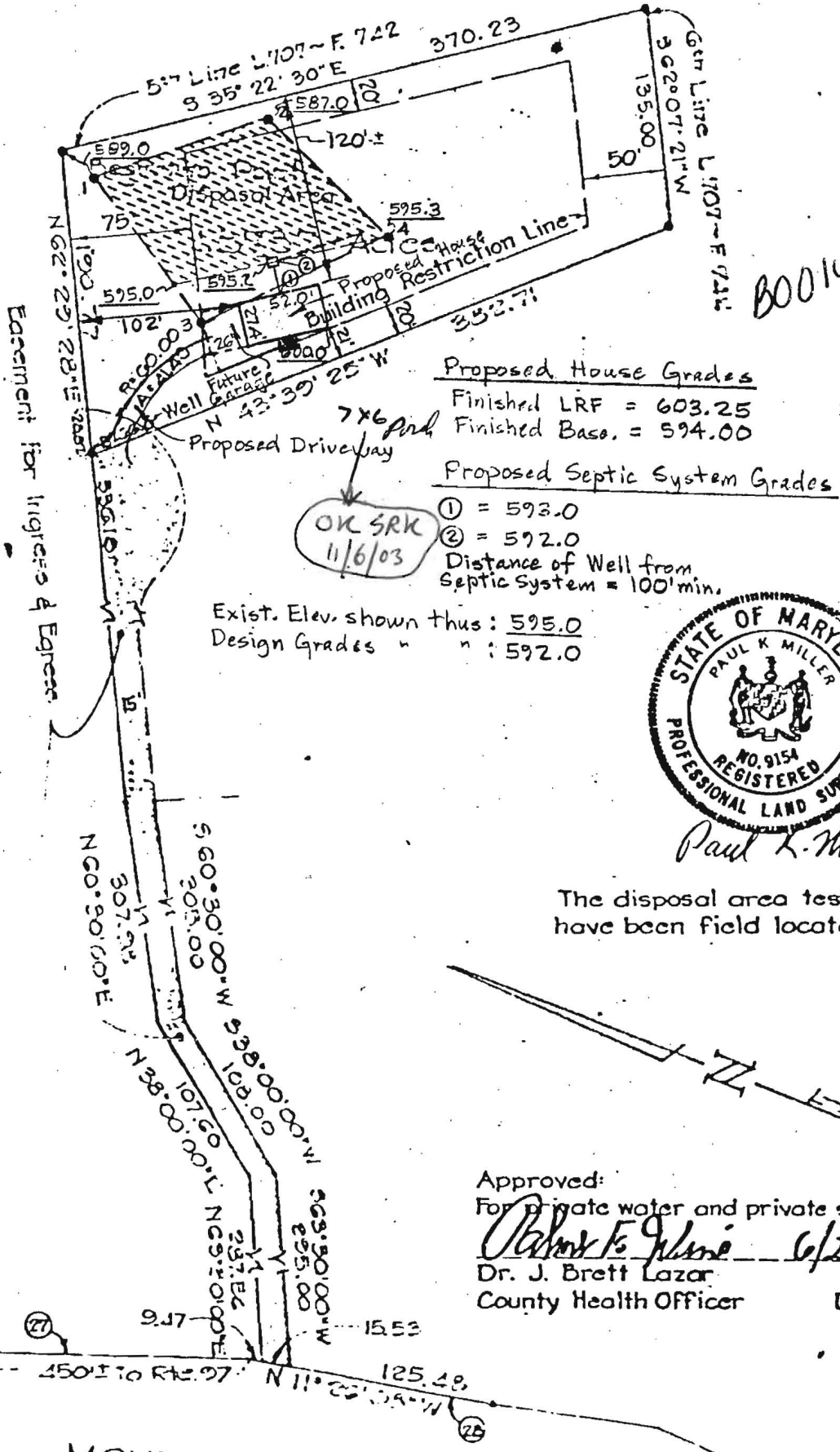

800144981



Paul K. Miller

The disposal area test sites have been field located.

Approved:
 For private water and private sewer
Robert F. Jeline 6/28/75
 Dr. J. Brett Lazar
 County Health Officer Date

MONTICELLO AVENUE
 'Frontage Road'

R/W Line of Through Hwy.
 U.S.H.A. R/W Plat 42430