



Building Permit Application

Howard County Maryland
 Department of Inspections, Licenses and Permits
 3430 Court House Drive
 Permits: 410-313-2455
 www.howardcountymd.gov

Date Received: _____

Permit No. B11005378

Building Address: 12348 Howard Lodge Dr
 City: Silver Spring State: MD Zip Code: 20910
 Suite/Apt. # _____ SDP/WP/BA #: _____
 Census Tract: _____ Subdivision: _____
 Section: _____ Area: _____ Lot: 711
 Tax Map: 9 Parcel: 3010 Grid: 13
 Zoning: _____ Map Coordinates: _____ Lot Size: _____

Existing Use: SED
 Proposed Use: SED with porch
 Estimated Construction Cost: \$ 5000
 Description of Work: Install 1000 sq ft porch on back of property. Porch is 10' x 10'.

Occupant/Tenant Name: _____
 Was tenant space previously occupied? Yes No
 Contact Name: _____
 Address: _____
 City: _____ State: _____ Zip Code: _____
 Phone: _____ Fax: _____
 Email: _____

Property Owner's Name: John J. Linao
 Address: 10519 15th St Silver Spring MD
 City: Silver Spring State: MD Zip Code: 20910
 Phone: _____ Fax: _____
 Email: _____

Applicant's Name & Mailing Address, (if other than stated herein)
 Applicant's Name: Michelle Linao
 Address: 10519 15th St Silver Spring MD
 City: Silver Spring State: MD Zip Code: 20910
 Phone: 410-239-5515 Fax: _____
 Email: _____

Contractor Company: Tom's Inc
 Contact Person: Tom
 Address: 11018 17th St Silver Spring MD
 City: Silver Spring State: MD Zip Code: 20910
 License No.: _____
 Phone: 410-239-5515 Fax: _____
 Email: _____

Engineer/Architect Company: _____
 Responsible Design Prof.: _____
 Address: _____
 City: _____ State: _____ Zip Code: _____
 Phone: _____ Fax: _____
 Email: _____

Commercial Building Characteristics	Residential Building Characteristics	
Height:	<input checked="" type="checkbox"/> SF Dwelling	<input type="checkbox"/> SF Townhouse
No. of stories:	Depth	Width
Gross area, sq. ft./floor:	1 st floor:	
	2 nd floor:	
Area of construction (sq. ft.):	Basement:	
	<input type="checkbox"/> Finished Basement	
Use group:	<input type="checkbox"/> Unfinished Basement	
	<input type="checkbox"/> Crawl Space	
Construction type:	<input type="checkbox"/> Slab on Grade	
<input type="checkbox"/> Reinforced Concrete	No. of Bedrooms:	
<input type="checkbox"/> Structural Steel	Multi-family Dwelling	
<input type="checkbox"/> Masonry	No. of efficiency units:	
<input type="checkbox"/> Wood Frame	No. of 1 BR units:	
<input type="checkbox"/> State Certified Modular	No. of 2 BR units:	
	No. of 3 BR units:	
	Other Structure:	
	Dimensions:	
<input checked="" type="checkbox"/> Roadside Tree Project Permit	Footings:	
<input type="checkbox"/> Yes <input checked="" type="checkbox"/> No	Roof:	
Roadside Tree Project Permit #	<input type="checkbox"/> State Certified Modular	
	<input type="checkbox"/> Manufactured Home	

Utilities	
Electric:	<input type="checkbox"/> Yes <input checked="" type="checkbox"/> No
Gas:	<input checked="" type="checkbox"/> Yes <input type="checkbox"/> No
Water Supply	
<input type="checkbox"/> Public	
<input type="checkbox"/> Private	
Sewage Disposal	
<input type="checkbox"/> Public	
<input checked="" type="checkbox"/> Private	
Heating System	
<input type="checkbox"/> Electric	<input type="checkbox"/> Oil
<input type="checkbox"/> Natural Gas	<input type="checkbox"/> Propane Gas
<input type="checkbox"/> Other:	
Sprinkler System:	
<input type="checkbox"/> Yes	<input checked="" type="checkbox"/> No
Grading Permit Number:	
Building Shell Permit Number:	

THE UNDERSIGNED HEREBY CERTIFIES AND AGREES AS FOLLOWS: (1) THAT HE/SHE IS AUTHORIZED TO MAKE THIS APPLICATION; (2) THAT THE INFORMATION IS CORRECT; (3) THAT HE/SHE WILL COMPLY WITH ALL REGULATIONS OF HOWARD COUNTY WHICH ARE APPLICABLE THERETO; (4) THAT HE/SHE WILL PERFORM NO WORK ON THE ABOVE REFERENCED PROPERTY NOT SPECIFICALLY DESCRIBED IN THIS APPLICATION; (5) THAT HE/SHE GRANTS COUNTY OFFICIALS THE RIGHT TO ENTER ONTO THIS PROPERTY FOR THE PURPOSE OF INSPECTING THE WORK PERMITTED AND POSTING NOTICES.

Applicant's Signature: Michelle Linao Print Name: Michelle Linao
 Email Address: mlinao@broadwaylocoriond.com Date: 12/13/16
 Title/Company: _____

Checks Payable to: DIRECTOR OF FINANCE OF HOWARD COUNTY
 PLEASE WRITE NEATLY & LEGIBLY
 -FOR OFFICE USE ONLY-

AGENCY	DATE	SIGNATURE OF APPROVAL	DPZ SETBACK INFORMATION	Filing Fee	\$
State Highways			Front:	Permit Fee	\$ <u>110</u>
Building Officials			Rear:	Tech Fee	\$
PSZA (Zoning)			Side:	Excise Tax	\$
PSZA (Engineering)			Side St.:	PSFS	\$
Health	<u>4/3/17</u>	<u>R. Bickel</u>	All minimum setbacks met? <input type="checkbox"/> Yes <input type="checkbox"/> No	Guaranty Fund	\$
			Is Entrance Permit Required? <input type="checkbox"/> Yes <input type="checkbox"/> No	Add'l per Fee	\$
			Historic District? <input type="checkbox"/> Yes <input type="checkbox"/> No	Total Fees	\$
			Lot Coverage for New Town Zone:	Sub- Total Paid	\$ <u>110</u>
			SDP/Red-line approval date:	Balance Due	\$
				Check #	<u>5027</u>

SOILS LEGEND			
SYMBOL	NAME / DESCRIPTION	GROUP	'K' FACTOR
GgB	GLENELG LOAM, 3 TO 8 PERCENT SLOPES	B	0.20
GmB	GLENVILLE SILTY LOAM, 3 TO 8 PERCENT SLOPES	C	0.37

NOTES:
 1) SOIL INFORMATION HAS BEEN TAKEN FROM THE UNITED STATES DEPARTMENT OF AGRICULTURE, NATURAL RESOURCES CONSERVATION SERVICE, WEB SOIL SURVEY.
 2) HIGHLY ERODIBLE SOILS ARE THOSE SOILS WITH A SLOPE GREATER THAN 15 PERCENT OR THOSE SOILS WITH A SOIL ERODIBILITY FACTOR 'K' GREATER THAN 0.35 AND WITH A SLOPE GREATER THAN 5 PERCENT.

LEGEND

- EXISTING CONTOUR
- PROPOSED CONTOUR
- PROPOSED SPOT ELEVATION
- DIRECTION OF FLOW
- PROPOSED WELL LOCATION
- SOIL BOUNDARY
- LIMIT OF DISTURBANCE
- EXISTING WETLANDS
- WETLAND BUFFER
- PROPOSED DRY WELL
- EXISTING DRAINAGE DIVIDE

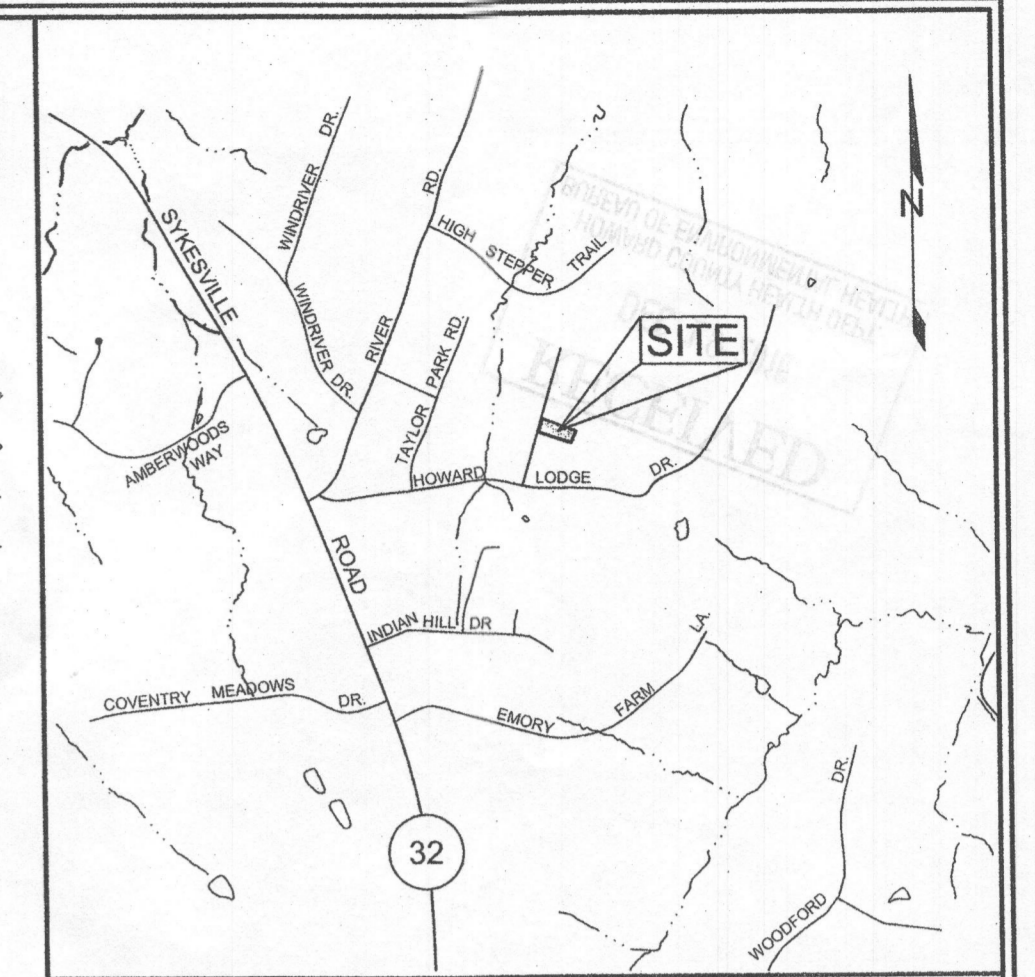

VICINITY MAP
SCALE: 1"=2000'



GENERAL NOTES

1. SUBJECT PROPERTY ZONED RR-DEO PER 02/02/04 COMPREHENSIVE ZONING PLAN.
2. TOTAL AREA OF PROPERTY = 1.25 AC ±.
3. PRIVATE WATER AND PRIVATE SEWER WILL BE USED WITHIN THIS SITE.
4. THIS AREA DESIGNATES A PRIVATE SEWAGE EASEMENT, OF AT LEAST 10,000 SF AS REQUIRED BY THE MARYLAND STATE DEPARTMENT OF THE ENVIRONMENT FOR INDIVIDUAL SEWAGE DISPOSAL (COMAR 26.04.03). IMPROVEMENTS OF ANY NATURE IN THIS AREA ARE RESTRICTED UNTIL PUBLIC SEWERAGE IS AVAILABLE. THESE EASEMENTS SHALL BECOME NULL AND VOID UPON CONNECTION TO A PUBLIC SEWERAGE SYSTEM. THE COUNTY HEALTH OFFICER SHALL HAVE THE AUTHORITY TO GRANT ADJUSTMENTS TO THE PRIVATE SEWAGE EASEMENT. RECORDATION OF A MODIFIED SEWAGE EASEMENT SHALL NOT BE NECESSARY.
5. THE BOUNDARY SHOWN HEREON IS BASED ON HOWARD COUNTY A FIELD RUN BOUNDARY SURVEY PREPARED BY ADCOCK & ASSOCIATES, LLC IN MAY 2015.
6. PROPERTY ADDRESS: 12348 HOWARD LODGE DRIVE
7. THE TOPOGRAPHY SHOWN HEREON WAS FIELD RUN BY ADCOCK & ASSOCIATES, IN MAY 2015. REFERENCES: LIBER 2224, FOLIO 389
8. THE LOTS SHOWN HEREON COMPLY WITH THE MINIMUM OWNERSHIP, WIDTH AND LOT AREA AS REQUIRED BY THE MARYLAND DEPARTMENT OF THE ENVIRONMENT.
9. THE LOWER AREA OF THE SEPTIC DISPOSAL AREA (SDA) WAS TESTED AND ANALYZED FOR A SAND MOUND SYSTEM. THE SAND MOUND DESIGN WAS BASED ON A SIX PERCENT (6%) GRADE AND FOUR BEDROOMS, UTILIZING A 9'X6' ABSORPTION BED AND 35'X4' FINAL DIMENSIONS PER TABLE 2.2, MARYLAND DEPARTMENT OF THE ENVIRONMENT, DESIGN AND CONSTRUCTION MANUAL FOR SAND MOUND SYSTEMS, JUNE 2003, FOURTH EDITION; HOWEVER, A SAND MOUND SYSTEM HAS NOT BE APPROVED FOR THE LOWER PORTION OF THE SDA AT THIS TIME AS THE CHARACTERISTICS OF DRAINAGE ON THE PROPERTY CAUSES THE LENGTH OF THE MOUND TO BE TRUNCATED, THEREFORE THE LINEAR LOADING RATE FOR THE SAND MOUND WOULD BE GREATER THAN IS ADVISABLE AT THIS TIME.
10. THE REPLACEMENT SYSTEM WILL REQUIRE A PRESSURIZED DESIGN WHEREAS THE COMBINED DISCHARGE OF TRENCHES 2 AND 3 NEARLY EQUAL THE DISCHARGE OF TRENCH 1.
11. THE MARYLAND DEPARTMENT OF THE ENVIRONMENT HAS APPROVED A VARIANCE TO ALLOW THE WELL ON THE SUBJECT PROPERTY, (TAX MAP 9) PARCEL 306, LOT 7D, TO BE DOWNGRADIENT FROM THE SEWAGE DISPOSAL AREAS ON PARCEL 306, LOTS 7D, 6A, AND 6B, AND SEVERAL OTHER LOTS WITHIN A 17.21-ACRE AREA, PURSUANT TO THE FOLLOWING CONDITIONS:
 A. A BEST AVAILABLE TECHNOLOGY UNIT FOR REDUCTION OF NITRATE RELEASED FROM THE WASTEWATER EFFLUENT MUST BE INCLUDED IN THE SEPTIC SYSTEM INSTALLATION ON LOT 7D.
 B. THE WELL TO BE INSTALLED ON PARCEL 306, LOT 7D MUST HAVE A STEEL CASING THAT EXTENDS TO A 50 FEET DEPTH OR TEN FEET INTO COMPETENT BEDROCK, WHICHEVER IS DEEPER.
 C. ALL WASTEWATER DISTRIBUTION SYSTEMS TO BE INSTALLED ON PARCEL 306, LOT 7D MUST BE DESIGNED FOR PRESSURIZED DISTRIBUTION AND INSTALLED AS LOW-PRESSURE DISTRIBUTION OR EQUIVALENT.
12. THE LIMITATIONS OF SOIL PROPERTIES ARE SUCH THAT A HOUSE WITH NO MORE THAN FOUR BEDROOMS COULD BE SUPPORTED BY THE SEWAGE DISPOSAL AREA ILLUSTRATED ON THIS PLAN.
13. THE REPLACEMENT SYSTEM IS AN ALTERNATIVE SYSTEM UNDER THE CURRENT REGULATIONS DUE TO PERCOLATION RATES. A DESIGN FOR BOTH SYSTEMS MUST BE SHOWN ON THE BAT DESIGN PLAN PRIOR TO BUILDING PERMIT APPROVAL.
14. AN INNOVATIVE AND ALTERNATIVE SEWAGE DISPOSAL SYSTEM AGREEMENT MUST BE SIGNED BY THE OWNER AND THE HEALTH DEPARTMENT AND RECORDED IN LAND RECORDS FOR THE PROPERTY PRIOR TO BUILDING PERMIT APPROVAL FOR THE REPLACEMENT SYSTEM.
15. LIMIT OF DISTURBANCE: 35,481 SF OR 0.8145 AC ±.

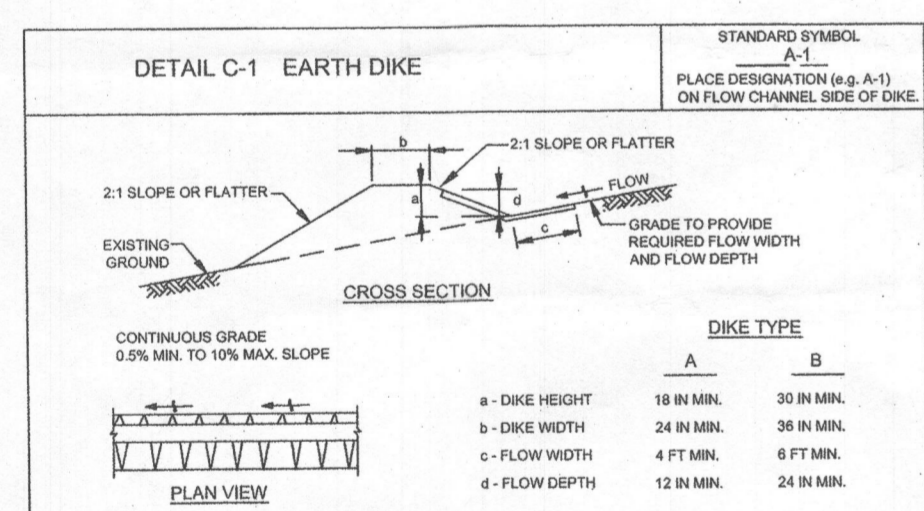

FLOW CHANNEL STABILIZATION

A-1 SEED WITH STRAW MULCH AND TACK. (NOT ALLOWED FOR CLEAR WATER DIVERSION)

A-2B-2 SEED WITH SOIL STABILIZATION MATTING OR LINE WITH SOG.

A-3B-3 4 TO 7 INCH STONE OR EQUIVALENT RECYCLED CONCRETE PRESSED INTO SOIL A MINIMUM OF 7 INCHES AND FLUSH WITH GROUND.

CONSTRUCTION SPECIFICATIONS

1. REMOVE AND DISPOSE OF ALL TREES, BRUSH, STUMPS, OBSTRUCTIONS, AND OTHER OBJECTIONABLE MATERIAL SO AS NOT TO INTERFERE WITH PROPER FUNCTION OF EARTHDIKE.
2. EXCAVATE OR SHAPE EARTH DIKE TO LINE, GRADE, AND CROSS SECTION AS SPECIFIED. BANK PROJECTIONS OR OTHER IRREGULARITIES ARE NOT ALLOWED.
3. COMPACT FILL.
4. CONSTRUCT FLOW CHANNEL ON AN UNINTERRUPTED, CONTINUOUS GRADE, ADJUSTING THE LOCATION DUE TO FIELD CONDITIONS AS NECESSARY TO MAINTAIN POSITIVE DRAINAGE.
5. PROVIDE OUTLET PROTECTION ON AS REQUIRED ON APPROVED PLAN.
6. STABILIZE EARTH DIKE WITHIN THREE DAYS OF INSTALLATION. STABILIZE FLOW CHANNEL FOR CLEAR WATER DIVERSION WITHIN 24 HOURS OF INSTALLATION.
7. MAINTAIN LINE, GRADE, AND CROSS SECTION. REMOVE ACCUMULATED SEDIMENT AND DEBRIS, AND MAINTAIN POSITIVE DRAINAGE. KEEP EARTH DIKE AND POINT OF DISCHARGE FREE OF FROGGLA AND CONTINUOUSLY MEET REQUIREMENTS FOR ADEQUATE VEGETATIVE ESTABLISHMENT IN ACCORDANCE WITH SECTION B-4 VEGETATIVE STABILIZATION.
8. UPON REMOVAL OF EARTH DIKE, GRADE AREA FLUSH WITH EXISTING GROUND. WITHIN 24 HOURS OF REMOVAL STABILIZE DISTURBED AREA WITH TOPSOIL, SEED, AND MULCH, OR AS SPECIFIED ON APPROVED PLAN.

MARYLAND STANDARDS AND SPECIFICATIONS FOR SOIL EROSION AND SEDIMENT CONTROL
 U.S. DEPARTMENT OF AGRICULTURE NATURAL RESOURCES CONSERVATION SERVICE 2011 MARYLAND DEPARTMENT OF ENVIRONMENT WATER MANAGEMENT ADMINISTRATION

OWNER/DEVELOPER
 EARL AND SUSAN CLIME
 6519 BARLEY CORN ROW
 COLUMBIA, MD 21044

GRADING, SEDIMENT AND EROSION CONTROL PLAN AND DETAILS
CLIME PROPERTY

LOT 7D
 TAX MAP 9 GRID 12
 3RD ELECTION DISTRICT
 PARCEL 306
 HOWARD COUNTY, MARYLAND

DESIGN BY: PS
 DRAWN BY: PS
 CHECKED BY: PS
 SCALE: AS SHOWN
 DATE: AUGUST 11, 2016
 PROJECT #: 16-026
 SHEET #: 1 of 2

SILL ENGINEERING GROUP, LLC
 3300 North Ridge Road, Suite 160
 Ellicott City, Maryland 21043
 Phone: 443.325.7682
 Fax: 443.325.7685
 Email: info@sillengineering.com
 Civil Engineering for Land Development

THIS DEVELOPMENT PLAN IS APPROVED FOR SOIL EROSION AND SEDIMENT CONTROL BY THE HOWARD SOIL CONSERVATION DISTRICT
 GP-17-015
 8/11/16
 DATE

ENGINEER'S CERTIFICATE
 I CERTIFY THAT THIS PLAN FOR SEDIMENT AND EROSION CONTROL REPRESENTS A PRACTICAL AND WORKABLE PLAN BASED ON MY PERSONAL KNOWLEDGE OF THE SITE CONDITIONS AND THAT IT WAS PREPARED IN ACCORDANCE WITH THE REQUIREMENTS OF THE HOWARD SOIL CONSERVATION DISTRICT.
 SIGNATURE OF ENGINEER: Paul M. Sill, P.E.
 DATE: 8/11/16

DEVELOPER'S CERTIFICATE
 I/WE CERTIFY THAT ALL DEVELOPMENT AND CONSTRUCTION WILL BE DONE ACCORDING TO THIS PLAN FOR SEDIMENT AND EROSION CONTROL, AND THAT ALL RESPONSIBLE PERSONNEL INVOLVED IN THE CONSTRUCTION PROJECT WILL HAVE A CERTIFICATE OF ATTENDANCE AT A DEPARTMENT OF THE ENVIRONMENT APPROVED TRAINING PROGRAM FOR THE CONTROL OF SEDIMENT AND EROSION BEFORE BEGINNING THE PROJECT. I ALSO AUTHORIZE PERIODIC ON-SITE INSPECTION BY THE HOWARD SOIL CONSERVATION DISTRICT.
 SIGNATURE OF DEVELOPER: Earl and Susan Clime
 DATE: 8/11/16

PROFESSIONAL CERTIFICATION: I HEREBY CERTIFY THAT THESE DOCUMENTS WERE PREPARED OR APPROVED BY ME, AND THAT I AM A DULY LICENSED PROFESSIONAL ENGINEER UNDER THE LAWS OF THE STATE OF MARYLAND, LICENSE NO. 32025, EXPIRATION DATE: JUNE 20, 2015

GP-17-015