

LAYOUT \_\_\_\_\_ INSP 4 \_\_\_\_\_  
 INSP 2 \_\_\_\_\_ INSP 5 \_\_\_\_\_  
 INSP 3 \_\_\_\_\_ INSP 6 \_\_\_\_\_

ISSUE DATE: 03/16/07 P 526288

APPROVAL DATE: 3/22/07 *Logged Into Permit Manager* A REPAIR

# PERMIT

TAX ID # **05-354455**

**ON-SITE SEWAGE DISPOSAL SYSTEM  
 HOWARD COUNTY HEALTH DEPARTMENT  
 BUREAU OF ENVIRONMENTAL HEALTH**

J M Contracting LLC IS PERMITTED TO INSTALL  ALTER

ADDRESS: 425 Obrecht Road, Sykesville PHONE NUMBER: 443-277-7526

SUBDIVISION: \_\_\_\_\_ LOT NUMBER: \_\_\_\_\_

ADDRESS: 8100 Murphy Road PROPERTY OWNER: Ivor Weldrick

SEPTIC TANK CAPACITY (GALLONS): \_\_\_\_\_ OUTLET BAFFLE FILTER REQUIRED

PUMP CHAMBER CAPACITY (GALLONS): \_\_\_\_\_ COMPARTMENTED TANK REQUIRED

NUMBER OF BEDROOMS: 3 *Trenches 2' Wide*

SQUARE FEET PER BEDROOM: \_\_\_\_\_ *Inlet 5'-6'*

LINEAR FEET OF TRENCH REQUIRED: 82' *Bottom 8'-9'*

*2-41' Trenches*

*3' of Stone Below Pipe*

TRENCHES:	Trench to be feet wide. Inlet feet below original grade. Bottom maximum depth feet below original grade. Effective area begins at feet below original grade. feet of stone below distribution pipe.
LOCATION:	<i>Install Trenches on Contour Near Left Front House Corner</i>
NOTES:	The existing septic system is failing. Call for inspection when ground is opened so sanitarian can make an inspection.

PLANS APPROVED: \_\_\_\_\_ DATE: \_\_\_\_\_

- NOTE: PERMIT VOID AFTER 2 YEARS
- NOTE: CONTRACTOR RESPONSIBLE FOR SCHEDULING A PRE-CONSTRUCTION INSPECTION FOR ALL INSTALLATIONS
- NOTE: WATERTIGHT SEPTIC TANKS REQUIRED
- NOTE: ALL PARTS OF SEPTIC SYSTEM SHALL BE 100 FEET FROM ANY WATER WELL
- NOTE: MANHOLE RISERS REQUIRED ON ALL SEPTIC TANKS AND PUMP CHAMBERS UNLESS SPECIFICALLY AUTHORIZED

**NEITHER THE HOWARD COUNTY COUNCIL NOR THE HEALTH DEPARTMENT IS RESPONSIBLE FOR THE SUCCESSFUL OPERATION OF ANY SYSTEM PERMITTEE RESPONSIBLE FOR OBTAINING FINAL APPROVAL ON THIS PERMIT CALL 410-313-1771 FOR INSPECTION OF SEPTIC SYSTEM**

NOT TO SCALE

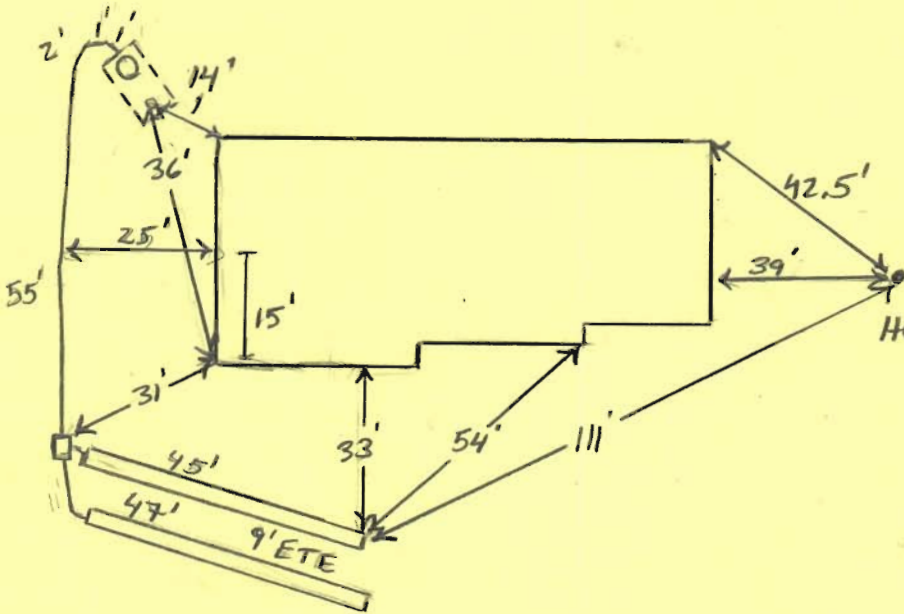

Murphy Rd

ROAD

**TRENCH/DRAINFIELD DATA**

WIDTH	INLET	BOTTOM
2'	5'-5.5'	8.5'
NUMBER OF TRENCHES		2
TOTAL LENGTH		
ABSORPTION AREA		
DISTRIBUTION BOX LEVEL		Yes
DISTRIBUTION BOX BAFFLE		Yes
DISTRIBUTION BOX PORT		No

**SEPTIC TANK DATA**

SEPTIC TANK 1 LEVEL	?
CAPACITY	12507 GAL
SEAM LOC	mid
TANK LID DEPTH	2'
BAFFLES	Yes Rear
BAFFLE FILTER	
MANHOLE LOC	Rear
6" PORT LOC	Front
WATERTIGHT TEST	
SEPTIC TANK 2 LEVEL	
CAPACITY	
SEAM LOC	
TANK LID DEPTH	
BAFFLES	
BAFFLE FILTER	
MANHOLE LOC	
6" PORT LOC	
WATERTIGHT TEST	

PRE-CONSTRUCTION \_\_\_\_\_

INSTALLATION 3/22/07 System complete according to installed plan.  
 Trench into ex. S.T. ran 2 x 45 and 47' trenches.  
 5' inlet on top trench, 5 1/2' inlet on bottom  
 OK to cover (KED)

FINAL INSPECTOR \_\_\_\_\_

*[Signature]*

DATE OF APPROVAL \_\_\_\_\_

3/22/07

**INFORMATION FORM - SEPTIC SYSTEM REPAIR / UPGRADE / EVALUATION**

For internal office use only

**Reason for Request:**

- Failing System (includes surface discharge or inadequate treatment zone)
- Has the contractor verified through excavation/pumping evaluation, that there are no pipe blockages?
- \*System relocation for proposed addition for setback compliance
- \*Verification of adequate system capacity per COMAR 26.04.02.02D (4)
- To replace collapsed septic tank
- To replace collapsed drywell

Septic Contractor:  
Contractor's Address:

J.M. Contracting LLC / Ronnie Deaps /  
425 C. Buecht Rd  
Sykesville MD. 21784

Contractor's Phone #:

413 277 7526

Property Address:

8100 Murphy Rd

Property (Subdivision) & Lot #

Fulton MD. 1 20759

County file number if known:

Owner's Name:

IVOR J & Mary L Weldrick

Is public sewer available/nearby:

NO

**If public sewer may be close, mention further research will be performed to verify availability**

Names of Any Previous Owners:

Year House Built:

1950

# of Existing Bedrooms:

3

# of Bedrooms after completion of addition:

Has this request been discussed previously with another Sanitarian: NO

If yes, then with whom and when: \_\_\_\_\_

**A Sanitarian will be in contact within three business days depending upon the urgency of the situation to coordinate the scheduling of the repair / upgrade / evaluation. No inspection will be performed without fee collection at the office.**

Print out copy of Real Property Data via Dept. of Taxation website \_\_\_\_\_ Indexed file found \_\_\_\_\_

\*Prior to scheduling inspections, scaled plans should be submitted to clarify the nature of the addition.

If public sewer may be nearby, verify whether the sewer is technically "available" (defined as abutting or within the property), through the Bureau of Engineering (Diane Nason x 3372 or Jean Reed x 3362).

If sewer is available, verify whether the property is within the Metropolitan District (Finance x 2061).

If sewer is available, and property is within the Metropolitan District, connection to sewer is required. If owner believes reasons for exemptions exist, owner should justify request in writing.

If soil/site conditions are limiting and sewer and/or Metro District status not conducive to connection, sanitarian may recommend pursuit of Emergency Sewer Extension or Emergency Metro District Inclusion.

Owner should contact Charlotte Dryden at x 4419 for further detail.

Environmental Sanitarian tentatively assigned per rotating index card box: \_\_\_\_\_

Date of request: \_\_\_\_\_ (Clerical staff to update scheduling card with date of request/property address)

Septic permit to be typed by clerical staff after instruction from scheduling sanitarian.