

APPLICATION

PERCOLATION TESTING

A 46527

P _____

HOWARD COUNTY HEALTH DEPARTMENT
BUREAU OF ENVIRONMENTAL HEALTH
P.O. BOX 476 ELLICOTT CITY, MARYLAND 21043
TELEPHONE: 461-9933

DISTRICT 5

DATE 10-25-90

TO: THE COUNTY HEALTH OFFICER
ELLICOTT CITY, MARYLAND

I, HEREBY, APPLY FOR THE NECESSARY TEST IN ORDER TO CONSTRUCT (OR RECONSTRUCT) A SEWAGE DISPOSAL SYSTEM.

PROPERTY OWNER Frances Ehler

ADDRESS 13792 Brighton Dam Rd PHONE _____

PROSPECTIVE BUYER Richard J. Demmitt

ADDRESS Po Box 208 Clarksville Md 21021 PHONE _____

PROPERTY LOCATION:

SUBDIVISION EHLER The Woods LOT NO. 52

ROAD AND DESCRIPTION 13866 Brighton DAM Rd

TAX MAP 40 PARCEL # 50 3A/B/50

SIZE OF LOT 3 Acres TYPE BLDG. (SINGLE FAMILY DWELLING OR COMMERCIAL)

THE SYSTEM INSTALLED UNDER THIS APPLICATION IS ACCEPTABLE ONLY UNTIL PUBLIC FACILITIES BECOME AVAILABLE. I FULLY UNDERSTAND THE

FEE CONNECTED WITH THE FILING OF THIS PERC TEST APPLICATION IS NON-REFUNDABLE UNDER ANY CIRCUMSTANCES. I ALSO AGREE TO COMPLY

WITH ALL M.O.S.H.A. REQUIREMENTS IN TESTING THIS LOT. Richard J. Demmitt
(SIGNATURE OF APPLICANT)

APPROVED BY _____ FOR _____ DATE _____

REJECTED BY _____ FOR _____ DATE _____

HOLD PENDING FURTHER TESTS _____ DATE _____

REASONS FOR REJECTION OR HOLDING 10/29/90 PERC OK HOLD FOR PERC

CERT PLAT RIT BLDG. PERMIT SIGNED AND RETURNED 9/5/93

Seal # 97167-SFD

Y. Behrens

THIS IS NOT A PERMIT

HD-216

Lot 15
A46527

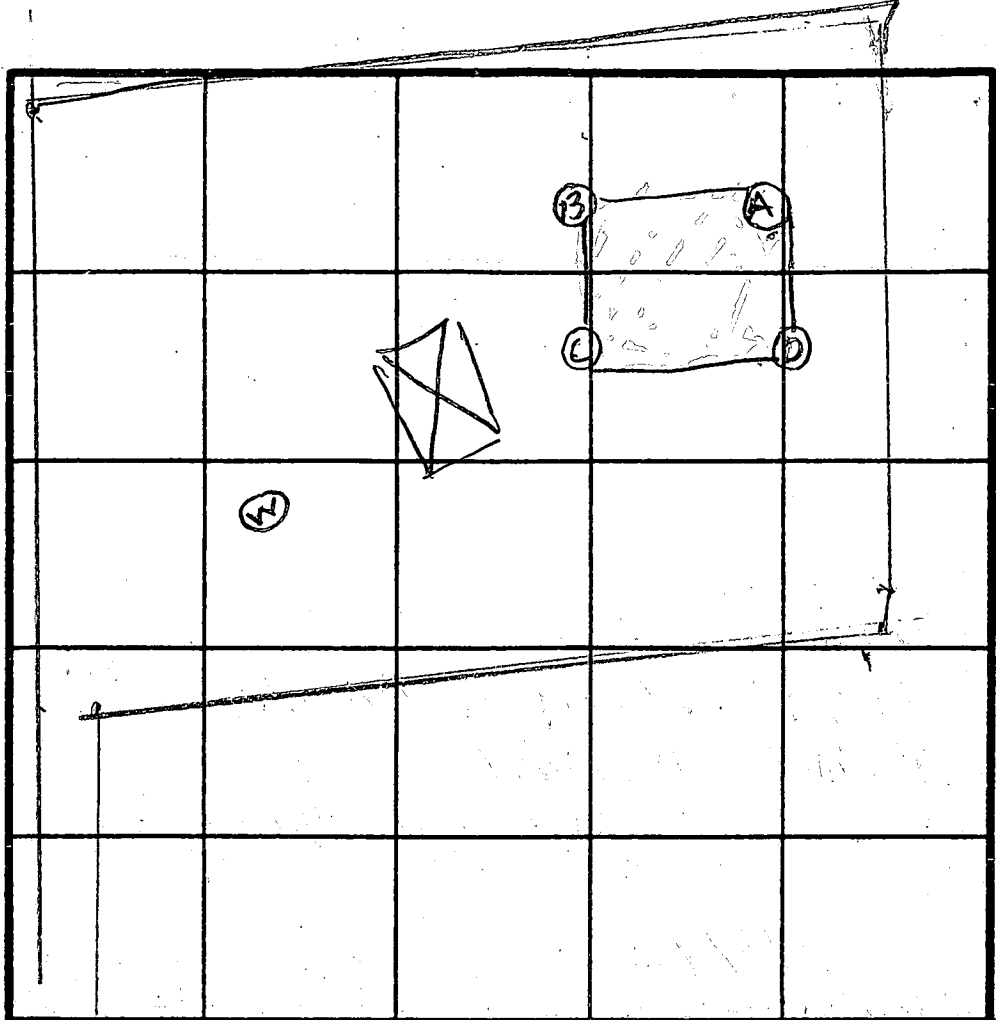

(B)
SOIL PROFILE

0
CLAY TOPSOIL
3
LIGHT BROWN LUMPY SAND LOAM

13 1/2

(C)

2
CLAY TOPSOIL
LIGHT BROWN & WHITE GRITTY SAND LOAM

13.5

(D)

0
CLAY TOPSOIL
2
RED BROWN SAND LOAM
6
BEIGE SAND LOAM

13.5

(E)

0
CLAY TOPSOIL
2
DULL BROWN GRITTY SAND LOAM

INLET 13

BOTTOM 10

INDICATE NORTH - NAME ADJOINING ROADWAY AS BASE LINE.

DATE	TEST NO.	DEPTH	PRE-WET		TEST - 1" DROP		TIME
			START	STOP	START	STOP	
10/26/90	BS	3.5	124	126	126	137	11
	BV	13.5	OK				
	CD	6.5	132	134	134	136	2
	CS	4	132	133	133	134	1
	CV	13.5	OK				
	DS	4	142	143	143	144	1
	DV	13.5	OK				
11/26/90	AS	3.5	150	151	151	153	2
	AV	14	OK				

REMARKS _____

TYPE OF SOIL _____

TESTED BY R. HODGES ALSO PRESENT R. DEMITT