

# APPLICATION

## FOR PERCOLATION TESTING AND SITE EVALUATION

TEST DATE(S) \_\_\_\_\_ TEST TIME \_\_\_\_\_ AP 520364  
 AGENCY REVIEW: \_\_\_\_\_ DATE 5/18/2004

**DO NOT WRITE ABOVE THIS LINE**

I HEREBY APPLY FOR THE NECESSARY TESTING/EVALUATION PRIOR TO ISSUANCE OF SEWAGE DISPOSAL SYSTEM PERMIT(S) TO:

CHECK AS NEEDED:

- CONSTRUCT NEW SEPTIC SYSTEM(S)
- REPAIR/ADD TO AN EXISTING SEPTIC SYSTEM
- REPLACE AN EXISTING SEPTIC SYSTEM

CHECK AS NEEDED:

- NEW STRUCTURE(S)
- ADDITION TO AN EXISTING STRUCTURE
- REPLACE AN EXISTING STRUCTURE

CHECK ONE:

- CREATE NEW LOT(S)
- BUILD ON AN EXISTING LOT IN A SUBDIVISION
- BUILD ON AN EXISTING PARCEL OF RECORD

IS THE PROPERTY WITHIN 2500' OF ANY RESERVOIR?

- YES
- NO

THE TYPE OF STRUCTURE IS:

- RESIDENTIAL WITH \_\_\_\_\_ PROPOSED BEDROOMS IN THE COMPLETED STRUCTURE (NOTE UNKNOWN IF APPROPRIATE)
- COMMERCIAL (PROVIDE DETAIL OF NUMBERS AND TYPES OF EMPLOYEES/ CUSTOMERS ON ACCOMPANYING PLAN)
- INSTITUTIONAL/GOVERNMENT (PROVIDE DETAIL OF NUMBERS AND TYPES OF EMPLOYEES/USERS ON ACCOMPANYING PLAN)

PROPERTY OWNER(S) ESTATE OF GEORGE M. LEAR

DAYTIME PHONE \_\_\_\_\_ CELL \_\_\_\_\_ FAX \_\_\_\_\_  
 MAILING ADDRESS: 11462 OLD HOPKINS RD CLARKSVILLE, MD 21029  
STREET CITY/TOWN STATE ZIP

APPLICANT WILLIAM LEAR

DAYTIME PHONE 703 280 7173 CELL \_\_\_\_\_ FAX \_\_\_\_\_  
 MAILING ADDRESS: 6713 MICHAELS DR BETHESDA MD 20817  
STREET CITY/TOWN STATE ZIP

APPLICANT'S ROLE: DEVELOPER BUILDER BUYER RELATIVE/FRIEND REALTOR CONSULTANT

PROPERTY LOCATION SUBDIVISION/PROPERTY NAME \_\_\_\_\_ LOT NO. \_\_\_\_\_

PROPERTY ADDRESS: 11462 OLD HOPKINS RD CLARKSVILLE, MD 21029  
STREET TOWN/POST OFFICE

TAX MAP PAGE(S) 41 GRID \_\_\_\_\_ PARCEL(S) P111 PROPOSED LOT SIZE 1.7 AC

AS APPLICANT, I UNDERSTAND THE FOLLOWING: THE SYSTEM INSTALLED SUBSEQUENT TO THIS APPLICATION IS ACCEPTABLE ONLY UNTIL PUBLIC SEWERAGE IS AVAILABLE. THIS APPLICATION IS COMPLETE WHEN ALL APPLICABLE FEES AND A SUITABLE SITE PLAN HAVE BEEN RECEIVED. I ACCEPT THE RESPONSIBILITY FOR COMPLIANCE WITH ALL M.O.S.H.A. AND "MISS UTILITY" REQUIREMENTS. APPROVAL IS BASED UPON SATISFACTORY REVIEW OF A PERC CERTIFICATION PLAN.

TEST RESULTS WILL BE MAILED TO APPLICANT. William Lear  
SIGNATURE OF APPLICANT

HOWARD COUNTY HEALTH DEPARTMENT, BUREAU OF ENVIRONMENTAL HEALTH, WELL AND SEPTIC PROGRAM  
 3525-H ELLICOTT MILLS DRIVE, ELLICOTT CITY, MARYLAND 21043-4544 (410) 313-1771 FAX (410) 313-2648  
 TDD (410) 313-2323 TOLL FREE 1-877-4MD-DHMH

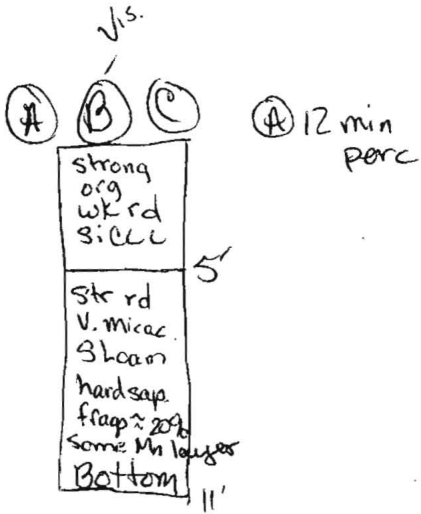

5 1/2'

(C) 9:09  
9:20  
44  
-----  
24 min

(D) Strong rd  
SCLL  
-----  
wk rd, ord 3  
s:cll - L  
-----  
5'

S Loam loose  
Rx ≤ 10%  
balls

(E) 6'

9:34  
37  
43

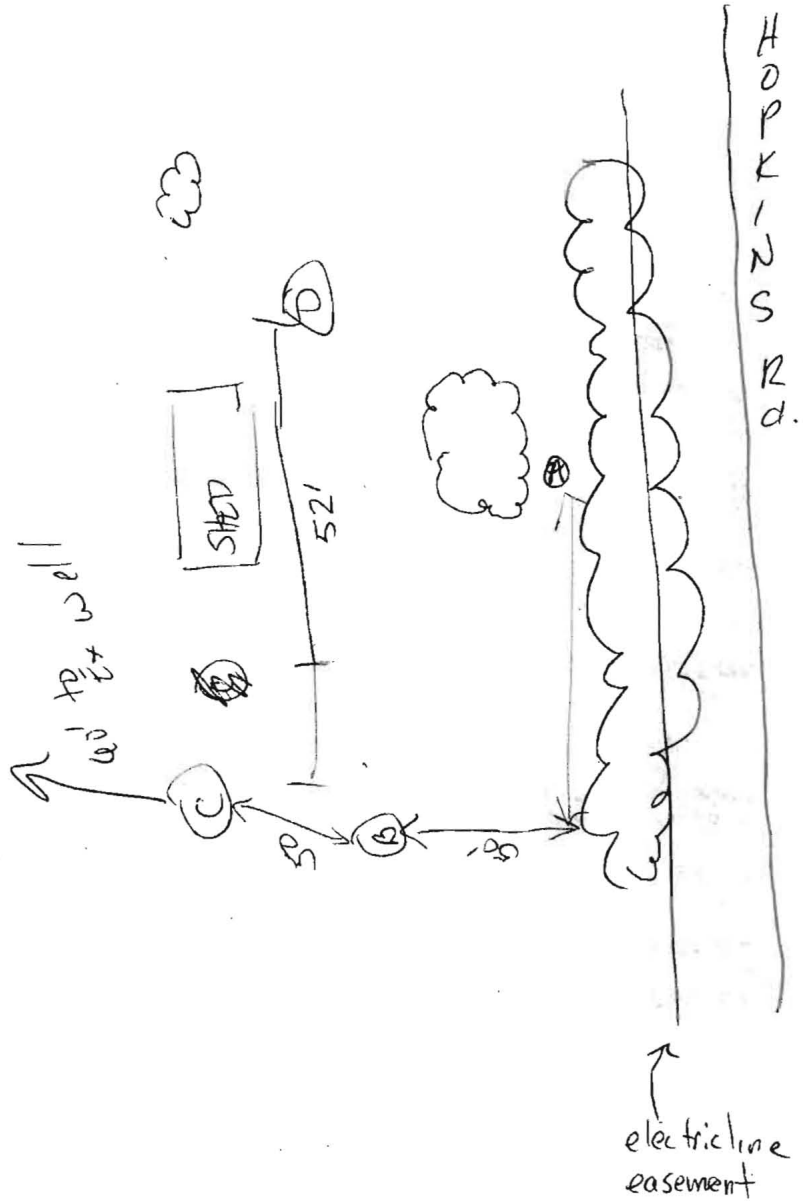

A520364

Approx. LOCATION OF TEST HOLES

COUNTY #

SOIL PROFILE

0' (A)(B)(C)  
 Str org  
 wk rd  
 micac  
 SCLL 5'  
 Str rd  
 v. micac  
 SL  
 hard  
 Sap frag  
 in (A) 20%  
 (B) 20%  
 (C) 29%  
 Some Mn  
 in saprolite  
 layers  
 Bottom 11'

SOIL PROFILE

0'

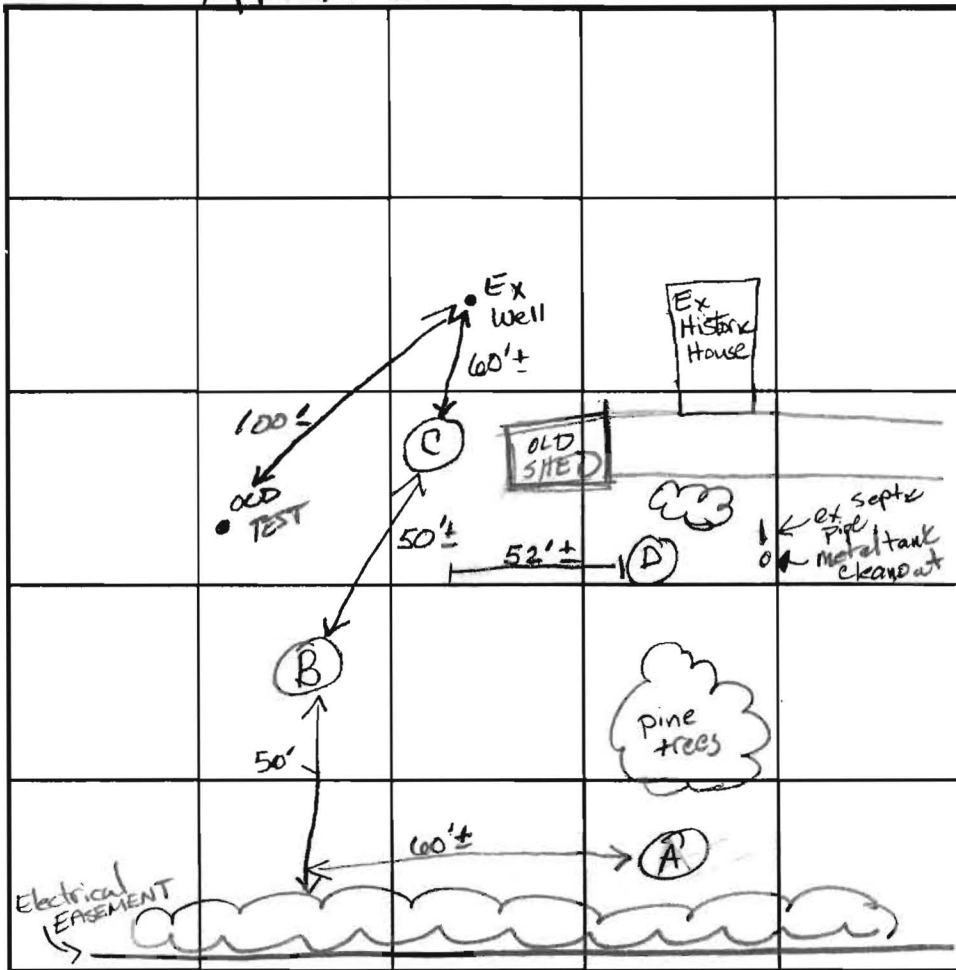

INDICATE NORTH - NAME ADJOINING ROADWAY AS BASE LINE.

John HOPKINS ROAD

ADJ Well of 11417 O. Hopkins concern  
 50'±  
 OLD Hopkins Rd

(D)  
 Str. rd  
 SCLL 3'  
 wk rd  
 org brn  
 SIL-L 5'  
 brn  
 SLoam 12'

DATE	TEST NO.	DEPTH	PRE-WET		TEST - 1" DROP		TIME
			START	STOP	START	STOP	
5-18-04	(A)	5 1/2' S	9:02	9:08	9:08	9:18	12 OK
	(B)	Visual					OK
	(C)	6' S	9:09	9:20	9:20	9:44	24 OK
	(D)	6' M	9:34	9:37	9:37	9:43	6 OK

REMARKS: Holes Staked by Mr. Lear  
 TYPE OF SOIL: SLoam-L v. micaceous <sup>loose</sup> grained but compacted  
 TESTED BY: Racie Thoman ALSO PRESENT ED ZEPP Mr Lear  
 TRENCH DESIGN DATA: AVERAGE PERCOLATION TIME 20 min TRENCH WIDTH 3  
 INLET DEPTH 4 1/2 MAXIMUM BOTTOM DEPTH 8 SQ. FT/BEDROOM 210  
 3' SIDEWALL COEFF = .50

8/28/09

Garland L Brian Sr

to Kevin Wolf

Howard County Health Dept.

Kevin

George Lewis old dry well was pumped by  
Freedom septics and filled with dirt, graded  
& seeded. Pump ticket ~~also~~ included.

Garland Brian

Job site:

George Lewis

11462 OLD Hopkins Rd

Clarksville

Garland Bryan

FAXED MAY 13 2009

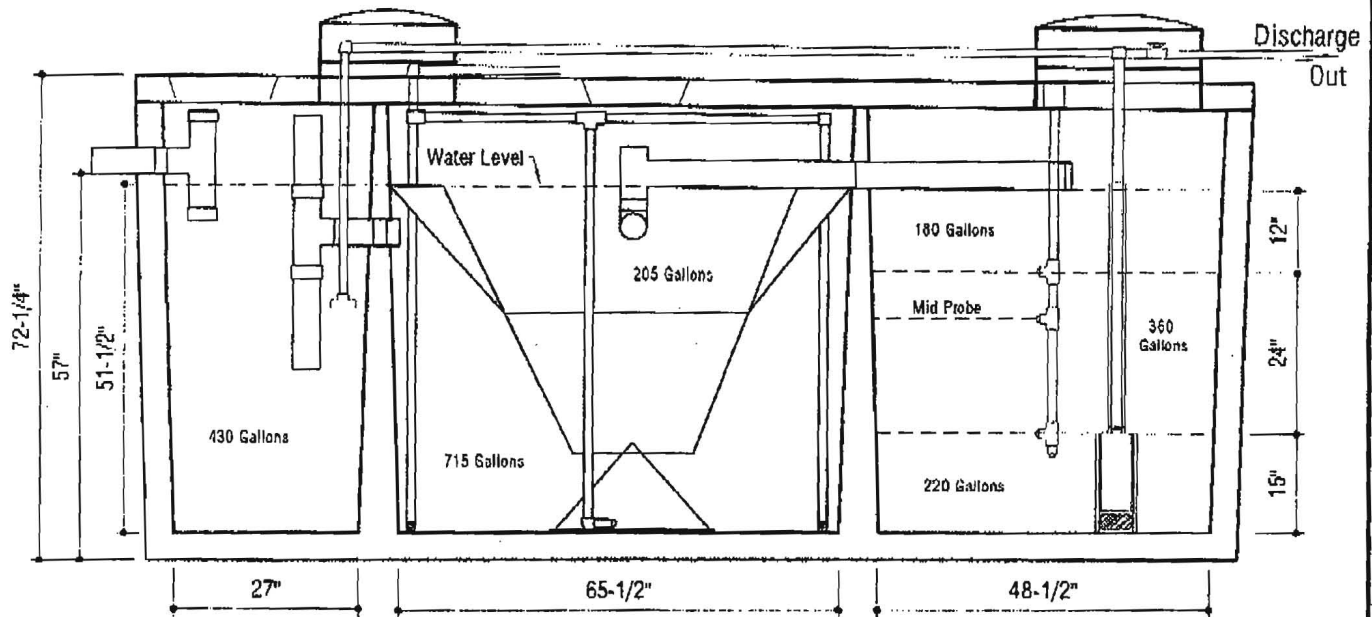
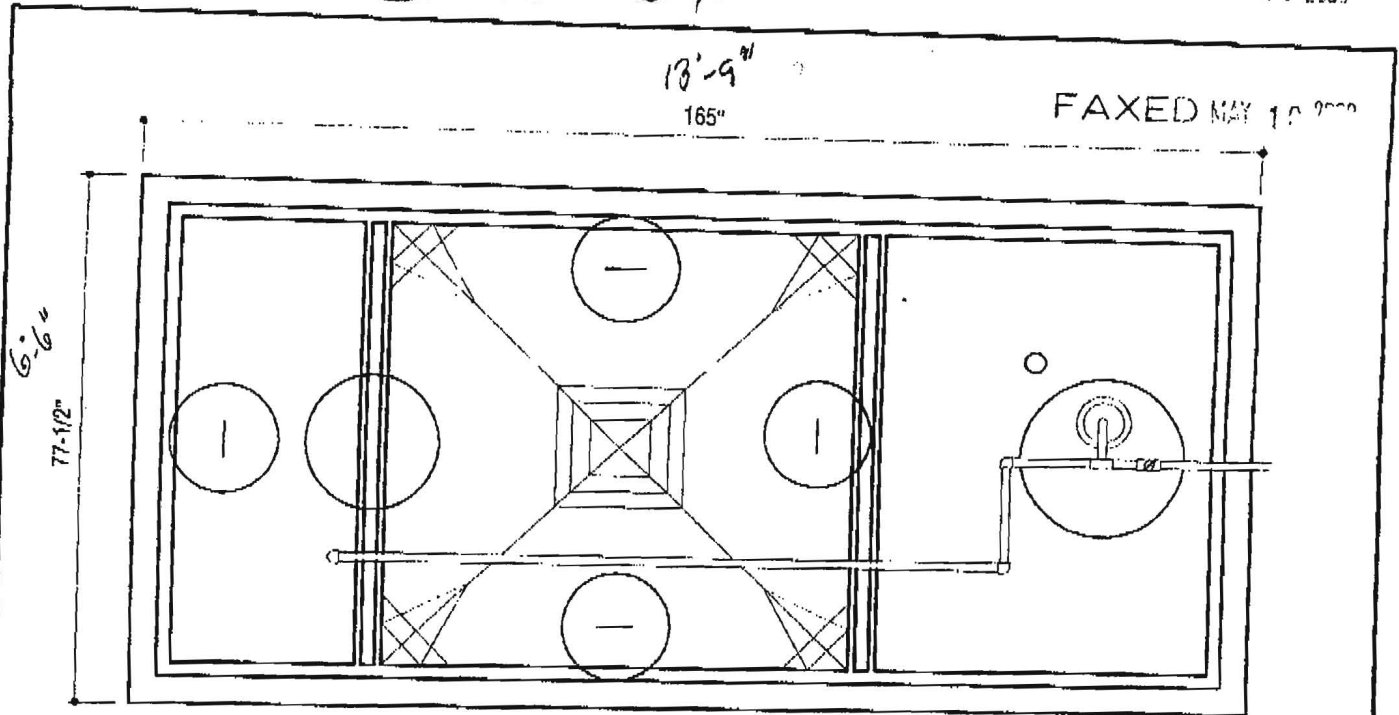

**DESIGN DATA & GENERAL NOTES**

- [1] Concrete strength  $f_c = 4,000$  p.s.i. @ 28 days. Density = 150 pcf.
- [2] Cement - Portland Type (I) per ASTM C 150-92.
- [3] Admixtures & plasticizers per ASTM C 260-86 & C 494-92.
- [4] Reinforcing per ASTM A185. Min. 1-1/2" cover.

**Mayer Brothers, Inc.**

6264 Race Road  
 Elkridge, Maryland 21075  
 Tel. 410.796.1434  
 Fax. 410.796.1438  
[www.mayerbrosprecast.com](http://www.mayerbrosprecast.com)



**600 GPD BNR SYSTEM  
 H-600 ABNR**

**with 750 GALLON PUMP CHAMBER**

Dwg. No. Hoot Form #1

No Scale

March 19, 2009

**FREEDOM SEPTIC SERVICE, INC.**

24 Hour Service  
2809 Liberty Road  
Eldersburg, Maryland 21784  
(410) 795-2947

**JOB WORK ORDER**

032392

DATE OF ORDER 8/25/09

\* Call 1 hr. before to meet you: 301-370-5432

PHONE

BILL TO Garland Brian, Sr., LLC

ADDRESS 11462 Old Hopkins Road

CITY clarksville, MD 21029

LOCATION OF SEPTIC drywell on side

LAST PUMPED

NEW CUSTOMER 3 1/2 Hoses

DESCRIPTION OF WORK

Bill -

pump drywell Drywell Full

1000 gallons - 180.00  
 1500 gallons - 210.00 PAID chk# 6782  
 2000 gallons - 270.00  
 3000 gallons - 320.00  
 4000 gallons - 395.00

Friday 8/28/09 \* AS EARLY AS POSSIBLE

A 15% Late Charge will be assessed 30 days after date of service.

**NOTICE TO CUSTOMERS**

I understand that Freedom Septic Service, Inc. is not responsible for any damage to driveway or lawn while rendering services on the above property.

828.00 SR

Date Completed

10:30

TOTAL MATERIALS

TOTAL LABOR

TAX

TOTAL AMOUNT

395.00

- NO ONE AT HOME
- TOTAL AMOUNT DUE FOR ABOVE WORK; OR
- TOTAL BILLING TO BE MAILED AFTER COMPLETION OF THE WORK

Signature

G. Brian

okay to bill

I hereby acknowledge the satisfactory completion of the above described work