



# Building Permit Application

Howard County Maryland  
Department of Inspections, Licenses and Permits  
3430 Court House Drive  
Permits: 410-313-2455  
www.howardcountymd.gov

Date Received: \_\_\_\_\_

Permit No.: \_\_\_\_\_

Building Address: 10114 Green Clover Dr  
City: Ellicott City State: MD Zip Code: 21042  
Suite/Apt. # \_\_\_\_\_ SDP/WP/BA #: \_\_\_\_\_  
Census Tract: \_\_\_\_\_ Subdivision: \_\_\_\_\_  
Section: \_\_\_\_\_ Area: \_\_\_\_\_ Lot: \_\_\_\_\_  
Tax Map: \_\_\_\_\_ Parcel: \_\_\_\_\_ Grid: \_\_\_\_\_  
Zoning: \_\_\_\_\_ Map Coordinates: \_\_\_\_\_ Lot Size: \_\_\_\_\_

Existing Use: RES Single family dwelling  
Proposed Use: DECK  
Estimated Construction Cost: \$ 50,000  
Description of Work: 16x20 SCREENED Porch w/  
DECK & STEPS

Occupant or Tenant: \_\_\_\_\_  
Was tenant space previously occupied?  Yes  No  
Contact Name: \_\_\_\_\_  
Address: \_\_\_\_\_  
City: \_\_\_\_\_ State: \_\_\_\_\_ Zip Code: \_\_\_\_\_  
Phone: \_\_\_\_\_ Fax: \_\_\_\_\_  
Email: \_\_\_\_\_

Property Owner's Name: BRYAN GLASS  
Address: 10114 Green Clover Dr  
City: Ellicott City State: MD Zip Code: 21042  
Phone: 443-6688898 Fax: \_\_\_\_\_  
Email: ERIC@BGLASS@GMAIL.COM

Applicant's Name & Mailing Address, (If other than stated herein)  
Applicant's Name: \_\_\_\_\_  
Address: \_\_\_\_\_  
City: \_\_\_\_\_ State: \_\_\_\_\_ Zip Code: \_\_\_\_\_  
Phone: \_\_\_\_\_ Fax: \_\_\_\_\_  
Email: \_\_\_\_\_

Contractor Company: TOWN CREEK LANDSCAPE  
Contact Person: STEVE CLAWSON  
Address: PO BOX 1920  
City: USKOW State: MD Zip Code: 21765  
License No.: 44986  
Phone: 301-252-4863 Fax: \_\_\_\_\_  
Email: SClawson@towncreeklandscaping.com

Engineer/Architect Company: \_\_\_\_\_  
Responsible Design Prof.: \_\_\_\_\_  
Address: \_\_\_\_\_  
City: \_\_\_\_\_ State: \_\_\_\_\_ Zip Code: \_\_\_\_\_  
Phone: \_\_\_\_\_ Fax: \_\_\_\_\_  
Email: \_\_\_\_\_

Commercial Building Characteristics	Residential Building Characteristics
Height:	<input type="checkbox"/> SF Dwelling <input type="checkbox"/> SF Townhouse
No. of stories:	Depth Width
Gross area, sq. ft./floor:	1 <sup>st</sup> floor:
	2 <sup>nd</sup> floor:
Area of construction (sq. ft.):	Basement:
	<input type="checkbox"/> Finished Basement
Use group:	<input type="checkbox"/> Unfinished Basement
	<input type="checkbox"/> Crawl Space
<b>Construction type:</b>	<input type="checkbox"/> Slab on Grade
<input type="checkbox"/> Reinforced Concrete	No. of Bedrooms:
<input type="checkbox"/> Structural Steel	<b>Multi-family Dwelling</b>
<input type="checkbox"/> Masonry	No. of efficiency units:
<input type="checkbox"/> Wood Frame	No. of 1 BR units:
<input type="checkbox"/> State Certified Modular	No. of 2 BR units:
	No. of 3 BR units:
	Other Structure:
	Dimensions:
<input checked="" type="checkbox"/> Roadside Tree Project Permit	Footings:
<input type="checkbox"/> Yes <input type="checkbox"/> No	Roof:
Roadside Tree Project Permit #	<input type="checkbox"/> State Certified Modular
	<input type="checkbox"/> Manufactured Home

Utilities	
<b>Water Supply</b>	
<input type="checkbox"/> Public	
<input checked="" type="checkbox"/> Private	
<b>Sewage Disposal</b>	
<input type="checkbox"/> Public	
<input checked="" type="checkbox"/> Private	
Electric: <input type="checkbox"/> Yes <input type="checkbox"/> No	
Gas: <input type="checkbox"/> Yes <input type="checkbox"/> No	
<b>Heating System</b>	
<input type="checkbox"/> Electric <input type="checkbox"/> Oil	
<input type="checkbox"/> Natural Gas <input type="checkbox"/> Propane Gas	
<input type="checkbox"/> Other:	
<b>Sprinkler System:</b>	
<input type="checkbox"/> Yes <input type="checkbox"/> No	
Grading Permit Number:	
Building Shell Permit Number:	

THE UNDERSIGNED HEREBY CERTIFIES AND AGREES AS FOLLOWS: (1) THAT HE/SHE IS AUTHORIZED TO MAKE THIS APPLICATION; (2) THAT THE INFORMATION IS CORRECT; (3) THAT HE/SHE WILL COMPLY WITH ALL REGULATIONS OF HOWARD COUNTY WHICH ARE APPLICABLE THERETO; (4) THAT HE/SHE WILL PERFORM NO WORK ON THE ABOVE REFERENCED PROPERTY NOT SPECIFICALLY DESCRIBED IN THIS APPLICATION; (5) THAT HE/SHE GRANTS COUNTY OFFICIALS THE RIGHT TO ENTER ONTO THIS PROPERTY FOR THE PURPOSE OF INSPECTING THE WORK PERMITTED AND POSTING NOTICES.

Steve Clawson  
Applicant's Signature  
SClawson@towncreeklandscaping.com  
Email Address  
\_\_\_\_\_  
Title/Company

STEPHEN M. CLAWSON  
Print Name  
10/11/16  
Date

Checks Payable to: DIRECTOR OF FINANCE OF HOWARD COUNTY  
\*\*PLEASE WRITE NEATLY & LEGIBLY\*\*  
-FOR OFFICE USE ONLY-

AGENCY	DATE	SIGNATURE OF APPROVAL
State Highways		
Building Officials		
PSZA ( Zoning )		
PSZA ( Engineering )		
Health	<u>10/11/16</u>	<u>H. Osowski</u>

Is Sediment Control approval required for issuance?  Yes  No  
 CONTINGENCY CONSTRUCTION START

DPZ SETBACK INFORMATION
Front:
Rear:
Side:
Side St.:
All minimum setbacks met? <input type="checkbox"/> Yes <input type="checkbox"/> No
Is Entrance Permit Required? <input type="checkbox"/> Yes <input type="checkbox"/> No
Historic District? <input type="checkbox"/> Yes <input type="checkbox"/> No
Lot Coverage for New Town Zone:
SDP/Red-line approval date:

Filing Fee	\$
Permit Fee	\$
Tech Fee	\$
Excise Tax	\$
PSFS	\$
Guaranty Fund	\$
Add'l per Fee	\$
Total Fees	\$
Sub-Total Paid	\$
Balance Due	\$
Check	#



50 scale

GLASS RES

APPROVED

10114 Green Clover Dr

WALK-THRU BUILDING PERMIT

BP#

A#

APP SAN H. Oswald DATE: 10/11/76

DESC. OF WORK: Construct 16' x 20' screened

porch & 12' x 23' deck w/ steps

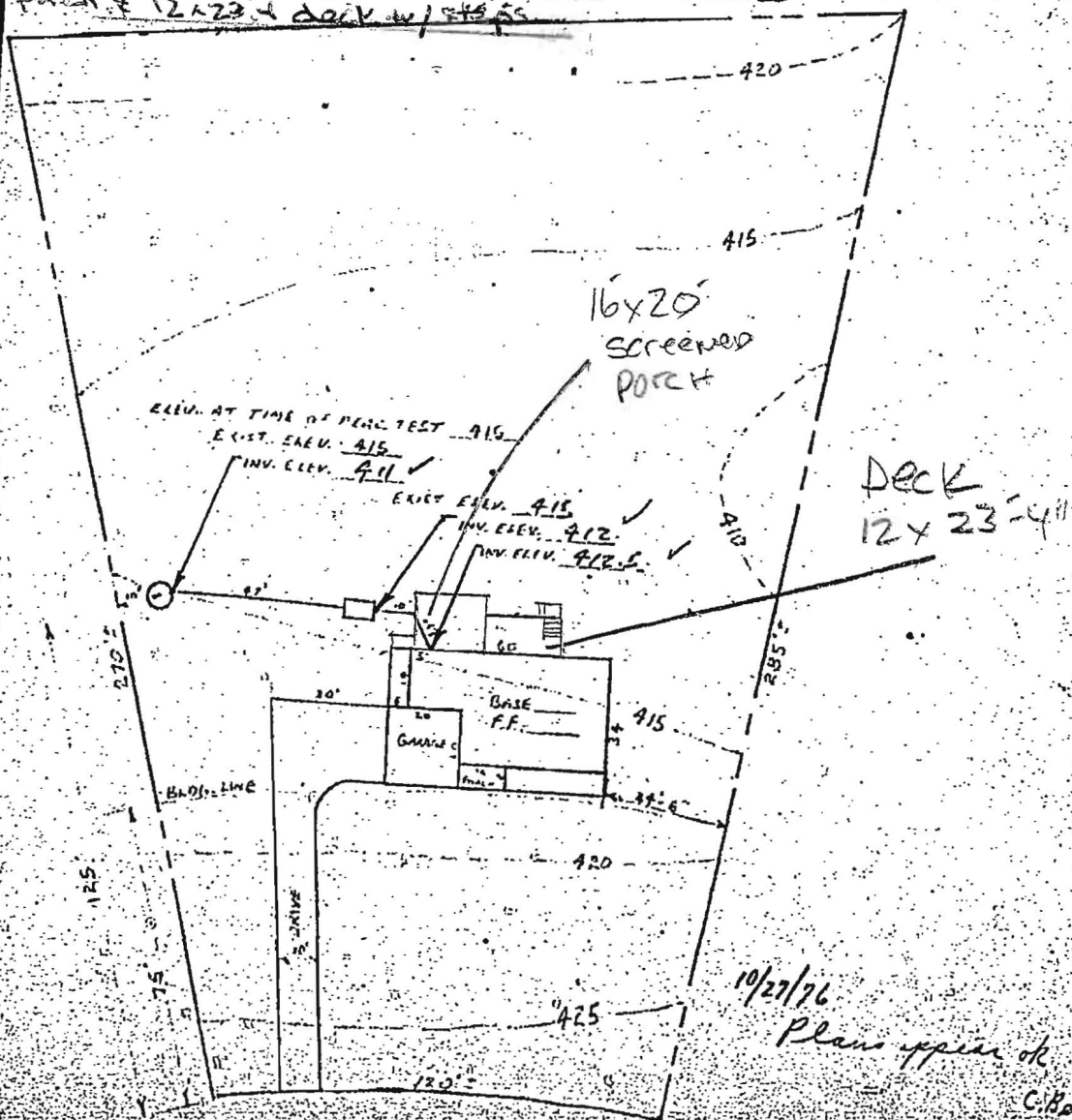

10/27/76  
Plans appear ok

C.B.