

NOTES

Methods WSP & CS-WSP: Min. 7/16" OSB Wood Structural Panel sheathing attached to framing with 6d at 6" o.c. at panel edges and 12" o.c. at intermediate framing members.

Note: At Braced Wall Lines incorporating Continuously Sheathed bracing methods (CS-WSP & CS-PF), all exterior walls along the Braced Wall Line must be fully sheathed with min 7/16" OSB Wood Structural Panel sheathing fastened per IRC 2012 Tables R602.3(1), R602.3(2), and R602.3(3).

Method GB: Min. 1/2" gypsum board applied to each side of framing with adhesive and Type S or W screws @ 7" o.c. at panel edges and 24" o.c. at intermediate framing members or nails per IRC 2012 Table R702.3.5 @ 7" o.c. at panel edges and 16" o.c. at intermediate framing members.

Method LIB: Simpson WB/WBC straps installed in an "X" pattern on one face of wall; fasten with 2- 16d nails at top and bottom plates and 1- 8d nail per stud. 8' tall walls to use either WB106/WB106C installed at 60° from horizontal (4'-8" linear wall length) or WB126/WB126C installed at 45° from horizontal (8'-1" linear wall length); 9' tall walls to use WB126/WB126C installed at 53° from horizontal (6'-10" linear wall length); 10' tall walls to use WB143C installed at 45° from horizontal (10'-1" linear wall length).

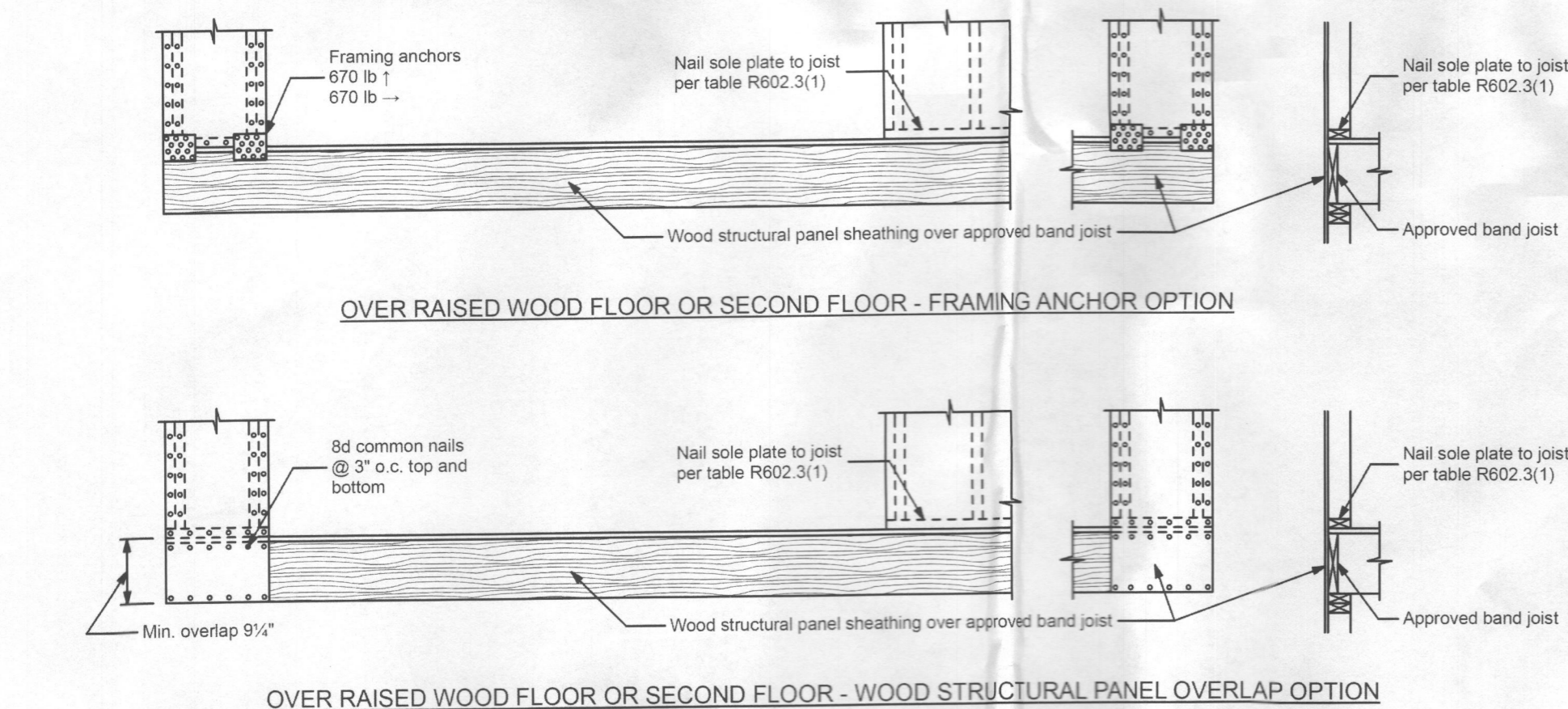
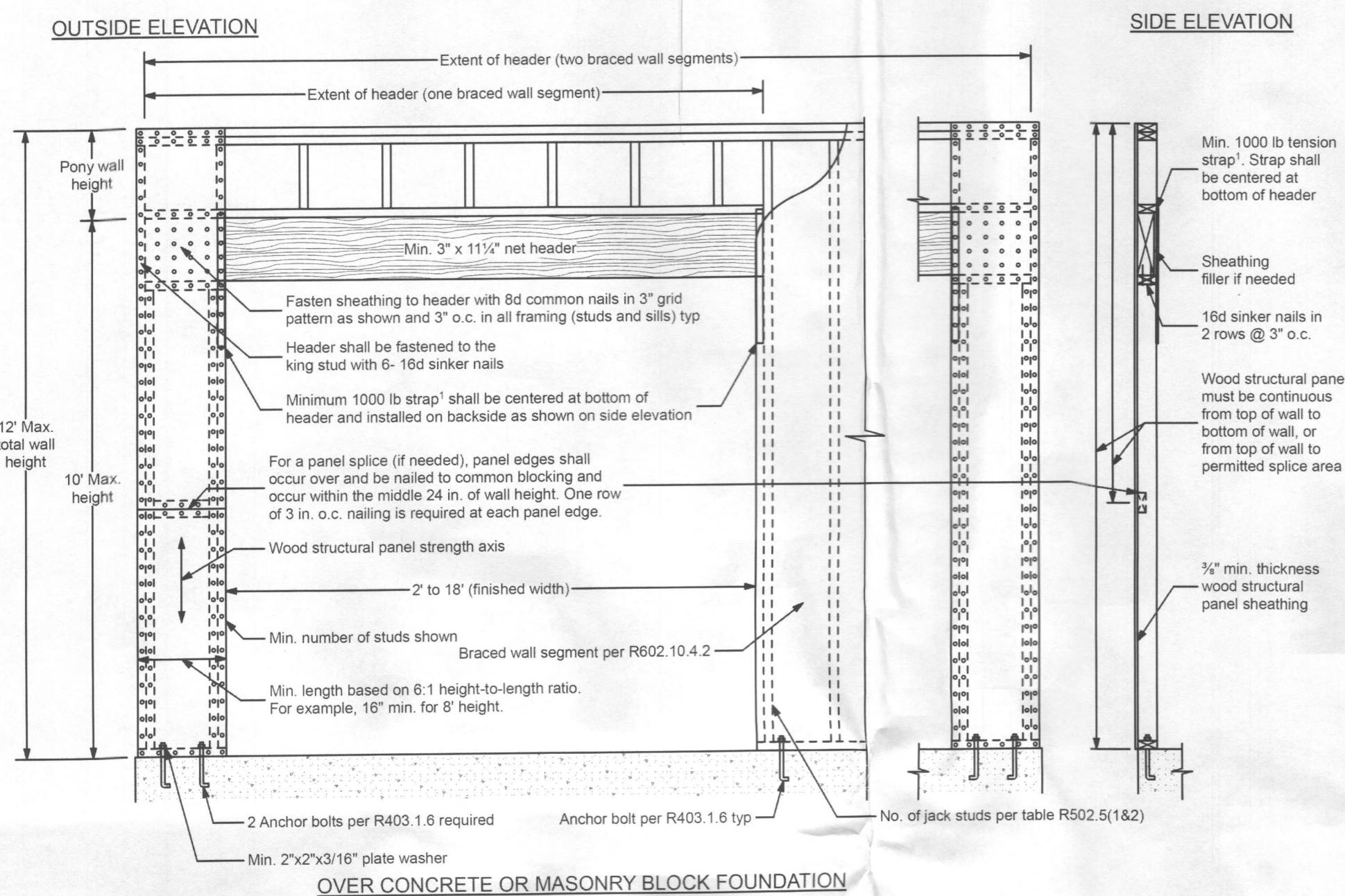

1 Tension Strap Capacity Required for Method CS-PF

Minimum Wall Stud Framing Nominal Size and Grade	Maximum Pony Wall Height (feet)	Maximum Total Wall Height (feet)	Maximum Opening Width (feet)	Wind Exposure	
				B	C
2x4 No. 2 Grade	0	10	18	1000	1000
			9	1000	1000
	1	10	16	1000	2325
			18	1200	2725
			9	1000	1550
			16	2025	3800
	2	10	18	2400	DR
			9	1200	2750
2	12	16	3200	DR	
		18	3850	DR	
		9	2350	DR	
		16	DR	DR	
2x6 Stud Grade	2	12	9	1000	1750
			18	2050	3550
	4	12	16	2450	4100
			9	1500	2775
18	12	16	3150	DR	
		18	3675	DR	

Notes: 1. Basic Wind Speed of 90mph. For other Basic Wind Speeds, see IRC 2012 Table R602.10.6.4
2. DR = Design Required

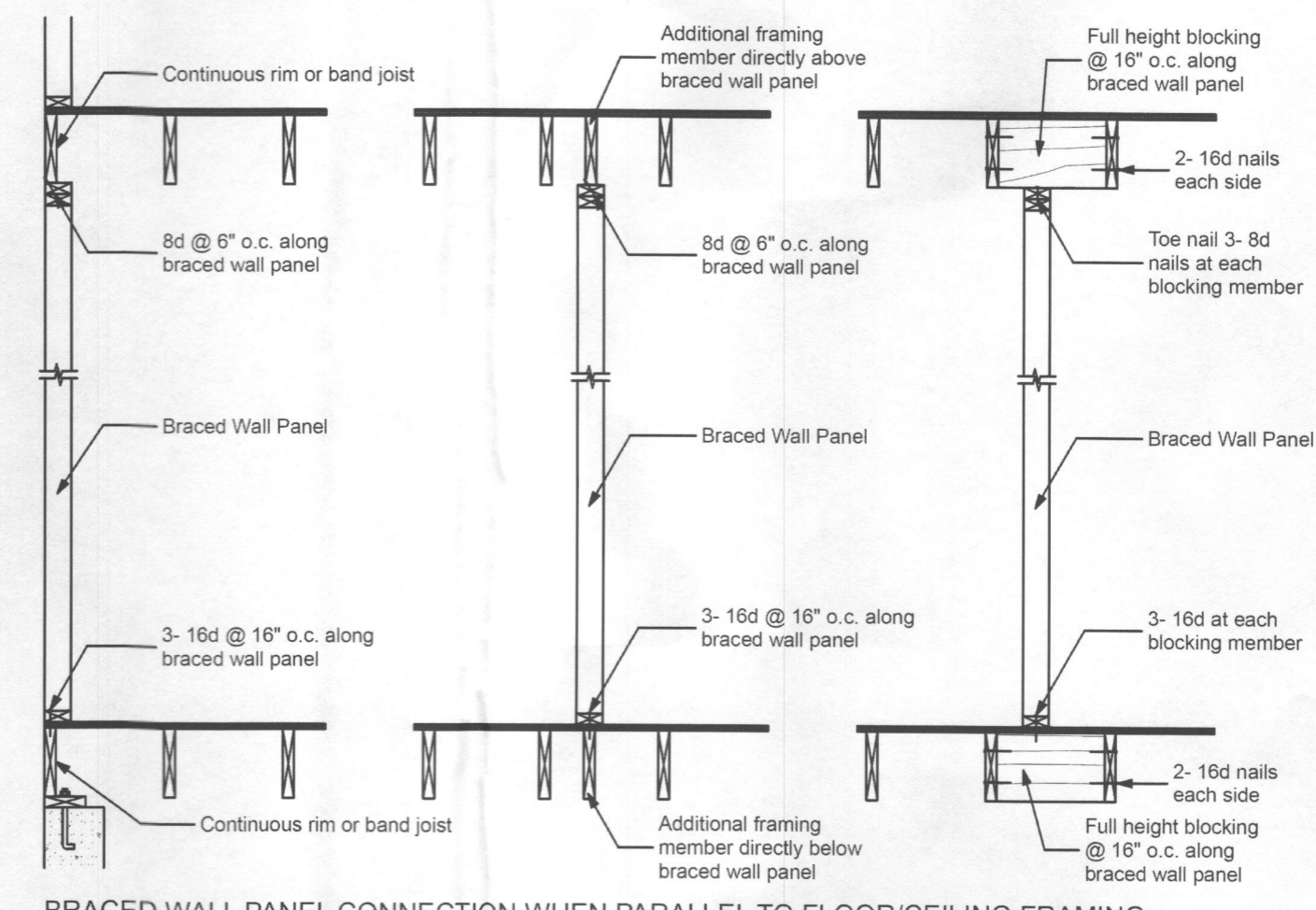
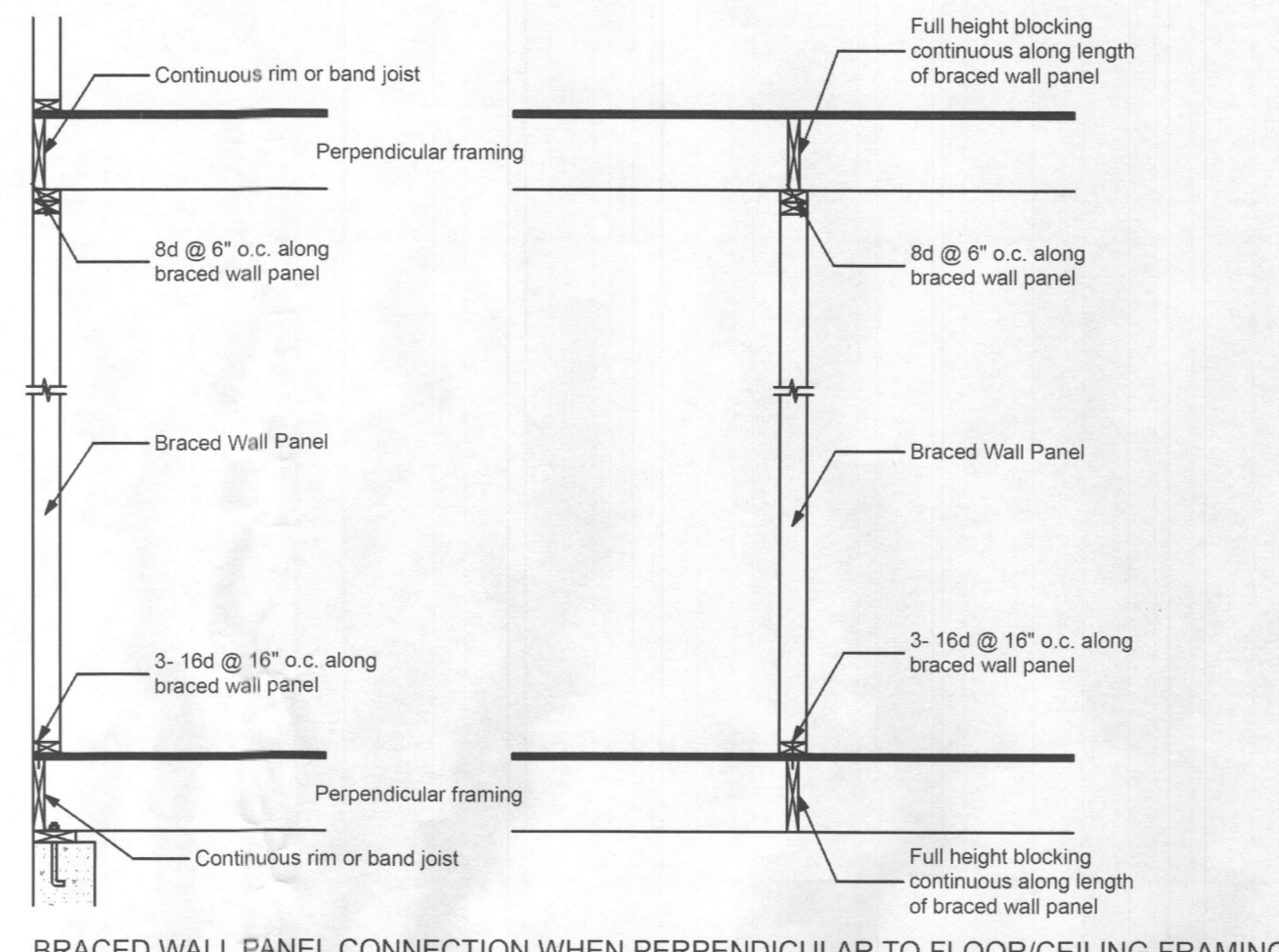

Braced Wall Panel Connections to Floor and Ceiling Framing
NOT TO SCALE

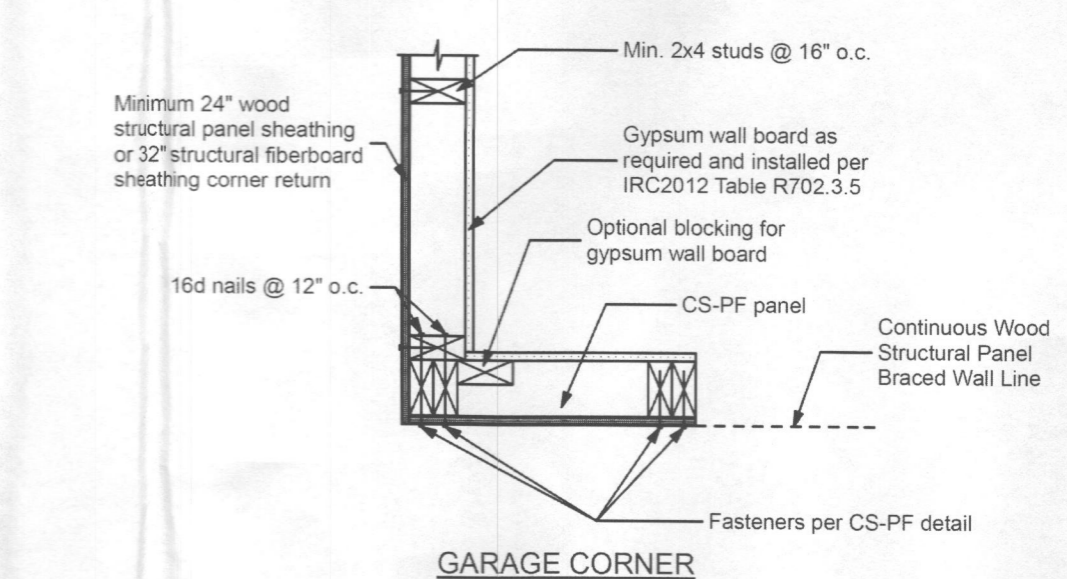
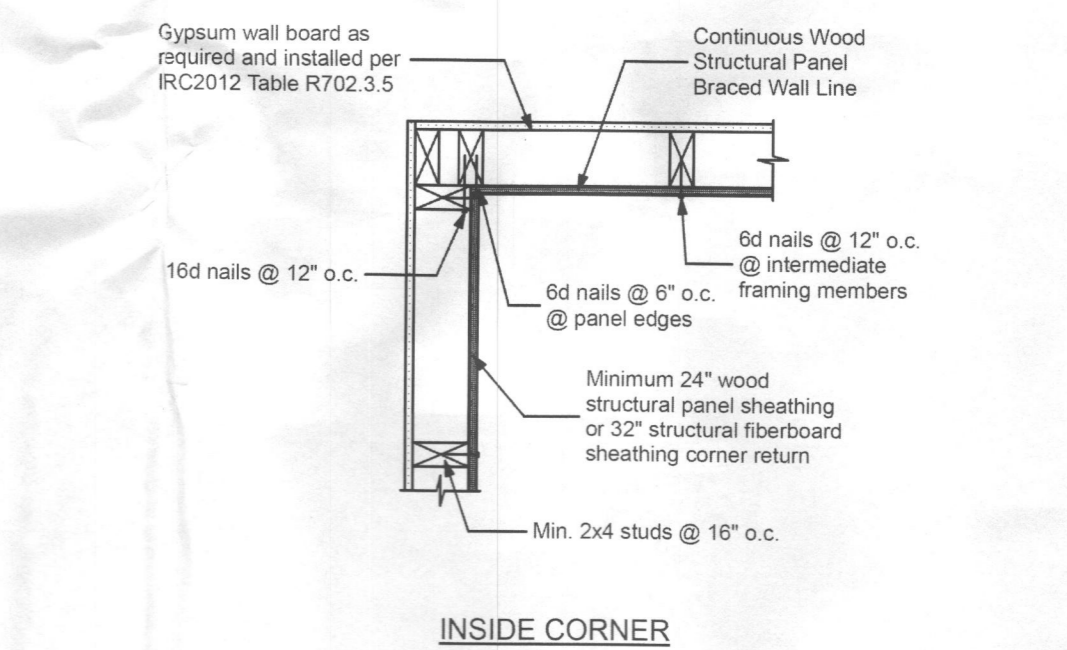
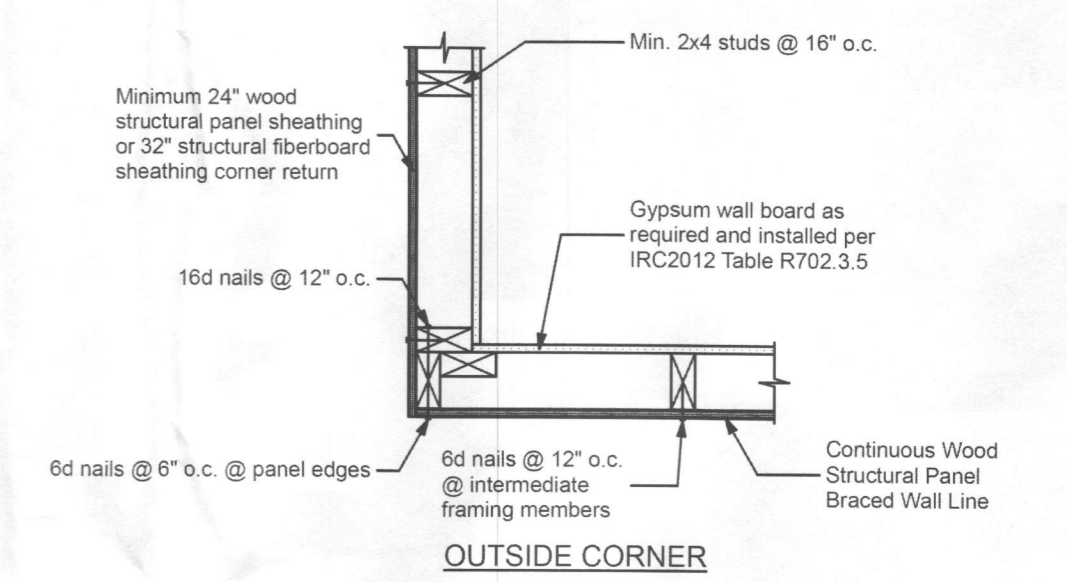
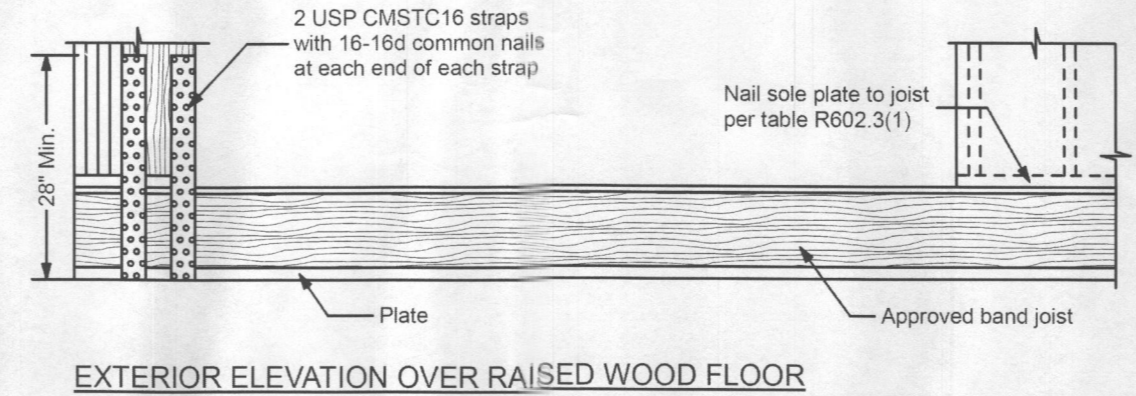
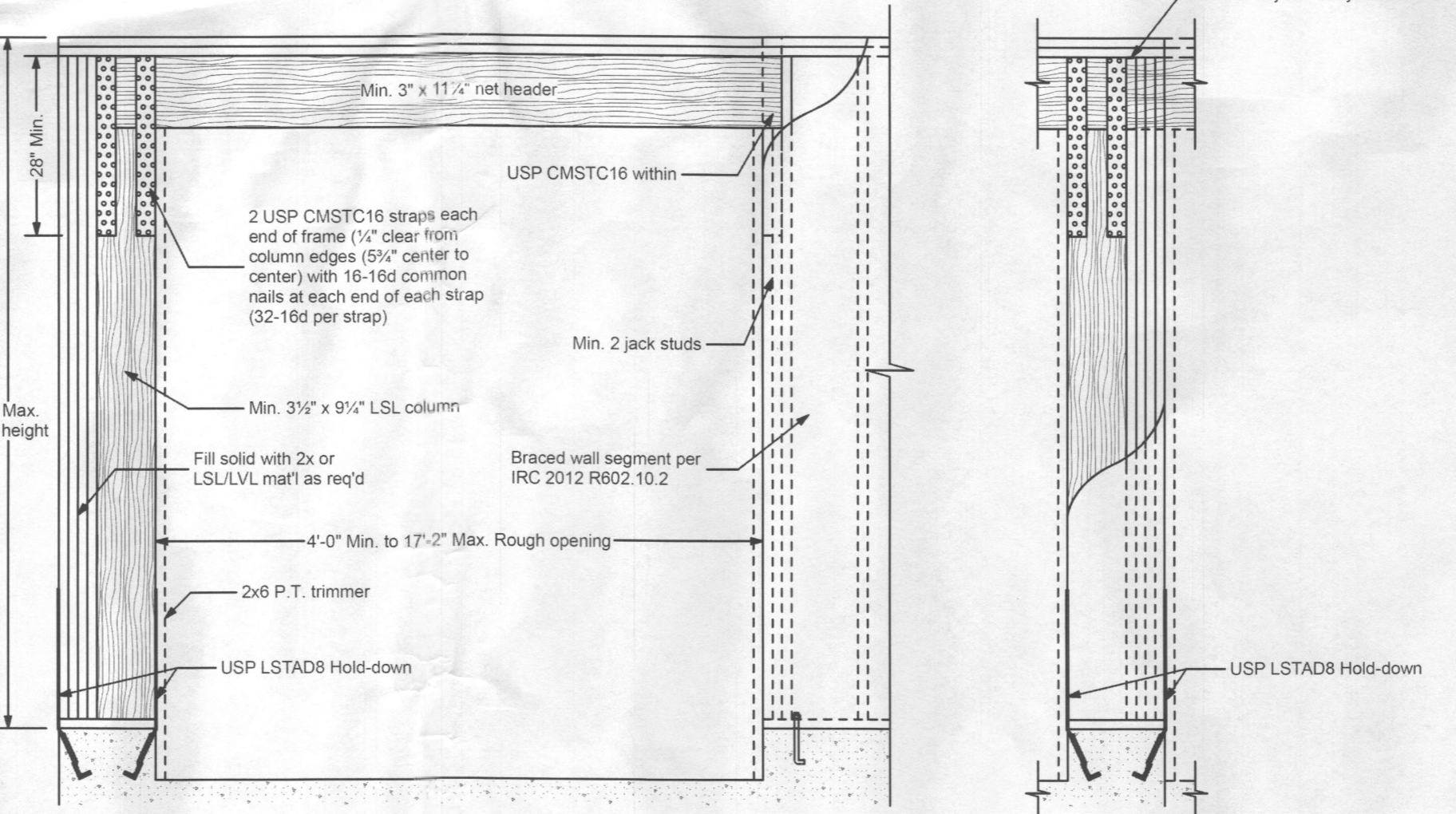
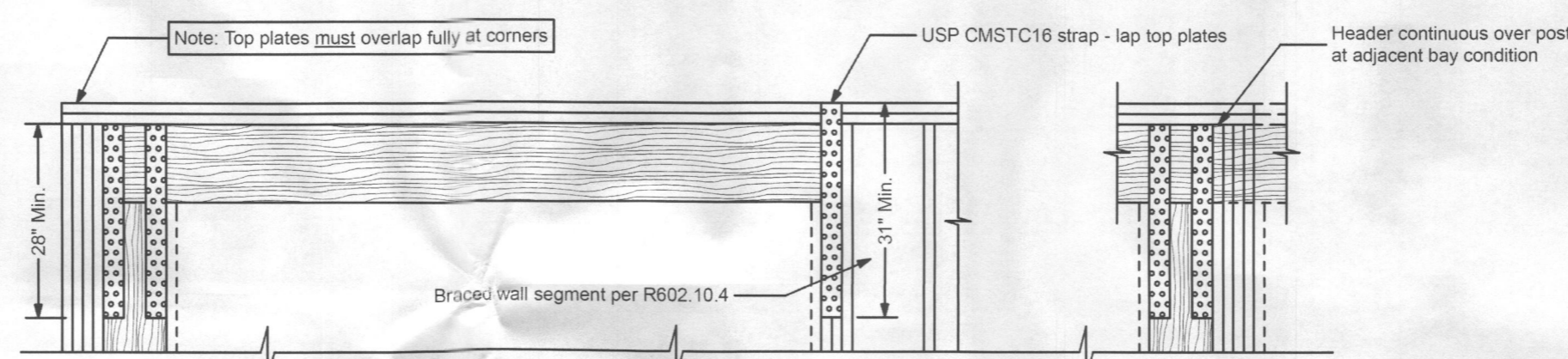

Corner Framing Details
NOT TO SCALE

PROFESSIONAL CERTIFICATION

DATE: 07/19/2012

SHEET NO. W-1