

C1 46187  
 1 2 3 6  
 (THIS NUMBER IS TO BE PUNCHED IN COLS. 3-6 ON ALL CARDS)

SEQUENCE NO. (MDE USE ONLY)

**STATE OF MARYLAND**  
**WELL COMPLETION REPORT**  
 FILL IN THIS FORM COMPLETELY  
 PLEASE TYPE

THIS REPORT MUST BE SUBMITTED WITHIN 45 DAYS AFTER WELL IS COMPLETED.

COUNTY NUMBER

ST/CO USE ONLY  
 DATE RECEIVED  
 MM DD YY  
 02 06 17  
 DATE WELL COMPLETED  
 \*original MM DD YY  
 copy last 11 17 16  
 in mail\* 15 20

Depth of Well  
 22 480' 26  
 (TO NEAREST FOOT)

PERMIT NO.  
 FROM "PERMIT TO DRILL WELL"  
 OK  
 26/17 SC  
 H0-15-0338  
 28 29 30 31 32 33 34 35 36 37

OWNER Register  
 WELL SITE ADDRESS 3670 Daisy Road TOWN Woodbine  
 SUBDIVISION \_\_\_\_\_ SECTION \_\_\_\_\_ LOT \_\_\_\_\_

**WELL LOG**  
 Not required for driven wells

STATE THE KIND OF FORMATIONS PENETRATED, THEIR COLOR, DEPTH, THICKNESS AND IF WATER BEARING

DESCRIPTION (Use additional sheets if needed)	FEET		check if water bearing
	FROM	TO	
topsoil:	0'	1'	
Silty, sand, brown,	1'	70'	
weathered rock	70'	80'	✓
Bed Rock Schist	80'	480'	✓

# Installed 1.25" x 480' HDPE - U-Bend closed loop

**GROUTING RECORD**

WELL HAS BEEN GROUTED (Circle Appropriate Box)  
 YES  NO   
 TYPE OF GROUTING MATERIAL (Circle one)  
 CEMENT:  BENTONITE CLAY:   
 NO. OF BAGS 21 NO. OF POUNDS 1,050  
 GALLONS OF WATER 399  
 DEPTH OF GROUT SEAL (to nearest foot)  
 from 0' ft. to 480' ft.  
 (enter 0 if from surface)

**CASING RECORD**  
 casing types insert appropriate code below  
 ST STEEL  
 CO CONCRETE  
 PL PLASTIC  
 OT OTHER

MAIN CASING TYPE  
 Nominal diameter top (main) casing (nearest inch)  
 Total depth of main casing (nearest foot)  
 60 61 63 64 66 70

**OTHER CASING (if used)**  
 diameter inch depth (feet) from to  
 EACH CASING \_\_\_\_\_

**SCREEN RECORD**  
 screen type or open hole insert appropriate code below  
 ST STEEL  
 BR BRASS  
 PL PLASTIC  
 HO OPEN HOLE  
 OT OTHER

**C 2** DEPTH (nearest ft.)

E	8	9	11	15	17	21
A						
C	23	24	26	30	32	38
H						
S	38	39	41	45	47	51
R						
E						
N						

SLOT SIZE - 1 \_\_\_\_\_ 2 \_\_\_\_\_ 3 \_\_\_\_\_  
 DIAMETER OF SCREEN \_\_\_\_\_ (NEAREST INCH)  
 56 60  
 from \_\_\_\_\_ to \_\_\_\_\_

GRAVEL PACK IF WELL DRILLED WAS FLOWING WELL INSERT F IN BOX 68 \_\_\_\_\_ 68

MDE USE ONLY (NOT TO BE FILLED IN BY DRILLER)  
 T (E.R.O.S.) W Q  
 70 \_\_\_\_\_ 72 \_\_\_\_\_ 74 75 76  
 TELESCOPE CASING LOG INDICATOR OTHER DATA

NUMBER OF UNSUCCESSFUL WELLS: 0  
 WELL HYDROFRACTURED YES  NO

CIRCLE APPROPRIATE LETTER  
 A A WELL WAS ABANDONED AND SEALED WHEN THIS WELL WAS COMPLETED  
 E ELECTRIC LOG OBTAINED  
 P TEST WELL CONVERTED TO PRODUCTION WELL

I HEREBY CERTIFY THAT THIS WELL HAS BEEN CONSTRUCTED IN ACCORDANCE WITH COMAR 26.04.04 "WELL CONSTRUCTION" AND IN CONFORMANCE WITH ALL CONDITIONS STATED IN THE ABOVE CAPTIONED PERMIT, AND THAT THE INFORMATION PRESENTED HEREIN IS ACCURATE AND COMPLETE TO THE BEST OF MY KNOWLEDGE.

DRILLERS LIC. NO. 1 M WD 572  
 DRILLERS SIGNATURE Samuel A. Connelly  
 (MUST MATCH SIGNATURE ON APPLICATION)

LIC. NO. 1 D

SITE SUPERVISOR (sign. of driller or journeyman responsible for sitework if different from permittee)

**C 3** PUMPING TEST

HOURS PUMPED (nearest hour) N/A  
 PUMPING RATE (gal. per min.) N/A  
 METHOD USED TO MEASURE PUMPING RATE N/A  
 WATER LEVEL (distance from land surface)  
 BEFORE PUMPING 80' ft.  
 WHEN PUMPING N/A ft.  
 TYPE OF PUMP USED (for test)  
 A air  P piston  T turbine  
 C centrifugal  R rotary  O other (describe below)  
 J jet  S submersible

**PUMP INSTALLED**

DRILLER INSTALLED PUMP (CIRCLE) (YES or NO) YES  NO   
 IF DRILLER INSTALLS PUMP, THIS SECTION MUST BE COMPLETED FOR ALL WELLS.  
 TYPE OF PUMP INSTALLED PLACE (A,C,J,P,R,S,T,O) IN BOX 29 \_\_\_\_\_ 29  
 CAPACITY: GALLONS PER MINUTE (to nearest gallon) \_\_\_\_\_ 31 \_\_\_\_\_ 35  
 PUMP HORSE POWER \_\_\_\_\_ 37 \_\_\_\_\_ 41  
 PUMP COLUMN LENGTH (nearest ft.) \_\_\_\_\_ 43 \_\_\_\_\_ 47  
 CASING HEIGHT (circle appropriate box and enter casing height)  
 + above } LAND SURFACE  
 - below } -3 (nearest foot)  
 49 50 51

LATITUDE 39.272834 (#1)  
 LONGITUDE 77.074581  
 (DEFAULT COORD. WGS 84)

Pursuant to §10-624 of the State Govt. Article of the Maryland Code personal info. requested on this form is used in processing this form pursuant to COMAR 26.04.04. Failure to provide the info. may result in this form not being processed. You have the right to inspect, amend, or correct this form. The Maryland Department of the Environment is subject to the Maryland Public Information Act. This form may be made available on the Internet via MDE's website and is subject to inspection or copying, in whole or in part, by the public and other governmental agencies, if not protected by federal or state law.

**B 1** SEQUENCE NO. (MDE USE ONLY) 46454 STATE OF MARYLAND APPLICATION FOR PERMIT TO DRILL WELL STATE PERMIT NUMBER HO-15-0338  
 1 2 3 6 559830-1 please type 70 fill in this form completely 79

Date Received (APA) 11/9/16  
**OWNER INFORMATION**  
 8 MM DD YY 13  
Reester Michael+Danielle  
 15 Last Name Owner First Name 34  
3670 Daisy Road  
 36 Street or RFD 55  
Woodbine MD 21797  
 57 Town 70 State 72 Zip 76

**B 3** LOCATION OF WELL  
Howard  
 8 COUNTY 21  
 23 SUBDIVISION 42  
 SECTION 44 46 LOT 48 50  
Woodbine  
 52 NEAREST TOWN 71

**DRILLER INFORMATION**  
Samuel A. Connelly MWD 572  
 Driller's Name 76 License No. 81  
Connelly & Associates, Inc.  
 Firm Name  
260 Interstate Ct. Frederick Md. 21704  
 Address  
Samuel A. Connelly 11/17/16 site  
 Signature Date

**B 4** SOURCES OF DRILLING WATER  
 1. Private  
 2.  
 3. grouting the bore.  
3670 Daisy Rd  
 11 STREET ADDRESS 30  
 ON WHICH SIDE OF ROAD (CIRCLE APPROPRIATE BOX)  
 NORTH  
 WEST EAST  
 SOUTH  
 34 400± 37  
 DISTANCE FROM ROAD ENTER FT OR MI 38 39  
 TAX MAP: 20 BLK: 11 PARCEL 109

**B 2** WELL INFORMATION  
 1 2 APPROX. PUMPING RATE (GAL. PER MIN.) 8 12  
 AVERAGE DAILY QUANTITY NEEDED (GAL. PER DAY) 14 20

**USE FOR WATER** (CIRCLE APPROPRIATE BOX)  
 DOMESTIC POTABLE SUPPLY & RESIDENTIAL IRRIGATION  
 FARMING (LIVESTOCK WATERING & AGRICULTURAL IRRIGATION)  
 INDUSTRIAL, COMMERCIAL, DEWATERING  
 PUBLIC WATER SUPPLY WELL  
 TEST, OBSERVATION, MONITORING  
 OPEN LOOP GEOTHERMAL  
 CLOSED LOOP GEOTHERMAL  
 1 & Bore

**NOT TO BE FILLED IN BY DRILLER HEALTH DEPARTMENT APPROVAL**  
Howard (13) P523546  
 COUNTY NAME COUNTY NO.  
 STATE SIGNATURE INSERT S →  
 DATE ISSUED 41  
11/9/16 W. M. Huff 11/9/17  
 43 MM DD YY 48 CO SIGNATURE EXP. DATE

APPROXIMATE DEPTH OF WELL 480 FEET  
 24 28  
 APPROXIMATE DIAMETER OF WELL 6 INCH  
 NEAREST INCH

PROPOSED LOCATION OF WELL ON LOT  
 SHOW PERMANENT STRUCTURES SUCH AS BUILDINGS, SEPTIC SYSTEM, ROADS AND/OR LANDMARKS AND INDICATE NOT LESS THAN TWO DISTANCE MEASUREMENTS TO WELL

**METHOD OF DRILLING** (circle one)  
 BORED (or Augered) JETTED Jetted & DRIVEN  
 30 AIR-ROTary AIR-PERcussion ROTARY (Hydraulic Rotary)  
 37 CABLE REVerse-ROTary DRive-POINT  
 other

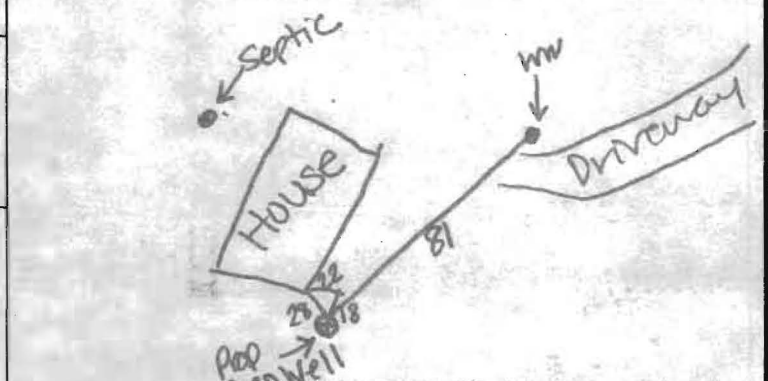

**REPLACEMENT OR DEEPEMED WELLS** (CIRCLE APPROPRIATE BOX)  
 THIS WELL WILL NOT REPLACE AN EXISTING WELL  
 THIS WELL WILL REPLACE A WELL THAT WILL BE ABANDONED AND SEALED  
 39  THIS WELL WILL REPLACE A WELL THAT WILL BE USED AS A STANDBY-CONTACT LOCAL APPROVING AUTHORITY FOR POLICY ON STANDBY WELLS  
 THIS WELL WILL DEEPEM AN EXISTING WELL  
 PERMIT NUMBER OF WELL TO BE REPLACED OR DEEPEMED (IF AVAILABLE) 41 52

**Not to be filled in by driller (MDE OR COUNTY USE ONLY)**  
 APPROP. PERMIT NUMBER - - - - - G - - - - -  
 PERMIT No. HO-15-0338  
 70 71 72 73 74 75 76 77 78 79

Pursuant to § 10-624 of the State Govt. Article of the Maryland Code, personal info requested on this form is used in processing this form pursuant to COMAR 26.04.04. Failure to provide the info may result in this form not being processed. You have the right to inspect, amend, or correct this form. The Maryland Department of the Environment is subject to the Maryland Public Information Act. This form may be made available on the Internet via MDE's website and is subject to inspection or copying, in whole or in part, by the public and other governmental agencies, if not protected by federal or State Law.

SPECIAL CONDITIONS Grout bore bottom to top.  
 NOTE: APPROVING AUTHORITIES SHOULD USE SEPARATE SHEET IF NEEDED.

Shared Drive  
To Daisy Road

Well HO 73 0917

NOT TO SCALE

81'

64'  
60'

N

22'

18'  
28'

HOUSE

GARAGE  
SHED

Screened  
Porch

~20'

Septic Tank  
C/O

sidewalk

70'

27'

Perc Hole

Ex.  
Drywell  
Collapsed

13'

101'

11/9/16  
Geo Base Loc.  
Site Approved  
-KNED



DO NOT REMOVE THIS TAG  
DEPARTMENT OF THE ENVIRONMENT  
WELL PERMIT NUMBER

HO-15-0338

INFORMATION-GIVE NUMBER AND WRITE  
1800 WASHINGTON BLVD  
BALTIMORE MARYLAND, 21230

NOTE: GEOTHERMAL WELL LOCATION IS GREATER THAN 50 FEET FROM DOMESTIC WATER WELL AND SEPTIC TANK/DRAINAGE FIELD.

L E G E N D

-  PROPOSED GEOTHERMAL WELL LOCATION
-  APPROXIMATE DOMESTIC WELL LOCATION
-  APPROXIMATE ~~DOMESTIC WELL~~ <sup>Septic</sup> LOCATION

NOT TO SCALE

**Connelly Geothermal**  
Partnering with Mother Earth

260 Interstate Court (301) 696-8820  
Frederick, Maryland 21704 (301) 696-0327 fax

REGISTER RESIDENCE  
3670 DAISY ROAD, WOODBINE, MARYLAND

PROPOSED GEOTHERMAL WELL  
LOCATION PLAN

Scale:  
AS SHOWN

Fig.

Date:  
NOV. 2016

Drawn By:  
J.A.

Checked By:  
E.S.

Project No.:  
00000

1

Geothermal Closed Loop / Address: 3670 Daisy Rd, Woodbine, MD

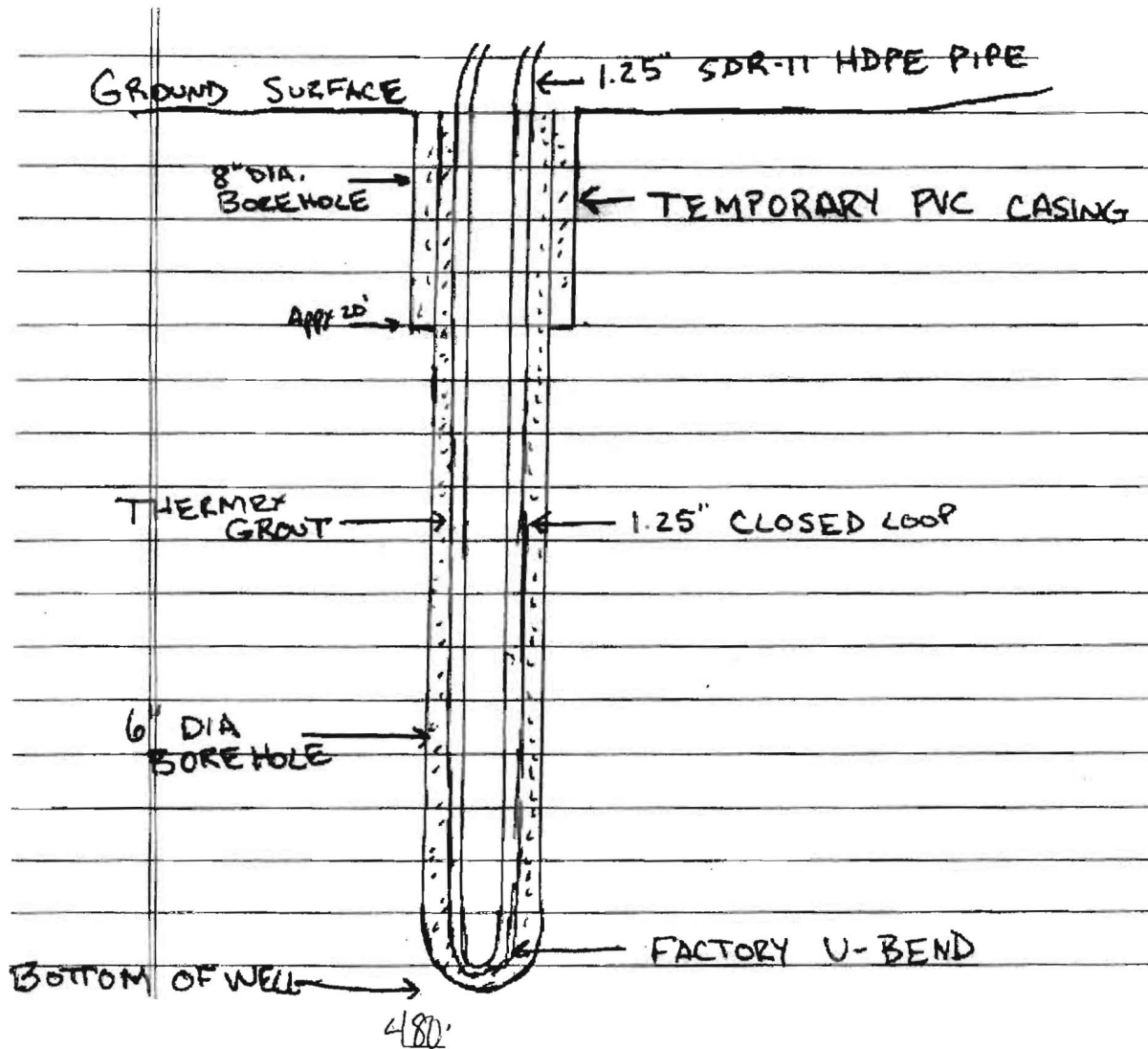

Grout information for this property is as follows:

Thermex grout mixture of 50 lb. grout to 19 gallons water, placed in the well using the tremie method, from bottom to top.

