

5/29/88
Now
5/9/88
9:30

6/25/88
Asm ASAP

03-298949

PERMIT

P 41790

A REPAIR

SEWAGE DISPOSAL SYSTEM

MARYLAND STATE DEPARTMENT OF HEALTH DISTRICT _____

HOWARD COUNTY
BUREAU OF ENVIRONMENTAL HEALTH
461-9933

DATE 5/18/88

INDEXED

DATE SYSTEM APPROVED 5-15-88

INSPECTOR S. Shul

Arnold Backhoe & Septic Services, Inc. IS PERMITTED TO INSTALL _____ ALTER X

ADDRESS P. O. Box 15, Woodbine, Maryland 21797 PHONE 795-7873

SUBDIVISION Map 15, Grid 6, P. 105 ROAD 2050 (1st house on drive)
~~2050~~ Mt. View Road LOT _____

PROPERTY OWNER Robert McManus **BLDG. PERMIT SIGNED**
ADDRESS 2050 Mt. View Road **AND RETURNED 5-6-88**

IF GARBAGE GRINDER IS USED INCREASE SEPTIC TANK CAPACITY BY 50% AND ABSORPTION AREA BY 22%. surplus 158

GARBAGE GRINDER? YES _____ NO X

SEPTIC TANK CAPACITY _____ GALLONS NUMBER OF BEDROOMS 3

5 (47.4) / 1.26 = 94.8 ft

REPAIR - CALL FOR INSPECTION WHEN GROUND IS OPENED UP SO SANITARIAN CAN RECOMMEND REPAIR.

5-24-88 Dry well was full, 1in below top of drywell. 158 sq ft/bdrm.
Perc test: 14.5 ft deep, 0'-3.5' rd-brcsa s/c, 3.5'-14.5' Tanpsa s/l/m, <10%
saprolite, bottom ok. Perc at 4.0': 11:54 - 11:59 1st
11:59 - 12:05 = 6min, Inlet at 1/4 Bottom
maximum at 9ft. 5 ft of stone, 12 1/2 ft trench. Maintain 75 ft
of existing well. Pump and clean cesspool. If in need of repairs, replace
with 1050 gal tank. JEN

PLANS APPROVED BY 1000 5-27-88 JEN C. Williams DATE 5/18/88

COVER NO WORK UNTIL INSPECTED AND APPROVED

NEITHER THE HOWARD COUNTY COUNCIL NOR THE HEALTH DEPARTMENT IS RESPONSIBLE FOR THE SUCCESSFUL OPERATION OF ANY SYSTEM.

NOTE: CLEANOUT REQUIRED EVERY 70 FEET OF SEWER LINE AND/OR AT 90° SWEEPS IN LINES FROM HOUSE TO DRAIN FIELDS.

NOTE: ALL PARTS OF SEPTIC SYSTEMS (I.E., TANK, DISTRIBUTION BOX, TRENCHES) TO BE 100 FEET FROM WELL. (UNLESS OTHERWISE SPECIFICALLY AUTHORIZED)

NOTE: IF DEEP TRENCH(ES) ARE USED CALL FOR INSPECTION BEFORE AND AFTER PLACING GRAVEL IN TRENCH(ES).

NOTE: NO DRY WELL SHALL EXCEED 15 FOOT IN DIAMETER. NO ABSORPTION TRENCH TO EXCEED 100 FEET IN LENGTH.

NOTE: ALL PIPE FROM HOUSE TO SEPTIC TANK MUST BE CAST IRON OR SCHEDULE 40 PVC OR ABS.

PERMIT VOID AFTER TWO YEARS.

NOTE: INSTALL STAND PIPE ON SEPTIC TANK AND DRY WELL. STAND PIPES MUST BE 6 INCHES IN DIAMETER. CAST IRON, CONCRETE OR TERRA COTTA OR PVC OR ABS ACCEPTED. IF TOP OF SEPTIC TANK IS DEEPER THAN 3 FEET, MANHOLE TO GRADE REQUIRED.

NOTE: DISTRIBUTION BOXES MUST HAVE BAFFLES.

BLDG. PERMIT SIGNED

AND RETURNED 5-4-88

Serial # 217116424
dict.

***INSTALLER IS RESPONSIBLE FOR OBTAINING FINAL APPROVAL ON THIS PERMIT**

*CALL 461-9933 FOR INSPECTION OF SEPTIC SYSTEMS.

EH - 2-1186

P 41790

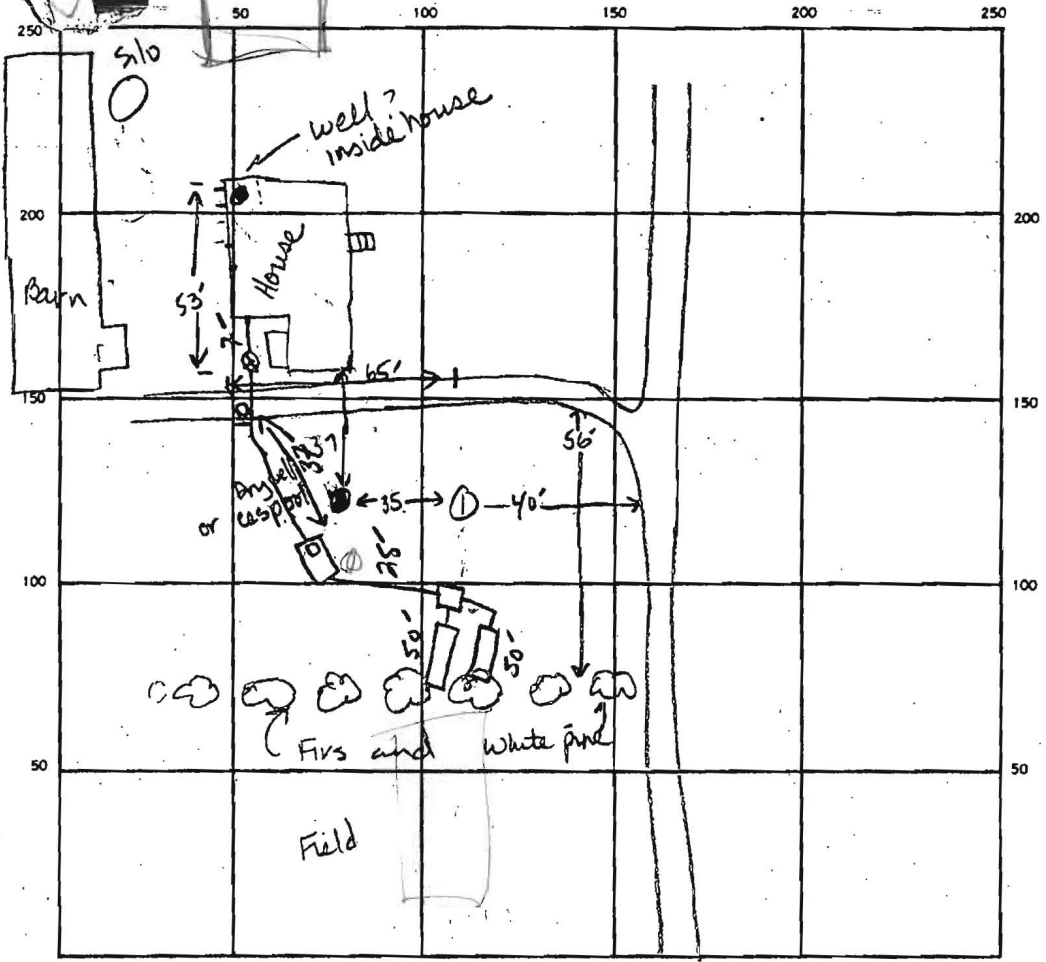

3
 28
 24
 70
 46
 52
 D
 27
 24
 108

INDICATE NORTH. - NAME ADJOINING ROADWAY AS BASE LINE.

Mt View Road

SEPTIC TANK. LEVEL EXISTING 2000⁺ GAL CLEANOUTS INLINE + ST
 DISTRIBUTION BOX. LEVEL
 DRAIN FIELD/TILE FIELD. DEPTH 9' FT. TRENCH WIDTH 2 FT. INLET DEPTH 4' FT.
 EFFECTIVE GRAVEL DEPTH 5' FT. TOTAL LENGTH 50' 50' 100' FT.
 NUMBER OF TRENCHES 2 ONE SIDEWALL/BOTTOM AREA 500 SQ. FT.
 DRYWELL INSIDE DIAMETER _____ FT. EFFECTIVE DEPTH BELOW INLET _____ FT.
 ABSORBENT AREA 500 SQ. FT.

Trenches Installed

REMARKS 6/9/88 NOTHING DONE R.H.
6-15-88 OK TO COVER

DATE SYSTEM APPROVED 6-15-88 INSPECTOR S. Abel

Charlie's Bobcat Service, Inc.

13 Energetic Endeavor Drive

Sykesville, MD 21784

410-549-8020 or 410-549-8021

Fax 410-549-8022

January 29, 2013

Howard County Health Department

7178 Columbia Gateway Drive

Columbia, MD 21046

To Whom It May Concern,

This letter is regarding a septic tank we abandoned at 2050 Mount View Road, Marriottsville, MD 21104. I have enclosed several pictures for your review as well. Please let me know if you should need anything further.



Charles W. Palmer, Jr.

Charlie's Bobcat Service, Inc.