

C 1 0658 SEQUENCE NO. (MDE USE ONLY)

STATE OF MARYLAND WELL COMPLETION REPORT FILL IN THIS FORM COMPLETELY PLEASE TYPE

THIS REPORT MUST BE SUBMITTED WITHIN 45 DAYS AFTER WELL IS COMPLETED. COUNTY NUMBER 13 A 520093

ST/CO USE ONLY DATE Received MM DD YY 8 13

DATE WELL COMPLETED MM DD YY 08 20 10

Depth of Well 22 240 28 4/5/11 0.K. (PB) (TO NEAREST FOOT)

PERMIT NO. FROM "PERMIT TO DRILL WELL" HO-95-1961

OWNER Deveraux Cindy last name first name STREET OR RFD Florence Rd TOWN Mt. Airy SUBDIVISION Kogen Trust SECTION LOT 16

WELL LOG Not required for driven wells STATE THE KIND OF FORMATIONS PENETRATED, THEIR COLOR, DEPTH, THICKNESS AND IF WATER BEARING

GROUTING RECORD WELL HAS BEEN GROUTED (Y) (N) TYPE OF GROUTING MATERIAL (C) (M) (B) (C) NO. OF BAGS 19 NO. OF POUNDS 1580 GALLONS OF WATER 114 DEPTH OF GROUT SEAL (to nearest foot) from 0 ft. to 64 ft.

CASING RECORD casing types insert appropriate code below (S) (T) (C) (O) (P) (L) (O) (T) MAIN CASING TYPE PL Nominal diameter top (main) casing (nearest inch) 6 Total depth of main casing (nearest foot) 67

OTHER CASING (if used) diameter inch depth (feet) from to

SCREEN RECORD screen type or open hole (S) (T) (B) (R) (H) (O) (P) (L) (O) (T) DEPTH (nearest ft.) 1 2 140 65 240

NUMBER OF UNSUCCESSFUL WELLS: 0 WELL HYDROFRACTURED (Y) (N)

CIRCLE APPROPRIATE LETTER A WELL WAS ABANDONED AND SEALED WHEN THIS WELL WAS COMPLETED E ELECTRIC LOG OBTAINED P TEST WELL CONVERTED TO PRODUCTION WELL

I HEREBY CERTIFY THAT THIS WELL HAS BEEN CONSTRUCTED IN ACCORDANCE WITH COMAR 26.04.04 "WELL CONSTRUCTION" AND IN CONFORMANCE WITH ALL CONDITIONS STATED IN THE ABOVE CAPTIONED PERMIT, AND THAT THE INFORMATION PRESENTED HEREIN IS ACCURATE AND COMPLETE TO THE BEST OF MY KNOWLEDGE.

DRILLERS LIC. NO. M SD 112 DRILLERS SIGNATURE (MUST MATCH SIGNATURE ON APPLICATION)

LIC. NO. D

SITE SUPERVISOR (sign. of driller or journeyman responsible for sitework if different from permittee)

DEPTH (nearest ft.) 1 2 140 65 240

GRAVEL PACK IF WELL DRILLED WAS FLOWING WELL INSERT F IN BOX 68

MDE USE ONLY (NOT TO BE FILLED IN BY DRILLER) T (E.R.O.S.) W Q 70 72 74 75 76 TELESCOPE CASING LOG INDICATOR OTHER DATA

PUMPING TEST HOURS PUMPED (nearest hour) 3 PUMPING RATE (gal. per min.) 5 METHOD USED TO MEASURE PUMPING RATE Bucket WATER LEVEL (distance from land surface) BEFORE PUMPING 50 ft. WHEN PUMPING 110 ft. TYPE OF PUMP USED (for test) (A) air (P) piston (T) turbine (C) centrifugal (R) rotary (O) other (describe below) (J) jet (S) submersible

PUMP INSTALLED DRILLER INSTALLED PUMP (YES) (NO) IF DRILLER INSTALLS PUMP, THIS SECTION MUST BE COMPLETED FOR ALL WELLS. TYPE OF PUMP INSTALLED PLACE (A,C,J,P,R,S,T,O) IN BOX 29. CAPACITY: GALLONS PER MINUTE (to nearest gallon) 31 35 PUMP HORSE POWER 37 41 PUMP COLUMN LENGTH (nearest ft.) 43 47 CASING HEIGHT (circle appropriate box and enter casing height) (+) above ( ) below LAND SURFACE 2 (nearest foot)

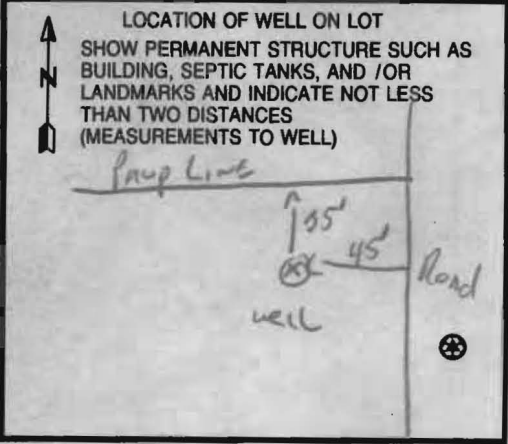

B 1 0874

SEQUENCE NO. (MDE USE ONLY)

STATE OF MARYLAND APPLICATION FOR PERMIT TO DRILL WELL 533 223 please type

STATE PERMIT NUMBER

140-95-1961 fill in this form completely

Date Received (APA)

OWNER INFORMATION

Deveneux William E Cindy 1850 Florence Rd Mt. Airy MD 21771

LOCATION OF WELL

Howard Kogan Trust Property Mt. Airy

MILES FROM TOWN (enter 0 if in town) 3

DRILLER INFORMATION

Ralph E. Mayne M 5 D 117 Ralph Mayne Well Drilling 17024 Handy Rd Mt. Airy MD 21771 4/28/10

DIRECTION OF WELL FROM TOWN (CIRCLE BOX)

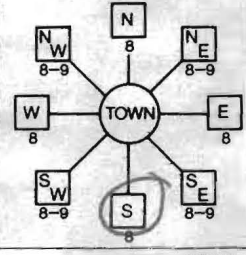

Florence Rd NEAR WHAT ROAD

ON WHICH SIDE OF ROAD (CIRCLE APPROPRIATE BOX) NORTH SOUTH DISTANCE FROM ROAD 40 ENTER FT OR MI 44

TAX MAP: 6 BLK: 23 PARCEL 247

WELL INFORMATION

APPROX. PUMPING RATE 5 GAL. PER MIN. AVERAGE DAILY QUANTITY NEEDED 500 GAL. PER DAY

NOT TO BE FILLED IN BY DRILLER HEALTH DEPARTMENT APPROVAL

Howard A 520023 COUNTY NAME COUNTY NO. STATE SIGNATURE INSERT S DATE ISSUED 7/30/10 CO SIGNATURE Phil Wolf 7/30/11 NORTH GRID 541 000 EAST GRID 0759 000

USE FOR WATER (CIRCLE APPROPRIATE BOX)

- Domestic Potable Supply & Residential Irrigation (circled) Farming (Livestock Watering & Agricultural Irrigation) Industrial, Commercial, Dewatering Public Water Supply Well Test, Observation, Monitoring Geo-Thermal

SHOW MAJOR FEATURES OF BOX & LOCATE WELL WITH AN X

SOURCES OF DRILLING WATER 1. well 2. 3.

WRITE THE BOX NUMBER FROM THE MAP HERE

E 760 59 N 500 41

DRAW A SKETCH BELOW SHOWING LOCATION OF WELL IN RELATION TO NEARBY TOWNS AND ROADS AND GIVE DISTANCE FROM WELL TO NEAREST ROAD JUNCTION

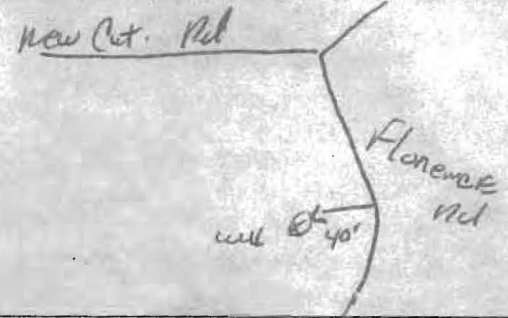

APPROXIMATE DEPTH OF WELL 150 FEET

APPROXIMATE DIAMETER OF WELL 6 1/2 INCH

METHOD OF DRILLING (circle one)

AIR-ROTary JETTED ROTARY (Hydraulic Rotary) CABLE REVERSE-ROTary DRIVE-POINT

REPLACEMENT OR DEEPEMED WELLS (CIRCLE APPROPRIATE BOX)

- This well will not replace an existing well (circled) This well will replace a well that will be abandoned and sealed This well will replace a well that will be used as a standby-contact local approving authority for policy on standby wells This well will deepen an existing well

PERMIT NUMBER OF WELL TO BE REPLACED OR DEEPEMED (IF AVAILABLE)

Not to be filled in by driller (MDE OR COUNTY USE ONLY)

APPROP. PERMIT NUMBER G PERMIT No. 140-95-1961

SPECIAL CONDITIONS

NOTE - APPROVING AUTHORITIES SHOULD USE SEPARATE SHEET IF NEEDED





**HOWARD COUNTY HEALTH DEPARTMENT  
BUREAU OF ENVIRONMENTAL HEALTH  
WELL & SEPTIC PROGRAM  
TEL: (410)313-1771 FAX: (410)313-2648**

**Information Form for the Installation of the Well Pump, Pitless Adapter, and Supply Piping**

**NOTE: The installer is responsible for requesting an inspection prior to 9 am on the day of the desired inspection. No work is to be covered until approved by the Health Department. All installations must comply with the National Standard Plumbing Code (NSPC, as amended locally) and COMAR 26.04.04 (MD Well Construction Regulations). Submission of a complete form is required prior to Use and Occupancy approval.**

Company Name: Cumberland Co. Inc. Telephone #: 301-259-1123  
Address: 16391 A.E. Mullinix Rd  
Woodbine MD

(Must circle one) Licensed Plumber Licensed Well Driller Licensed Well Pump Installer  
License # and name of individual responsible for the field installation:  
Name (Print): Kelly Cumberland License# 61417

**\*A licensed individual must perform the actual installation. Apprentices must be under the supervision of a licensed journeyman or master plumber, pump installer or well driller. Licenses may be subjected to field verification. Unlicensed individuals may be reported to the appropriate licensing agency.\***

Name of Property Owner: Curtis Cumberland Telephone #: 301-259-1122  
Subdivision: \_\_\_\_\_ Lot #: \_\_\_\_\_ Well Tag #: HO-95-1961  
Site Address: 1820 Florence Rd Mt Airy

<b><u>Submersible Pump Data</u></b>	<b><u>Pitless Adapter</u></b>	<b><u>Well Cap and Electric Conduit</u></b>
Make: <u>Mycos-5-P4</u>	Make: <u>1" Fern</u>	Two piece watertight cap: <input checked="" type="checkbox"/>
Model #: <u>25152</u>	Model #: <u>1"</u>	Screened, vented well cap: <input checked="" type="checkbox"/>
Pump Capacity <u>5</u> GPM	Depth: <u>42"</u> (36" min)	Cap secured to casing: <input checked="" type="checkbox"/>
Well Yield: <u>5</u> GPM	NSF/WSC approved: <input checked="" type="checkbox"/>	Conduit min 18" B.G.: <input checked="" type="checkbox"/>
Depth of well encountered at time of pump installation: <u>240</u> (feet)		Conduit secured to well cap: <input checked="" type="checkbox"/>
If pump capacity exceeds well yield, a low water cut off switch is required by NSPC 1990 Section 17.8.4		
Torque arrestors, <u>Cable guards</u> , or other acceptable method used— Must circle one		
Safety rope, if used, attached to brass rope adapter or other acceptable method <u>inside of well casing</u>		

<b><u>Piping to house</u></b>	<b><u>House Connection</u></b>
Type: <u>1" Poly</u>	PVC sleeve to undisturbed soil at wall penetration: <input checked="" type="checkbox"/>
PSI: <u>160</u> (160 psi min)	Length of sleeve (5' minimum from foundation): <u>72"</u>
Depth of supply line: <u>48"</u> (36" min)	Sleeve sealed properly: <input checked="" type="checkbox"/>

**The water supply line is required to be at least ten feet from the septic tank, pump chamber, sewage piping, distribution box, drainfields, and sewage reserve area. If this cannot be accomplished, contact this office for approval prior to installation.**

Signature of company representative responsible for installation: [Signature] date: 10-31-16

**For Health Department Use Only – Not to be completed by Installer**

Date Insp. Requested: 8/3/16 Date Insp. Approved: 8/3/16 Inspector: SC

Inspection Data: Pitless adapter watertight & water supply line at least 36" below grade	<input checked="" type="checkbox"/>
Two piece cap installed and attached to casing securely	<input checked="" type="checkbox"/>
Elec. conduit extends at least 18" below grade/attached to cap properly	<input checked="" type="checkbox"/>
Safety rope not outside of well cap/casing	<input checked="" type="checkbox"/>
Correct well tag attached properly and casing 8" above finished grade	<input checked="" type="checkbox"/>
Water supply line sleeved adequately at house connection	<input checked="" type="checkbox"/>
Adequate grout observed below pitless adapter	<input checked="" type="checkbox"/>

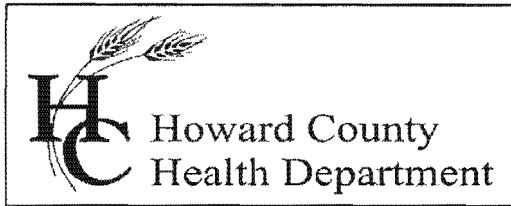

## Bureau of Environmental Health

8930 Stanford Blvd., Columbia, MD 21045  
Main: 410-313-2640 | Fax: 410-313-2648  
TDD 410-313-2323 | Toll Free 1-866-313-6300  
[www.hchealth.org](http://www.hchealth.org)  
Facebook: [www.facebook.com/hocohealth](https://www.facebook.com/hocohealth)  
Twitter: HowardCoHealthDep

Maura J. Rossman, M.D., Health Officer

---

### INTERIM CERTIFICATE OF POTABILITY

Expiration Date - JUNE 13, 2017

**December 13, 2016**

Homeowner  
1820 Florence Road  
Mt. Airy, MD 21771

**RE:** Kogan Trust Property, Lot 16  
1820 Florence Road  
**Building Permit: B16002172**  
**Well Permit: HO-95-1961**

Dear Homeowner:

This is to advise you that the septic system installation and water well construction for the above referenced property have been inspected and approved. Final approval of the septic system was granted on **10/24/2016**. Final approval of the well line connection to the dwelling was granted on **8/3/2016**. The well construction was completed on **8/20/2010**. Water samples were collected on **12/7/2016**.

The water sample results indicate that the water samples submitted for testing were free of coliform and fecal coliform bacteria at the time of sampling and are bacteriologically safe for drinking.

This certifies that the initial sampling requirements of COMAR 26.04.04 "Well Regulations" have been met for the water supply system installed under well permit **HO-95-1961**. Although the submitted sample results are in compliance with COMAR standards, the Health Department does not guarantee water supplies.

This Interim Certificate of Potability will expire **six months** from the date of issuance. Submission of a second bacteriological test indicating the water is free of coliform and fecal coliform bacteria is required prior to the expiration date, after which time a Final Certificate of Potability will be issued. **Failure to submit an additional sample and obtain a Final Certificate of Potability will result in a Notice of Violation and is punishable as a misdemeanor under the Annotated Code of Maryland, Environment Article, 9-1311, subject to a fine of up to \$500 or imprisonment not to exceed three months.**

Please contact (410) 313-1773 to schedule a final water sample appointment or contact a Maryland certified water laboratory to schedule a water sample. A list of laboratories certified by the state of Maryland may be found at the following website:

<http://www.mde.state.md.us/assets/document/WSP-Labs-2010apr16.pdf>

In closing, please refer to our "Homeowner Fact Sheet" which illustrates a better understanding for your Best Available Technology (BAT). You will also find a link to Maryland Department of the Environments website which describes in further detail operation and maintenance of your BAT.

Approving Authority,

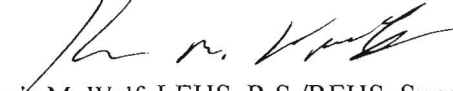

Kevin M. Wolf, LEHS, R.S./REHS, Supervisor  
Groundwater Management Section  
Well & Septic Program

cc: Howard County Dept. of Inspections, Licenses, and Permits  
Community Hygiene Program  
File

# FOUNTAIN VALLEY ANALYTICAL LABORATORY, INC.

1413 Old Taneytown Rd. Westminster, MD (410) 848-1014 (410) 876-4554 FAX (410) 848-0298

## REPORT OF ANALYSIS

Laboratory ID #: 111763 Account #: 7085  
Reference: Cumberland Development Company: Cumberland Development  
Location: 1820 Florence Road Requested By: Curtis L. Cumberland  
Mount Airy, MD 21771 Source: Well Water  
Date/ Time Collected: 12/7/2016 0840 Site: Pressure Tank  
Date/Time Rec'd: 12/7/2016 1125 Treatment: None  
Chlorine ppm: Free: ND Total: ND pH: 6.3  
Collected By: J. Yeager 6176JY Well #: HO-95-1961

PARAMETERS	RESULTS	UNITS	REFERENCE	METHOD	DATE/TIME/ANALYST
Bacteria, Coliform, Total, MPN	<1.0	MPN/ 100 ml	<1.0	SM18 9223	12/8/2016 / 0800 / LLO
Bacteria, E. coli, MPN	<1.0	MPN/ 100 ml	<1.0	SM18 9223	12/8/2016 / 0800 / LLO
Nitrate	5.35	mg/L	10	601	12/7/2016 / 1525 / CRS
Turbidity	3.42	NTU	<10	SM18 2130B	12/7/2016 / 1530 / CRS
Sand	NS	mg/L	5	Visual/Gravimetric	12/7/2016 / 1530 / CRS

OK  
12/12/16 SCJ

### NOTES

- 1 mg/L = milligrams per liter (also, parts per million)
- 2 MPN/ 100 ml = Most Probable Number [of viable bacteria] per 100 ml of sample.
- 3 NS = None Seen (NS indicates less than 5 mg/L)
- 4 NTU = Nephelometric Turbidity Units
- 5 Results less than or within the reference range are considered satisfactory and within potable water limits at the time of sampling.
- 6 ND:None Detected
- 7 Visual well check: Sealed, vented cap
- 8 pH & Chlorine level tested on site

Reason for Test : Use & Occupancy

Building Permit # : 16002172

Date Reported: 12/8/2016

