

Bureau of Environmental Health
 8930 Stanford Boulevard, Columbia, MD 21045
 Main: 410-313-2640 | Fax: 410-313-2648
 TDD 410-313-2323 | Toll Free 1-866-313-6300
www.hchealth.org
 Facebook: www.facebook.com/hocohealth

Maura J. Rossman, M.D., Health Officer

RECEIPT DATE: 5/27/16

ONSITE SEWAGE DISPOSAL SYSTEM

P 558734

INSTALLATION

APPROVAL DATE: 6/3/16 (SEC)

PERMIT
TANK REPLACEMENT

A _____

PROPERTY ADDRESS: 6757 Cortina Drive

SUBDIVISION: Deer Track

LOT: 10

TAX ID: 05-417716

CONTRACTOR: Hatfield's Equipment

EMAIL: ken@hatfieldsequipment.com

CONTRACTOR ADDRESS: P.O. Box 519, Annapolis Junction, MD 20701

PHONE: 301-490-4289

PROPERTY OWNER: Nathaniel and Annette Williams

EMAIL: _____

OWNER ADDRESS: 6757 Cortina Drive, Highland, MD 20777

PHONE: 410-984-5393

NUMBER OF BEDROOMS: _____

SEPTIC TANK SIZE: 1500

DRAINFIELD SIZE/TYPE: _____

LOCATION:	
NOTES:	<p>Install new tank in order to build deck. Tie new tank into existing system. Tank should be (2) compartment and slotted.</p>

ISSUED BY: Hank Oswald

ISSUE DATE: 5/27/16

EXPIRATION DATE: 5/27/17

NOTE: CONTRACTOR MUST SCHEDULE AN INSPECTION AND GAIN APPROVAL OF ALL COMPONENTS PRIOR TO COVERING

NOTE: AN ELECTRICAL PERMIT IS REQUIRED FOR INSTALLATION OF ANY ELECTRICAL COMPONENTS OF THE SYSTEM

NOTE: MDE RECOMMENDS SEPTIC TANKS, BAT, AND OTHER PRETREATMENT UNITS BE PUMPED AT A FREQUENCY ADEQUATE TO ENSURE THAT SOLIDS ARE NOT DISCHARGED TO THE DISPOSAL AREA

**NEITHER THE HOWARD COUNTY COUNCIL NOR THE HEALTH DEPARTMENT IS RESPONSIBLE FOR THE SUCCESSFUL OPERATION OF ANY SYSTEM.
 PERMITTEE RESPONSIBLE FOR OBTAINING FINAL APPROVAL ON THIS PERMIT.
 CALL 410-313-1771 FOR INSPECTION OF SEPTIC SYSTEM.**

W H0-94-0186

NOT TO SCALE

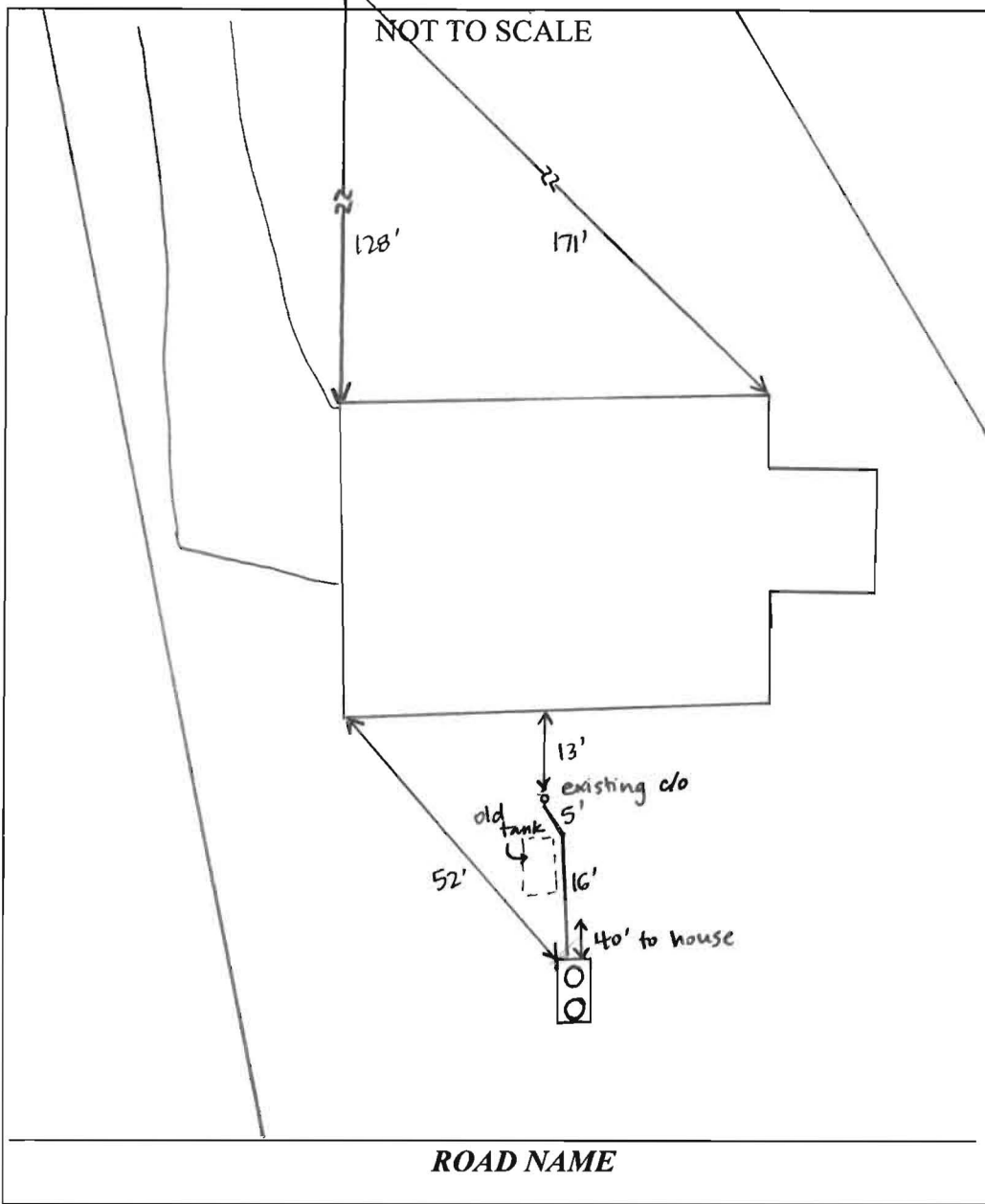

TRENCH/DRAINFIELD DATA

WIDTH	INLET	BOTTOM
_____	_____	_____
NUMBER OF TRENCHES	_____	
TOTAL LENGTH	_____	
ABSORPTION AREA	_____	
DISTRIBUTION BOX LEVEL	_____	
DISTRIBUTION BOX BAFFLE	_____	
DISTRIBUTION BOX PORT	_____	

SEPTIC TANK DATA

SEPTIC TANK I LEVEL YES

MANUFACTURER BABYLON

CAPACITY 1500 GAL

SEAM LOC TOP

TANK LID DEPTH 2.5'

BAFFLES YES

BAFFLE FILTER NO

MANHOLE LOC FRONT + REAR

6" PORT LOC NONE

WATERTIGHT TEST NO

SLOTTED YES

DATE ON LID 4-10-16

~~PUMP/SEPTIC TANK LEVEL _____~~

~~MANUFACTURER _____~~

~~CAPACITY _____ GAL~~

~~SEAM LOC _____~~

~~TANK LID DEPTH _____~~

~~BAFFLES _____~~

~~BAFFLE FILTER _____~~

~~MANHOLE LOC _____~~

~~6" PORT LOC _____~~

~~WATERTIGHT TEST _____~~

~~SLOTTED _____~~

~~DATE ON LID _____~~

PRE-CONSTRUCTION:

INSTALLATION: 6/3/16 New tank installed and connected to existing system. Old tank pumped + removed. hole filled in with CP-G. (SC)

FINAL INSPECTOR Sarah Collins . DATE OF APPROVAL 6/3/16 .

Hatfield's Equipment and Dedication Services, Inc.

P.O. Box 519 • Annapolis Junction, MD 20701-0519
Office: 301-490-4289 / 888-490-4289 • Fax: 301-490-5794

Stevens Builders
4829 Ten Oaks Road
Dayton, MD 21036
Phil Stevens

Relocated and install new tank
Williams Residence
6757 Cortina Drive
Highland, MD 20777
Proposal # 7482

May 24, 2016

We propose to supply the labor, materials and equipment to complete the following:

Apply for permit.
Pump, crush and fill existing tank
Extend schedule 40 pipe to the new location
Install a new 1500 gallon top seam septic tank
Install a 30" manhole riser to grade
Tie onto existing distribution pipe
Inspected and backfilled

Total Cost \$ 4,760.00

Exclusions: export of fill, import of fill, asphalt repair, concrete repair, temporary fencing, any items not priced above.

All work to be billed as completed.

Customer agrees to pay Hatfield's Equipment And Dedication Services Inc. in full the amount due within 30 days.

A finance charge at the periodic rate of 2% per month which constitutes an annual percentage rate of 24%, will be applied to any balances not paid in 30 days

Customer agrees to pay 40% of amount due as attorney fees if placed in the hands of an attorney for collection.

Non-payment of any past due amount will be sufficient justification to stop work on the project.

Respectfully Submitted

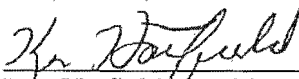

Ken Hatfield, president

Accepted by

Signature

Print Name