

# MOUND TEST DATA SHEETS

Property I.D. \_\_\_\_\_ Lot # \_\_\_\_\_ Date 3/27/07

Sanitarian GAC Landscape Position Toe

% Slope ~8% Soil Type GnB Contractor \_\_\_\_\_

HOLE # F DEPTH OF TEST 2' START TIME 10:17

0	Brn Lm organic
4"	Str. Brwn Salm. Columnar Str. - Angular Blk
20"	Brn Lm. Silty
24"	Pale Yellow Silty Faint Yellowish Red Mottles (Many)
30"	Psk Yllow Silty w/ Many prominent Yellowish Red Mottles (Fragipan) @ 38"
4'	

Hook Gauge Reading	Elapsed Time (min)	Measured Drop	Estimated Rate	% Change
<del>7 5/16</del>	<del>10m</del>	<del>11/16</del>		
<del>6 5/8</del>	<del>10m</del>	<del>11/16</del>		0
<del>5 5/16</del>	<del>10m</del>	<del>11/16</del>		0
<del>5 3/8</del>	<del>10m</del>	<del>9/16</del>		13%
<del>4 13/16</del>	<del>10m</del>	<del>9/16</del>		-
<del>4 3/8</del>	<del>10m</del>	<del>7/16</del>		12%
<del>3 3/4</del>	<del>10m</del>	<del>5/8 = 10/16</del>		2 1/2%
<del>3"</del>	<del>10m</del>	<del>3/4 = 12/16</del>		12%
<del>2 11/16</del>	<del>10m</del>	<del>5/16</del>		44%
<del>2 1/4</del>	<del>10m</del>	<del>7/16</del>		13%

Leaking Infiltration Test Data Sheet  
 4 5/16 - 3 1/16  
Leaking Infiltration  
 Sheet 1  
 See 2nd Data Sheet

69  
56  
44  
63  
75  
31  
44

HOLE # G DEPTH OF TEST 24" START TIME 11:23

4"	Brown Organic Salm
16"	10YR 4/4 Dk Yllow Brn Salm Ang. Blk str. gr. cr.
25"	Yellowish Brn 10YR 5/8 Silty High Silty Columnar w/ Ang Blk str.
30"	Str. Brwn 5/8 7.5YR 2 Silty
36"	2.5Y Lt yellow Brn Oxidized Silty w/ oxidation 5YR 4/6 Yellow Red
48"	Pale Yellow Silty Many prominent Yellowish Red Mottles (Fragipan) - Water @ 38" - seeps -

Hook Gauge Reading	Elapsed Time (min)	Measured Drop	Estimated Rate	% Change
7 3/4	10m	1/4" = 4/16	Pre-soak	
7 1/2	10m	1/4" = 4/16		
7 5/16	10m	3/16		
7 1/16	10m	4/16		
6 7/8	10m	3/16		
6 3/4	10m	2/16		
6 1/2	10m	4/16		
6 3/16	10m	3/16		
6 1/16	10m	4/16		
5 13/16	10m	4/16	1" / hr	
4 5/16	20m	1/2"		

(P)

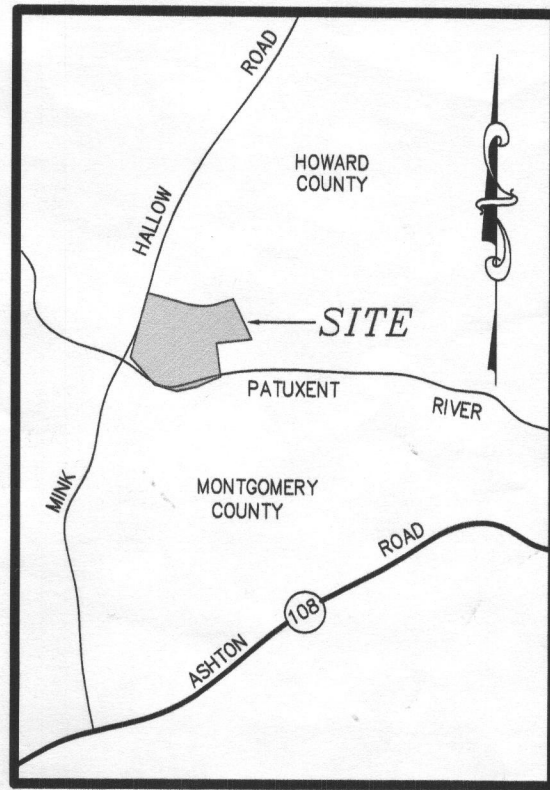
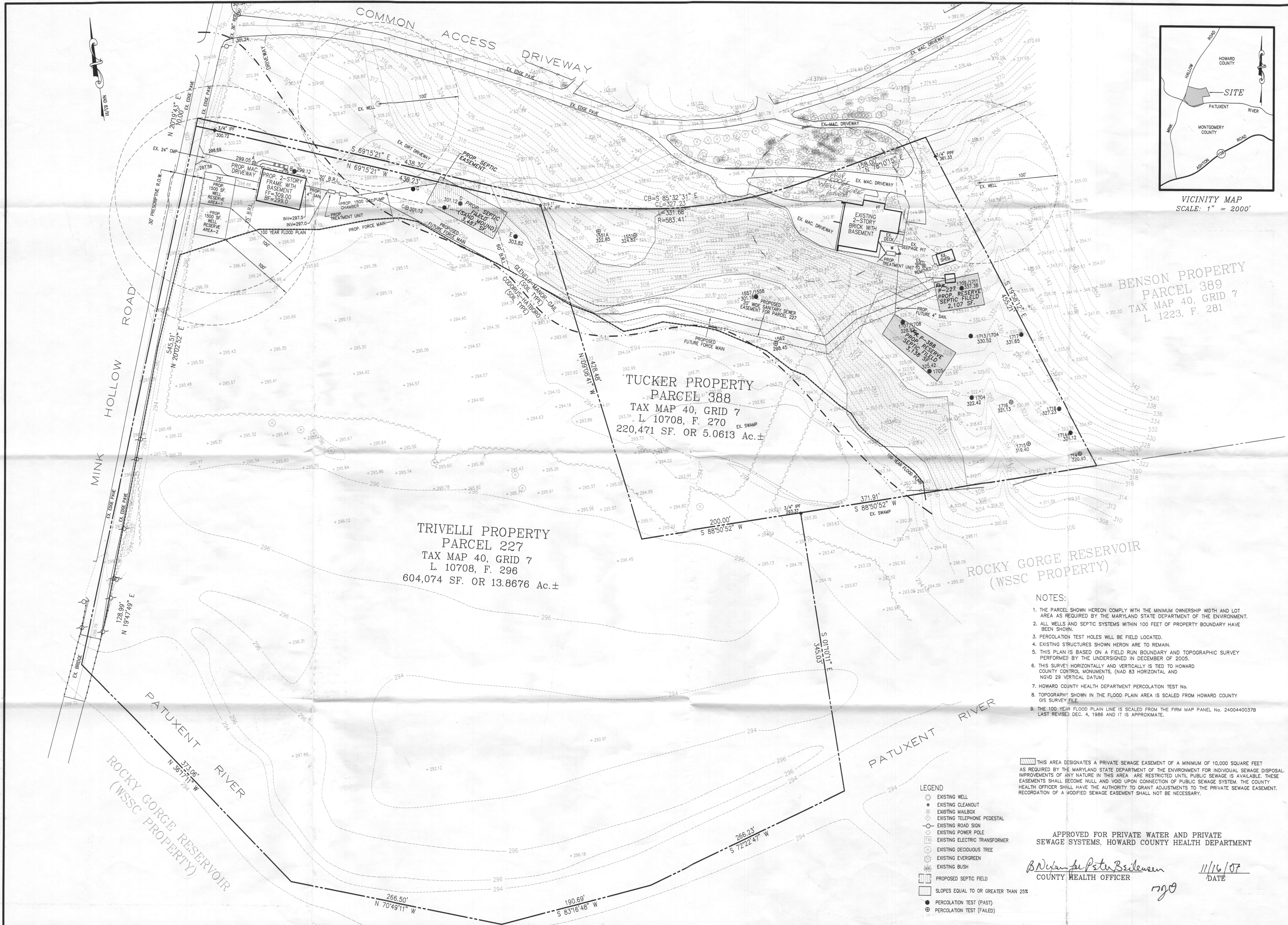

VICINITY MAP  
SCALE: 1" = 2000'

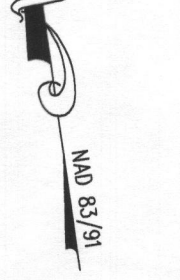

TRIVELLI PROPERTY  
PARCEL 227  
TAX MAP 40, GRID 7  
L. 10708, F. 296  
604,074 SF. OR 13.8676 Ac.±

TUCKER PROPERTY  
PARCEL 388  
TAX MAP 40, GRID 7  
L. 10708, F. 270  
220,471 SF. OR 5.0613 Ac.±

BENSON PROPERTY  
PARCEL 389  
TAX MAP 40, GRID 7  
L. 1223, F. 281

ROCKY GORGE RESERVOIR  
(WSSC PROPERTY)

- LEGEND
- EXISTING WELL
  - EXISTING CLEANOUT
  - ⊕ EXISTING MAILBOX
  - ⊕ EXISTING TELEPHONE PEDESTAL
  - ⊕ EXISTING ROAD SIGN
  - ⊕ EXISTING POWER POLE
  - ⊕ EXISTING ELECTRIC TRANSFORMER
  - ⊕ EXISTING DECIDUOUS TREE
  - ⊕ EXISTING EVERGREEN
  - ⊕ EXISTING BUSH
  - ▭ PROPOSED SEPTIC FIELD
  - ▭ SLOPES EQUAL TO OR GREATER THAN 25%
  - PERCOLATION TEST (PAST)
  - ⊕ PERCOLATION TEST (FAILED)

- NOTES:
1. THE PARCEL SHOWN HEREON COMPLY WITH THE MINIMUM OWNERSHIP WIDTH AND LOT AREA AS REQUIRED BY THE MARYLAND STATE DEPARTMENT OF THE ENVIRONMENT.
  2. ALL WELLS AND SEPTIC SYSTEMS WITHIN 100 FEET OF PROPERTY BOUNDARY HAVE BEEN SHOWN.
  3. PERCOLATION TEST HOLES WILL BE FIELD LOCATED.
  4. EXISTING STRUCTURES SHOWN HEREON ARE TO REMAIN.
  5. THIS PLAN IS BASED ON A FIELD RUN BOUNDARY AND TOPOGRAPHIC SURVEY PERFORMED BY THE UNDERSIGNED IN DECEMBER OF 2005.
  6. THIS SURVEY HORIZONTALLY AND VERTICALLY IS TIED TO HOWARD COUNTY CONTROL MONUMENTS, (NAD 83 HORIZONTAL AND NGVD 29 VERTICAL DATUM).
  7. HOWARD COUNTY HEALTH DEPARTMENT PERCOLATION TEST No.
  8. TOPOGRAPHY SHOWN IN THE FLOOD PLAIN AREA IS SCALED FROM HOWARD COUNTY GIS SURVEY FILE.
  9. THE 100 YEAR FLOOD PLAIN LINE IS SCALED FROM THE FIRM MAP PANEL No. 24004400378 LAST REVISED DEC. 4, 1986 AND IT IS APPROXIMATE.

THIS AREA DESIGNATES A PRIVATE SEWAGE EASEMENT OF A MINIMUM OF 10,000 SQUARE FEET AS REQUIRED BY THE MARYLAND STATE DEPARTMENT OF THE ENVIRONMENT FOR INDIVIDUAL SEWAGE DISPOSAL IMPROVEMENTS OF ANY NATURE IN THIS AREA ARE RESTRICTED UNTIL PUBLIC SEWAGE IS AVAILABLE. THESE EASEMENTS SHALL BECOME NULL AND VOID UPON CONNECTION TO THE PRIVATE SEWAGE EASEMENT. THE COUNTY HEALTH OFFICER SHALL HAVE THE AUTHORITY TO GRANT ADJUSTMENTS TO THE PRIVATE SEWAGE EASEMENT. RECORDATION OF A MODIFIED SEWAGE EASEMENT SHALL NOT BE NECESSARY.

APPROVED FOR PRIVATE WATER AND PRIVATE SEWAGE SYSTEMS, HOWARD COUNTY HEALTH DEPARTMENT

*B. Williams*  
COUNTY HEALTH OFFICER  
DATE: 11/16/07

PERCOLATION CERTIFICATION PLAN  
TRAVELLI PROPERTY  
PARCELS 227  
TAX MAP 40, GRID 7  
LIBER 6203, FOLIO 282  
5TH ASSESSMENT DISTRICT  
HOWARD COUNTY, MARYLAND

PLAN PREPARED BY:  
NJR & ASSOCIATES  
Land Surveying and Planning  
9035-B DORSEY RUN ROAD  
JESSUP, MARYLAND 20794  
TEL: (410)799-9089  
FAX: (410)799-9063

REVISIONS

1.	01/30/07, REVISED AS PER HEALTH DEPT. COMMENTS.
2.	09/04/07, REVISED FOR SAND MOUND SYSTEM.

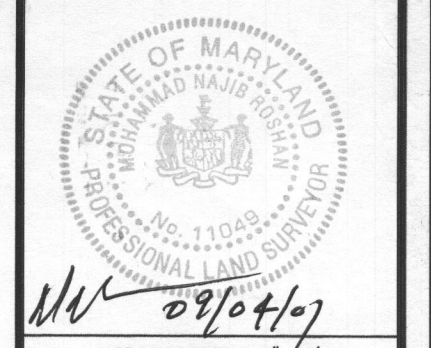

DATE: DEC. 19, 2005  
JOB NUMBER: 2638  
FILE NUMBER: 2638DWG  
PLOTTED: SEP. 04, 2007  
DRAWN BY: NR  
PERCOLATION CERTIFICATION PLAN  
SHEET 1 OF 1

SIGNED  
PC