

APPLICATION

PERCOLATION TESTING

A 516098-S

P _____

HOWARD COUNTY HEALTH DEPARTMENT
BUREAU OF ENVIRONMENTAL HEALTH
3525-H ELLICOTT MILLS DRIVE/ELLICOTT CITY, MARYLAND 21043
TELEPHONE: 313-2640

DISTRICT _____

DATE _____

TO: THE COUNTY HEALTH OFFICER
ELLICOTT CITY, MARYLAND

I HEREBY APPLY FOR THE NECESSARY TEST PRIOR TO APPLICATION FOR PERMIT TO CONSTRUCT (OR RECONSTRUCT) A SEWAGE DISPOSAL SYSTEM.

PROPERTY OWNER SLAGGOS BROTHERS EQUIPMENT

ADDRESS 3258 BETHANY LANE PHONE _____

ELLICOTT CITY, MD 21042

AGENT OR PROSPECTIVE BUYER _____

ADDRESS _____ PHONE _____

PROPERTY LOCATION:

SUBDIVISION SLAGGOS PROPERTY PHASE 2 LOT NO. B7

ROAD AND DESCRIPTION OLD COLUMBIA PIKE ~ 200' NORTH OF
INTERSECTION OF MURPHY ROAD & OLD COLUMBIA PIKE

TAX MAP 46 PARCEL # PO 118

SIZE OF LOT 1 ACRE TYPE BLDG. SFD
(SINGLE FAMILY DWELLING OR COMMERCIAL)

THE SYSTEM INSTALLED UNDER THIS APPLICATION IS ACCEPTABLE ONLY UNTIL PUBLIC FACILITIES BECOME AVAILABLE. I FULLY UNDERSTAND THE FEE CONNECTED WITH THE FILING OF THIS PERC TEST APPLICATION IS NON-REFUNDABLE UNDER ANY CIRCUMSTANCES. I ALSO AGREE TO COMPLY WITH ALL M.O.S.H.A. REQUIREMENTS IN TESTING THIS LOT.

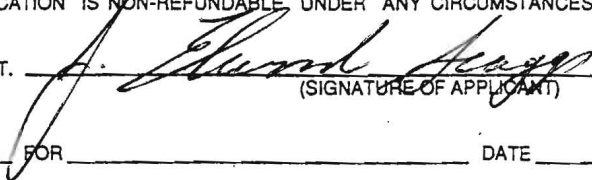
(SIGNATURE OF APPLICANT)

APPROVED BY _____ FOR _____ DATE _____

DISAPPROVED BY _____ FOR _____ DATE _____

HOLD PENDING FURTHER TESTS _____

REASONS FOR REJECTION OR HOLDING _____

PERCOLATION TEST PLAT/PRELIMINARY PLAT - TITLE OR I.D. # _____ DATE _____

SITE DEVELOPMENT PLAN/FINAL PLAT - TITLE OR I.D. # _____ DATE _____

THIS IS NOT A PERMIT

COUNTY #

SOIL PROFILE

0' EA
red brn
lt. brn
heavy lm
to cl lm

4 1/2
tan gray
mica sa
+ sa lm
20-25%
frags
mostly
saprolite
esp @ SW

14-
14 1/2

BE
orgr brn
red cl lm

4 1/2
-5
fine lt.
brn tan
beige pink
samicalm
15-25%
frags

13 1/2
14 1/2

D
brn red
cl lm

3
red brn
yel silm

6
tan brn
samica
lm
20% frags

13
30% black mica
saprolite

14

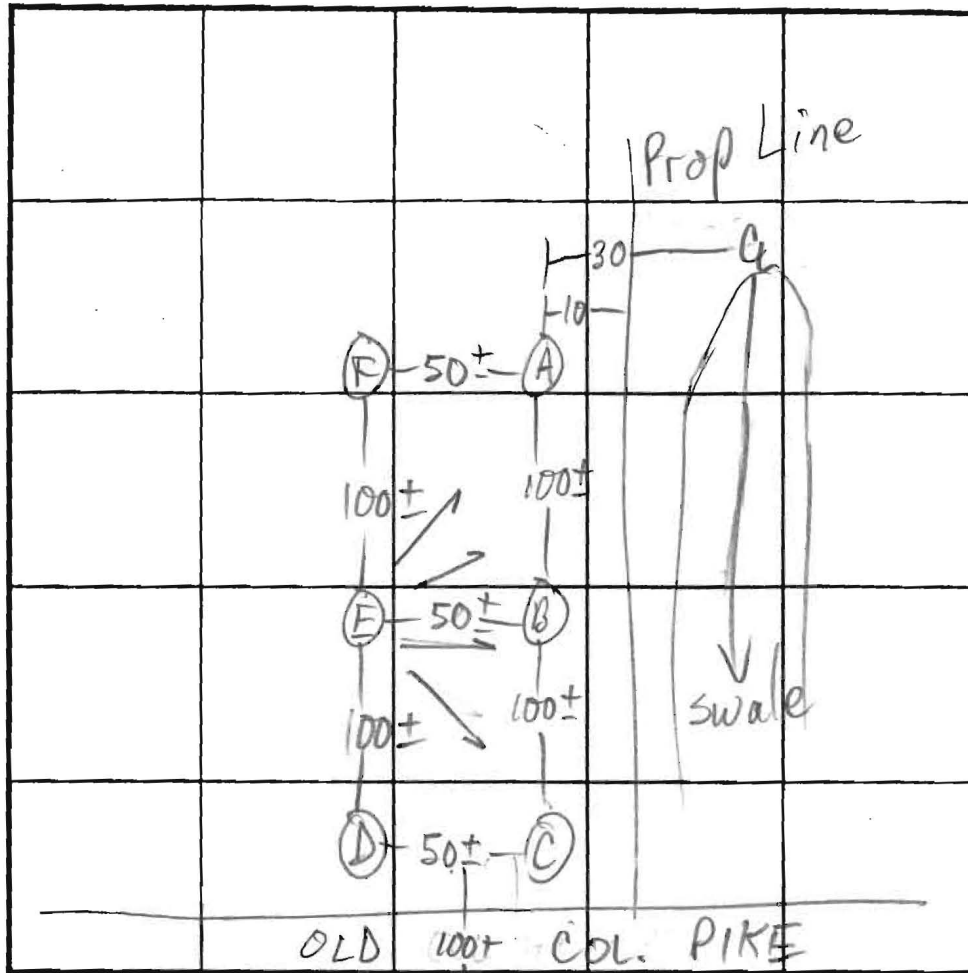

SOIL PROFILE

0' C
brn red
cl lm

3
tan brn
samica
lam
20%
frags

13
14
30% black mica
saprolite

INDICATE NORTH - NAME ADJOINING ROADWAY AS BASE LINE.
• ADJ. WELLS •

DATE	TEST NO.	DEPTH	PRE-WET		TEST - 1" DROP		TIME
			START	STOP	START	STOP	
2/13/02	8A S	2' 9" / 4 1/2"	2:45	VERY SLOW	2:08	3:18	10
	8A V	14 1/2	OK	see profile			
	8B S	1 1/2 REPAIR	3:35:30	3:36:15	3:36:15	3:37:45	1 1/2
			3:38:00	3:39:25	3:39:25	3:41:35	2
	8B V	14 1/2	OK	see profile			
	8C S	2' 9" / 14	3:03	3:05	3:05	3:08	3
			OK	see profile			
	8D S	3 1/2 / 14	2:53	3:02	3:02	3:15	13
			OK	see profile			
	8E V	13 1/2	OK	see profile			
	8F S	5 1/2 REPAIR	2:32:35	2:33:15	2:33:15	2:34:25	10
			2:34:45	2:36:10	2:36:10	2:37:40	130
	8F S	5 1/2 REPAIR	2:38:00	2:40:00	2:40:00	2:42:20	220
			OK	see profile			

REMARKS ALL HOLES PER PLAN

TYPE OF SOIL _____

TESTED BY M. Ritkin ALSO PRESENT Wade S., Andy

TRENCH DESIGN DATA: AVERAGE PERCOLATION TIME _____ TRENCH WIDTH _____

INLET DEPTH _____ MAXIMUM BOTTOM DEPTH _____ SQ. FT./BEDROOM _____

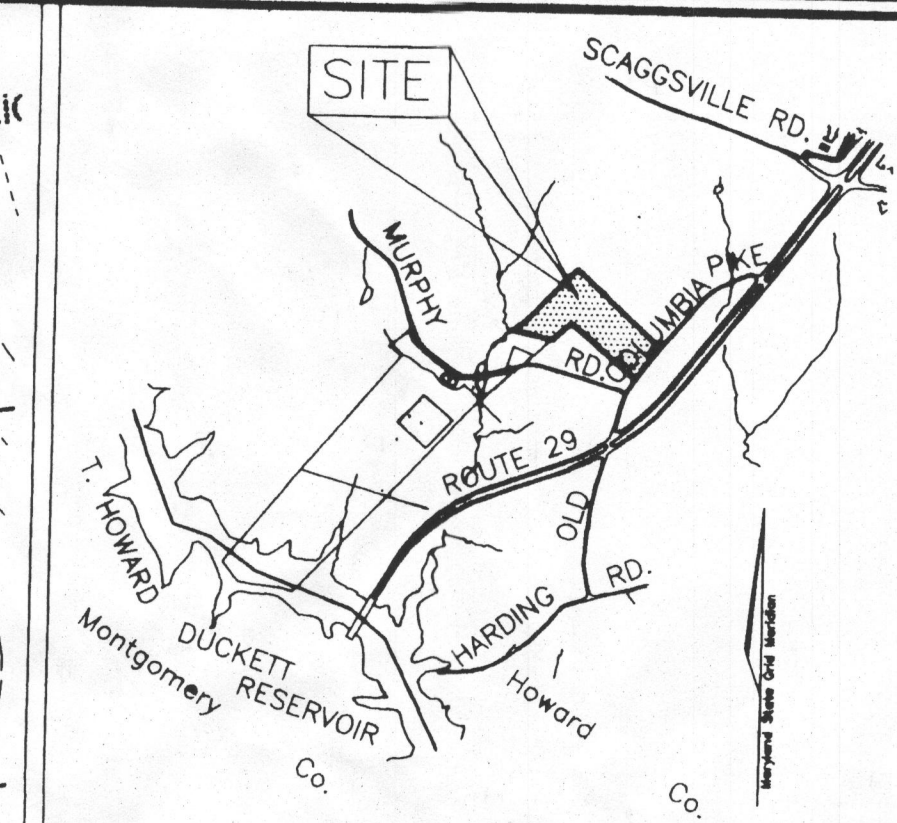
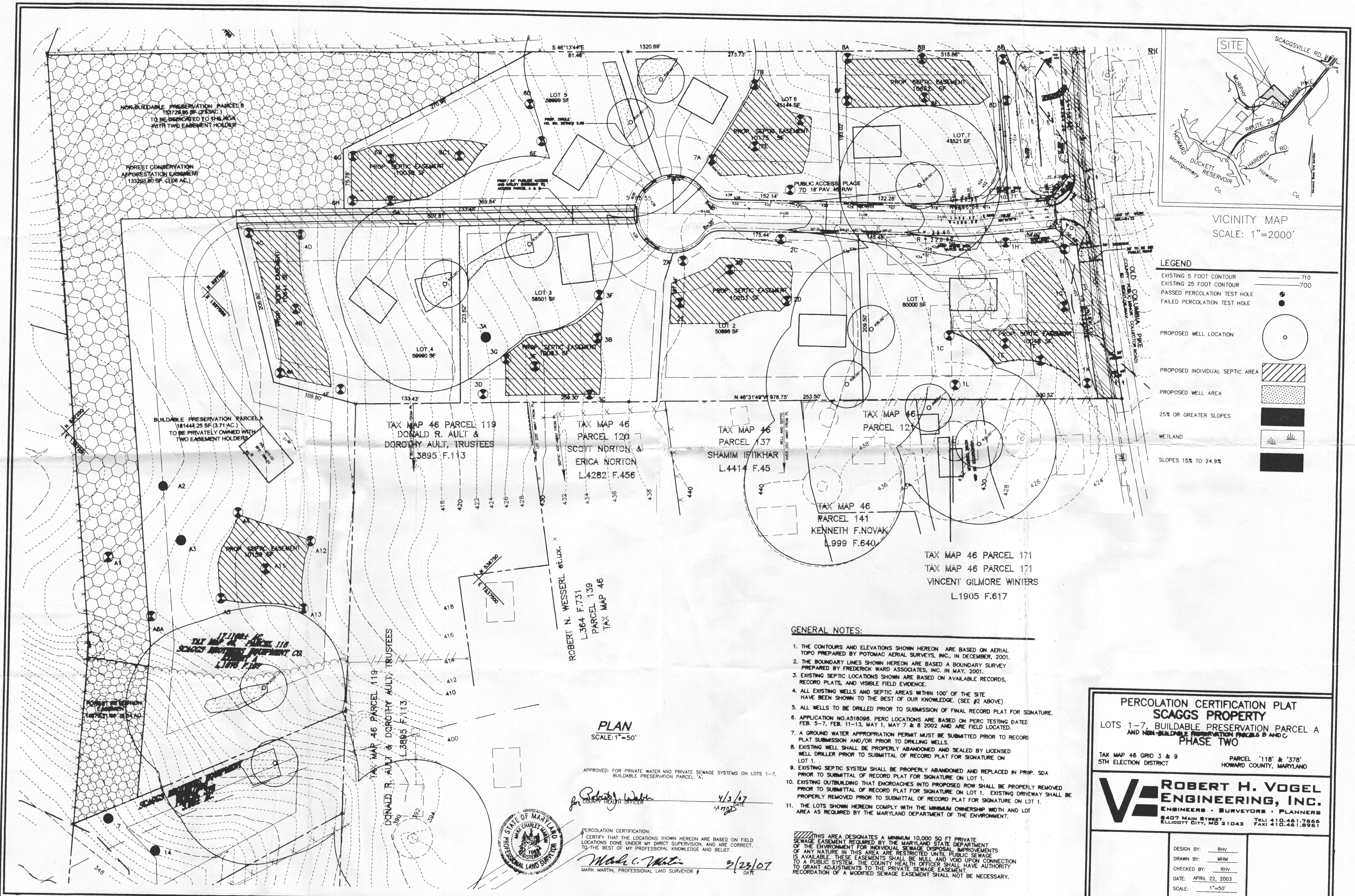

VICINITY MAP
SCALE: 1"=2000'

LEGEND

EXISTING 5 FOOT CONTOUR	---	710
EXISTING 25 FOOT CONTOUR	---	700
PASSED PERCOLATION TEST HOLE	○	
FAILED PERCOLATION TEST HOLE	●	
PROPOSED WELL LOCATION	○	
PROPOSED INDIVIDUAL SEPTIC AREA	▨	
PROPOSED WELL AREA	▨	
25% OR GREATER SLOPES	■	
WETLAND	▨	
SLOPES 15% TO 24.9%	■	

- GENERAL NOTES:**
1. THE CONTOURS AND ELEVATIONS SHOWN HEREON ARE BASED ON AERIAL TOPO PREPARED BY POTOMAC AERIAL SURVEYS, INC., IN DECEMBER, 2001.
 2. THE BOUNDARY LINES SHOWN HEREON ARE BASED A BOUNDARY SURVEY PREPARED BY FREDERICK WARD ASSOCIATES, INC. IN MAY, 2001.
 3. EXISTING SEPTIC LOCATIONS SHOWN ARE BASED ON AVAILABLE RECORDS, RECORD PLATS, AND VISIBLE FIELD EVIDENCE.
 4. ALL EXISTING WELLS AND SEPTIC AREAS WITHIN 100' OF THE SITE HAVE BEEN SHOWN TO THE BEST OF OUR KNOWLEDGE. (SEE #2 ABOVE)
 5. ALL WELLS TO BE DRILLED PRIOR TO SUBMISSION OF FINAL RECORD PLAT FOR SIGNATURE.
 6. APPLICATION NO.A518098. PERC LOCATIONS ARE BASED ON PERC TESTING DATED FEB. 5-7, FEB. 11-13, MAY 1, MAY 7 & 8 2002 AND ARE FIELD LOCATED.
 7. A GROUND WATER APPROPRIATION PERMIT MUST BE SUBMITTED PRIOR TO RECORD PLAT SUBMISSION AND/OR PRIOR TO DRILLING WELLS.
 8. EXISTING WELL SHALL BE PROPERLY ABANDONED AND SEALED BY LICENSED WELL DRILLER PRIOR TO SUBMITTAL OF RECORD PLAT FOR SIGNATURE ON LOT 1.
 9. EXISTING SEPTIC SYSTEM SHALL BE PROPERLY ABANDONED AND REPLACED IN PROP. SDA PRIOR TO SUBMITTAL OF RECORD PLAT FOR SIGNATURE ON LOT 1.
 10. EXISTING OUTBUILDING THAT ENROACHES INTO PROPOSED ROW SHALL BE PROPERLY REMOVED PRIOR TO SUBMITTAL OF RECORD PLAT FOR SIGNATURE ON LOT 1. EXISTING DRIVEWAY SHALL BE PROPERLY REMOVED PRIOR TO SUBMITTAL OF RECORD PLAT FOR SIGNATURE ON LOT 1.
 11. THE LOTS SHOWN HEREON COMPLY WITH THE MINIMUM OWNERSHIP WIDTH AND LOT AREA AS REQUIRED BY THE MARYLAND DEPARTMENT OF THE ENVIRONMENT.

PLAN
SCALE: 1"=50'

APPROVED: FOR PRIVATE WATER AND PRIVATE SEWAGE SYSTEMS ON LOTS 1-7, BUILDABLE PRESERVATION PARCEL 'A'.
Robert H. Vogel
COUNTY HEALTH OFFICER
4/3/07
DATE



PERCOLATION CERTIFICATION:
I CERTIFY THAT THE LOCATIONS SHOWN HEREON ARE BASED ON FIELD LOCATIONS DONE UNDER MY DIRECT SUPERVISION, AND ARE CORRECT, TO THE BEST OF MY PROFESSIONAL KNOWLEDGE AND BELIEF.
Mark C. Martin
MARK MARTIN, PROFESSIONAL LAND SURVEYOR # 31702
DATE 3/23/07

THIS AREA DESIGNATES A MINIMUM 10,000 SQ FT PRIVATE SEWAGE EASEMENT REQUIRED BY THE MARYLAND STATE DEPARTMENT OF THE ENVIRONMENT FOR INDIVIDUAL SEWAGE DISPOSAL IMPROVEMENTS OF ANY NATURE IN THIS AREA ARE RESTRICTED UNTIL PUBLIC SEWAGE IS AVAILABLE. THESE EASEMENTS SHALL BE NULL AND VOID UPON CONNECTION TO A PUBLIC SYSTEM. THE COUNTY HEALTH OFFICER SHALL HAVE AUTHORITY TO GRANT ADJUSTMENTS TO THE PRIVATE SEWAGE EASEMENT. RECORDATION OF A MODIFIED SEWAGE EASEMENT SHALL NOT BE NECESSARY.

PERCOLATION CERTIFICATION PLAT
SCAGGS PROPERTY
LOTS 1-7, BUILDABLE PRESERVATION PARCEL A AND NON-BUILDABLE PRESERVATION PARCELS B AND C
PHASE TWO

TAX MAP 46 GRID 3 & 9
5TH ELECTION DISTRICT

PARCEL '118' & '378'
HOWARD COUNTY, MARYLAND

ROBERT H. VOGEL ENGINEERING, INC.
ENGINEERS • SURVEYORS • PLANNERS
8407 MAIN STREET
ELLIOTT CITY, MD 21043
TEL: 410-461-7666
FAX: 410-461-8961

DESIGN BY:	RHV
DRAWN BY:	MHM
CHECKED BY:	RHV
DATE:	APRIL 22, 2003
SCALE:	1"=50'
W.O. NO.:	2014031.00

1 SHEET OF 1