

EMERGENCY/TEMP NO. IF ANY

|     |              |                                |   |   |
|-----|--------------|--------------------------------|---|---|
| B 1 | <b>12114</b> | SEQUENCE NO.<br>(MDE USE ONLY) | STATE OF MARYLAND<br><b>APPLICATION FOR PERMIT TO DRILL WELL</b><br>please type | STATE PERMIT NUMBER<br><b>HO-95-2575</b><br><small>fill in this form completely</small> |
|-----|--------------|--------------------------------|---|---|

**OWNER INFORMATION**

Date Received (APA) \_\_\_\_\_

8 MM DD YY 13

15 Last Name Flowers Owner William First Name William 34

36 Street or RFD 11643 Masters Run 55

57 Town Ellicott City Md State Md Zip 21042 76

**LOCATION OF WELL**

B 3

8 COUNTY Howard 21

23 SUBDIVISION The Chase 42

SECTION 44 46 LOT 48 50

52 NEAREST TOWN Clarksville 71

**DRILLER INFORMATION**

Driller's Name Joseph L Mayne License No. MSD024 81

Firm Name Joseph L Mayne Well Drilling

Address 5512 Ridge Rd Mt. Airy Md 21771

Signature Joseph L Mayne Date 8-8-2013

**SOURCES OF DRILLING WATER**

B 4

11 well 30

11643 Masters Run

ON WHICH SIDE OF ROAD (CIRCLE APPROPRIATE BOX)

34 W 37 SOUTH

DISTANCE FROM ROAD 110 FT

ENTER FT OR MI 38 39

TAX MAP: 29 BLK: 2 PARCEL 24

**WELL INFORMATION**

B 2

APPROX. PUMPING RATE 4 GAL. PER MIN. 8 12

AVERAGE DAILY QUANTITY NEEDED 500 GAL. PER DAY 14 20

**USE FOR WATER (CIRCLE APPROPRIATE BOX)**

DOMESTIC POTABLE SUPPLY & RESIDENTIAL IRRIGATION

FARMING (LIVESTOCK WATERING & AGRICULTURAL IRRIGATION)

INDUSTRIAL, COMMERCIAL, DEWATERING

PUBLIC WATER SUPPLY WELL

TEST, OBSERVATION, MONITORING

OPEN LOOP GEOTHERMAL

CLOSED LOOP GEOTHERMAL

**NOT TO BE FILLED IN BY DRILLER HEALTH DEPARTMENT APPROVAL**

COUNTY NAME Howard COUNTY NO. (15) A36992

STATE SIGNATURE \_\_\_\_\_ INSERT S →

DATE ISSUED 8/9/13 CO SIGNATURE Phirre Wad EXP. DATE 8/9/14

43 MM DD YY 48

Cancelled 2/15/14

APPROXIMATE DEPTH OF WELL 300 FEET 24 28

APPROXIMATE DIAMETER OF WELL 6 INCH NEAREST

PROPOSED LOCATION OF WELL ON LOT  
SHOW PERMANENT STRUCTURES SUCH AS BUILDINGS, SEPTIC SYSTEM, ROADS AND/OR LANDMARKS AND INDICATE NOT LESS THAN TWO DISTANCE MEASUREMENTS TO WELL

**METHOD OF DRILLING (circle one)**

BORED (or Augered) JETTED Jetted & DRIVEN

30 AIR-ROTARY AIR-PERCussion ROTARY (Hydraulic Rotary)

37 CABLE REVerse-ROTary DRive-POINT

other \_\_\_\_\_

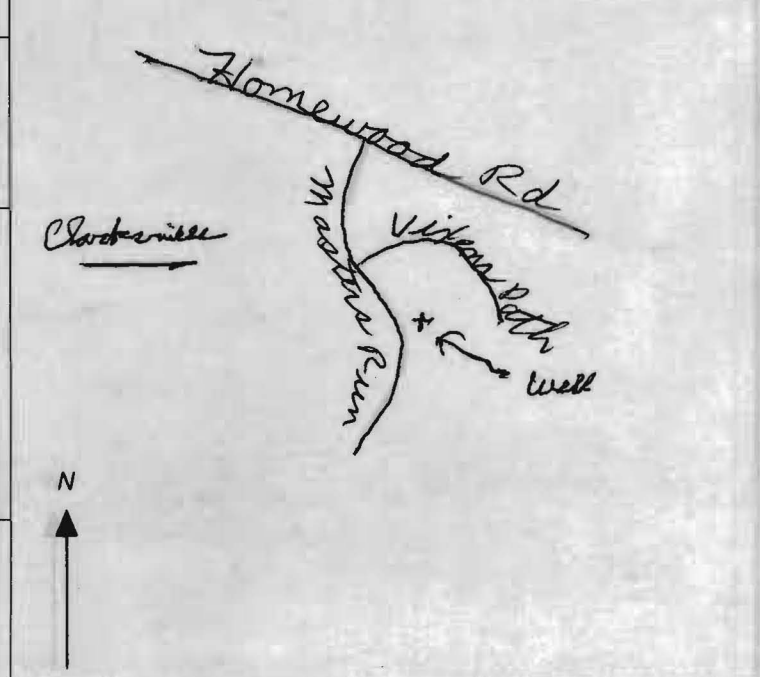

**REPLACEMENT OR DEEPEINED WELLS (CIRCLE APPROPRIATE BOX)**

THIS WELL WILL NOT REPLACE AN EXISTING WELL

THIS WELL WILL REPLACE A WELL THAT WILL BE ABANDONED AND SEALED

39  THIS WELL WILL REPLACE A WELL THAT WILL BE USED AS A STANDBY-CONTACT LOCAL APPROVING AUTHORITY FOR POLICY ON STANDBY WELLS

THIS WELL WILL DEEPEIN AN EXISTING WELL

PERMIT NUMBER OF WELL TO BE REPLACED OR DEEPEINED (IF AVAILABLE) 41 \_\_\_\_\_ 52

**Not to be filled in by driller (MDE OR COUNTY USE ONLY)**

APPROP. PERMIT NUMBER \_\_\_\_\_ G \_\_\_\_\_

PERMIT No. HO-95-2575

70 71 72 73 74 75 76 77 78 79

SPECIAL CONDITIONS For well to be sealed - COM 48 26 04 04 07

11643 masters run



SITE INSPECTION SHEET

OWNER: Flowers PHONE #: \_\_\_\_\_  
ADDRESS: 11643 Masters Run CONTRACTOR: J. Mayne  
WELL TAG #: \_\_\_\_\_  
SUBDIVISION: Chase LOT: 6 COUNTY #: 13  
PROPOSAL: out of H<sub>2</sub>O

LOCATION DIAGRAM

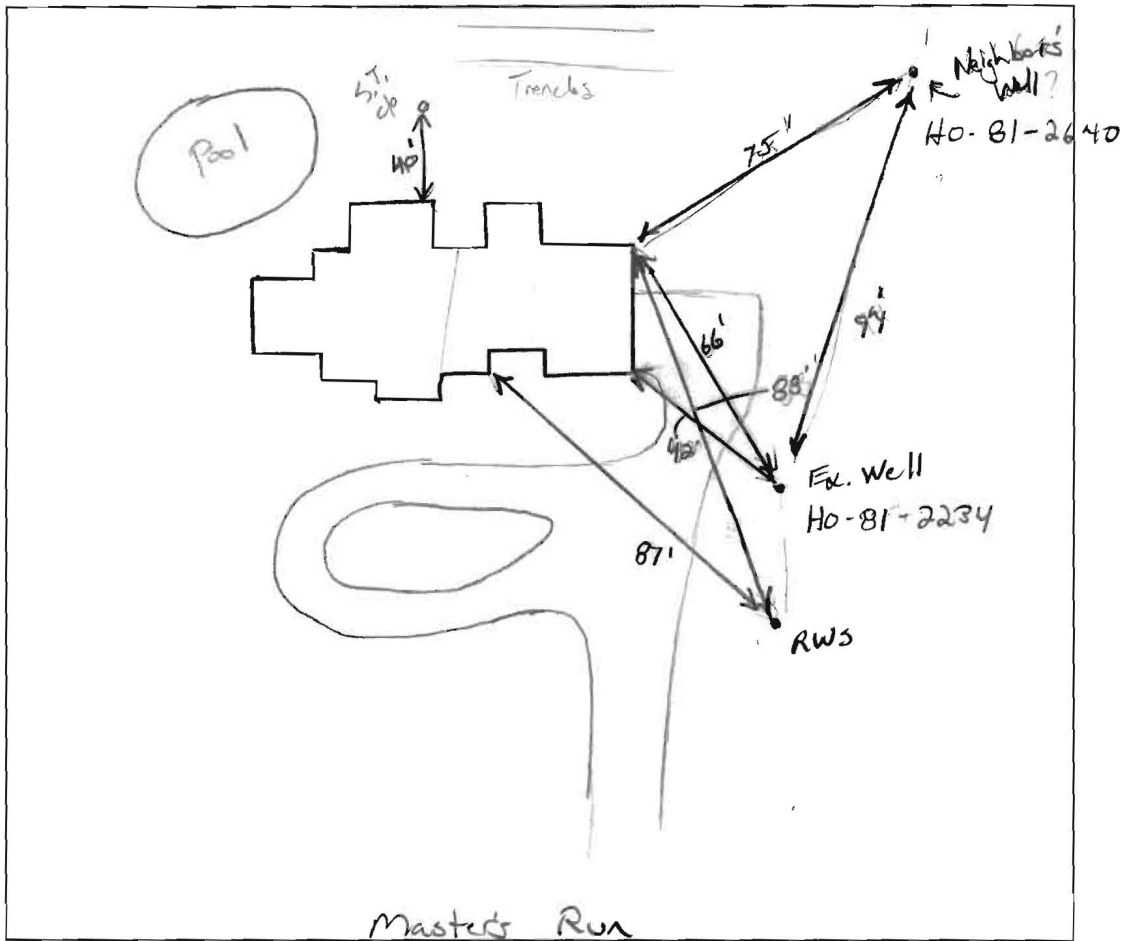

COMMENTS: 8/8/13 Rep. well location selected as shown above.  
Ex. well completely dry, Well/Property inside radium area.

DATE: 8/8/13 INSPECTOR: R. Volk