

B 1 6077 SEQUENCE NO. (MDE USE ONLY)

STATE OF MARYLAND APPLICATION FOR PERMIT TO DRILL WELL please type

STATE PERMIT NUMBER H0-95-0593 fill in this form completely

Date Received (APA) 12/13/2006 OWNER INFORMATION Gill, Stephen 7166 Mink Hollow RD Highland Md

B 3 LOCATION OF WELL Howard 8 COUNTY 21 23 SUBDIVISION 42 SECTION 44 46 LOT 48 50 Highland 52 NEAREST TOWN 71 MILES FROM TOWN (enter 0 if in town) 5 M I I 73 76 77 78

DRILLER INFORMATION Allen Compton MS D 009 Driller's Name 76 License No. 81 Fogles Well Drilling Firm Name 580 Obrecht RD Address Signature Date 12-13-06

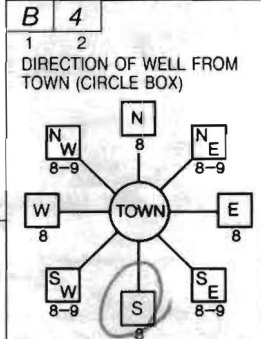

B 4 7166 Mink Hollow Rd 11 NEAR WHAT ROAD 30 ON WHICH SIDE OF ROAD (CIRCLE APPROPRIATE BOX) NORTH N WEST W EAST E SOUTH S 34 800 37 DISTANCE FROM ROAD ENTER FT OR MI 38 39 TAX MAP: 40 BLK: 1 PARCEL 10

B 2 WELL INFORMATION APPROX. PUMPING RATE 5 (GAL. PER MIN.) 8 12 AVERAGE DAILY QUANTITY NEEDED 500 (GAL. PER DAY) 14 20

NOT TO BE FILLED IN BY DRILLER HEALTH DEPARTMENT APPROVAL Howard 13 A13958 COUNTY NAME COUNTY NO. STATE SIGNATURE INSERT S 41 DATE ISSUED 12/13/2006 Brian Baker 12/13/2007 CO SIGNATURE EXP. DATE NORTH GRID 489 0 0 50 55 EAST GRID 802 0 0 57 63

USE FOR WATER (CIRCLE APPROPRIATE BOX) D DOMESTIC POTABLE SUPPLY & RESIDENTIAL IRRIGATION F FARMING (LIVESTOCK WATERING & AGRICULTURAL IRRIGATION) I INDUSTRIAL, COMMERCIAL, DEWATERING P PUBLIC WATER SUPPLY WELL T TEST, OBSERVATION, MONITORING G GEO-THERMAL

APPROXIMATE DEPTH OF WELL 300 FEET APPROXIMATE DIAMETER OF WELL 6 INCH NEAREST

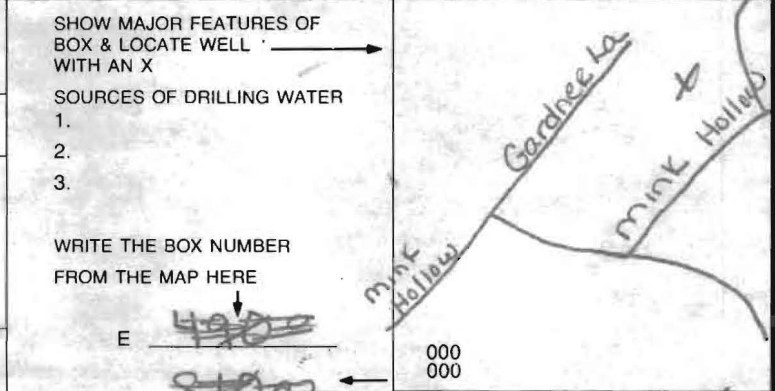

METHOD OF DRILLING (circle one) BORED (or Augered) JETTED Jetted & DRIVEN AIR-ROtary AIR-PERcussion ROTARY (Hydraulic Rotary) CABLE REVerse-ROtary DRive-POINT other

REPLACEMENT OR DEEPEMED WELLS (CIRCLE APPROPRIATE BOX) N THIS WELL WILL NOT REPLACE AN EXISTING WELL Y THIS WELL WILL REPLACE A WELL THAT WILL BE ABANDONED AND SEALED S THIS WELL WILL REPLACE A WELL THAT WILL BE USED AS A STANDBY-CONTACT LOCAL APPROVING AUTHORITY FOR POLICY ON STANDBY WELLS D THIS WELL WILL DEEPEN AN EXISTING WELL PERMIT NUMBER OF WELL TO BE REPLACED OR DEEPEMED (IF AVAILABLE) 41 52

Not to be filled in by driller (MDE OR COUNTY USE ONLY) APPROX. PERMIT NUMBER G PERMIT No. H0-95-0593

SPECIAL CONDITIONS NOTE - APPROVING AUTHORITIES SHOULD USE SEPARATE SHEET IF NEEDED

SITE INSPECTION SHEET

OWNER: Stephen and Carmen Gill PHONE #: \_\_\_\_\_  
ADDRESS: 7166 Mink Hollow Road CONTRACTOR: Fogles/Compton  
WELL TAG #: \_\_\_\_\_  
SUBDIVISION: \_\_\_\_\_ LOT: \_\_\_\_\_ COUNTY #: \_\_\_\_\_  
PROPOSAL: Well Currently Has Insufficient Yield - Want to Drill Replacement

LOCATION DIAGRAM

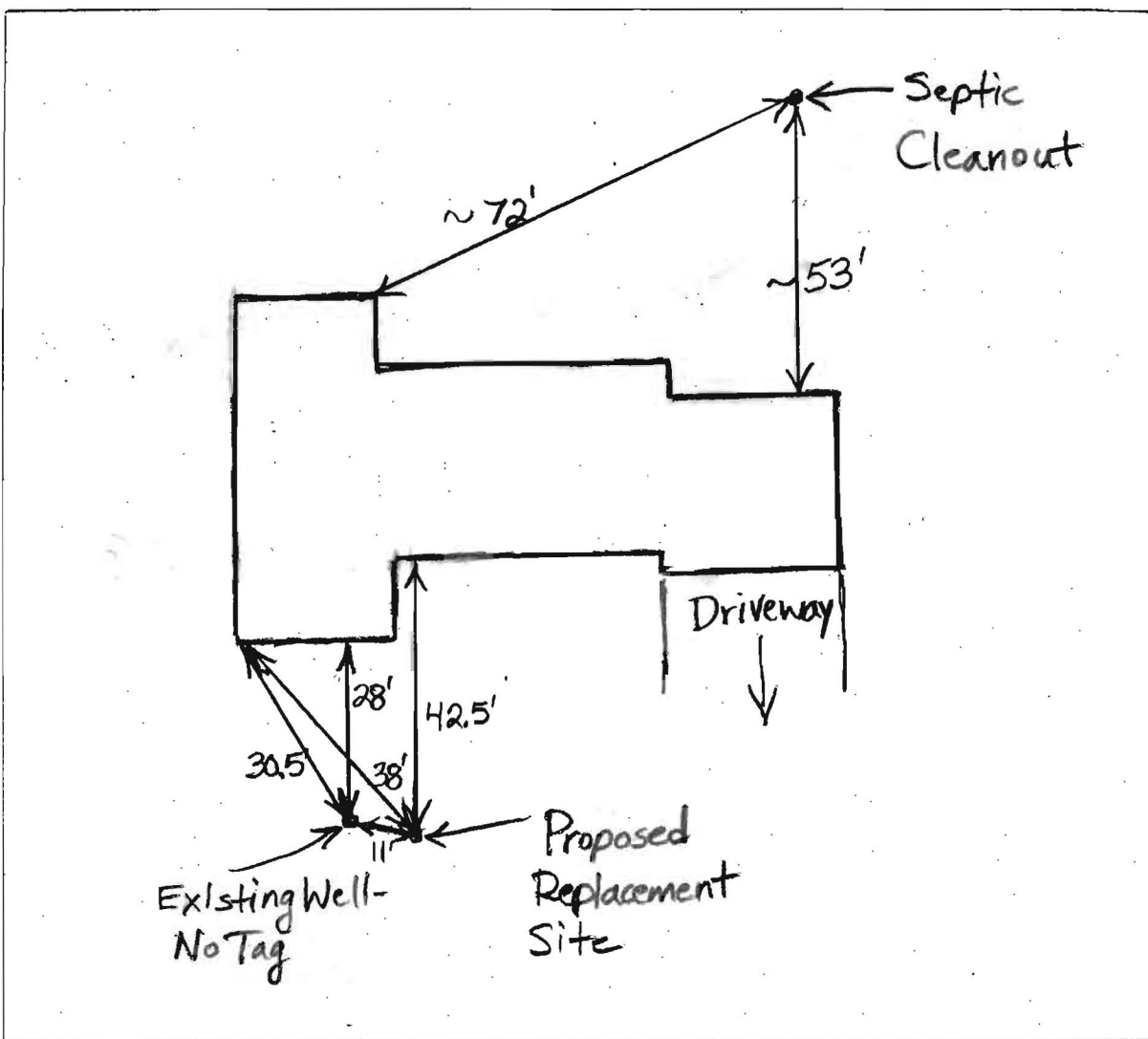

COMMENTS: Seal Old Well

DATE: 12/13/06

INSPECTOR: Brian Baker