

5/16/73  
after noon

05-365392

File  
Fund 18267  
A ~~16286~~  
38077

# PERMIT

SEWAGE DISPOSAL SYSTEM

MARYLAND STATE DEPARTMENT OF HEALTH

HOWARD COUNTY

ELLICOTT CITY

DISTRICT 5th

## INDEXED

DATE 4/16/73

Edwards Construction Company IS PERMITTED TO INSTALL  ALTER

ADDRESS 13921 Wayside Drive, Clarksville, Md. 21029 PHONE 286-3825

A SEWAGE DISPOSAL SYSTEM LOCATED AT

SUBDIVISION 7249 ROAD Mink Hollow Road LOT 854-0366

PROPERTY OWNER Mr. Rene Ryckebusch Highland, Md. 20777 TAX MAP 40

ADDRESS 6721 Montell Court, Highland, Md. Pmc. 309

SPECIFICATIONS 3 bedrooms

DRAIN FIELD \_\_\_\_\_ DEPTH \_\_\_\_\_ FEET, BOTTOM AREA \_\_\_\_\_ SQ. FT.

SEEPAGE PITS \_\_\_\_\_ ABSORBENT SIDE-WALL AREA \_\_\_\_\_ SQ. FT.

SEPTIC TANK CAPACITY 1000 GALLONS

5/16/73 advise

FOR GARBAGE GRINDER, INCREASE DISPOSAL AREA 22% & TANK CAPACITY 50%.

OTHER DRY WELL - 108 sq. ft. per bedroom. Inlet to be 3 1/2 ft. and maximum depth 12 ft. unless water encountered. Locate dry well about 380 ft. from edge of road and 60 ft. from the edge of Cox right of way side line as seen when standing on Mink Hollow Road.

NOTE: ALL PIPE FROM HOUSE TO DRY WELL MUST BE CAST IRON. all cast iron  
PERMIT VOID AFTER THREE YEARS.

NOTE: INSTALL STAND PIPE ON SEPTIC TANK AND DRY WELL.

PLANS APPROVED BY Fred Frommelt DATE 4/9/73

FILL SEPTIC TANK AND DISTRIBUTION BOX WITH WATER BEFORE CALLING FOR AN INSPECTION. COVER NO WORK UNTIL INSPECTED AND APPROVED.

NEITHER THE HOWARD COUNTY COMMISSIONERS NOR THE HEALTH DEPARTMENT IS RESPONSIBLE FOR THE SUCCESSFUL OPERATION OF ANY SYSTEM.

38077  
A 16286

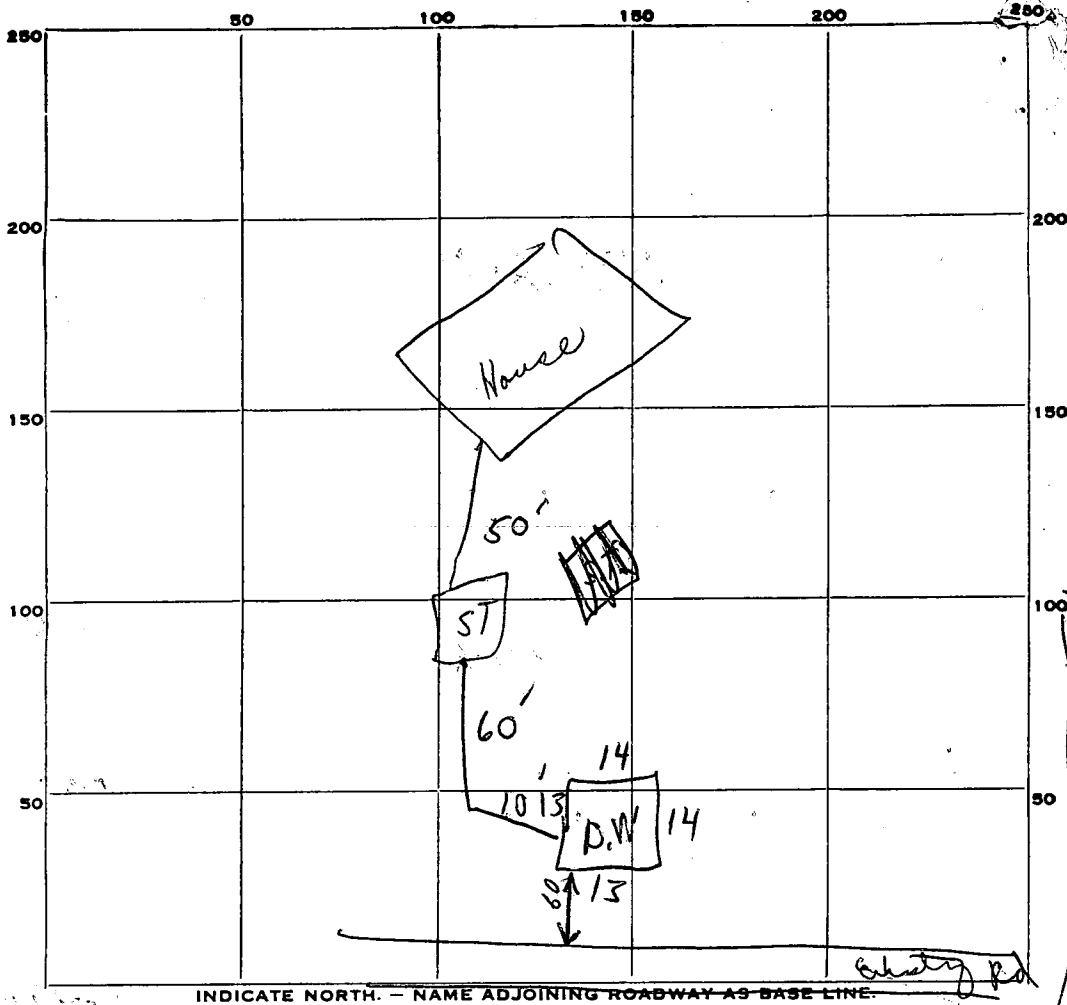

INDICATE NORTH. - NAME ADJOINING ROADWAY AS BASE LINE.

PERMIT CARD Partial signed Cap needed on S.T. P.W. OK

SEPTIC TANK, LEVEL OK CLEANOUTS OK

DISTRIBUTION BOX, LEVEL \_\_\_\_\_

TILE FIELD, DEPTH \_\_\_\_\_ FT. TRENCH WIDTH \_\_\_\_\_ FT.

GRAVEL DEPTH \_\_\_\_\_ IN. TOTAL LENGTH \_\_\_\_\_ FT.

NUMBER OF TRENCHES \_\_\_\_\_ TOTAL BOTTOM AREA \_\_\_\_\_

SEEPAGE PITS, INSIDE DIAMETER outside permits 54 FT. DEPTH BELOW INLET 9' FT.

ABSORBENT AREA 486 SQ. FT.

REMARKS 5/16/73 Inspection - more gravel needed around drywell top + cement plug needed on Septic Tank.  
Cap on + gravel in D. Well Final

DATE SYSTEM APPROVED 5/16/73 INSPECTOR C. Stecker