



# Building Permit Application

Howard County Maryland  
Department of Inspections, Licenses and Permits  
3430 Court House Drive  
Permits: 410-313-2455  
www.howardcountymd.gov

Date Received: \_\_\_\_\_

Permit No.: \_\_\_\_\_

Building Address: 12188 MOUNT ALBERT RD  
 City: ELLCOTT CITY State: MD Zip Code: 21042  
 Suite/Apt. # \_\_\_\_\_ SDP/WP/BA #: \_\_\_\_\_  
 Census Tract: \_\_\_\_\_ Subdivision: \_\_\_\_\_  
 Section: \_\_\_\_\_ Area: \_\_\_\_\_ Lot: \_\_\_\_\_  
 Tax Map: \_\_\_\_\_ Parcel: \_\_\_\_\_ Grid: \_\_\_\_\_  
 Zoning: \_\_\_\_\_ Map Coordinates: \_\_\_\_\_ Lot Size: \_\_\_\_\_

Existing Use: SFD  
 Proposed Use: SFD W/NEW WALLS IN BASEMENT

Estimated Construction Cost: \$500  
 Description of Work: BUILD NEW WALLS IN BASEMENT PER PLAN  
MEDIA/FAMILY BAR RM  
BATH REMODEL

Occupant or Tenant: \_\_\_\_\_  
 Was tenant space previously occupied?  Yes  No  
 Contact Name: \_\_\_\_\_  
 Address: \_\_\_\_\_  
 City: \_\_\_\_\_ State: \_\_\_\_\_ Zip Code: \_\_\_\_\_  
 Phone: \_\_\_\_\_ Fax: \_\_\_\_\_  
 Email: \_\_\_\_\_

Property Owner's Name: MR. STEVE PENIX  
 Address: 12188 MOUNT ALBERT RD  
 City: ELLCOTT CITY State: MD Zip Code: 21042  
 Phone: 443-535-8684 Fax: \_\_\_\_\_  
 Email: \_\_\_\_\_

**Applicant's Name & Mailing Address, (if other than stated herein)**  
 Applicant's Name: \_\_\_\_\_  
 Address: \_\_\_\_\_  
 City: \_\_\_\_\_ State: \_\_\_\_\_ Zip Code: \_\_\_\_\_  
 Phone: \_\_\_\_\_ Fax: \_\_\_\_\_  
 Email: \_\_\_\_\_

Contractor Company: PROBUILT CONSTRUCTION, INC.  
 Contact Person: EDWARD PACYLOWSKI  
 Address: 13330 CLARKSVILLE PIKE  
 City: HIGHLAND State: MD Zip Code: 20777  
 License No.: MHIC20247  
 Phone: 301-854-0821 Fax: \_\_\_\_\_  
 Email: CHRISTINA@PROBUILTCONSTRUCTION.COM

Engineer/Architect Company: \_\_\_\_\_  
 Responsible Design Prof.: \_\_\_\_\_  
 Address: \_\_\_\_\_  
 City: \_\_\_\_\_ State: \_\_\_\_\_ Zip Code: \_\_\_\_\_  
 Phone: \_\_\_\_\_ Fax: \_\_\_\_\_  
 Email: \_\_\_\_\_

Commercial Building Characteristics	Residential Building Characteristics	
Height:	<input checked="" type="checkbox"/> SF Dwelling <input type="checkbox"/> SF Townhouse	
No. of stories:	<b>Depth</b>	<b>Width</b>
Gross area, sq. ft./floor:	1 <sup>st</sup> floor:	
	2 <sup>nd</sup> floor:	
Area of construction (sq. ft.):	Basement:	
	<input type="checkbox"/> Finished Basement	
Use group:	<input type="checkbox"/> Unfinished Basement	
	<input type="checkbox"/> Crawl Space	
<b>Construction type:</b>	<input type="checkbox"/> Slab on Grade	
<input type="checkbox"/> Reinforced Concrete	No. of Bedrooms:	
<input type="checkbox"/> Structural Steel	<b>Multi-family Dwelling</b>	
<input type="checkbox"/> Masonry	No. of efficiency units:	
<input type="checkbox"/> Wood Frame	No. of 1 BR units:	
<input type="checkbox"/> State Certified Modular	No. of 2 BR units:	
	No. of 3 BR units:	
	Other Structure:	
	Dimensions:	
<b>➤ Roadside Tree Project Permit</b>	Footings:	
<input type="checkbox"/> Yes <input checked="" type="checkbox"/> No	Roof:	
<b>Roadside Tree Project Permit #</b>	<input type="checkbox"/> State Certified Modular	
	<input type="checkbox"/> Manufactured Home	

Utilities	
<b>Water Supply</b>	
<input type="checkbox"/> Public	
<input checked="" type="checkbox"/> Private	
<b>Sewage Disposal</b>	
<input type="checkbox"/> Public	
<input checked="" type="checkbox"/> Private	
Electric: <input type="checkbox"/> Yes <input type="checkbox"/> No	
Gas: <input type="checkbox"/> Yes <input checked="" type="checkbox"/> No	
<b>Heating System</b>	
<input type="checkbox"/> Electric <input type="checkbox"/> Oil	
<input type="checkbox"/> Natural Gas <input checked="" type="checkbox"/> Propane Gas	
<input type="checkbox"/> Other:	
<b>Sprinkler System:</b>	
<input type="checkbox"/> Yes <input checked="" type="checkbox"/> No	
<b>Grading Permit Number:</b>	
<b>Building Shell Permit Number:</b>	

THE UNDERSIGNED HEREBY CERTIFIES AND AGREES AS FOLLOWS: (1) THAT HE/SHE IS AUTHORIZED TO MAKE THIS APPLICATION; (2) THAT THE INFORMATION IS CORRECT; (3) THAT HE/SHE WILL COMPLY WITH ALL REGULATIONS OF HOWARD COUNTY WHICH ARE APPLICABLE THERETO; (4) THAT HE/SHE WILL PERFORM NO WORK ON THE ABOVE REFERENCED PROPERTY NOT SPECIFICALLY DESCRIBED IN THIS APPLICATION; (5) THAT HE/SHE GRANTS COUNTY OFFICIALS THE RIGHT TO ENTER ONTO THIS PROPERTY FOR THE PURPOSE OF INSPECTING THE WORK PERMITTED AND POSTING NOTICES.

Applicant's Signature \_\_\_\_\_

Print Name \_\_\_\_\_

Email Address \_\_\_\_\_

Date \_\_\_\_\_

Title/Company \_\_\_\_\_

Checks Payable to: DIRECTOR OF FINANCE OF HOWARD COUNTY  
 \*\*PLEASE WRITE NEATLY & LEGIBLY\*\*  
 -FOR OFFICE USE ONLY-

AGENCY	DATE	SIGNATURE OF APPROVAL
State Highways		
Building Officials		
PSZA ( Zoning )		
PSZA ( Engineering )		
Health	11/17/16	<i>[Signature]</i>

Is Sediment Control approval required for issuance?  Yes  No  
 CONTINGENCY CONSTRUCTION START

DPZ SETBACK INFORMATION
Front:
Rear:
Side:
Side St.:
All minimum setbacks met? <input type="checkbox"/> Yes <input type="checkbox"/> No
Is Entrance Permit Required? <input type="checkbox"/> Yes <input type="checkbox"/> No
Historic District? <input type="checkbox"/> Yes <input type="checkbox"/> No
Lot Coverage for New Town Zone:
SDP/Red-line approval date:

Filing Fee	\$
Permit Fee	\$
Tech Fee	\$
Excise Tax	\$
PSFS	\$
Guaranty Fund	\$
Add'l per Fee	\$
Total Fees	\$
Sub- Total Paid	\$
Balance Due	\$
Check	#

New Walls

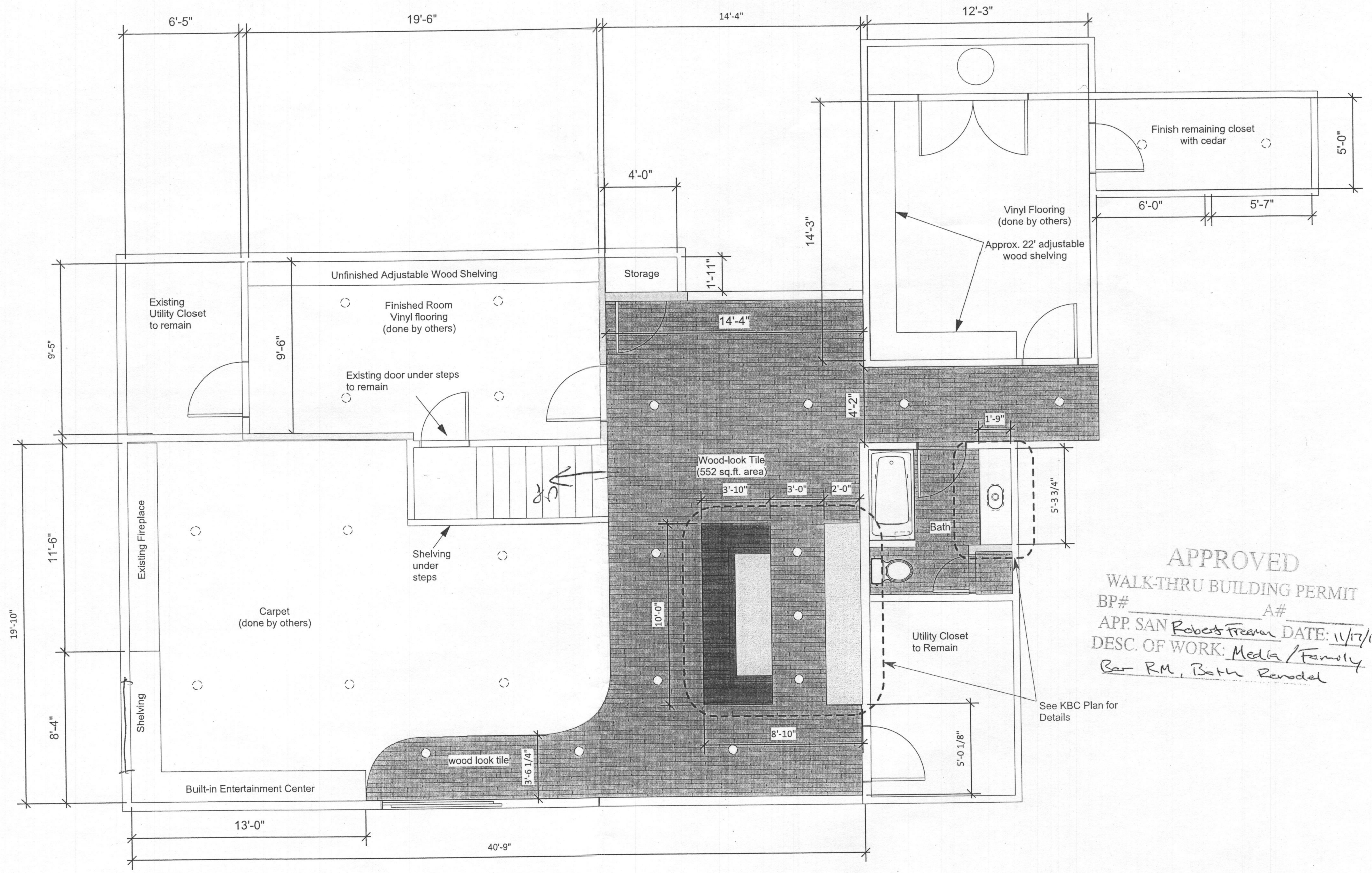

APPROVED  
 WALK-THRU BUILDING PERMIT  
 BP# \_\_\_\_\_ A# \_\_\_\_\_  
 APP. SAN Robert Freeman DATE: 11/17/16  
 DESC. OF WORK: Media / Family  
Bar RM, Bath Renodel

See KBC Plan for Details

Renderings, Drawings, Samples and other intellectual properties provided are for the express benefit of the client. However, ProBuilt Construction Inc, has sole ownership of all documents. Clients can never own, use, and/or distribute documents without written consent of ProBuilt Construction, Inc.

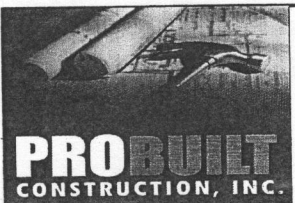

General Contractor  
**ProBuilt Construction Inc.**  
 13330 Clarksville Pike  
 Highland, MD 20777  
 ph: 301-854-0821  
 www.probuiltconstruction.com

Project Title  
 PENIX RESIDENCE  
 12188 MOUNT ALBERT RD  
 ELLICOTT CITY, MD 21042

Project Manager <b>Jessica Barwick</b>	Drawing Title <b>Basement Plan</b>
Date <b>11.04.16</b>	Scale <b>Scale: 3/16"=1'-0"</b>