



Building Permit Application

Howard County Maryland
Department of Inspections, Licenses and Permits
3430 Court House Drive
Permits: 410-313-2455
www.howardcountymd.gov

Date Received: _____

Permit No.: _____

Building Address: 2791 Florence Rd
City: Woodbine State: MD Zip Code: 21797
Suite/Apt. # _____ SDP/WP/BA #: _____
Census Tract: _____ Subdivision: _____
Section: _____ Area: _____ Lot: 6
Tax Map: 0007 Parcel: 0012 Grid: 0019
Zoning: _____ Map Coordinates: _____ Lot Size: 1.35A

Existing Use: SFD
Proposed Use: SFD Finished Basement
Estimated Construction Cost: \$ 25,000.
Description of Work: Finish basement, exercise room, rec room, full bath, bar area, utility storage, 800 sq ft finished space
Occupant/Tenant Name: Homeowner
Was tenant space previously occupied? Yes No
Contact Name: _____
Address: _____
City: _____ State: _____ Zip Code: _____
Phone: _____ Fax: _____
Email: _____

Property Owner's Name: Adam & Heather Parks
Address: 2791 Florence Rd
City: Woodbine State: MD Zip Code: 21797
Phone: 801 647 7491 Fax: NA
Email: sicparks@gmail.com

Applicant's Name & Mailing Address, (if other than stated herein)
Applicant's Name: Brent Basement Bldgs
Address: 1716 Spring Hollow Ct
City: WFAiry State: MD Zip Code: 21771
Phone: 301 399 5708 Fax: _____
Email: brentbuild@verizon.net

Contractor Company: Basement Bldgs
Contact Person: Brent Johnson
Address: 1716 Spring Hollow Ct
City: WFAiry State: MD Zip Code: 21771
License No.: 40689
Phone: 410 489 0500 Fax: NA
Email: brentbuild@verizon.net

Engineer/Architect Company: NA
Responsible Design Prof.: _____
Address: _____
City: _____ State: _____ Zip Code: _____
Phone: _____ Fax: _____
Email: _____

Commercial Building Characteristics	Residential Building Characteristics
Height:	<input checked="" type="checkbox"/> SF Dwelling <input type="checkbox"/> SF Townhouse
No. of stories:	<u>1</u> Depth Width
Gross area, sq. ft./floor:	1 st floor: _____ 2 nd floor: _____
Area of construction (sq. ft.):	Basement: _____ <input type="checkbox"/> Finished Basement
Use group:	<input checked="" type="checkbox"/> Unfinished Basement <input type="checkbox"/> Crawl Space
Construction type:	<input type="checkbox"/> Slab on Grade
<input type="checkbox"/> Reinforced Concrete	No. of Bedrooms: _____
<input type="checkbox"/> Structural Steel	Multi-family Dwelling
<input type="checkbox"/> Masonry	No. of efficiency units: _____
<input type="checkbox"/> Wood Frame	No. of 1 BR units: _____
<input type="checkbox"/> State Certified Modular	No. of 2 BR units: _____
	No. of 3 BR units: _____
	Other Structure: _____
	Dimensions: _____
<input checked="" type="checkbox"/> Roadside Tree Project Permit	Footings: _____
<input type="checkbox"/> Yes <input type="checkbox"/> No	Roof: _____
Roadside Tree Project Permit #	<input type="checkbox"/> State Certified Modular
	<input type="checkbox"/> Manufactured Home

Utilities	
Electric:	<input checked="" type="checkbox"/> Yes <input type="checkbox"/> No
Gas:	<input checked="" type="checkbox"/> Yes <input type="checkbox"/> No
Water Supply	
<input type="checkbox"/> Public	
<input checked="" type="checkbox"/> Private	
Sewage Disposal	
<input type="checkbox"/> Public	
<input checked="" type="checkbox"/> Private	
Heating System	
<input type="checkbox"/> Electric <input type="checkbox"/> Oil	
<input checked="" type="checkbox"/> Natural Gas <input checked="" type="checkbox"/> Propane Gas	
<input type="checkbox"/> Other:	
Sprinkler System:	
<input checked="" type="checkbox"/> Yes <input type="checkbox"/> No	
Grading Permit Number: _____	
Building Shell Permit Number: _____	

THE UNDERSIGNED HEREBY CERTIFIES AND AGREES AS FOLLOWS: (1) THAT HE/SHE IS AUTHORIZED TO MAKE THIS APPLICATION; (2) THAT THE INFORMATION IS CORRECT; (3) THAT HE/SHE WILL COMPLY WITH ALL REGULATIONS OF HOWARD COUNTY WHICH ARE APPLICABLE THERETO; (4) THAT HE/SHE WILL PERFORM NO WORK ON THE ABOVE REFERENCED PROPERTY NOT SPECIFICALLY DESCRIBED IN THIS APPLICATION; (5) THAT HE/SHE GRANTS COUNTY OFFICIALS THE RIGHT TO ENTER ONTO THIS PROPERTY FOR THE PURPOSE OF INSPECTING THE WORK PERMITTED AND POSTING NOTICES.

Brent Johnson
Applicant's Signature
brentbuild@verizon.net
Email Address
owner Basement Bldgs
Title/Company

Brent Johnson
Print Name
1-12-17
Date

Checks Payable to: DIRECTOR OF FINANCE OF HOWARD COUNTY
PLEASE WRITE NEATLY & LEGIBLY
-FOR OFFICE USE ONLY-

AGENCY	DATE	SIGNATURE OF APPROVAL
State Highways		
Building Officials		
PSZA (Zoning)		
PSZA (Engineering)		
Health		<u>1/21/17 R. Bricker</u>

Is Sediment Control approval required for issuance? Yes No
 CONTINGENCY CONSTRUCTION START

DPZ SETBACK INFORMATION	
Front:	
Rear:	
Side:	
Side St.:	
All minimum setbacks met?	<input type="checkbox"/> Yes <input type="checkbox"/> No
Is Entrance Permit Required?	<input type="checkbox"/> Yes <input type="checkbox"/> No
Historic District?	<input type="checkbox"/> Yes <input type="checkbox"/> No
Lot Coverage for New Town Zone:	
SDP/Red-line approval date:	

Filing Fee	\$ <u>25.00</u>
Permit Fee	\$ <u>100.00</u>
Tech Fee	\$ <u>10.00</u>
Excise Tax	\$
PSFS	\$
Guaranty Fund	\$
Add'l per Fee	\$
Total Fees	\$ <u>135.00</u>
Sub- Total Paid	\$
Balance Due	\$
Check	#

Distribution of Copies: White: Building Officials Green: PSZA,Zoning Yellow: PSZA,Engineering Pink: Health Gold: SHA

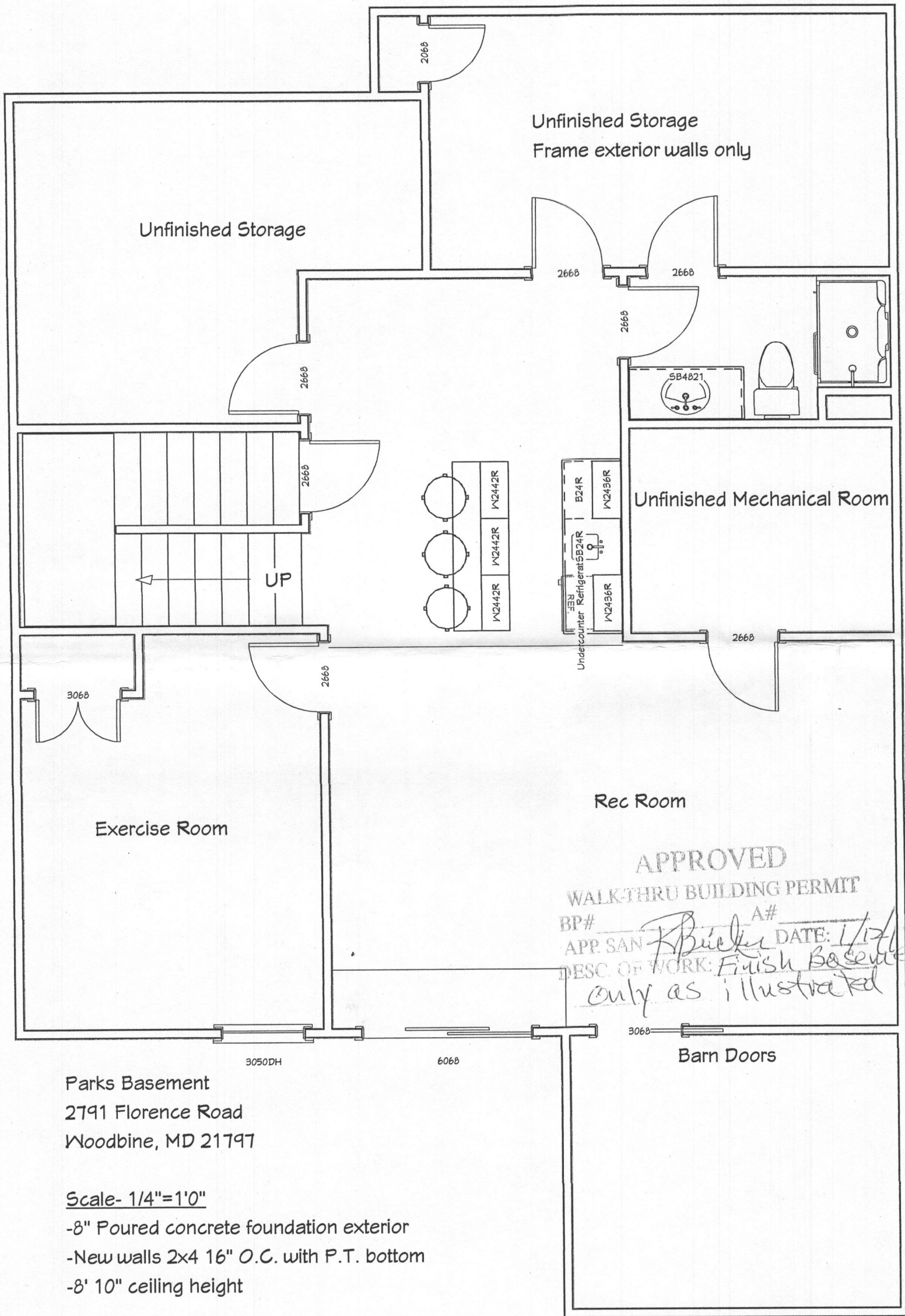

Parks Basement
 2791 Florence Road
 Woodbine, MD 21797

Scale- 1/4"=1'0"
 -8" Poured concrete foundation exterior
 -New walls 2x4 16" O.C. with P.T. bottom
 -8' 10" ceiling height