WATER WELL ABANDONMENT-SEALING REPORT FORM

SUBMIT COPIES OF COMPLETED FORM TO:

- * COUNTY ENVIRONMENTAL AGENCY (contact MDE, WMA if address needed)
- * WELL OWNER
- * MDE, WATER MANAGEMENT ADMINISTRATION, WELL PROGRAM

OK
9/14/16 SC

DATE WELL ABANDONED: 10-20-15 (month/day/year)

* PERMIT NUMBER OF ABANDONED WELL (if any) _____

* PERMIT NUMBER OF REPLACEMENT WELL: _____

* PERSON ABANDONING WELL: Andrew Houseman WELL DRILLER'S LICENSE NUMBER: 224

CIRCLE: MWD / MSD / MGD

* OWNER'S NAME: Brian Smith

SITE LOCATION MAP

* WELL LOCATION:
COUNTY: Howard
NEAREST TOWN: Columbia
TAX MAP 0037 BLOCK 0007 PARCEL 0230
SUBDIVISION: _____
SECTION: _____ LOT: _____
STREET ADDRESS: 8302 Old Montgomery Rd

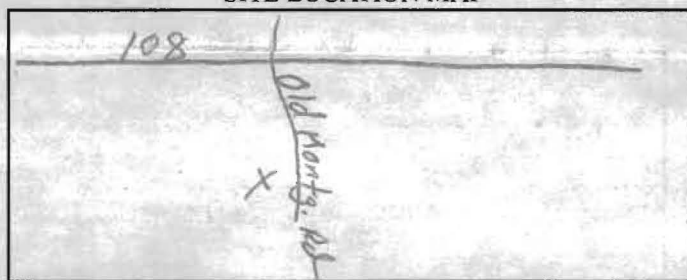

LATITUDE 3 9 . 2041893

LONGITUDE 7 6 . 7994843

LOG OF SEALING MATERIAL

MATERIAL	FEET	
	FROM	TO
<u>Cement</u>	<u>50</u>	<u>0</u>

VOLUME OF MATERIAL USED

1 yard Cement

* TYPE OF WELL BEING ABANDONED:

- DRILLED JETTED
- BORED HAND DUG
- OTHER (specify) _____

* USE CODE:

- DOMESTIC MUNICIPAL/PUBLIC
- IRRIGATION INDUSTRIAL
- TEST/OBSERVATION GEOTHERMAL

* TYPE OF CASING:

- STEEL PLASTIC
- CONCRETE OTHER (specify) _____

SIZE OF CASING: 6 INCHES IN DIAMETER

DEPTH OF WELL: 50 FEET DEEP

WAS ANY CASING REMOVED? YES NO

If yes, length removed, in feet: _____

WAS CASING RIPPED OR PERFORATED? YES NO

SIGNATURE-MASTER WELL DRILLER OR SUPERVISING SANITARIAN LICENSE#

Andrew Houseman

224

MWD / MSD / MGS

10-20-15

CIRCLE ONE

DATE

COUNTY

