

Bureau of Environmental Health

8930 Stanford Boulevard, Columbia, MD 21045

Main: 410-313-2640 | Fax: 410-313-2648

TDD 410-313-2323 | Toll Free 1-866-313-6300

www.hchealth.org

Facebook: www.facebook.com/hocohealth

Twitter: HowardCoHealthDep

Maura J. Rossman, M.D., Health Officer

APPLICATION

FOR PERCOLATION TESTING AND SITE EVALUATION

559815

PROPERTY LOCATION

SUBDIVISION/PROPERTY NAME

PROPERTY ADDRESS 3153 Emerald Valley Rd Ellicott City MD 21042

TAX ACCOUNT # TAX MAP GRID PARCEL LOT NO. PROPOSED LOT SIZE (ACRES)

ZONING CATEGORY TIER

PROPERTY OWNER(S) Michael S Basom

DAYTIME PHONE CELL EMAIL

MAILING ADDRESS

APPLICANT Ronnie Hears RELATIONSHIP TO OWNER: Contractor

DAYTIME PHONE 443 277 7526 CELL EMAIL

MAILING ADDRESS 425 Obrecht Rd Sykesville MD 21784

I HEREBY APPLY FOR THE NECESSARY TESTING/EVALUATION PRIOR TO ISSUANCE OF SEWAGE DISPOSAL SYSTEM PERMIT(S):

PROPERTY:

- PROPERTY: SUBDIVISION: NUMBER OF LOTS INCLUDING RESIDUE: SUBDIVISION CLASSIFICATION (PER DEPT. OF PLANNING AND ZONING) MAJOR MINOR CONSTRUCT NEW OSDS ON UNDEVELOPED LOT REPAIR OR REPLACE FAILING OSDS UPGRADE EXISTING OSDS

BUILDING:

- BUILDING: RESIDENTIAL WITH 21 EXISTING OR PROPOSED BEDROOMS IN THE COMPLETED STRUCTURE COMMERCIAL (PROVIDE DETAIL OF TYPE OF USE AND NUMBERS OF EMPLOYEES/CUSTOMERS ON ACCOMPANYING PLAN)

IS THE PROPERTY WITHIN 2500 FEET OF ANY RESERVOIR?

- YES NO

AS APPLICANT, I UNDERSTAND THE FOLLOWING:

- THIS APPLICATION IS VALID FOR TWO(2) YEARS FROM DATE OF FEE PAYMENT AND APPROVAL IS BASED UPON HEALTH OFFICER SIGNATURE OF A PERC CERTIFICATION PLAN PRIOR TO EXPIRATION OF THIS PERMIT. THE APPLICATION FEE IS NON-REFUNDABLE THIS APPLICATION MUST BE ACCOMPANIED BY ALL APPLICABLE FEES AND A SUITABLE SITE PLAN IN ORDER TO BE PROCESSED THIS IS A PUBLIC DOCUMENT

I declare and affirm that to the best of my knowledge, the information contained herein is correct. I declare that I am the owner of the property or duly authorized to make this application on behalf of the owner. I agree to comply with all applicable state and county regulations.

By signature of this application, I hereby grant Howard County Health Department officials the right to enter onto the property for the purpose of inspecting the property as directly related to the requested permit/service.

Signature of applicant

11/17/16

SIGNATURE OF APPLICANT

DATE

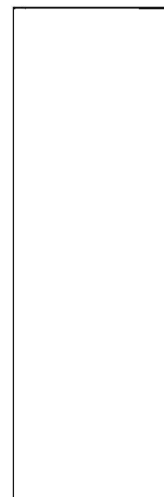
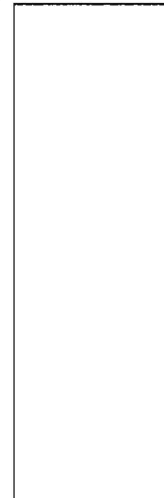
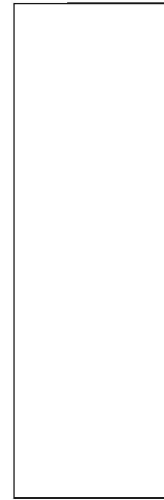
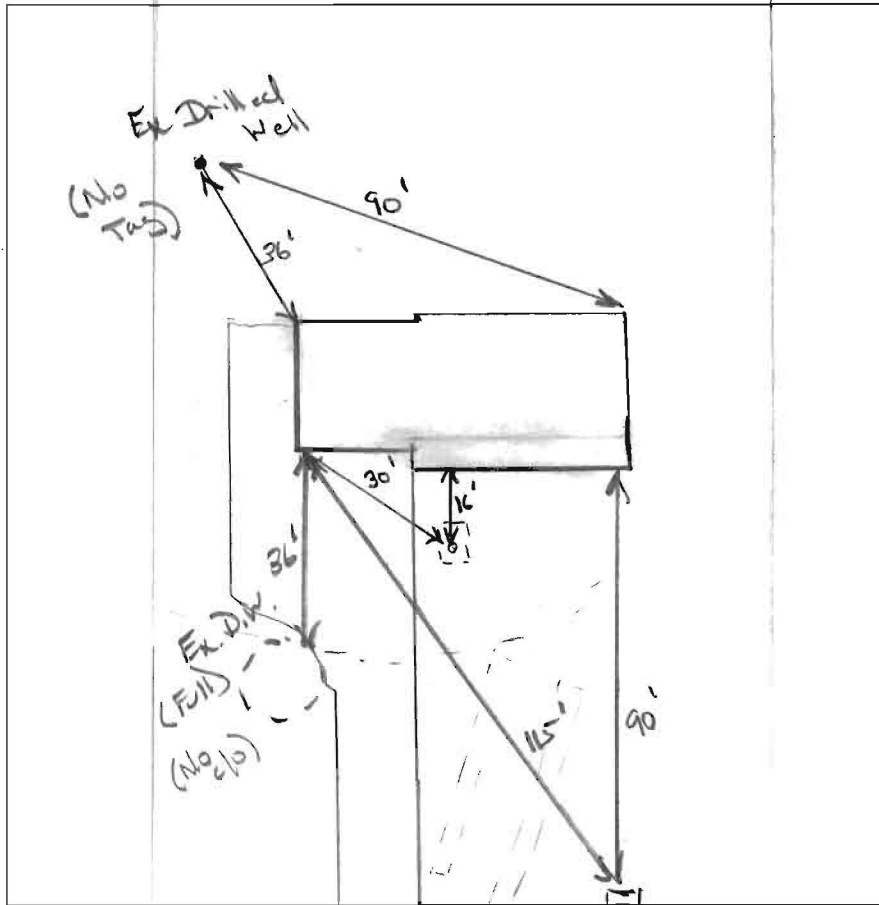
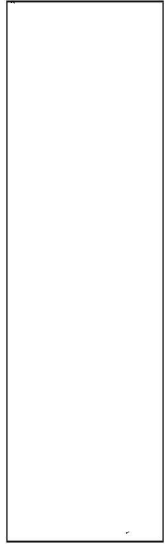

Ⓐ

Br/Br Rd.  
L,  
wk SBK  
roots  
3'  
Br/11 Br.  
L, wk pl,  
cw, 5% adm  
6'  
li Br/Y/Rd  
SL, Dry.  
wk PL,  
micaceous  
concrete found  
↓

3'

6'

14'

DATE	TEST #	DEPTH	START	BREAK 1" DROP	STOP 2" DROP	TIME OF 2ND INCH	P/F/H
12/1/16	Ⓐ	7 1/4'	00:39	00:41	00:43	2	P
		5'	00:41	00:46	00:57	11	P

REMARKS Avy Perc OK for 1.2 loading Rate.  
 SANITARIAN K. Wo F BACKHOE Ronnie Hiji OTHERS Helper  
 TEST HOLES USED IN SDA 1 AVG. PERC TIME 6.5 SQ. FT/BR  
 TRENCH WIDTH 2 INLET DEPTH 4' MAX. BOT DEPTH 9 EFFECTIVE S/W 5

$$4(150) = \frac{600}{1.2} = 500 \div 2 = 250 (.36) = 90 LF$$