

# APPLICATION

PERCOLATION TESTING

A \_\_\_\_\_  
P \_\_\_\_\_

HOWARD COUNTY HEALTH DEPARTMENT  
BUREAU OF ENVIRONMENTAL HEALTH  
P.O. BOX 476 ELLICOTT CITY, MARYLAND 21043  
TELEPHONE: 461-9933

DISTRICT \_\_\_\_\_  
DATE \_\_\_\_\_

TO: THE COUNTY HEALTH OFFICER  
ELLCOTT CITY, MARYLAND

I, HEREBY, APPLY FOR THE NECESSARY TEST IN ORDER TO CONSTRUCT (OR RECONSTRUCT) A SEWAGE DISPOSAL SYSTEM.

PROPERTY OWNER Bernard Heidelberg  
ADDRESS 7036 Mink Hollow Rd PHONE \_\_\_\_\_

PROSPECTIVE BUYER \_\_\_\_\_  
ADDRESS \_\_\_\_\_ PHONE \_\_\_\_\_

PROPERTY LOCATION:

SUBDIVISION \_\_\_\_\_ LOT NO. \_\_\_\_\_

ROAD AND DESCRIPTION same

TAX MAP \_\_\_\_\_ PARCEL # \_\_\_\_\_

SIZE OF LOT \_\_\_\_\_ TYPE BLDG. \_\_\_\_\_  
(SINGLE FAMILY DWELLING OR COMMERCIAL)

THE SYSTEM INSTALLED UNDER THIS APPLICATION IS ACCEPTABLE ONLY UNTIL PUBLIC FACILITIES BECOME AVAILABLE. I FULLY UNDERSTAND THE FEE CONNECTED WITH THE FILING OF THIS PERC TEST APPLICATION IS NON-REFUNDABLE UNDER ANY CIRCUMSTANCES. I ALSO AGREE TO COMPLY WITH ALL M.O.S.H.A. REQUIREMENTS IN TESTING THIS LOT.

(SIGNATURE OF APPLICANT)

APPROVED BY \_\_\_\_\_ FOR \_\_\_\_\_ DATE \_\_\_\_\_

REJECTED BY \_\_\_\_\_ FOR \_\_\_\_\_ DATE \_\_\_\_\_

HOLD PENDING FURTHER TESTS \_\_\_\_\_ DATE \_\_\_\_\_

REASONS FOR REJECTION OR HOLDING 8/7/89- Proposed garage is lower than area tested for the repair. The repair area has water table problems which will require close interpretation in future repairs. S. Abel for MK

HD-216

# THIS IS NOT A PERMIT

① ② H!  
 ③ LO.  
 Repairs  
 $\bar{x} = 4$   
 180 DBR  
 Inlet  $2\frac{1}{2}$   
 Bottom 4'

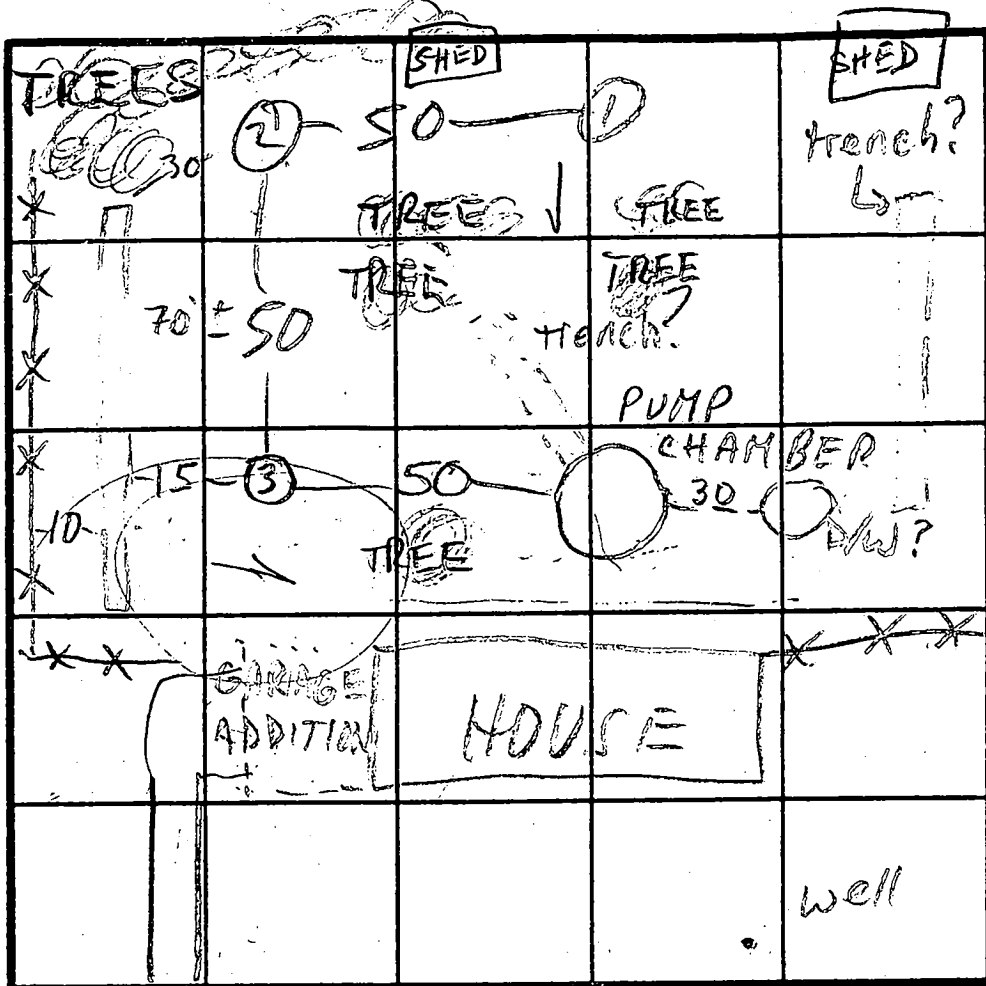

②  
 SOIL PROFILE  
 topsoil  
 org  
 brn  
 clay loam  
 3  
 14. tan  
 med  
 brn  
 sandy  
 silt  
 loam  
 9  
 WATER

INDICATE NORTH. NAME ADJOINING ROADWAY AS BASE LINE.  
 MINK HOLLOW RD

DATE	TEST NO.	DEPTH	PRE-WET		TEST - 1" DROP		TIME
			START	STOP	START	STOP	
8/14/89	1 S	4 1/2	11:55	MOVED 1/2" IN	25 min		
	1 V				WATER AT 9'		
	2 S	4	11:58	12:02	12:02	12:06	4
	2 V				WATER AT 9'		
	3 V				OK - WATER AT 8 1/2'		

REMARKS SHALLOW SYSTEM ONLY OR LOWER THAN GARAGE LEVEL ③  
 REPAIR WILL REQUIRE SPECIAL REVIEW DUE TO H<sub>2</sub>O TABLE  
 TYPE OF SOIL PROPOSED GARAGE HAS NO IMPACT ON REPAIR  
 RECOMMEND APPROVAL OF BP FOR PROPOSED GARAGE  
 TESTED BY NO FUTURE REPAIR AREA LOST MR 8/7/89 ALSO PRESENT