





MARYLAND DEPARTMENT OF THE ENVIRONMENT, WATER MANAGEMENT ADMINISTRATION  
1800 Washington Blvd., Baltimore, Maryland 21230 (410) 537-3784

\*\*\*\*\*  
WATER WELL ABANDONMENT-SEALING REPORT FORM  
\*\*\*\*\*

SUBMIT COPIES OF COMPLETED FORM TO:

- \* COUNTY ENVIRONMENTAL AGENCY (contact MDE, WMA if address needed)
- \* WELL OWNER
- \* MDE, WATER MANAGEMENT ADMINISTRATION, WELL PROGRAM

DATE WELL ABANDONED: OCT 28 2013 (month/day/year)

\* PERMIT NUMBER OF ABANDONED WELL (if any) N/A

\* PERMIT NUMBER OF REPLACEMENT WELL: N/A

\* PERSON ABANDONING WELL: Ralph E. MAYNE WELL DRILLER'S LICENSE NUMBER: 117  
CIRCLE: MWD MSD MGD

\* OWNER'S NAME: Land Design & Developments

\* WELL LOCATION:  
COUNTY: Howard  
NEAREST TOWN: Columbia Md.  
TAX MAP \_\_\_\_\_ BLOCK \_\_\_\_\_ PARCEL \_\_\_\_\_  
SUBDIVISION: Rivers Overlook  
SECTION: \_\_\_\_\_ LOT: N/A  
STREET ADDRESS: 10000 Old Columbia Rd.

SITE LOCATION MAP

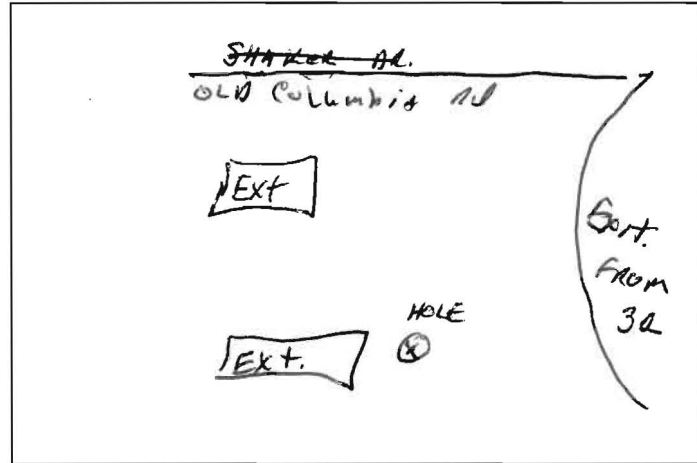

LATITUDE 3 9 . 1 7 4 8 6 \_

LONGITUDE 7 6 . 8 5 8 2 7 \_

\* TYPE OF WELL BEING ABANDONED:  
 DRILLED  JETTED  
 BORED  HAND DUG  
 OTHER (specify) \_\_\_\_\_

OK  
(RW)

\* USE CODE: DOMESTIC \_\_\_\_\_ MUNICIPAL/PUBLIC \_\_\_\_\_  
IRRIGATION \_\_\_\_\_ INDUSTRIAL \_\_\_\_\_  
 TEST/OBSERVATION \_\_\_\_\_ GEOTHERMAL \_\_\_\_\_

\* TYPE OF CASING:  
 STEEL  PLASTIC  
 CONCRETE  OTHER (specify) \_\_\_\_\_

SIZE OF CASING: 4 INCHES IN DIAMETER

DEPTH OF WELL: 8 FEET DEEP

WAS ANY CASING REMOVED? YES  NO   
If yes, length removed, in feet: \_\_\_\_\_

LOG OF SEALING MATERIAL

MATERIAL	FEET	
	FROM	TO
Cement.	8	0

VOLUME OF MATERIAL USED

7 BAG



MARYLAND DEPARTMENT OF THE ENVIRONMENT, WATER MANAGEMENT ADMINISTRATION  
1800 Washington Blvd., Baltimore, Maryland 21230 (410) 537-3784

\*\*\*\*\*  
WATER WELL ABANDONMENT-SEALING REPORT FORM  
\*\*\*\*\*

SUBMIT COPIES OF COMPLETED FORM TO:

- \* COUNTY ENVIRONMENTAL AGENCY (contact MDE, WMA if address needed)
- \* WELL OWNER
- \* MDE, WATER MANAGEMENT ADMINISTRATION, WELL PROGRAM

DATE WELL ABANDONED: 04 28 2013 (month/day/year)

\* PERMIT NUMBER OF ABANDONED WELL (if any) N/A

\* PERMIT NUMBER OF REPLACEMENT WELL: N/A

\* PERSON ABANDONING WELL: Ralph E MAYNE WELL DRILLER'S LICENSE NUMBER: 117  
CIRCLE: MWD / ~~MSD~~ / MGD

\* OWNER'S NAME: Land Design & Development

\* WELL LOCATION:  
COUNTY: Howard  
NEAREST TOWN: Columbia Md.  
TAX MAP BLOCK PARCEL \_\_\_\_\_  
SUBDIVISION: Rivers Overlook  
SECTION: \_\_\_\_\_ LOT: N/A  
STREET ADDRESS: 10000 Old Columbia Rd

SITE LOCATION MAP

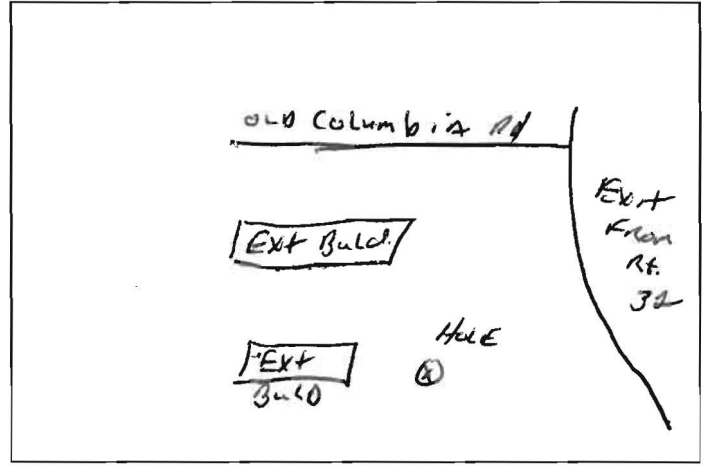

LATITUDE 39.17490  
LONGITUDE 76.85831

\* TYPE OF WELL BEING ABANDONED:  
 DRILLED  JETTED  
 BORED  HAND DUG  
 OTHER (specify) \_\_\_\_\_

OK  
(RW)

\* USE CODE: DOMESTIC \_\_\_\_\_ MUNICIPAL/PUBLIC \_\_\_\_\_  
IRRIGATION \_\_\_\_\_ INDUSTRIAL \_\_\_\_\_  
 TEST/OBSERVATION \_\_\_\_\_ GEOTHERMAL \_\_\_\_\_

\* TYPE OF CASING:  
 STEEL  PLASTIC  
 CONCRETE \_\_\_\_\_ OTHER (specify) \_\_\_\_\_

SIZE OF CASING: 4 INCHES IN DIAMETER

DEPTH OF WELL: 9 FEET DEEP

WAS ANY CASING REMOVED? YES  NO  
If yes, length removed, in feet: \_\_\_\_\_

LOG OF SEALING MATERIAL

MATERIAL	FEET	
	FROM	TO
<u>Cement</u>	<u>9</u>	<u>0</u>

VOLUME OF MATERIAL USED

2 BAGS