

APPLICATION

FOR PERCOLATION TESTING AND SITE EVALUATION

TEST DATE(S) _____ TEST TIME _____ @JP 528885

AGENCY REVIEW: _____ DATE 4/9/08

DO NOT WRITE ABOVE THIS LINE

I HEREBY APPLY FOR THE NECESSARY TESTING/EVALUATION PRIOR TO ISSUANCE OF SEWAGE DISPOSAL SYSTEM PERMIT(S) TO:

CHECK AS NEEDED:

- CONSTRUCT NEW SEPTIC SYSTEM(S)
- REPAIR/ADD TO AN EXISTING SEPTIC SYSTEM
- REPLACE AN EXISTING SEPTIC SYSTEM

CHECK AS NEEDED:

- NEW STRUCTURE(S)
- ADDITION TO AN EXISTING STRUCTURE
- REPLACE AN EXISTING STRUCTURE

CHECK ONE: UPGRADE

- CREATE NEW LOT(S)
- BUILD ON AN EXISTING LOT IN A SUBDIVISION
- BUILD ON AN EXISTING PARCEL OF RECORD

IS THE PROPERTY WITHIN 2500' OF ANY RESERVOIR?

- YES
- NO

THE TYPE OF STRUCTURE IS:

- RESIDENTIAL WITH 4 PROPOSED BEDROOMS IN THE COMPLETED STRUCTURE (NOTE **UNKNOWN** IF APPROPRIATE)
- COMMERCIAL (PROVIDE DETAIL OF NUMBERS AND TYPES OF EMPLOYEES/ CUSTOMERS ON ACCOMPANYING PLAN)
- INSTITUTIONAL/GOVERNMENT (PROVIDE DETAIL OF NUMBERS AND TYPES OF EMPLOYEES/USERS ON ACCOMPANYING PLAN)

PROPERTY OWNER(S) RAJIV + PAMILA SHAH

DAYTIME PHONE 3015602468 CELL 2023291494 FAX 2026627101

MAILING ADDRESS 7024 Mink Hollow RD Highland MD 20777
STREET CITY/TOWN STATE ZIP

APPLICANT RAJIV SHAH

DAYTIME PHONE SAME AS ABOVE CELL _____ FAX _____

MAILING ADDRESS _____
STREET CITY/TOWN STATE ZIP

APPLICANT'S ROLE: DEVELOPER ^{OWNER} BUILDER BUYER RELATIVE/FRIEND REALTOR CONSULTANT

PROPERTY LOCATION
SUBDIVISION/PROPERTY NAME SWAN HILL LOT NO. 2

PROPERTY ADDRESS 7024 Mink Hollow Rd
STREET TOWN/POST OFFICE

TAX MAP PAGE(S) 40 GRID 2 PARCEL(S) 162 PROPOSED LOT SIZE 1 ACRE

AS APPLICANT, I UNDERSTAND THE FOLLOWING: THE SYSTEM INSTALLED SUBSEQUENT TO THIS APPLICATION IS ACCEPTABLE ONLY UNTIL PUBLIC SEWERAGE IS AVAILABLE. THIS APPLICATION IS COMPLETE WHEN ALL APPLICABLE FEES AND A HITTABLE SITE PLAN HAVE BEEN RECEIVED. I ACCEPT THE RESPONSIBILITY FOR COMPLIANCE WITH ALL M.O.S.H.A. AND "SS UTILITY" REQUIREMENTS. APPROVAL IS BASED UPON SATISFACTORY REVIEW OF A PERC CERTIFICATION PLAN.

TEST RESULTS WILL BE MAILED TO APPLICANT. Rajiv Shah
SIGNATURE OF APPLICANT

HOWARD COUNTY HEALTH DEPARTMENT, BUREAU OF ENVIRONMENTAL HEALTH, WELL AND SEPTIC PROGRAM
7178 COLUMBIA GATEWAY DRIVE COLUMBIA, MARYLAND 21046 (410) 313-1771 FAX (410) 313-2648
TDD (410) 313-2323 TOLL FREE 1-877-4MD-DHMH

528885

7024 Mink Hollow Rd.

(12)

AP

(11)

5' dk brn scl }
 1' brn scl } Fill
 5' brn tyscl
 1' common mica
 5' yel-brn scl
 5' red-brn chsl
 micaeous
 9' red-brn & lt. brn
 variegated
 fl chsl
 5' dk brn scl
 common mica
 1' brn scl
 2 mshk
 red-brn scl
 & lt. brn scl
 common mica
 1' brn chsl
 1' brn fl chsl

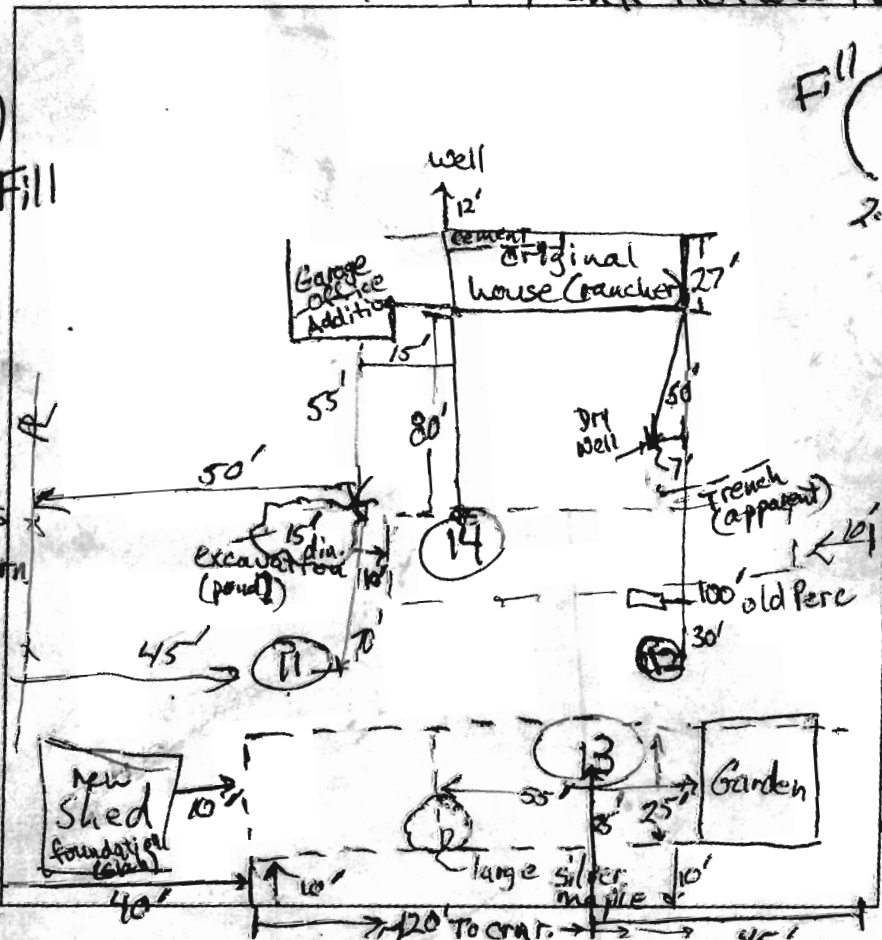

Fill

0.4' dk brn scl
 common mica
 1.7' brn scl, few boulders
 dk grey brn loam
 2.5' yel-brn scl
 6.0' red-brn chsl
 micaeous
 10' red-brn & lt. brn
 variegated
 fl chsl
 micaeous
 11.5' brn fl chsl
 micaeous
 13' dk brn scl
 common mica
 0.5' brn scl
 micaeous
 3' red-brn, lt. brn
 heavy sl
 micaeous
 4' red-brn, lt. brn
 sl, micaeous
 8' red-brn chsl
 10% flags
 13'

(13)

(14)

DATE	TEST #	DEPTH	START	BREAK 1" DROP	STOP 2" DROP	TIME OF 2ND INCH	P/F/H
4/29/08	11	6.5' / 13.5'	10:00	10:30 ⁺			F
4/29/08	12	7.5' / 13'	10:37	10:46	11:16 ⁺	>30	F
reshelf	11	7.5' / 12.5'	11:10	11:42 ⁺			F
4/29/08	13	6' / 13'	11:53	11:56	12:00	4	P
4/29/08	14	9' / 14'	12:42	12:46	12:50	4	P

REMARKS _____
 SANITARIAN PB BACKHOE Bill Ingram OTHERS _____
 TEST HOLES USED IN SDA 13 & 14 & 142 AVG. PERC TIME < 5 SQ. FT/BR 125
 TRENCH WIDTH _____ INLET DEPTH 3 1/4 MAX. BOT DEPTH 8 & 10 EFFECTIVE SW varies