

7/20/99

PERMIT

SEWAGE DISPOSAL SYSTEM

DEPARTMENT OF HEALTH AND MENTAL HYGIENE

P 512041

A REPAIR

DISTRICT _____

DATE 7-30-99

DATE SYSTEM APPROVED 7/20/99

INSPECTOR DKS

HOWARD COUNTY HEALTH DEPARTMENT
BUREAU OF ENVIRONMENTAL HEALTH
~~XXXXXX~~ 410-313-2640

RPS# 370493
INDEXED

Jack Fyock Septic Service IS PERMITTED TO INSTALL _____ ALTER

ADDRESS P.O. Box 89, Glenelg, MD 21737 PHONE 410-988-9270

SUBDIVISION _____ LOT _____ ROAD 6985 Mink Hollow Road

PROPERTY OWNER Wade

ADDRESS _____

SEPTIC TANK CAPACITY Existing GALLONS

NUMBER OF BEDROOMS 4

125 SQUARE FEET PER BEDROOM

LINEAR FEET OF TRENCH REQUIRED 71

REPAIR - PURPOSE - Existing septic system has failed.

Call for inspection when ground is opened so sanitarian can recommend repair. 7-27-99

Install replacement trench off existing drywell along contour
Trench to be 2' wide, inlet 2.5', bottom 9.5', stone 7'

PLANS APPROVED BY DKS DATE 7/20/99

COVER NO WORK UNTIL INSPECTED AND APPROVED

NEITHER THE HOWARD COUNTY COUNCIL NOR THE HEALTH DEPARTMENT IS RESPONSIBLE FOR THE SUCCESSFUL OPERATION OF ANY SYSTEM

NOTE: CLEANOUT REQUIRED EVERY 70 FEET OF SEWER LINE AND/OR AT 90° SWEEPS IN LINES FROM HOUSE TO DRAIN FIELDS, 90° ELBOWS NOT ACCEPTABLE.

NOTE: ALL PARTS OF SEPTIC SYSTEMS (I.E. TANK, DISTRIBUTION BOX TRENCHES) TO BE 100 FEET FROM WELL (UNLESS OTHERWISE SPECIFICALLY AUTHORIZED)

NOTE: IF DEEP TRENCH(ES) ARE USED CALL FOR INSPECTION BEFORE AND AFTER PLACING GRAVEL IN TRENCH(ES)

NOTE: NO DRY WELL SHALL EXCEED 15 FOOT IN DIAMETER NO ABSORPTION TRENCH TO EXCEED 100 FEET IN LENGTH

NOTE: ALL PIPE FROM HOUSE TO SEPTIC TANK MUST BE CAST IRON OR SCHEDULE 35/40 PVC OR ABS

PERMIT VOID AFTER TWO YEARS

NOTE: INSTALL STAND PIPE ON SEPTIC TANK AND DRY WELL STAND PIPES MUST BE 6 INCHES IN DIAMETER CAST IRON, CONCRETE OR TERRA COTTA OR PVA OR ABS ACCEPTED. IF TOP OF SEPTIC TANK IS DEEPER THAN 3 FEET, MANHOLE TO GRADE REQUIRED.

NOTE: DISTRIBUTION BOXES MUST HAVE BAFFLES

***INSTALLER IS RESPONSIBLE FOR OBTAINING FINAL APPROVAL ON THIS PERMIT**

P512041

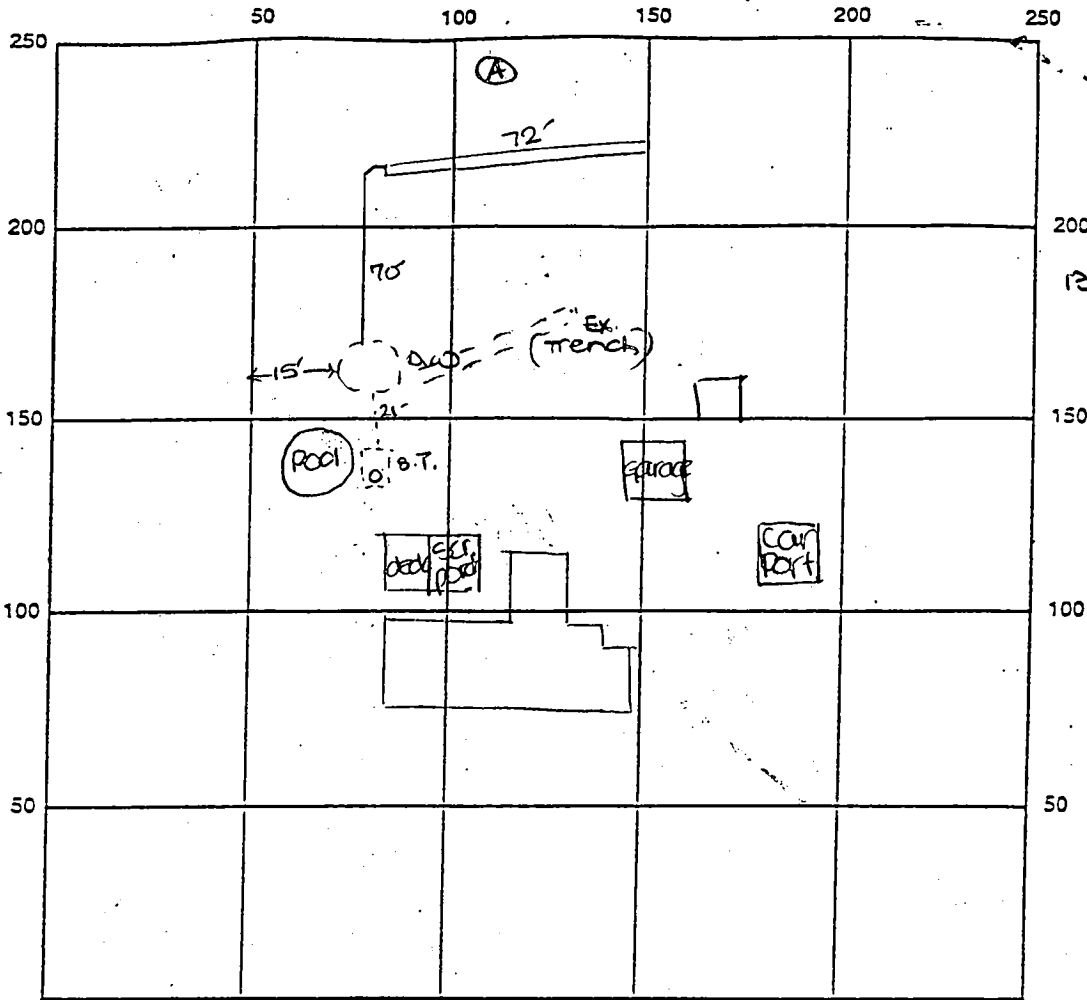

INDICATE NORTH - NAME ADJOINING ROADWAY AS BASE LINE

Mink Hollow Road

SEPTIC TANK LEVEL Existing CLEANOUTS one on site

DISTRIBUTION BOX LEVEL Not Used

DRAIN FIELD/TITLE DEPTH 9.5 FT. TRENCH WIDTH 2 FT. INLET DEPTH 2.5 FT.

EFFECTIVE GRAVEL DEPTH 7 FT. TOTAL LENGTH 72 FT.

NUMBER OF TRENCHES 1 ONE SIDEWALL BOTTOM AREA 504 SQ. FT.

DRYWALL INSIDE DIAMETER 12 FT. EFFECTIVE DEPTH BELOW INLET 11.5 FT.

ABSORBENT AREA 504 SQ. FT. Existing

REMARKS: 7/20/99 A.M. OK to begin system installation as specified. DKS

7/20/99 P.M. Final Insp - OK to cover all work. DKS

DATE SYSTEM APPROVED 7/20/99 INSPECTOR [Signature]