

HOWARD COUNTY  
PERMIT APPLICATION

PERMIT NUMBER

B00002501

Building Address 6985 Mink Hollow Rd.  
Highland, MD 20777

Suite/Apt. #: \_\_\_\_\_ SDP/WP/Petition #: \_\_\_\_\_

Census Tract \_\_\_\_\_ Subdivision \_\_\_\_\_

Section \_\_\_\_\_ Area \_\_\_\_\_ Lot \_\_\_\_\_

Tax Map \_\_\_\_\_ Parcel \_\_\_\_\_ Grid \_\_\_\_\_

Zoning \_\_\_\_\_ Map Coordinates \_\_\_\_\_ Lot size \_\_\_\_\_

Property Owner's Name John Wade

Address 6985 Mink Hollow Rd.

City Highland State MD Zip Code 20777

Phone 301-546-9056 Phone \_\_\_\_\_

Applicant's Name & Mailing Address, (if other than stated hereon): \_\_\_\_\_

Phone \_\_\_\_\_ Fax \_\_\_\_\_

Existing Use Self Dwelling

Proposed Use Single

Estimated Construction Cost \$ 130,000

Description of Work Removal of 300 sq. ft. porch and replacement with new porch

Contractor Company Suburban Paving

Contact Person Thomas M. Conway

Address 21 Demond Church

City Rockville State MD Zip Code 20850

License No. TS 2000

Phone 301-281-0000 Fax 301-281-0000

Occupant or Tenant John Wade

Contact Name \_\_\_\_\_

Address 6985 Mink Hollow Rd.

City Highland State MD Zip Code 20777

Phone 301-546-9056 Fax \_\_\_\_\_

Engineer or Architect Company \_\_\_\_\_

Contact Person \_\_\_\_\_

Address \_\_\_\_\_

City \_\_\_\_\_ State \_\_\_\_\_ Zip Code \_\_\_\_\_

Phone \_\_\_\_\_ Fax \_\_\_\_\_

BUILDING DESCRIPTION - <u>COMMERCIAL</u>		BUILDING DESCRIPTION - <u>RESIDENTIAL</u>	
Building Characteristics	Utilities	Building Characteristics	Utilities
Height: _____	Water Supply: <input type="checkbox"/> Public <input type="checkbox"/> Private	SF Dwelling <input checked="" type="checkbox"/> SF Townhouse <input type="checkbox"/> Depth _____ Width _____	Water Supply: <input type="checkbox"/> Public <input type="checkbox"/> Private
No. of stories: _____	Sewage Disposal: <input type="checkbox"/> Public <input type="checkbox"/> Private	1st floor: _____ 2nd floor: _____ Basement: _____	Sewage Disposal: <input type="checkbox"/> Public <input type="checkbox"/> Private
Gross area, sq. ft. per floor: _____	Electric Yes <input type="checkbox"/> No <input type="checkbox"/> Gas Yes <input type="checkbox"/> No <input type="checkbox"/>	Finished Basement <input type="checkbox"/> Unfinished Basement <input type="checkbox"/> <input type="checkbox"/> Crawl space <input type="checkbox"/> Slab on Grade <input type="checkbox"/> No. of Bedrooms _____ Height: _____	Electric Yes <input type="checkbox"/> No <input type="checkbox"/> Gas Yes <input type="checkbox"/> No <input type="checkbox"/>
Use group: _____	Heating System: Electric <input type="checkbox"/> Oil <input type="checkbox"/> Natural Gas <input type="checkbox"/> Propane Gas <input type="checkbox"/>	Multi-family dwellings: No. of efficiency units: _____ No. of 1 BR units: _____ No. of 2 BR units: _____ No. of 3 BR units: _____	Heating System: Electric <input type="checkbox"/> Oil <input type="checkbox"/> Natural Gas <input type="checkbox"/> Propane Gas <input type="checkbox"/>
Construction type: <input type="checkbox"/> Reinforced Concrete <input type="checkbox"/> Structural Steel <input type="checkbox"/> Masonry <input type="checkbox"/> Wood Frame	Sprinkler system: N/A <input type="checkbox"/> <input type="checkbox"/> Full <input type="checkbox"/> Partial <input type="checkbox"/> Other Suppression # of Heads _____	Other Structure: _____ Dimensions: _____ Footings: _____ Roof Height: _____	Sprinkler system: N/A <input type="checkbox"/> <input type="checkbox"/> NFPA #13D <input type="checkbox"/> NFPA #13R <input type="checkbox"/> Other:
<input type="checkbox"/> State Certified Modular		<input type="checkbox"/> State Certified Modular <input type="checkbox"/> Manufactured Home	

THE UNDERSIGNED HEREBY CERTIFIES AND AGREES AS FOLLOWS: (1) THAT HE/SHE IS AUTHORIZED TO MAKE THIS APPLICATION; (2) THAT THE INFORMATION IS CORRECT; (3) THAT HE/SHE WILL COMPLY WITH ALL REGULATIONS OF HOWARD COUNTY WHICH ARE APPLICABLE THERETO; (4) THAT HE/SHE WILL PERFORM NO WORK ON THE ABOVE REFERENCED PROPERTY NOT SPECIFICALLY DESCRIBED IN THIS APPLICATION; (5) THAT HE/SHE GRANTS COUNTY OFFICIALS THE RIGHT TO ENTER ONTO THIS PROPERTY FOR THE PURPOSE OF INSPECTING THE WORK PERMITTED AND POSTING NOTICES.

Applicant's Signature \_\_\_\_\_ Print Name \_\_\_\_\_

Title/Company \_\_\_\_\_ Date \_\_\_\_\_

Checks payable to: **DIRECTOR OF FINANCE OF HOWARD COUNTY**  
\*\* PLEASE WRITE NEATLY AND LEGIBLY. \*\*

**FOR OFFICE USE ONLY**

AGENCY	DATE	SIGNATURE APPROVAL	DPZ SETBACK INFORMATION	PROPERTY ID#
Land Development, DPZ			Front: _____	Filing fee \$ _____
State Highways			Rear: _____	Permit fee \$ <u>10,000</u>
Building Official			Side: _____	Excise tax \$ <u>1,000</u>
Dev. Engineering, DPZ			Side St.: _____	Add'l per. fee \$ _____
Health	<u>9-3-08</u>	<u>[Signature]</u>	All minimum setbacks met? YES <input type="checkbox"/> NO <input type="checkbox"/>	TOTAL FEES \$ _____
Fire Protection			Is Entrance Permit required? YES <input type="checkbox"/> NO <input type="checkbox"/>	Sub-total paid \$ _____
Is Sediment Control approval required prior to issuance? YES <input type="checkbox"/> NO <input type="checkbox"/>			Historic District? YES <input type="checkbox"/> NO <input type="checkbox"/>	Balance due \$ _____
CONTINGENCY CONSTRUCTION START: <input type="checkbox"/>			Lot Coverage for New Town Zone _____	Check # _____
ONE STOP SHOP: <input type="checkbox"/>			SDP/Red-line approval date _____	Validation # _____
Distribution of Copies- White: Building Official Green: LDD, DPZ Yellow: DED, DPZ Pink: Health Gold: SHA			Accepted by _____	

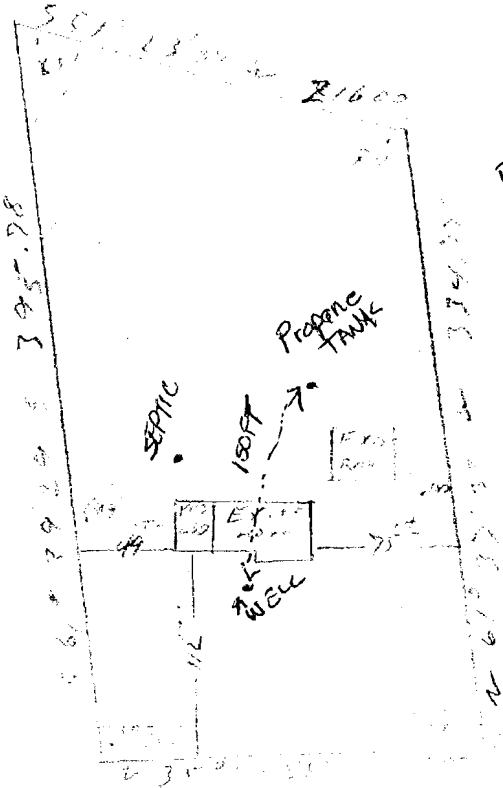

B08002501  
 9-3-08 ITS  
 TANK OK

0.61 x 29.24 = 17.55  
 3.00 x 1.00 = 3.00

ALL THE ABOVE ARE TO BE TAKEN  
 INTO ACCOUNT DURING THE DESIGN