

**Williams, Jeffrey**

---

**From:** Cumberland Company <cumberlandcompany@gmail.com>  
**Sent:** Tuesday, May 24, 2016 1:33 PM  
**To:** Williams, Jeffrey  
**Subject:** P#16001725 5509 Trotter Road  
**Attachments:** Invoice #2117.pdf; Pumping Invoice 275580.pdf

Dear Ms. Mielcarek and Mr. Williams,

Attached is our company invoice for septic abandonment at the referenced job site. Additionally, attached is a copy of the pumping bill we received for pumping at the referenced site. Howard County Plumbing no: P16001725. Should you have any questions, please contact Kelly Cumberland at 301-252-1123, or this email. Thank you.

--

Danielle Cumberland  
cell: 301-252-1124  
*Cumberland Company, Inc.*  
[www.cumberlandcompanyinc.com](http://www.cumberlandcompanyinc.com)

Cumberland Company, Inc.

16391 A.E. Mullinix Road  
Woodbine, MD 21797

# Invoice

Date	Invoice #
5/24/2016	2117

<b>Bill To</b>
Kristin Mielcarek Kristin.mielcarek@canaanvi.org Watershed Circuit Rider Canaan Valley Institute CC: Jeffrey Williams

P.O. No.	Terms	Due Date	Job:
#P16001725	Net 30	6/23/2016	5509 Trotter Rd, Clarksville

Quantity	Description	Rate	Amount
	Disconnect and abandon failing septic system. Hook up to public sewer with inspection approval for plumbing permit #P16001725.  Septic was abandoned as follows: 1. Dig up and pump tank and drywell (see pumping invoice attached). 2. Crush tank and drywell tops and fill with dirt.	10,300.00	10,300.00
<b>Total</b>			\$10,300.00

Phone #	Fax #
301-854-6838	301-854-6325

**Fogle's Septic Clean, Inc.**  
**580 Obrecht Road**  
**Sykesville, MD 21784**

**Invoice Date**      **Invoice #**  
 5/17/2016              275580

**INVOICE**

*PLEASE PAY*  
*THIS AMOUNT*                      \$940.00

Make checks payable to: **Fogle's Septic Clean, Inc.**

**Bill To:**

CUMBERLAND & CO  
 16391 A E MULLINEX ROAD  
 WOODBINE, MD 21797

**Service Address**

5509 TROTTER RD  
 CLARKSVILLE

**Phone #**              410-795-5670

Fogle's Septic Clean, Inc.  
 580 Obrecht Road  
 Sykesville, MD 21784

**PLEASE DETACH AND RETURN TOP PORTION WITH PAYMENT**

P.O. #	Due Date	Rep	Ship Date
	5/17/2016	DRL	5/16/2016

Qty	Description	Rate	Amount
2	PUMP SEPTIC & DRYWELL FOR ABANDONMENT  2 FULL LOADS	470.00	940.00

	<b>Subtotal</b>	\$940.00
	<b>Total</b>	\$940.00
1.5% interest will be charged monthly on all unpaid balances after 30 days. \$30 CHARGE FOR RETURNED CHECK. RECEIPT DATE STAMPS ARE STRICTLY ENFORCED for ALL DISCOUNTS.	<b>Payments/Credits</b>	\$0.00
<b>Billing Questions Call</b> 410-795-5670	<b>Customer Total Balance</b>	\$940.00



# CANAAN VALLEY INSTITUTE

February 18, 2016

Joseph DeJordy  
4299 S.E. Brittney Circle  
Port St. Lucie, Florida 34952

RE: FY 2016 Howard County Bay Restoration Fund OSDS Upgrade Program

Dear Mr. DeJordy:

Thank you for your application to participate in the Howard County Bay Restoration Fund OSDS Upgrade Program. The Howard County Health Department has verified that the existing septic system at your property at **5509 Trotter Road, Clarksville, MD**, is failing and that a connection to the Little Patuxent Sewage Treatment Plant is the most cost effective and environmentally sensitive solution. Maryland Department of the Environment (MDE) has reviewed the proposal for the cost to extend sewer to your property, and has approved it eligible to be paid using a Bay Restoration Fund grant.

Based on 2014 tax returns, you are eligible to receive funding to cover **100%** of the contractor cost of **\$10,300** to connect to public sewer. If you select a contractor whose installation cost is higher than the approved \$10,300, you will be responsible for additional costs. Upon project completion, CVI will request payment from MDE and will reimburse you any portion of the \$5100 Howard County Sewer Connection Fee not eligible for reimbursement by the county and will pay the \$10,300 installation cost directly to the contractor.

To accept the conditions of this grant award, please sign and return this letter to me prior to scheduling construction. If assistance is needed or if you have any questions, you may contact me at 304-940-3443 or [kristin.mielcarek@canaanvi.org](mailto:kristin.mielcarek@canaanvi.org).

Sincerely,

Kristin Mielcarek, Watershed Circuit Rider

I have read and agree to the conditions of this Agreement Letter.

Accepted by: Joseph DeJordy, Property Owner

---

*Signature*

*Date*

494 RiverStone Road | Davis, WV 26260  
Phone: (304) 259.4739 or (800) 922.3601 | Fax: (304) 259.4759  
[www.canaanvi.org](http://www.canaanvi.org)

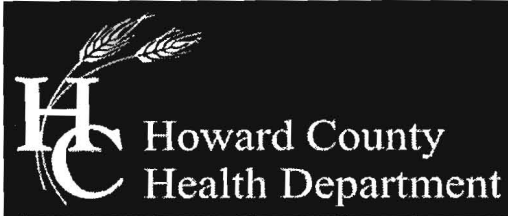

Bureau of Environmental Health  
7178 Columbia Gateway Drive, Columbia, MD 21046-2147  
Main: 410-313-2640 | Fax: 410-313-2648  
TDD 410-313-2323 | Toll Free 1-866-313-6300  
[www.hchealth.org](http://www.hchealth.org)  
Facebook: [www.facebook.com/hocohealth](https://www.facebook.com/hocohealth)  
Twitter: HowardCoHealthDep

Maura J. Rossman, M.D., Health Officer

February 3, 2016

MEMORANDUM

To: Jag Khuman  
Director  
Water Quality Financing Administration  
Maryland Department of the Environment

Kristin Mielcarek  
Canaan Valley Institute

From: Jeff Williams  
Program Supervisor, Well & Septic Program  
Bureau of Environmental Health

Re: **BRF Proposal for connecting 5509 Trotter Road to public sewer**

The Howard County Health Department has identified a property in Howard County that meets the five requirements of HB 57 to receive BRF money for connecting an existing house to an existing public sewer line.

**1. THE ENVIRONMENTAL IMPACT OF THE ONSITE SEWAGE DISPOSAL SYSTEM IS DOCUMENTED BY THE LOCAL GOVERNMENT AND CONFIRMED BY THE DEPARTMENT;**

The existing on-site sewage disposal system serving the single family dwelling on the property has failed. Please see exhibit A with field notes documenting the failure.

**2. IT CAN BE DEMONSTRATED THAT:**

**A. THE REPLACEMENT OF THE ONSITE SEWAGE DISPOSAL SYSTEM WITH SERVICE TO AN EXISTING MUNICIPAL WASTEWATER FACILITY THAT IS ACHIEVING ENHANCED NUTRIENT REMOVAL LEVEL TREATMENT IS MORE COST-EFFECTIVE FOR NITROGEN REMOVAL THAN UPGRADING THE INDIVIDUAL ONSITE SEWAGE DISPOSAL SYSTEM; OR**

**B. THE INDIVIDUAL REPLACEMENT OF THE ONSITE SEWAGE DISPOSAL SYSTEM IS NOT FEASIBLE;**

The Little Patuxent Wastewater Treatment Plant is currently constructed to meet to ENR standards. Therefore, it is more cost effective per pound of nitrogen removal than installing a BAT on an on-site sewage disposal system. The homeowner has received

three (3) written quotes (exhibit B) from contractors to make the connection. The lowest quote is \$10,300 from Zepp Plumbing and Heating plus the Howard County connection cost of \$5100.00 (exhibit C). The bids include line items for connection to public water. The portion of the bids relating only to public sewer connection and abandonment of the existing septic system were compared. *Please note that the connection fee has not yet been paid by the homeowner.* Additionally, connection to the public system is required by Howard County Code and installation of an on-site sewage disposal system would be inconsistent with the Howard County Master Plan for Water and Sewerage, and therefore, prohibited by COMAR 26.04.02.02.J.

**3. THE PROJECT IS CONSISTENT WITH THE COUNTY'S COMPREHENSIVE PLAN AND WATER AND SEWER MASTER PLAN;**

The Howard County Master Plan states that an individual sewerage system may not be installed on any parcel or lot where a public sewer system is adequate and available. The public sewer system is adequate and available to this property.

**4. THE ONSITE SEWAGE DISPOSAL SYSTEM WAS INSTALLED AS OF OCTOBER 1, 2008, AND THE PROPERTY THE SYSTEM SERVES IS LOCATED IN A PRIORITY FUNDING AREA, IN ACCORDANCE WITH § 5-7B-02 OF THE STATE FINANCE AND PROCUREMENT ARTICLE; AND**

The existing home was built before public sewer was available. Health Department records do not exist for the property. Exhibit D is a copy of the Maryland Department of Assessments and Taxation indicating that the home was built in 1959. Exhibit E is copy of the Priority Funding Map from the Maryland Department of Planning website. 5509 Trotter Road is within the Priority Funding Area.

**5. THE LOCAL GOVERNMENT HAS ADOPTED A POLICY OR PROCEDURE THAT WILL GUARANTEE THAT ANY FUTURE CONNECTION TO AN EXISTING MUNICIPAL WASTEWATER FACILITY THAT IS FUNDED UNDER PARAGRAPH (2)(I)1E OF THIS SUBSECTION WILL MEET ALL OF THE REQUIREMENTS UNDER THIS SUBPARAGRAPH.**

The Howard County public sewer line has already been constructed. The connection will be for 5509 Trotter Road and no other homes will be connected to the sewer line house connection.

The Howard County Health Department does not like to maintain financial data of Howard County citizens, so I have requested that the owner provide their taxable income information directly to Canaan Valley Institute. Please feel free to contact me at (410) 313-2651 with any questions.

SITE INSPECTION SHEET

OWNER: DeJordy PHONE #: \_\_\_\_\_  
ADDRESS: 5509 Trotter Rd CONTRACTOR: \_\_\_\_\_  
WELL TAG #: \_\_\_\_\_  
SUBDIVISION: \_\_\_\_\_ LOT: \_\_\_\_\_ COUNTY #: \_\_\_\_\_  
PROPOSAL: Family septic - use GRF for public connection

LOCATION DIAGRAM

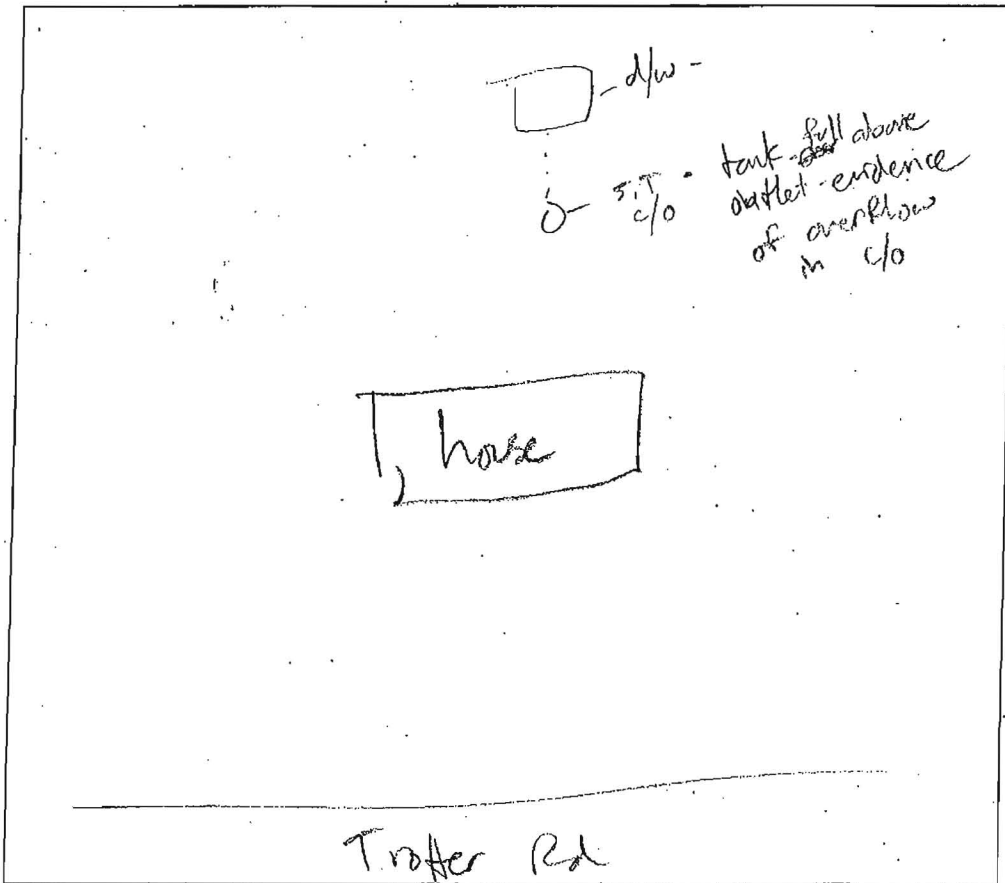

COMMENTS: \_\_\_\_\_  
\_\_\_\_\_  
\_\_\_\_\_

DATE: 7/13/15 INSPECTOR: J. Williams



Service Contractor Of Choice

8010 Cessna Avenue Gaithersburg, MD 20879  
(301) 840-5861 • Fax (240) 238-1856

# Proposal

Page No. 1 of 1 Pages

PROPOSAL SUBMITTED TO <b>James Dejordy</b>	Phone <b>240-485-4468</b>	DATE <b>December 9, 2015</b>
STREET <b>5509 Trotter Road</b>	JOB NAME <b>City Sewer &amp; Water Installation</b>	
CITY, STATE, AND ZIP CODE <b>Clarksville, MD 21029</b>	JOB ADDRESS <b>5509 Trotter Road</b>	

We hereby propose to furnish materials and labor necessary for the completion of:

Furnish and install new sewer and water from property line to house connection approximately 90', install hung sewer along unfinished basement wall approximately 60', waste line to be 4" schedule 40 PVC, water line to be 1" poly, existing septic tank and drywell to be pumped out and backfilled with stone per Howard County Health Department, existing well to be used for hose connection only

Includes: Howard County Plumbing Permits, daytime normal working hours, backfill to rough grade only, pressure reducing valve for domestic water

Does not include: overtime or night work, sewer and water tap fees, removal of pump tank, paint, drywall, electrical, carpentry, foundation drain repairs, sewage ejector pit or pump, utilities repairs not marked by miss utility, landscaping, removal or dirt

Complete water per specifications \$1,500.00  
 Complete sewer per specifications \$7,675.00  
 Connect to existing plumbing inside \$2,400.00  
 Abandon existing septic per Howard County Health Dept. \$2,000.00

WE PROPOSE hereby to furnish material and labor – complete in accordance with above specification, for the sum of:

**Thirteen Thousand five hundred seventy five** \$ **13,575.00** ,

Payment to be made as follows:

**To be paid in full at completion**

All material is guaranteed to be as specified. All work to be completed in a substantial workmanlike manner according to specifications submitted, per standard practices. Any alteration or deviation from above specifications involving extra costs will be executed only upon written orders, and will become an extra charge over and above the estimate. All agreements contingent upon strikes, accidents or delays beyond our control. Owner to carry fire, tornado and other necessary insurance. Our workers are fully covered by Workman's Compensation Insurance.

Authorized  
Signature

Note: This proposal may be withdrawn by us if not accepted within **30** days.

TERMS: Accounts being over 30 days add 1 1/2 % per month to pay all costs, including attorney fees caused by any collection activity caused by buyers failure to pay for goods and services rendered.

ACCEPTANCE OF PROPOSAL. The above prices, specifications and conditions are satisfactory and are hereby accepted. You are authorized to do the work as specified. Payment will be made as outlined above.

Signature \_\_\_\_\_

Date of Acceptance: \_\_\_\_\_

Signature \_\_\_\_\_



5820 Clarksville Square Drive  
 Clarksville, MD 21029  
 Phone 410-631-6712  
 Fax 410-531-5812

September 17, 2015  
 Revised November 17, 2015

Jim Dejordy  
 5509 Trotter Rd.  
 Clarksville, MD 21029  
 mxwfo@aol.com

Dear Mr. Dejordy,

Thank you for your Interest in Zepp Plumbing & Heating, Inc. We are pleased to quote you the following prices for work to be completed at your residence.

**Job #1: Sewer**

- Supply & Install / Includes:
  - o Approx. 83ft of 4" pvc sewer pipe buried in front yard from foundation wall to connection @ property line.
  - o Approx. 60ft of 4" pvc hung sewer along unfinished basement cinderblock walls to exit @ front wall. (LT and W/M included)
  - o Connect to county sewer and house DWV stack.
  - o Abandon septic tank and drywell per Howard County Health Dept. specifications.
  - o Howard County permit and inspections. (plumbing only)

\*Note\* Per Call Brooks, DPW connection fees are correct as quoted in July 2015.

**Total Cost Job#1: \$10,300.00**

Please initial to accept Job#1: \_\_\_\_\_

**Job #2: Water**

- Supply & Install / Includes:
  - o Approx. 95ft of 1" soft tubing buried in front yard from foundation wall to meter vault at property line.
  - o A pressure reducing valve and connect to existing house main with valves.
  - o Abandon well per Howard County Health Dept. specifications.
  - o Howard County permit and inspections.

**Total Cost Job#2: \$4,600.00**

Please initial to accept Job#2: \_\_\_\_\_

**Options:**

**#1 Water service at later date. \$5,600.00 (Prices good for 90 days, weather permitting.)**

**#2 Sewage ejector pit & pump installed with vent through roof. \$2,895.00**

\*Note\* Zepp Plumbing will search for 30 minutes to locate county sewer and water taps. If not located in 30 minutes, Zepp will advise the homeowner of the extra cost to locate. Zepp relies on county supplied info that is not always accurate or reliable.

**Not Included:**

- Removal of pump and tank from basement
- Area connection charges
- Removal of dirt, replacement of top soil or tamping of ditches
- We will not be responsible for any damage to flowers, lawn, trees, shrubbery, sidewalks, patio, and driveway.
- Any utilities will be carefully excavated around; however it will be the owner's responsibility if damage should occur.
- Any underground obstruction will be worked on a time and material basis or the owner had the option of removing it himself.
- Sewage ejector pit or pump.
- Sub soil/foundation drain repair or replacement
- Electrical
- Carpentry
- Drywall repair or replacement
- Paint

**Note:**

All materials will be installed in a clean and professional manner and installed according to manufacturer's specifications and maintaining all local code requirements. Zepp Plumbing will not be able to warranty customer supplied material. We can only warranty the installation and materials supplied by our company. Installation of customer materials may require additional material & labor costs.

**Payment Schedule:**

Deposit Job #1: <b>\$3,000.00</b>	Balance due upon completion: <b>\$7,300.00</b>
Deposit Job #2: <b>\$1,400.00</b>	Balance due upon completion: <b>\$3,200.00</b>
Options due upon completion.	

We accept Visa, MasterCard, Discover, Amex, Cash, or Check.

Quoted prices are valid for 90 days.

If the above is acceptable please sign below and return one copy along with your deposit. **Work will be scheduled upon receipt of signed proposal & deposit.** Please allow 48-72 business hours in the event that materials need to be ordered. Please call if you have any questions.

Sincerely,



Edgar W. Zepp IV

President  
Zepp Plumbing & Heating, Inc.

Signature: \_\_\_\_\_  
I agree to the prices, terms, and conditions in the above proposal.

Date: \_\_\_\_\_

Office use only

Contract Accepted	Date:
Deposit Received	Date:
Materials Ordered	Date:
Start	Date:
Completion	Date:
Emailed/Mailed	Date:

**CUMBERLAND COMPANY, INC.**  
**Plumbing and Mechanical Contractors**  
**16391 A.E. Mullinix Road**  
**Woodbine, Maryland 21797**  
**Telephone: 301-854-6838**  
**Fax: 301-854-6325**

**PROPOSAL**

Date: December 29, 2015  
Attention: James Dejordy and Jeffrey Williams  
VIA E-MAIL: [jdejordy@howardcountymd.gov](mailto:jdejordy@howardcountymd.gov); [jewilliams@howardcountymd.gov](mailto:jewilliams@howardcountymd.gov)  
Address: 5509 Trotter Rd. Clarksville, MD 21029  
Re: City sewer hook-up and interior plumbing to accommodate city sewer hook-up.  
Reference No.: 0138-15

Complete water per specifications:	\$1,500.00
Complete sewer per specifications:	\$7,665.00
Connect sewer to existing plumbing inside:	\$2,200.00
Abandon existing septic per Howard County Health Dept.:	<u>\$2,000.00</u>
<b>Total:</b>	<b>\$13,365.00</b>

**Specs.:**

1. Waste and vents to be PVC.
2. Sewer to be 4" PVC from existing tap in front yard through foundation wall in front of house approximately 95'.
3. Sewer and water tap fees, not included.
4. Water to be 1" poly from meter vault in front yard through foundation at front of house, approximately 95'.
5. Backfilled to rough grade only.
6. Final grade, seed and straw not included.
7. Existing well to be used for hose connections only.
8. Abandon existing septic and drywell by pumping out and filling with dirt.

NOTE Digging around utilities, per utility: \$95.00  
NOTE Sewer deeper than 9' will be charged as an extra.  
NOTE: Sewer and water tap fees and aid of construction fees approximately \$8,410.00 not included.

**Payment Schedule:**

Payment due 15 days from invoice date. Failure to pay in a timely fashion will result in cessation of work, to commence again only when bill is paid in full. We reserve the right to charge interest on past-due invoices at the rate of five per cent (5%), plus collection of reasonable attorneys' fees.

1. Permitting and deposit:	\$2,000.00
----------------------------	------------

- |  |            |
|--|------------|
| 2. Sewer and water inspection and backfill:  | \$7,165.00 |
| 3. Interior plumbing connected to new sewer: | \$2,200.00 |
| 4. Existing septic and well abandoned:       | \$2,000.00 |

Materials herein listed are warranted to be free from defects under normal conditions and service for a period of one year from completion of work. Workmanship is warranted to be free from defects under normal conditions and service for a period of one year. All of our materials are WSSC and state approved.

It is hereby expressly provided that any and all deviations from the plans and specifications upon which this estimate is made, and which shall require additional labor and material, shall be treated as an extra. Both parties shall agree upon cost in writing before such work is performed.

This proposal is based on normal earth excavating. If rock or other hazards are encountered, additional costs of excavating will be paid by others. We assume no liability for sod, utility lines, sidewalks or other obstructions placed in our way prior to such installations. It shall be the responsibility of others to establish proper elevation of basement so that proper grade of house sewer may be run. The undersigned shall not be required to replace materials stolen from job after they have been installed.

**NOTE:**

Sewer and water included in price.

Plumbing permits are included in this price.

Any additional pricing or bids needed please do not hesitate to call for an immediate response.

Pricing subject to change after 60 days of Proposal date.

SUBMITAL: *H. Campbell* DATE: *12-29-15*

ACCEPTANCE: \_\_\_\_\_

The foregoing is hereby accepted this \_\_\_\_\_ day of \_\_\_\_\_, 2015.

0138-15 d/c C.C.I.2/Proposals/Dejordy

OFFICE USE ONLY

OFFICE USE ONLY

**SEWER CONNECTION APPLICATION  
HOWARD COUNTY  
DEPARTMENT OF PUBLIC WORKS  
3430 COURT HOUSE DRIVE ELLICOTT CITY, MD 21043**

CONTROL NO.: \_\_\_\_\_  
 PERMIT NO.: \_\_\_\_\_  
 INSPECTED BY: \_\_\_\_\_  
 DATE INSPECTED: \_\_\_\_\_

APPLICATION NO.: \_\_\_\_\_  
 CONTRACT NO.: 4805  
 REBATE CONTRACT NO.: \_\_\_\_\_  
 SEWER ZONE: \_\_\_\_\_  
 CONNECTION WORKSHEET Y \_\_\_N \_\_\_

Account No. \_\_\_\_\_

FILL OUT APPLICATION COMPLETELY AND SIGN BELOW. IF LOCATION INFORMATION IS UNKNOWN, CONTACT THE OFFICE OF PLANNING AND ZONING (DPZ) FOR HOUSE NUMBER, STREET NAME, ETC. NOTE: COMMERCIAL AND INDUSTRIAL FACILITIES MAY BE SUBJECT TO REQUIREMENTS OF THE COUNTY CODE FOR SEWER SURCHARGES, INDUSTRIAL COST RECOVERY CHARGES, AND PRETREATMENT.

Application is hereby made for a water house connection to the property described below.

DATE OF APPLICATION \_\_\_\_\_

SUBDIVISION Trotter Ridge SECTION \_\_\_\_\_ AREA \_\_\_\_\_ LOT \_\_\_\_\_ BLOCK \_\_\_\_\_  
 HOUSE NO. 5509 STREET Trotter Rd TAX MAP \_\_\_\_\_ GRID \_\_\_\_\_ PARCEL \_\_\_\_\_  
 CITY, STATE Clarksville ZIP CODE 21029 PHONE NO. 240-485-4468  
 NEW OR EXISTING BUILDING? Existing USE (SEE PROPERTY CLASSIFICATIONS ON REVERSE SIDE) \_\_\_\_\_

ITEMS CHECK	CONNECTION TYPE	CON. DIA.	CHARGES DESCRIPTION	CHARGES AMOUNT	FUND	BA	G/L
<input checked="" type="checkbox"/>	SEWER CONNECTION	4"	INSTALLATION	\$4500.00	701009000	3100	431185
<input type="checkbox"/>	SEWER CONNECTION	6"	INSTALLATION		7010009000	3100	431185
<input type="checkbox"/>	SEWER CONNECTION	8"	INSTALLATION - ADO		7010003000	1300	102998
<input type="checkbox"/>			IN-AID-OF CONSTRUCTION AMOUNT CHARGED BASED ON METER SIZE	\$600.00	7030015100	3100	422000
<input type="checkbox"/>	ADO OR SURETY #		ADVANCED DEPOSIT ORDER OR SURETY DEPOSIT AMOUNT		7010003000	1300	102998
<input type="checkbox"/>			INSPECTION FEE AND PERMIT FEE		7010010000	3100	431105

\*Refer to DPZ for estimates of Advanced Deposit (ADO). For installations requiring an ADO, the owner must enter into a cost agreement with Howard County prior to the commencement of any installation work.

**\$5700.00**  
 TOTAL DUE

DATE \_\_\_\_\_  
 CR # \_\_\_\_\_

THE INFORMATION REQUESTED BELOW MUST BE LEGIBLE FOR BILLING/REFUND PURPOSES.

COMPANY NAME \_\_\_\_\_  
 COMPANY ADDRESS \_\_\_\_\_  
 OWNER SIGNATURE \_\_\_\_\_  
 OWNER NAME (PRINT) \_\_\_\_\_  
 OWNER ADDRESS \_\_\_\_\_

**FULL FEE MUST ACCOMPANY THIS COMPLETE APPLICATION, MAKE CHECKS PAYABLE TO: DIRECTOR OF FINANCE, HOWARD COUNTY CREDIT CARDS ARE NOT ACCEPTED.**

**THE TERMS & CONDITIONS OF THIS APPLICATION, INCLUDING ANYTHING ON THE REVERSE SIDE HEREOF ARE BINDING UPON THE OWNERS SIGNATURE & ALL SUCCEEDING OWNERS.**

OFFICE USE ONLY

OFFICE USE ONLY

**SEWER CONNECTION APPLICATION  
HOWARD COUNTY  
DEPARTMENT OF PUBLIC WORKS  
3430 COURT HOUSE DRIVE ELLICOTT CITY, MD 21043**

CONTROL NO.: \_\_\_\_\_  
 PERMIT NO.: \_\_\_\_\_  
 INSPECTED BY: \_\_\_\_\_  
 DATE INSPECTED: \_\_\_\_\_

APPLICATION NO.: \_\_\_\_\_  
 CONTRACT NO.: 4805  
 REBATE CONTRACT NO.: \_\_\_\_\_  
 SEWER ZONE: \_\_\_\_\_  
 CONNECTION WORKSHEET Y \_\_\_ N \_\_\_

Account No. \_\_\_\_\_

FILL OUT APPLICATION COMPLETELY AND SIGN BELOW. IF LOCATION INFORMATION IS UNKNOWN, CONTACT THE OFFICE OF PLANNING AND ZONING (DPZ) FOR HOUSE NUMBER, STREET NAME, ETC. NOTE: COMMERCIAL AND INDUSTRIAL FACILITIES MAY BE SUBJECT TO REQUIREMENTS OF THE COUNTY CODE FOR SEWER SURCHARGES, INDUSTRIAL COST RECOVERY CHARGES, AND PRETREATMENT.

Application is herewith made for a water house connection to the property described below.

SUBDIVISION Trotter Ridge SECTION \_\_\_\_\_ AREA \_\_\_\_\_ LOT \_\_\_\_\_ BLOCK \_\_\_\_\_  
 HOUSE NO. 5509 STREET Trotter Rd TAX MAP \_\_\_\_\_ GRID \_\_\_\_\_ PARCEL \_\_\_\_\_  
 CITY, STATE Clarksville ZIP CODE 21029 PHONE NO. 240-485-4468  
 NEW OR EXISTING BUILDING? Existing USE (SEE PROPERTY CLASSIFICATIONS ON REVERSE SIDE)

ITEMS CHECK	CONNECTION TYPE	CON. DIA.	CHARGES DESCRIPTION	CHARGES AMOUNT	FUND	BA	G/L
<input checked="" type="checkbox"/>	SEWER CONNECTION	4"	INSTALLATION	\$14500.00	701009000	3100	431185
<input type="checkbox"/>	SEWER CONNECTION	6"	INSTALLATION		7010009000	3100	431185
<input type="checkbox"/>	SEWER CONNECTION	8"	INSTALLATION - ADO		7010003000	1300	102998
<input type="checkbox"/>			IN-AID-OF CONSTRUCTION AMOUNT CHARGED BASED ON METER SIZE	\$600.00	7030015100	3100	422000
<input type="checkbox"/>	ADO OR SURETY #		ADVANCED DEPOSIT ORDER OR SURETY DEPOSIT AMOUNT		7010003000	1300	102998
<input type="checkbox"/>			INSPECTION FEE AND PERMIT FEE		7010010000	3100	431105

\*Refer to DPZ for estimates of Advanced Deposit (ADO). For installations requiring an ADO, the owner must enter into a cost agreement with Howard County prior to the commencement of any installation work.

**\$5700.00**  
TOTAL DUE

DATE \_\_\_\_\_  
 CR # \_\_\_\_\_

THE INFORMATION REQUESTED BELOW MUST BE LEGIBLE FOR BILLING/REFUND PURPOSES.

COMPANY NAME \_\_\_\_\_  
 COMPANY ADDRESS \_\_\_\_\_  
 OWNER SIGNATURE \_\_\_\_\_  
 OWNER NAME (PRINT) \_\_\_\_\_  
 OWNER ADDRESS \_\_\_\_\_

**FULL FEE MUST ACCOMPANY THIS COMPLETE APPLICATION, MAKE CHECKS PAYABLE TO: DIRECTOR OF FINANCE, HOWARD COUNTY CREDIT CARDS ARE NOT ACCEPTED.**

**THE TERMS & CONDITIONS OF THIS APPLICATION, INCLUDING ANYTHING ON THE REVERSE SIDE HEREOF ARE BINDING UPON THE OWNERS SIGNATURE & ALL SUCCEEDING OWNERS.**

EXHIBIT D

## Real Property Data Search ( w2)

## Guide to searching the database

Search Result for HOWARD COUNTY

View Map		View GroundRent Redemption			View GroundRent Registration				
<b>Account Identifier:</b>		<b>District - 05 Account Number - 348013</b>							
<b>Owner Information</b>									
<b>Owner Name:</b>		DEJORDY JOSEPH P AND WF			<b>Use:</b>		RESIDENTIAL		
<b>Mailing Address:</b>		4299 SE BRITTNEY CIR PORT SAINT LUCIE FL 34952-			<b>Principal Residence:</b>		NO		
					<b>Deed Reference:</b>		/00349/ 00349		
<b>Location &amp; Structure Information</b>									
<b>Premises Address:</b>		5509 TROTTER RD CLARKSVILLE 21029-0000			<b>Legal Description:</b>		LOT 6 1.10 A. 5509 TROTTER RD CRISWOOD MANOR S4		
<b>Map:</b>	<b>Grid:</b>	<b>Parcel:</b>	<b>Sub District:</b>	<b>Subdivision:</b>	<b>Section:</b>	<b>Block:</b>	<b>Lot:</b>	<b>Assessment Year:</b>	<b>Plat No:</b>
0029	0020	0088		0000			6	2014	Plat Ref:
<b>Special Tax Areas:</b>					<b>Town:</b>		NONE		
					<b>Ad Valorem:</b>		101		
					<b>Tax Class:</b>				
<b>Primary Structure Built</b>		<b>Above Grade Enclosed Area</b>		<b>Finished Basement Area</b>		<b>Property Land Area</b>		<b>County Use</b>	
1959		1,323 SF				1.1000 AC			
<b>Stories</b>	<b>Basement</b>	<b>Type</b>		<b>Exterior</b>	<b>Full/Half Bath</b>	<b>Garage</b>	<b>Last Major Renovation</b>		
1	YES	STANDARD UNIT		BRICK	1 full	1 Attached			
<b>Value Information</b>									
		<b>Base Value</b>		<b>Value As of 01/01/2014</b>		<b>Phase-in Assessments As of 07/01/2015</b>		<b>As of 07/01/2016</b>	
<b>Land:</b>		276,000		276,000					
<b>Improvements</b>		86,600		94,800					
<b>Total:</b>		362,600		370,800		368,067		370,800	
<b>Preferential Land:</b>		0						0	
<b>Transfer Information</b>									
<b>Seller:</b>		<b>Date:</b>			<b>Price:</b>				
<b>Type:</b>		<b>Deed1:</b>			<b>Deed2:</b>				
<b>Seller:</b>		<b>Date:</b>			<b>Price:</b>				
<b>Type:</b>		<b>Deed1:</b>			<b>Deed2:</b>				
<b>Seller:</b>		<b>Date:</b>			<b>Price:</b>				
<b>Type:</b>		<b>Deed1:</b>			<b>Deed2:</b>				
<b>Exemption Information</b>									
<b>Partial Exempt Assessments:</b>		<b>Class</b>		<b>07/01/2015</b>		<b>07/01/2016</b>			
<b>County:</b>		000		0.00					
<b>State:</b>		000		0.00					
<b>Municipal:</b>		000		0.00 0.00		0.00 0.00			
<b>Tax Exempt:</b>					<b>Special Tax Recapture:</b>				
<b>Exempt Class:</b>					NONE				
<b>Homestead Application Information</b>									
<b>Homestead Application Status: No Application</b>									

1. This screen allows you to search the Real Property database and display property records.
2. Click [here](#) for a glossary of terms.
3. Deleted accounts can only be selected by Property Account Identifier.
4. The following pages are for information purpose only. The data is not to be used for legal reports or documents. While we have confidence in

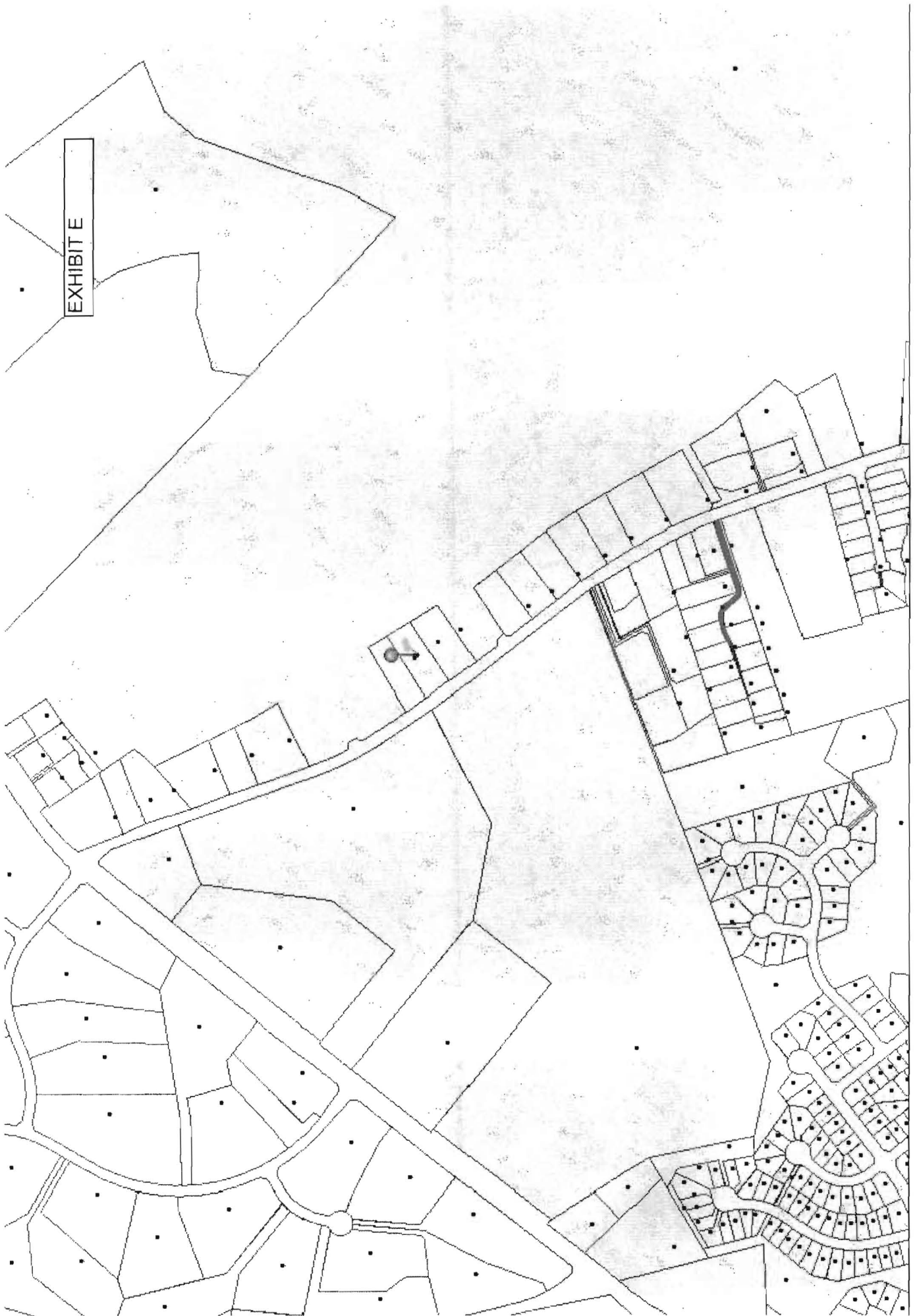
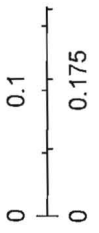

EXHIBIT E



PFA  
PFA Comment Area

al PFA