

C1 7135 SEQUENCE NO. (MDE USE ONLY)

STATE OF MARYLAND WELL COMPLETION REPORT FILL IN THIS FORM COMPLETELY PLEASE TYPE

THIS REPORT MUST BE SUBMITTED WITHIN 45 DAYS AFTER WELL IS COMPLETED.

COUNTY NUMBER A21989

ST/CO USE ONLY DATE RECEIVED MM DD YY 06 30 08

Depth of Well 22 240 26 (TO NEAREST FOOT)

PERMIT NO. FROM "PERMIT TO DRILL WELL" HO - 95 - 1632

OWNER Wick Karen last name first name STREET OR RFD 740 Middle Trail Ct. TOWN Mt. Airy, Md. 21771 SUBDIVISION SECTION LOT 15 B

WELL LOG Not required for driven wells

STATE THE KIND OF FORMATIONS PENETRATED, THEIR COLOR, DEPTH, THICKNESS AND IF WATER BEARING. Existing Well tag # HO-73-41 23 Casing was cut off 5' below grade 1" Geothermal Loop Installed Sealed with Bentonite From 240' to top of well

GROUTING RECORD

WELL HAS BEEN GROUTED (Circle Appropriate Box) YES Y NO N TYPE OF GROUTING MATERIAL (Circle one) CEMENT CM BENTONITE CLAY BC NO. OF BAGS 18 NO. OF POUNDS 700 GALLONS OF WATER 324 DEPTH OF GROUT SEAL (to nearest foot) from 0 ft. to 240 ft.

CASING RECORD

MAIN CASING TYPE of 1" Geothermal Loop Nominal diameter top (main) casing (nearest inch)! Total depth of main casing (nearest foot)

OTHER CASING (if used) diameter inch depth (feet) from to

SCREEN RECORD screen type or open hole (insert appropriate code below) ST STEEL BR BRASS PL PLASTIC HO OPEN HOLE OT OTHER

DEPTH (nearest ft.) 1 2 3 4 5 6 7 8 9 10 11 12 13 14 15 16 17 18 19 20 21 22 23 24 25 26 27 28 29 30 31 32 33 34 35 36 37 38 39 40 41 42 43 44 45 46 47 48 49 50 51 52 53 54 55 56 57 58 59 60 61 62 63 64 65 66 67 68 69 70 71 72 73 74 75 76 77 78 79 80

GRAVEL PACK IF WELL DRILLED WAS FLOWING WELL INSERT F IN BOX 68

MDE USE ONLY (NOT TO BE FILLED IN BY DRILLER) T (E.R.O.S.) W Q 70 72 74 75 76 TELESCOPE CASING LOG INDICATOR OTHER DATA

PUMPING TEST

HOURS PUMPED (nearest hour) 0 PUMPING RATE (gal. per min.) 11 15 METHOD USED TO MEASURE PUMPING RATE 0 WATER LEVEL (distance from land surface) BEFORE PUMPING 17 20 ft. WHEN PUMPING 22 25 ft. TYPE OF PUMP USED (for test) A air P piston T turbine C centrifugal R rotary O other J jet S submersible

PUMP INSTALLED

DRILLER INSTALLED PUMP YES NO IF DRILLER INSTALLS PUMP, THIS SECTION MUST BE COMPLETED FOR ALL WELLS. TYPE OF PUMP INSTALLED PLACE (A,C,J,P,R,S,T,O) IN BOX 29 CAPACITY: GALLONS PER MINUTE (to nearest gallon) 31 35 PUMP HORSE POWER 37 41 PUMP COLUMN LENGTH (nearest ft.) 43 47 CASING HEIGHT (circle appropriate box and enter casing height) LAND SURFACE below 5' (nearest foot)

LOCATION OF WELL ON LOT SHOW PERMANENT STRUCTURE SUCH AS BUILDING, SEPTIC TANKS, AND /OR LANDMARKS AND INDICATE NOT LESS THAN TWO DISTANCES (MEASUREMENTS TO WELL)

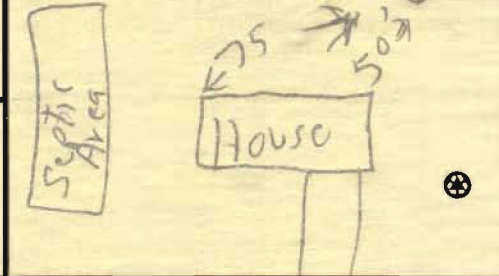

NUMBER OF UNSUCCESSFUL WELLS: 0

WELL HYDROFRACTURED YES Y NO N

CIRCLE APPROPRIATE LETTER A A WELL WAS ABANDONED AND SEALED WHEN THIS WELL WAS COMPLETED E ELECTRIC LOG OBTAINED P TEST WELL CONVERTED TO PRODUCTION WELL

I HEREBY CERTIFY THAT THIS WELL HAS BEEN CONSTRUCTED IN ACCORDANCE WITH COMAR 26.04.04 "WELL CONSTRUCTION" AND IN CONFORMANCE WITH ALL CONDITIONS STATED IN THE ABOVE CAPTIONED PERMIT, AND THAT THE INFORMATION PRESENTED HEREIN IS ACCURATE AND COMPLETE TO THE BEST OF MY KNOWLEDGE.

DRILLERS LIC. NO. 1 M S D 0 0 6 1

DRILLERS SIGNATURE (MUST MATCH SIGNATURE ON APPLICATION)

LIC. NO. 1 D

SITE SUPERVISOR (sign. of driller or journeyman responsible for sitework if different from permittee)

C1 **7136** SEQUENCE NO. (MDE USE ONLY)

**STATE OF MARYLAND**  
**WELL COMPLETION REPORT**  
 FILL IN THIS FORM COMPLETELY  
 PLEASE TYPE

THIS REPORT MUST BE SUBMITTED WITHIN  
 45 DAYS AFTER WELL IS COMPLETED.  
 COUNTY NUMBER **A21989**

ST/CO USE ONLY  
 DATE RECEIVED  
 MM DD YY  
 8 13

DATE WELL COMPLETED  
 MM DD YY  
 06 30 08

Depth of Well  
 22 **250** 26  
 (TO NEAREST FOOT)

PERMIT NO.  
 FROM "PERMIT TO DRILL WELL"  
 HO 05 1632  
 28 29 30 31 32 33 34 35 36 37

OWNER Wick Karen  
 STREET OR RFD 740 Middle Trail Ct. TOWN Mt. Airy Md. 21771  
 SUBDIVISION \_\_\_\_\_ SECTION \_\_\_\_\_ LOT 158

**WELL LOG**  
 Not required for driven wells

STATE THE KIND OF FORMATIONS PENETRATED, THEIR COLOR, DEPTH, THICKNESS AND IF WATER BEARING

DESCRIPTION (Use additional sheets if needed)	FEET		check if water bearing
	FROM	TO	
tan Brown Shale	0	20	
Gray Green Schist	20	250	
1" Geothermal Loop Installed sealed with Bentonite From Bottom to top			

**GROUTING RECORD** yes no  
 WELL HAS BEEN GROUTED (Circle Appropriate Box) **Y** **N**  
 TYPE OF GROUTING MATERIAL (Circle one)  
 CEMENT **CM** BENTONITE CLAY **BC**  
 NO. OF BAGS 18 NO. OF POUNDS 700  
 GALLONS OF WATER 324  
 DEPTH OF GROUT SEAL (to nearest foot)  
 from 0 TOP 52 ft. to 250 BOTTOM 58 ft.  
 (enter 0 if from surface)

**CASING RECORD**  
 casing types insert appropriate code below  
**ST** STEEL **CO** CONCRETE  
**PL** PLASTIC **OT** OTHER  
 MAIN CASING TYPE Nominal diameter top (main) casing (nearest inch) Total depth of main casing (nearest foot)  
OT 1" Geothermal Loop 60 61 63 64 66 70

**OTHER CASING (if used)**  
 diameter depth (feet)  
 inch from to

**SCREEN RECORD**  
 screen type or open hole insert appropriate code below  
**ST** STEEL **BR** BRASS **HO** OPEN HOLE  
**PL** PLASTIC **OT** OTHER

NUMBER OF UNSUCCESSFUL WELLS: 0

WELL HYDROFRACTURED **Y** **N**

CIRCLE APPROPRIATE LETTER  
**A** A WELL WAS ABANDONED AND SEALED WHEN THIS WELL WAS COMPLETED  
**E** ELECTRIC LOG OBTAINED  
**P** TEST WELL CONVERTED TO PRODUCTION WELL

I HEREBY CERTIFY THAT THIS WELL HAS BEEN CONSTRUCTED IN ACCORDANCE WITH COMAR 26.04.04 "WELL CONSTRUCTION" AND IN CONFORMANCE WITH ALL CONDITIONS STATED IN THE ABOVE CAPTIONED PERMIT, AND THAT THE INFORMATION PRESENTED HEREIN IS ACCURATE AND COMPLETE TO THE BEST OF MY KNOWLEDGE.

DRILLERS LIC. NO. MS D 006  
 DRILLERS SIGNATURE [Signature]  
 (MUST MATCH SIGNATURE ON APPLICATION)

LIC. NO. D

SITE SUPERVISOR (sign. of driller or journeyman responsible for sitework if different from permittee)

**C 2** DEPTH (nearest ft.)  
 1 2  
0 sealed with Bentonite Grout  
 E 8 9 11 15 17 21  
 A 23 24 26 30 32 36  
 H 38 39 41 45 47 51  
 S  
 R  
 C 3  
 E  
 N  
 SLOT SIZE 1 \_\_\_\_\_ 2 \_\_\_\_\_ 3 \_\_\_\_\_  
 DIAMETER OF SCREEN 1" Geo Loop (NEAREST INCH)  
 56 60  
 from to

GRAVEL PACK IF WELL DRILLED WAS FLOWING WELL INSERT F IN BOX 68

MDE USE ONLY (NOT TO BE FILLED IN BY DRILLER)  
 T \_\_\_\_\_ (E.R.O.S.) W Q \_\_\_\_\_  
 70 \_\_\_\_\_ 72 \_\_\_\_\_ 74 75 76  
 TELESCOPE CASING LOG INDICATOR OTHER DATA

**C 3** **PUMPING TEST**  
 1 2  
 HOURS PUMPED (nearest hour) 0  
 8 9  
 PUMPING RATE (gal. per min.) 0  
 11 15  
 METHOD USED TO MEASURE PUMPING RATE 0  
 WATER LEVEL (distance from land surface)  
 BEFORE PUMPING 0 ft.  
 17 20  
 WHEN PUMPING 0 ft.  
 22 25  
 TYPE OF PUMP USED (for test)  
**A** air **P** piston **T** turbine  
**C** centrifugal **R** rotary **O** other (describe below)  
**J** jet **S** submersible

**PUMP INSTALLED**  
 DRILLER INSTALLED PUMP YES **N**  
 (CIRCLE) (YES or NO)  
 IF DRILLER INSTALLS PUMP, THIS SECTION MUST BE COMPLETED FOR ALL WELLS.  
 TYPE OF PUMP INSTALLED PLACE (A,C,J,P,R,S,T,O) IN BOX 29. 29  
 CAPACITY: GALLONS PER MINUTE (to nearest gallon) 31 35  
 PUMP HORSE POWER 37 41  
 PUMP COLUMN LENGTH (nearest ft.) 43 47  
 CASING HEIGHT (circle appropriate box and enter casing height)  
**+** above } LAND SURFACE  
**-** below } 4 (nearest foot)  
 49 51

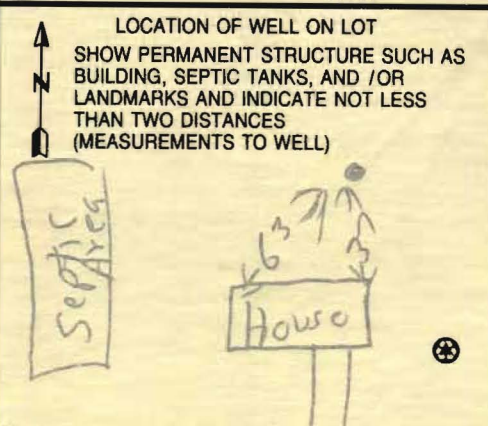

C1 7137

SEQUENCE NO. (MDE USE ONLY)

STATE OF MARYLAND WELL COMPLETION REPORT

THIS REPORT MUST BE SUBMITTED WITHIN 45 DAYS AFTER WELL IS COMPLETED.

(THIS NUMBER IS TO BE PUNCHED IN COLS. 3-6 ON ALL CARDS)

COUNTY NUMBER A21989

ST/CO USE ONLY DATE Received MM DD YY

DATE WELL COMPLETED MM DD YY 07 1 08

Depth of Well 22 250 26 (TO NEAREST FOOT)

PERMIT NO. FROM "PERMIT TO DRILL WELL" HO 95 1632

OWNER Wick last name Karon first name STREET OR RFD 740 Middle Trail Ct. TOWN Mt. Airy Md 21771 SUBDIVISION SECTION LOT 15B

WELL LOG Table with columns: DESCRIPTION, FEET (FROM, TO), check if water bearing. Includes handwritten entries: Tan Brown Shale (0-20), Gray Green Schist (20-250), 1" Geothermal Loop Installed sealed with Bentonite from bottom to top.

GROUTING RECORD Form: WELL HAS BEEN GROUTED (Y), TYPE OF GROUTING MATERIAL (CM, BC), NO. OF BAGS (18), NO. OF POUNDS (700), GALLONS OF WATER (324), DEPTH OF GROUT SEAL (0-250).

CASING RECORD Form: casing types insert appropriate code below (ST, CO, PL, OT), MAIN CASING TYPE (OT), Nominal diameter top (main) casing (1" Geothermal Loop), Total depth of main casing (nearest foot) (70).

OTHER CASING (if used) Form: diameter inch, depth (feet) from to.

SCREEN RECORD Form: screen type or open hole (ST, BR, HO, PL, OT), insert appropriate code below.

NUMBER OF UNSUCCESSFUL WELLS: 0

WELL HYDROFRACTURED (Y) (N)

- CIRCLE APPROPRIATE LETTER: A WELL WAS ABANDONED AND SEALED WHEN THIS WELL WAS COMPLETED; E ELECTRIC LOG OBTAINED; P TEST WELL CONVERTED TO PRODUCTION WELL.

I HEREBY CERTIFY THAT THIS WELL HAS BEEN CONSTRUCTED IN ACCORDANCE WITH COMAR 26.04.04 "WELL CONSTRUCTION" AND IN CONFORMANCE WITH ALL CONDITIONS STATED IN THE ABOVE CAPTIONED PERMIT...

DRILLERS LIC. NO. 1 MSD 0061

DRILLERS SIGNATURE (Must match signature on application)

LIC. NO. 1 D

SITE SUPERVISOR (sign. of driller or journeyman responsible for sitework if different from permittee)

DEPTH (nearest ft.) Form: 1 2 of sealed with Bentonite Grout; 3 4 5 6 7 8 9 10 11 12 13 14 15 16 17 18 19 20 21 22 23 24 25 26 27 28 29 30 31 32 33 34 35 36 37 38 39 40 41 42 43 44 45 46 47 48 49 50 51 52 53 54 55 56 57 58 59 60 61 62 63 64 65 66 67 68 69 70 71 72 73 74 75 76 77 78 79 80 81 82 83 84 85 86 87 88 89 90 91 92 93 94 95 96 97 98 99 100

GRAVEL PACK IF WELL DRILLED WAS FLOWING WELL INSERT F IN BOX 68

MDE USE ONLY (NOT TO BE FILLED IN BY DRILLER) T (E.R.O.S.) W Q

TELESCOPE CASING LOG INDICATOR OTHER DATA

PUMPING TEST Form: HOURS PUMPED (nearest hour) 0; PUMPING RATE (gal. per min.) 0; METHOD USED TO MEASURE PUMPING RATE 0; WATER LEVEL (distance from land surface) BEFORE PUMPING 0 ft, WHEN PUMPING 0 ft; TYPE OF PUMP USED (for test) A air, P piston, T turbine, C centrifugal, R rotary, O other, J jet, S submersible.

PUMP INSTALLED Form: DRILLER INSTALLED PUMP (YES NO), IF DRILLER INSTALLS PUMP, THIS SECTION MUST BE COMPLETED FOR ALL WELLS. TYPE OF PUMP INSTALLED PLACE (A,C,J,P,R,S,T,O) IN BOX 29. CAPACITY: GALLONS PER MINUTE (to nearest gallon) 31 35; PUMP HORSE POWER 37 41; PUMP COLUMN LENGTH (nearest ft.) 43 47; CASING HEIGHT (circle appropriate box and enter casing height) + above, - below, LAND SURFACE 4' (nearest foot).

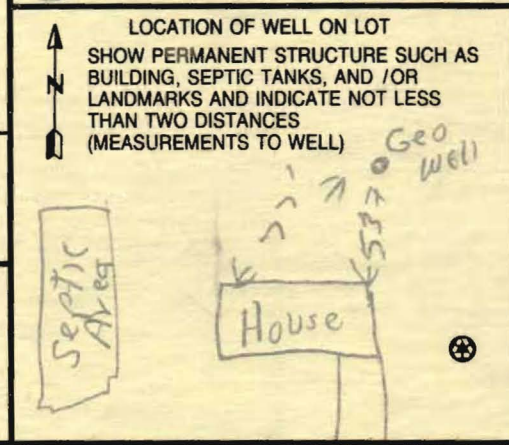

B 1 4853

SEQUENCE NO. (MDE USE ONLY)

STATE OF MARYLAND APPLICATION FOR PERMIT TO DRILL WELL

STATE PERMIT NUMBER

HO-95-1632

528984 please type

fill in this form completely

Date Received (APA)

OWNER INFORMATION

8 MM DD YY 13

Wick Karen 740 middletrail ct. Mt Airy md 21771

B 3

LOCATION OF WELL

Howard 21 15-B Woodbine 71 2

DRILLER INFORMATION

Randall L. Alexander MS D 006 Alexander's Well Drilling 125 W. Main St. P.O. Box 443 Fairfield PA 17320

B 4

DIRECTION OF WELL FROM TOWN (CIRCLE BOX)

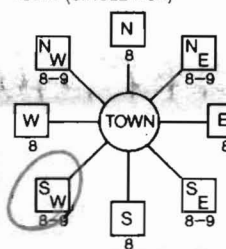

740 middletrail ct. 30

ON WHICH SIDE OF ROAD (CIRCLE APPROPRIATE BOX)



500 FT 38 39

TAX MAP: 2 BLK: 23 PARCEL 197

B 2

WELL INFORMATION

APPROX. PUMPING RATE 0 GAL. PER MIN. AVERAGE DAILY QUANTITY NEEDED 0 GAL. PER DAY

USE FOR WATER (CIRCLE APPROPRIATE BOX)

- DOMESTIC POTABLE SUPPLY & RESIDENTIAL IRRIGATION, FARMING, INDUSTRIAL, PUBLIC WATER SUPPLY WELL, TEST, OBSERVATION, MONITORING, GEO-THERMAL

NOT TO BE FILLED IN BY DRILLER HEALTH DEPARTMENT APPROVAL

Howard 12/19/89 COUNTY NAME COUNTY NO. STATE SIGNATURE INSERT S DATE ISSUED 6/13/08 CO SIGNATURE EXP. DATE NORTH GRID 552 EAST GRID 776

APPROXIMATE DEPTH OF WELL 250 FEET

APPROXIMATE DIAMETER OF WELL 6 NEAREST INCH

METHOD OF DRILLING (circle one)

- BORED (or Augered), AIR-ROTary, CABLE, JETTED, AIR-PERCussion, REVERSE-ROTary, ROTARY (Hydraulic Rotary), DRIVE-POINT

REPLACEMENT OR DEEPEMED WELLS (CIRCLE APPROPRIATE BOX)

- THIS WELL WILL NOT REPLACE AN EXISTING WELL, THIS WELL WILL REPLACE A WELL THAT WILL BE ABANDONED AND SEALED, THIS WELL WILL REPLACE A WELL THAT WILL BE USED AS A STANDBY-CONTACT LOCAL APPROVING AUTHORITY FOR POLICY ON STANDBY WELLS, THIS WELL WILL DEEPEMED AN EXISTING WELL

PERMIT NUMBER OF WELL TO BE REPLACED OR DEEPEMED (IF AVAILABLE)

Not to be filled in by driller (MDE OR COUNTY USE ONLY)

APPROP. PERMIT NUMBER PERMIT No. HO-95-1632

SPECIAL CONDITIONS

Use COMAR approved joint bottom to top

SHOW MAJOR FEATURES OF BOX & LOCATE WELL WITH AN X

SOURCES OF DRILLING WATER

- Well water

WRITE THE BOX NUMBER FROM THE MAP HERE

E 776 N 552

DRAW A SKETCH BELOW SHOWING LOCATION OF WELL IN RELATION TO NEARBY TOWNS AND ROADS AND GIVE DISTANCE FROM WELL TO NEAREST ROAD JUNCTION

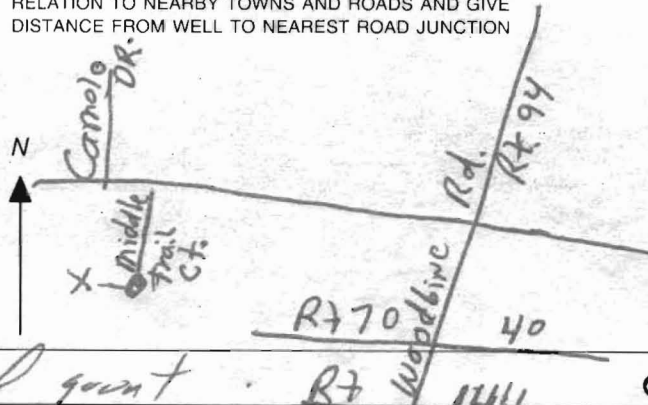





740 Middletrail Court  
Mount Airy, MD 21771

Sara Sappington  
Howard County Health Department – Environmental Health  
7178 Columbia Gateway Drive  
Columbia, MD 21046

April 22, 2008

Dear Ms. Sappington:

This letter is to notify you of our intent to repurpose well HO-73-3957 for geothermal usage. This will satisfy the requirement to abandon the well located at 740 Middletrail Court. This option was discussed with Stuart Oster on March 7, 2008 in a phone conversation.

The existing well's bore hole will be fitted with the piping and grout required for a geothermal vertical loop. The heat exchange done by a geothermal system is within a closed loop and does not transfer any water from the ground. The nitrates in well HO-73-3957 will be contained in the closed well and not accessible for human consumption.

Attached you will find the signed contract with Lind Heating and Cooling, Inc. for the installation of a geothermal heating and cooling system at 740 Middletrail Court, utilizing well HO-73-3957 as part of the vertical loop. (Reference on page 2, "the 240' abandoned well")

Also included is a copy of the plot plan showing the proposed wells for the geothermal vertical loop.

Our building permit application was submitted April 22.

Sincerely,



Karen Hensei Wick

.cc Stuart Oster

.enci 2



Proposal

# Lind Heating & Cooling, Inc.

11720 Good Intent Road  
Keymar, MD 21757  
Ph.(301)898-7754 Fax(301)845-7799  
HVAC #6395 MHIC #31039

March 25, 2008

Karen & Bryant Wick  
740 Middletrail Court  
Mt. Airy, MD 21771

Estimate to install geothermal heating and cooling to condition existing home and new addition.

**New addition:**

- 1-WaterFurnace NDV026A111CT L/R 2 ton 2 stage variable speed Envision R410A heat pump
- 1-WaterFurnace EAL10 10kw heater package
- 1-WaterFurnace APF2634 isolation pad
- 1-WaterFurnace TA32W01 electronic non programmable thermostat
- 1-WaterFurnace FC1-FPT flow center
- 1-WaterFurnace MA5PES fusion adapters
- 1-WaterFurnace CK4L hose connector kit
- 1-WaterFurnace EAF242 electrostatic air cleaner
- all HDPE loop piping and fittings needed to install vertical loop, header, piping to house and flow center
- fusion, flush/purge, charge with antifreeze/water mixture as needed
- condensate drain
- all low voltage wiring
- duct system typical- install in garage. All sheet metal duct supply/return, branch line round pipe and/or flexible insulated duct, floor supply register, returns 1 each bedroom only (verify in field)
- all labor and miscellaneous materials needed to complete new addition system

**TOTAL new addition system.....\$16,515.00**

**Existing home:**

- 1-WaterFurnace NDV038111CT R/L 3 ton 2 stage variable speed R410A Envision heat pump
- 1-WaterFurnace EAL15 15kw heater package
- 1-WaterFurnace APF2634 isolation pad
- 1-WaterFurnace TA32W01 electronic non programmable thermostat
- 1-WaterFurnace FC1FPT flow center

***Not responsible for damage to plaster walls/ceilings as a result of work performed.***

Please send 1/3 of total money due for down payment, 1/3 when rough in is complete, balance due upon completion of job. This proposal may be withdrawn by us if not accepted within thirty days.

All material is guaranteed to be as specified. All work to be completed in a workmanlike manner according to standard practices. Any alteration or deviation from above specifications involving extra costs will be executed only upon written orders, and will become an extra charge over and above the estimate.

All agreements contingent upon strikes, accidents, or delays beyond our control. Owner to carry fire, tornado, and other necessary insurance. Our workers are fully covered by Workman's

Compensation Insurance.

Authorized Signature Brian Lind

Acceptance Bryant D Wick

Date \_\_\_\_\_

Please sign and return one copy.



Proposal

# Lind Heating & Cooling, Inc.

11720 Good Intent Road  
Keymar, MD 21757  
Ph.(301)898-7754 Fax(301)845-7799  
HVAC #6395 MHIC #31039

- 1-WaterFurnace MASPES fusion adapter
  - 1-WaterFurnace CK4L hose connector kit
  - 1-WaterFurnace EAF2830 electrostatic air cleaner
  - all HDPE loop piping and fittings needed to install vertical loops, header, piping to house and flow centers
  - fusion, flush/purge, charge with antifreeze/water mixture as needed
  - condensate drain
  - all low voltage wiring
  - redo existing duct system-centralize new equipment. Duct system typical basement installation all sheet metal duct supply/return, branch lines round pipe and or flexible insulated duct. Floor register for supply 2 central return 1 each master bedroom area, 1 each general living area (verify in field)
  - all labor and miscellaneous materials needed to complete existing home addition
- TOTAL existing home.....\$17,175.00**

**Well drilling, permits, grouting for both systems.. approximately \$5,900.00**

*Well drilling approximately 2- 250' bores in addition to the 240' abandoned well.  
Homeowner to supply/dig trenches from vertical loop to house, NOT included in price.  
All high voltage wiring to be supplied by others, NOT included in price.  
Drilling debris to be piled up, homeowners responsibility to dispose of.*

- 1 yr. Warranty on all parts/labor.
- 10 yr. Warranty parts/labor on WaterFurnace equipment.
- 5 yr. Warranty parts/labor on WaterFurnace accessories.

***Not responsible for damage to plaster walls/ceilings as a result of work performed.***

Please send 1/3 of total money due for down payment, 1/3 when rough in is complete, balance due upon completion of job. This proposal may be withdrawn by us if not accepted within thirty days.

All material is guaranteed to be as specified. All work to be completed in a workmanlike manner according to standard practices. Any alteration or deviation from above specifications involving extra costs will be executed only upon written orders, and will become an extra charge over and above the estimate.

All agreements contingent upon strikes, accidents, or delays beyond our control. Owner to carry fire, tornado, and other necessary insurance. Our workers are fully covered by Workman's Compensation Insurance.

Authorized Signature Brian Lind

Acceptance Brent D Ward  
Date \_\_\_\_\_

**Please sign and return one copy.**