

**Bureau of Environmental Health**  
 8930 Stanford Boulevard, Columbia, MD 21045  
 Main: 410-313-2640 | Fax: 410-313-2648  
 TDD 410-313-2323 | Toll Free 1-866-313-6300  
[www.hchealth.org](http://www.hchealth.org)

Facebook: [www.facebook.com/hocohealth](http://www.facebook.com/hocohealth)

Maura J. Rossman, M.D., Health Officer

RECEIPT DATE: 9/24/2015      **ONSITE SEWAGE DISPOSAL SYSTEM**      P 557385

APPROVAL DATE: 10-14-15      **PERMIT:**      **REPAIR**      A \_\_\_\_\_

PROPERTY ADDRESS: 14406 Triadelphia Mill Road

SUBDIVISION: Saah Property      LOT: 2      TAX ID: \_\_\_\_\_

CONTRACTOR: Fogle's Septic Clean Inc.      EMAIL: Kevin@foglesinc.com

CONTRACTOR ADDRESS: 580 Obrecht Road, Sykesville, MD 21784      PHONE: 410-795-5670

PROPERTY OWNER: Jeff Yourick      EMAIL: \_\_\_\_\_

OWNER ADDRESS: 14406 Triadelphia Mill Road      PHONE: 410-627-5097

SEPTIC TANK SIZE (GALLONS): Ex.      PUMP CHAMBER CAPACITY (GALLONS): Ex.      PUMP SIZE: \_\_\_\_\_

NUMBER OF BEDROOMS: 5      HOUSE SQ. FT. \_\_\_\_\_      APPLICATION RATE: 1.2

DISTRIBUTION SYSTEM:    GRAVITY FED       LOW PRESSURE DOSED

TRENCHES:	LINEAR FEET REQUIRED: <u>104</u>	INLET DEPTH: <u>3</u>
	TRENCH WIDTH: <u>3</u>	MAXIMUM BOTTOM DEPTH: <u>7</u>
	MINIMUM SPACE BETWEEN TRENCHES: <u>12</u>	EFFECTIVE AREA BEGINNING DEPTH: <u>4</u>
LOCATION:	TO BE STAKED BY SANITARIAN DURING PRE-CONSTRUCTION INSPECTION.	
NOTES:	<p>Ex. system put in clay. Original Perc tests not accurate. Good soil starts at 3.5'-4'. Owner wants system to be sized a little larger. [5BR Design: 750gpd ÷ 1.2gpd/sq.ft = 625 ÷ 3 = 208 (.50) = 104LF]          [6BR Design: 900gpd ÷ 1.2gpd/sq.ft = 750 ÷ 3 = 250 (.50) = 125LF]</p> <p>Install new dist. Box just below existing trenches. Run 3x40' trenches on contour away from house. Future repair area will be further away from house uphill from ex. Barn.</p>	

ISSUED BY: K. Wolf, L.E.H.S.      ISSUE DATE: 10/14/2015      EXPIRATION DATE: 10/14/2016

- NOTE: CONTRACTOR MUST SCHEDULE A PRE-CONSTRUCTION INSPECTION PRIOR TO BEGINNING ANY INSTALLATION
- NOTE: CONTRACTOR MUST SCHEDULE AN INSPECTION AND GAIN APPROVAL OF ALL COMPONENTS PRIOR TO COVERING
- NOTE: STONE MUST BE APPROVED BY HEALTH DEPARTMENT AND GRAVEL TICKET MUST BE AVAILABLE FOR REVIEW,
- NOTE: WATERTIGHT SEPTIC TANKS REQUIRED
- NOTE: ALL PARTS OF SEPTIC SYSTEM SHALL BE AT LEAST 100 FEET DOWNGRADIENT FROM ANY WATER WELL
- NOTE: MANHOLE RISERS REQUIRED ON ALL SEPTIC TANKS AND PUMP CHAMBERS
- NOTE: AN ELECTRICAL PERMIT IS REQUIRED FOR INSTALLATION OF ANY ELECTRICAL COMPONENTS OF THE SYSTEM  
 ELECTRICAL PERMIT ISSUED    E n/a
- NOTE: THE HCHD DOES NOT WARRANTY ANY SYSTEM AND CANNOT GUARANTEE THE PERFORMANCE OF THIS SYSTEM AS DESIGNED. BY ACCEPTING THIS PERMIT, THE OWNER AND/OR APPLICANT ACKNOWLEDGE THAT THE SPECIFICATIONS DETAILED IN THIS DESIGN ARE ONE POSSIBLE OPTION AND THAT THE HCHD WILL REVIEW OTHER PROPOSALS. YOU HAVE THE OPTION TO SEEK THE ADVICE OF A QUALIFIED DESIGN CONSULTANT OR PROFESSIONAL ENGINEER FOR FURTHER GUIDANCE.
- NOTE: MDE RECOMMENDS SEPTIC TANKS, BAT, AND OTHER PRETREATMENT UNITS BE PUMPED AT A FREQUENCY ADEQUATE TO ENSURE THAT SOLIDS ARE NOT DISCHARGED TO THE DISPOSAL AREA

NEITHER THE HOWARD COUNTY COUNCIL NOR THE HEALTH DEPARTMENT IS RESPONSIBLE FOR THE SUCCESSFUL OPERATION OF ANY SYSTEM.  
 PERMITTEE RESPONSIBLE FOR OBTAINING FINAL APPROVAL ON THIS PERMIT.  
 CALL 410-313-1771 TO SCHEDULE INSPECTIONS.

NOT TO SCALE

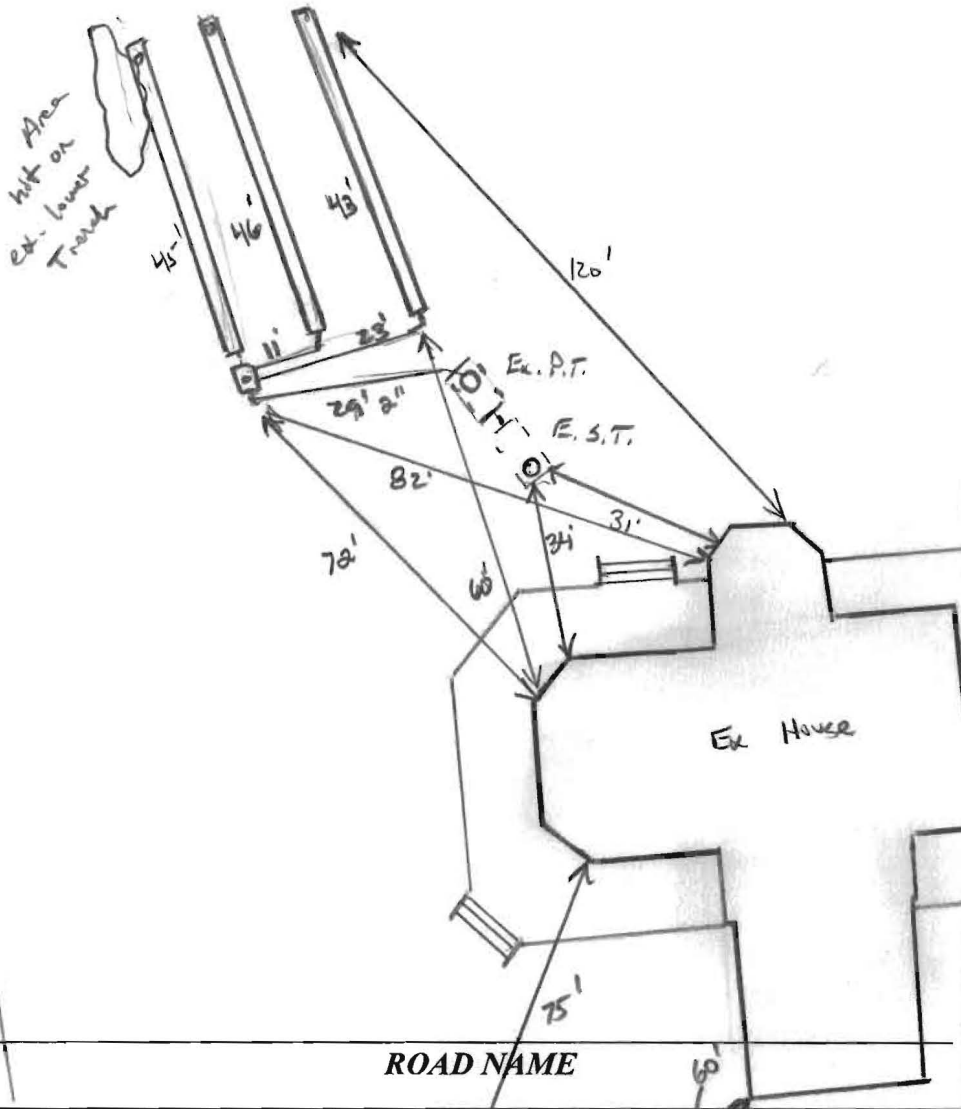

**TRENCH/DRAINFIELD DATA**

WIDTH	INLET	BOTTOM
3'	3'	7'
NUMBER OF TRENCHES		3
TOTAL LENGTH		3
ABSORPTION AREA		
DISTRIBUTION BOX LEVEL		Yes
DISTRIBUTION BOX BAFFLE		90°
DISTRIBUTION BOX PORT		Yes

**SEPTIC TANK DATA**

SEPTIC TANK I LEVEL	Yes (Ex)
MANUFACTURER	?
CAPACITY	1500 GAL
SEAM LOC	Top
TANK LID DEPTH	
BAFFLES	Yes
BAFFLE FILTER	—
MANHOLE LOC	Front
6" PORT LOC	none
WATERTIGHT TEST	OK
SLOTTED	no
DATE ON LID	N/A

**PUMP/SEPTIC TANK LEVEL** Yes (Ex)

MANUFACTURER	—
CAPACITY	1500 GAL
SEAM LOC	Top
TANK LID DEPTH	
BAFFLES	—
BAFFLE FILTER	—
MANHOLE LOC	Center?
6" PORT LOC	none
WATERTIGHT TEST	OK
SLOTTED	no
DATE ON LID	—

**PRE-CONSTRUCTION:**

10/12/15 load out 3 x 40' trenches on contour just below existing failed trenches. 5 BR design w/ 1.2 loading rate only called for 104' but owner wanted a little extra trench. Possibly sized for 6 BR. Trenches flagged in field. (KW)

**INSTALLATION:**

10/14/15 Lower trenches installed. Firm contacted, stated working OK. Alarm verified by Foglar. Top trench dry, encased existing lower trench. Told contractor to excavate and collapse. Should be OK. Depth of inlet in is below trench bottom of ex. tank (HO-94-3014)

OK to come all work when done.

FINAL INSPECTOR

*[Signature]*

DATE OF APPROVAL

10/14/15

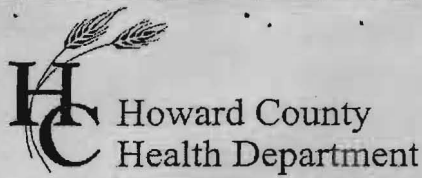

**Bureau of Environmental Health**  
 8930 Stanford Boulevard, Columbia, MD 21045  
 Main: 410-313-2640 | Fax: 410-313-2648  
 TDD 410-313-2323 | Toll Free 1-866-313-6300  
[www.hchealth.org](http://www.hchealth.org)  
 Facebook: [www.facebook.com/hocohealth](http://www.facebook.com/hocohealth)

Maura J. Rossman, M.D., Health Officer

RECEIPT DATE: 9/24/2015 **ONSITE SEWAGE DISPOSAL SYSTEM** P 557385

APPROVAL DATE: \_\_\_\_\_ **PERMIT:** **REPAIR** A \_\_\_\_\_

PROPERTY ADDRESS: 14406 Triadelphia Mill Road

SUBDIVISION: Saah Property LOT: 2 TAX ID: \_\_\_\_\_

CONTRACTOR: Fogle's Septic Clean Inc. EMAIL: Kevin@foglesinc.com

CONTRACTOR ADDRESS: 580 Obrecht Road, Sykesville, MD 21784 PHONE: 410-795-5670

PROPERTY OWNER: Jeff Yourick EMAIL: \_\_\_\_\_

OWNER ADDRESS: 14406 Triadelphia Mill Road PHONE: 410-627-5097

SEPTIC TANK SIZE (GALLONS): Ex. PUMP CHAMBER CAPACITY (GALLONS): Ex. PUMP SIZE: \_\_\_\_\_

NUMBER OF BEDROOMS: 5 HOUSE SQ. FT. \_\_\_\_\_ APPLICATION RATE: 1.2

DISTRIBUTION SYSTEM: GRAVITY FED  LOW PRESSURE DOSED

TRENCHES:	LINEAR FEET REQUIRED: <u>104</u>	INLET DEPTH: <u>3</u>
	TRENCH WIDTH: <u>3</u>	MAXIMUM BOTTOM DEPTH: <u>7</u>
	MINIMUM SPACE BETWEEN TRENCHES: <u>12</u>	EFFECTIVE AREA BEGINNING DEPTH: <u>4</u>
LOCATION:	<b>TO BE STAKED BY SANITARIAN DURING PRE-CONSTRUCTION INSPECTION.</b>	
NOTES:	<p>Ex. system put in clay. Original Perc tests not accurate. Good soil starts at 3.5'-4'. Owner wants system to be sized a little larger. [5BR Design: <math>750\text{gpd} \div 1.2\text{gpd}/\text{sq.ft} = 625 \div 3 = 208 (.50) = 104\text{LF}</math>]          [6BR Design: <math>900\text{gpd} \div 1.2\text{gpd}/\text{sq.ft} = 750 \div 3 = 250 (.50) = 125\text{LF}</math>]          Install new dist. Box just below existing trenches. Run 3x40' trenches on contour away from house. Future repair area will be further away from house uphill from ex. Barn. * An Event Counter may need to be installed on ex. Pump to check timely flow of system.</p>	

ISSUED BY: K. Wolf, L.E.H.S. ISSUE DATE: 10/14/2015 EXPIRATION DATE: 10/14/2016

- NOTE: CONTRACTOR MUST SCHEDULE A PRE-CONSTRUCTION INSPECTION PRIOR TO BEGINNING ANY INSTALLATION
- NOTE: CONTRACTOR MUST SCHEDULE AN INSPECTION AND GAIN APPROVAL OF ALL COMPONENTS PRIOR TO COVERING
- NOTE: STONE MUST BE APPROVED BY HEALTH DEPARTMENT AND GRAVEL TICKET MUST BE AVAILABLE FOR REVIEW.
- NOTE: WATERTIGHT SEPTIC TANKS REQUIRED
- NOTE: ALL PARTS OF SEPTIC SYSTEM SHALL BE AT LEAST 100 FEET DOWNGRADE FROM ANY WATER WELL
- NOTE: MANHOLE RISERS REQUIRED ON ALL SEPTIC TANKS AND PUMP CHAMBERS
- NOTE: AN ELECTRICAL PERMIT IS REQUIRED FOR INSTALLATION OF ANY ELECTRICAL COMPONENTS OF THE SYSTEM  
 ELECTRICAL PERMIT ISSUED E n/a
- NOTE: THE HCHD DOES NOT WARRANT ANY SYSTEM AND CANNOT GUARANTEE THE PERFORMANCE OF THIS SYSTEM AS DESIGNED. BY ACCEPTING THIS PERMIT, THE OWNER AND/OR APPLICANT ACKNOWLEDGE THAT THE SPECIFICATIONS DETAILED IN THIS DESIGN ARE ONE POSSIBLE OPTION AND THAT THE HCHD WILL REVIEW OTHER PROPOSALS. YOU HAVE THE OPTION TO SEEK THE ADVICE OF A QUALIFIED DESIGN CONSULTANT OR PROFESSIONAL ENGINEER FOR FURTHER GUIDANCE.
- NOTE: MDE RECOMMENDS SEPTIC TANKS, BAT, AND OTHER PRETREATMENT UNITS BE PUMPED AT A FREQUENCY ADEQUATE TO ENSURE THAT SOLIDS ARE NOT DISCHARGED TO THE DISPOSAL AREA

NEITHER THE HOWARD COUNTY COUNCIL NOR THE HEALTH DEPARTMENT IS RESPONSIBLE FOR THE SUCCESSFUL OPERATION OF ANY SYSTEM.

PERMITTEE RESPONSIBLE FOR OBTAINING FINAL APPROVAL ON THIS PERMIT.

CALL 410-313-1771 TO SCHEDULE INSPECTIONS.

# Howard County Health Department

Bureau of Environmental Health, Ellicott City, Maryland 410-313-2640

SEWAGE DISPOSAL PERMIT NO. A- Repair P- 557385

PERMITTEE

Fogel's Septic Clean, Inc.

LOCATION

14466 Tradelphia Mill Rd Arach Property

Jeff Yourick

Do Not Cover Work Until Health Department Approval Appears On This Card

POST THIS CARD WHERE IT CAN BE SEEN FROM ROAD

STOP ALL CONSTRUCTION ON SEWAGE DISPOSAL SYSTEM AND CONTACT HEALTH DEPARTMENT BEFORE CONTINUING

WORK IS SATISFACTORY, CONTINUE

Inspector

Date

Inspector

Date

FINAL INSPECTION MADE, COVER ALL WORK

Inspector

Date