

5/14/03-12pm

PUB. SEWER STATUS VERIFIED BY NA

ISSUE DATE: 5/2/2003

P 518650-C

APPROVAL DATE: 5/14/03

# PERMIT INDEXED

A REPAIR

## ON-SITE SEWAGE DISPOSAL SYSTEM HOWARD COUNTY HEALTH DEPARTMENT BUREAU OF ENVIRONMENTAL HEALTH 04-339800

Jack Fyock Septic Service IS PERMITTED TO INSTALL  ALTER

ADDRESS: PO Box 89, Glenelg, MD 21737 PHONE NUMBER: 410-988-9270

SUBDIVISION: Hough Property LOT NUMBER: 2

ADDRESS: 2285 McKendree Road PROPERTY OWNER: Robert Boguslaw

SEPTIC TANK CAPACITY (GALLONS): Existing 1000 gallon + Ex drywell

PUMP CHAMBER CAPACITY (GALLONS): N/A Ex 71' long trench

NUMBER OF BEDROOMS: 4 + 5

SQUARE FEET PER BEDROOM: 180

LINEAR FEET OF TRENCH REQUIRED: ADD ANOTHER 70' TRENCH

TRENCHES:	Trench to be <u>3</u> feet wide. Inlet <u>4 1/2</u> feet below original grade. Bottom maximum depth <u>6 1/2</u> feet below original grade. Effective area begins at <u>4 1/2</u> feet below original grade. <u>2</u> feet of stone below distribution pipe.
LOCATION:	<u>SET D. Box off Dry well. Connect existing trench to d. box and the new 70' trench, too.</u>
PURPOSE:	In support of building permit. Call for inspection when ground is opened so sanitarian can recommend repair.

PLANS APPROVED: (KN) DATE: 5-7-03  
5/2/2003

- NOTE: PERMIT VOID AFTER 2 YEARS
- NOTE: CONTRACTOR RESPONSIBLE FOR SCHEDULING A PRE-CONSTRUCTION INSPECTION FOR ALL INSTALLATIONS
- NOTE: WATERTIGHT SEPTIC TANKS REQUIRED
- NOTE: ALL PARTS OF SEPTIC SYSTEM SHALL BE 100 FEET FROM ANY WATER WELL
- NOTE: MANHOLE RISERS REQUIRED ON ALL SEPTIC TANKS AND PUMP CHAMBERS

**NEITHER THE HOWARD COUNTY COUNCIL NOR THE HEALTH DEPARTMENT IS RESPONSIBLE FOR THE SUCCESSFUL OPERATION OF ANY SYSTEM PERMITTEE RESPONSIBLE FOR OBTAINING FINAL APPROVAL ON THIS PERMIT CALL 410-313-2640 FOR INSPECTION OF SEPTIC SYSTEM**

P518650-C

NOT TO SCALE

SEE PERC SHEET FOR PRE CONSTRUCTION SITE PICTURE. Draw final trench installation, below with measurements

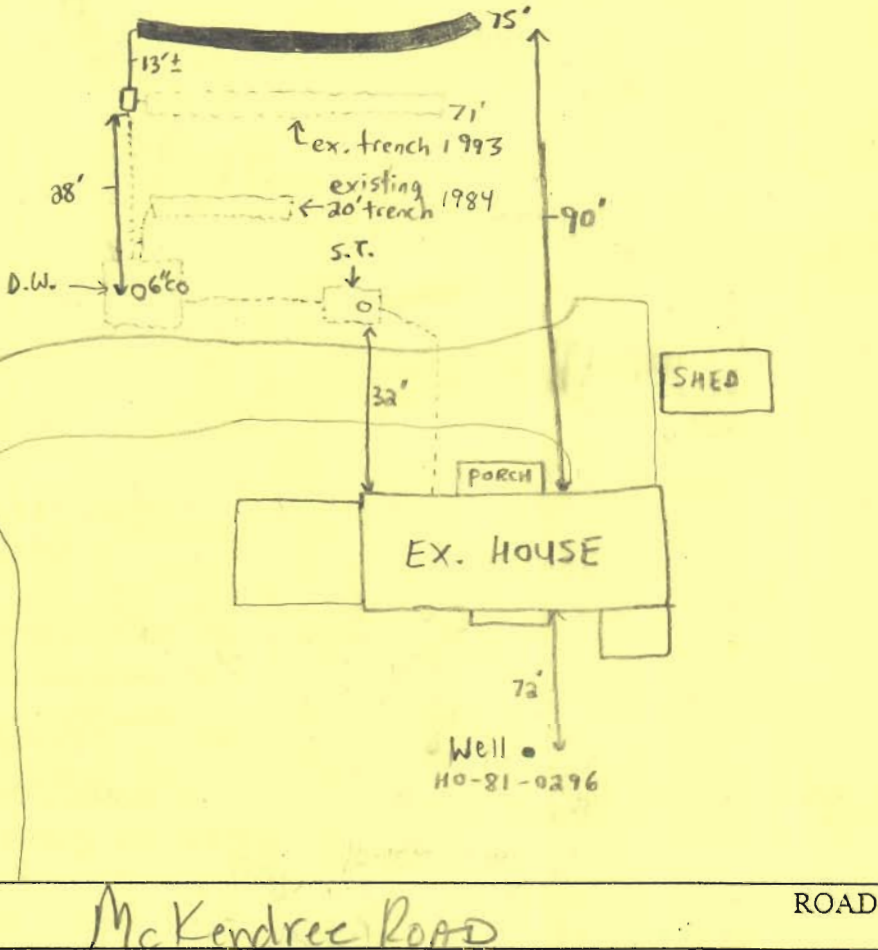

TRENCH/DRAINFIELD DATA		
WIDTH	INLET	BOTTOM
3	4.5	6.5
NUMBER OF TRENCHES		1
TOTAL LENGTH		75'
ABSORPTION AREA		
DISTRIBUTION BOX LEVEL		✓
DISTRIBUTION BOX BAFFLE		NA
DISTRIBUTION BOX PORT		NA

SEPTIC TANK DATA	
SEPTIC TANK 1 LEVEL	Existing
CAPACITY	Ex 1,000 GAL
SEAM LOC	+ Dry well
TANK LID DEPTH	?
BAFFLES	?
BAFFLE FILTER	NA
MANHOLE LOC	NA
6" PORT LOC	
WATERTIGHT TEST	NA
SEPTIC TANK 2 LEVEL	NA
CAPACITY	
SEAM LOC	
TANK LID DEPTH	
BAFFLES	
BAFFLE FILTER	
MANHOLE LOC	
6" PORT LOC	
WATERTIGHT TEST	

PRE-CONSTRUCTION 5-7-03 SEE PERC NOTES FOR DRAWING AND DATA.  
 NEED 1 more trench ~70' long. Current trench fine. Accomodating  
 INSTALLATION B.P. (AL) 5/14/03- OK TO COVER ALL WORK, NEW 75' TRENCH  
 INSTALLED - (SRK)

FINAL INSPECTOR Steven R. Krieg DATE OF APPROVAL 5/14/03