

~~HOUSE CONNECTION REQ'D~~

# PERMIT

approved 10/21/86  
8/16

P 37718

A 35192

## SEWAGE DISPOSAL SYSTEM

### MARYLAND STATE DEPARTMENT OF HEALTH

HOWARD COUNTY  
BUREAU OF ENVIRONMENTAL HEALTH

461-9933

INDEXED

ELLICOTT CITY

DISTRICT 3rd

DATE 9/30/86

Lendrim Contracting, Inc. IS PERMITTED TO INSTALL  ALTER

ADDRESS 14010 Forsythe Road, Sykesville, Maryland 21784 PHONE 442-2416

SUBDIVISION Homewood ROAD 11207 McGee Way LOT 2

PROPERTY OWNER Robert C. Goodier

ADDRESS \_\_\_\_\_

IF GARBAGE GRINDER IS USED INCREASE SEPTIC TANK CAPACITY BY 50% AND ABSORPTION AREA BY 22%.

GARBAGE GRINDER? YES  NO

SEPTIC TANK CAPACITY 1250 GALLONS NUMBER OF BEDROOMS 4

TRENCHES - 259 sq. ft. per bedroom. Trench to be 3 feet wide. Inlet 3.5 feet below original grade. Bottom maximum depth 5 feet below original grade. Effective area begins at 3.5 feet below original grade. 1.5 feet of stone below distribution pipe.

LOCATION - Place the distribution box 135 feet from the back (350') lot line and 195 feet from the right (190') lot line as seen when facing the lot from Homewood Road. Run trenches on contour toward the back of lot.

NOTE - No trench to exceed 100 feet in length. If more than one trench used, a distribution box is required. Call for inspection of trench(s) before and after gravel is installed. Provide 6" - 8" diameter cleanout and cap to grade or above on septic tank.

*JKP*

OK TO USE 2-6" WIDE 87' TRENCHES w/ 2 LINGS THROUGH EACH TRENCH. S.D. 21

PLANS APPROVED BY S. Abel DATE 2/07/86

COVER NO WORK UNTIL INSPECTED AND APPROVED.

NEITHER THE HOWARD COUNTY COUNCIL NOR THE HEALTH DEPARTMENT IS RESPONSIBLE FOR THE SUCCESSFUL OPERATION OF ANY SYSTEM.

NOTE: IF TRENCH IS USED CALL FOR INSPECTION BEFORE AND AFTER PLACING GRAVEL IN TRENCH.

NOTE: NO DRY WELL SHALL EXCEED 15 FOOT IN DIAMETER. NO ABSORPTION TRENCH TO EXCEED 100 FEET IN LENGTH.

NOTE: ALL PIPE FROM HOUSE TO SEPTIC TANK MUST BE CAST IRON OR SCHEDULE 40 PVC OR ABS.

PERMIT VOID AFTER THREE YEARS.

NOTE: INSTALL STAND PIPE ON SEPTIC TANK AND DRY WELL. STAND PIPES MUST BE 6 INCHES IN DIAMETER. CAST IRON, CONCRETE OR TERRA COTTA, OR PVC OR ABS ACCEPTED. IF TOP OF SEPTIC TANK IS DEEPER THAN 3 FEET MANHOLE TO GRADE REQUIRED.

**\*INSTALLER IS RESPONSIBLE FOR OBTAINING FINAL APROVAL ON THIS PERMIT**

CALL 992-2330 FOR INSPECTION OF SEPTIC SYSTEMS.

EH - 2-1082

A 35192

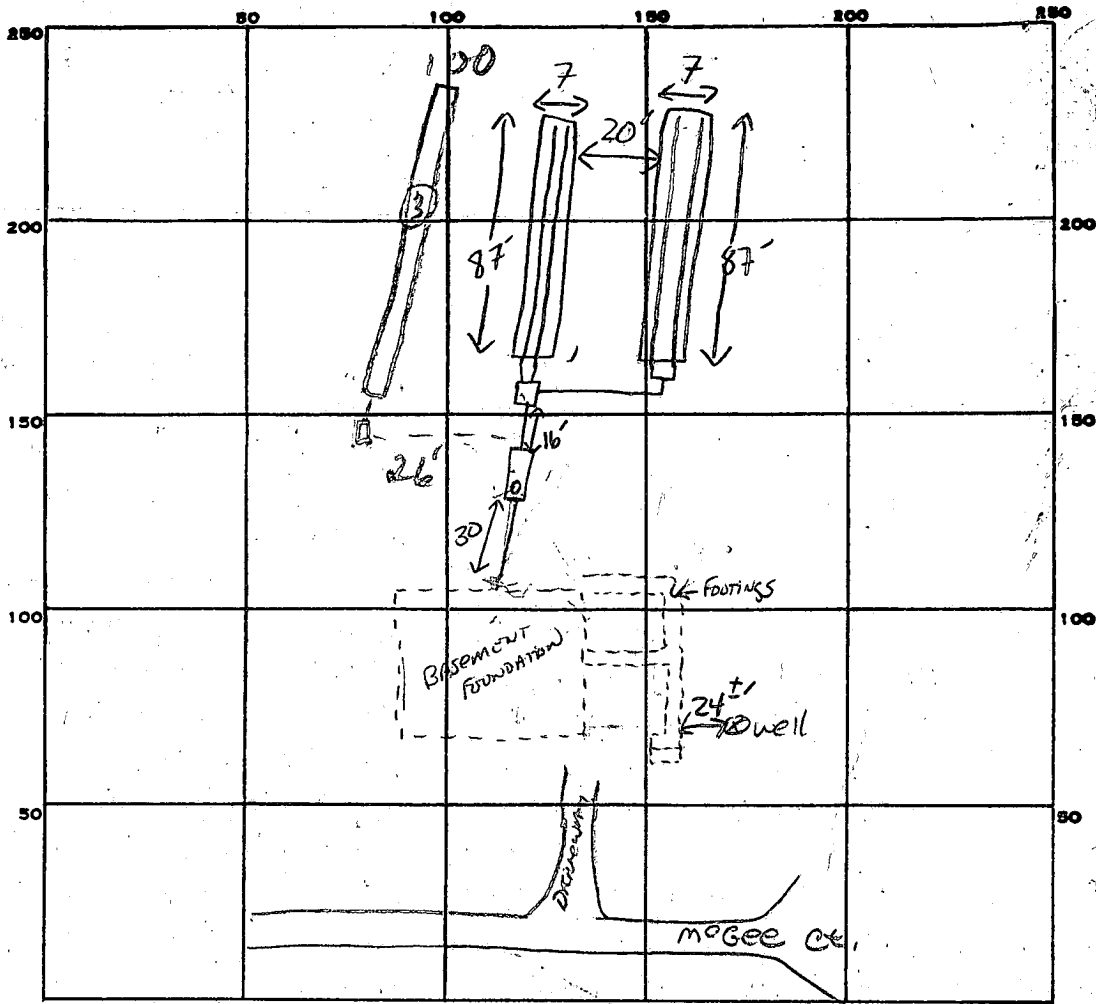

INDICATE NORTH. - NAME ADJOINING ROADWAY AS BASE LINE.

$$\begin{array}{r} 239 \\ 574 \\ \hline 1218 \end{array}$$
  

$$\begin{array}{r} 239 \\ 254 \\ \hline 1036 \\ 310 \\ \hline 310 \\ 310 \\ \hline 310 \end{array}$$
  
 345'

PERMIT CARD 
  
 SEPTIC TANK, LEVEL 1500 GAL  CLEANOUTS 
  
 DISTRIBUTION BOX, LEVEL 
  
 TILE FIELD, DEPTH 5-5.5' FT. TRENCH WIDTH 7 FT. INLET 3.5'
  
 GRAVEL DEPTH 1.5-2 FEET. TOTAL LENGTH 87 <sup>①</sup> 87 <sup>②</sup> FT.

NUMBER OF TRENCHES 2 TOTAL BOTTOM AREA 1218 SQ. FT.

SEEPAGE PITS, INSIDE DIAMETER \_\_\_\_\_ FT. DEPTH BELOW INLET \_\_\_\_\_ FT.

ABSORBENT AREA 1218 SQ. FT.

REMARKS OK TO COVER ALL WORK. NEED HOUSE CONNECTION BEFORE FINAL. S. Abad

---



---



---



---

DATE SYSTEM APPROVED 10-21-87 INSPECTOR Sid Abad